



THE SHAKESPEARE
ASSOCIATION
OF AMERICA

University of Maryland,
Baltimore County
1000 Hilltop Circle
Baltimore, Maryland
21250

PHONE: 410-455-6788
FAX: 410-455-1063
E-MAIL: saa@umbc.edu



SHAKESPEARE
ASSOCIATION
OF AMERICA

PROGRAM OF THE
29TH ANNUAL MEETING

12-14 APRIL 2001

HOTEL INTER-CONTINENTAL
MIAMI

Shakespeare

The 29th Annual Meeting of The Shakespeare Association of America

Executive Director: LENA COWEN ORLIN
University of Maryland, Baltimore County

Interim Executive Director: SARAH GREENLEAF WHITTIER
Pacific Collegiate School, Santa Cruz

President

MEREDITH SKURA
Rice University

Vice-President

ANTHONY B. DAWSON
University of British Columbia

Trustees

HARRY BERGER, JR.
University of California, Santa Cruz

DYMPNA CALLAGHAN
Syracuse University

BARBARA HODGDON
Drake University

JEAN E. HOWARD
Columbia University

JEFFREY MASTEN
Northwestern University

STEPHEN ORGEL
Stanford University

LOIS POTTER
University of Delaware

Program Planning for the 29th Annual Meeting

Chair

BARBARA HODGDON, Drake University

JOHN MICHAEL ARCHER, University of New Hampshire

ANTHONY B. DAWSON, University of British Columbia

SUSAN FRYE, University of Wyoming

Sponsors of the 29th Annual Meeting

Principal Hosts

Florida International University, Miami
College of Arts and Sciences
Department of English
Department of Theatre and Dance
Women's Studies Center

University of Miami, Coral Gables
College of Arts and Sciences
Department of English
Department of Theatre Arts
Master of Arts in Liberal Studies
Office of the Executive Vice President
and Provost



Miami Dade County Tourist Development Council

Miami-Dade County Tourist Development Council
Miami-Dade County Department of Cultural Affairs
Miami-Dade County Cultural Affairs Council
Miami-Dade County Mayor
Board of County Commissioners

Co-Sponsors

Barry University, Miami Shores
Florida Atlantic University, Boca Raton
Florida Gulf Coast University, Fort Myers
Florida State University, Tallahassee,
and the *Journal for Early Modern Cultural Studies*
New College of the University of South Florida, Sarasota,
and the New College Program in Medieval-Renaissance Studies
University of South Florida, Tampa

The Shakespeare Association of America
wishes to acknowledge
the indispensable efforts of the following people:

Local Arrangements Committee
Co-Chairs

PEGGY ENDEL, Florida International University
MIHOKO SUZUKI, University of Miami

Committee Members

JAMES ANDREAS, Florida International University
ANTHONY BARTHELEMY, University of Miami
PHILLIP CHURCH, Florida International University
KENT LANTAFF, University of Miami
JENNIFER LOW, Florida Atlantic University
JEFFREY SHOULSON, University of Miami
JAMES SUTTON, Florida International University

With special thanks to:

The Honorable GWEN MARGOLIS,
Chairperson, Miami-Dade County Cultural Affairs Council

PETER BELLIS, University of Miami
TOM BISHOP, Case Western Reserve University
BRUCE BOEHRER, Florida State University
LEROY CLARK, Florida International University
EUGENE CLASBY, University of Miami
ABEL CORNEJO, Florida International University
SARA M. DEATS, University of South Florida, Tampa
LUIS GLASER, University of Miami
IVELAW L. GRIFFITH, Florida International University
DANIEL PALS, University of Miami
SUZANNE ROSE, Florida International University
LILLIAN SCHANFIELD, Barry University
LEE SNYDER, New College of the University of South Florida
STEVEN G. ULLMANN, University of Miami
DONALD WATSON, Florida International University
DAYLE WILSON, University of Miami
JOE WISDOM, Florida Gulf Coast University
REM CABRERA, Miami-Dade County Department of Cultural Affairs
CHRISTINA TASSY-BEAUVOIR, Miami-Dade County Department of Cultural Affairs

Conference Administration

Program Coordinator
LEE TYDINGS
With the Assistance of
JACKIE HOPKINS and JULIE MORRIS

2001 Program Guide

See a floorplan for hotel meeting spaces on pages 5 & 6

Thursday, 12 April

	<i>Page</i>
12:00 noon	7
Registration opens on the MEZZANINE LEVEL	7
Exhibits open on MEZZANINE EAST	7
1:30 p.m.	7
Paper Session in TRIANON: Retracing the Spirit: Shakespearean Reminiscences of Premodern Devotion and Postmodern Religion	7
Paper Session in CHOPIN: Feminist Historiography and Shakespeare's London: Rewriting Women's History	7
3:30 p.m.	8
Seminar in TUTTLE: Stage Directions in Text and Performance	8
Seminar in TRINITY: Shakespeare's Stationers, 1593-2001: Printers, Publishers, Booksellers	8
Seminar in BALMORAL: Food Studies/Early Modern Studies	8
Seminar in CAMBRIDGE: Early Observers of the Shakespearean Stage: Reporters and Interpreters, 1576-1642	8
Seminar in MARTI: Closet or Coterie Drama	9
Seminar in SANDRINGHAM: Normative Shakespeare	9
Seminar in RAPHAEL: Women Reading and Being Read	9
Workshop in WINDSOR: Getting Published	9
Seminar in GUSMAN: The State of Performance Criticism: Where Are We Today and Where Are We Headed?	10
Seminar in ESCORIAL & ALHAMBRA: Early Modern "Manuals" and the Scripting of Behavior	10
Seminar in MICHELANGELO: Instructive Formations: Education, Rhetoric, and Renaissance Drama	10
4:00 p.m.	11
Workshop For Teachers in BAYFRONT B: Teaching Outside the Curriculum: 11 <i>Romeo and Juliet</i> and <i>The Tempest</i>	11
6:00 p.m.	11
Registration and Exhibits close	11
6:30 p.m.	11
Opening Reception at Vizcaya	11

Friday, 13 April

8:00 a.m.	12
Registration opens on the MEZZANINE LEVEL	12
Exhibits open on MEZZANINE EAST	12
Continental Breakfast for Graduate Students in FLAGLER	12
9:00 a.m.	12
Plenary Session in the GRAND BALLROOM: Not the New Criticism: Historicizing Shakespeare's Language	12
10:30 a.m.	12
Morning Break; coffee served	12
11:00 a.m.	13
Paper Session in SEVILLA: Knowing Bodies: Towards an Historical Phenomenology	13
Paper Session in CHOPIN: Performance as Critical Practice	13
1:00 p.m.	13
Annual Luncheon in VERSAILLES	13
3:30 p.m.	14
Seminar in MARTI: Pornographic Shakespeare	14
Workshop in BALMORAL: Shakespeare and the Moving Image: The Pedagogy of Film	14
Workshop in WINDSOR: Teaching through Performance: <i>Hamlet</i> , 3.1	14
Seminar in MICHELANGELO: Rivalry and Re-vision in English Drama, 1580-1642	15

	Seminar in SANDRINGHAM: Anger, Revenge, and the Gendering of Emotions on the Early Modern Stage	15
	Seminar in TUTTLE: American Cultural Productions of Shakespeare	15
	Seminar in GUSMAN: Personation	15
	Seminar in RAPHAEL: The Characters of Shakespeare's Plays	16
	Seminar in CAMBRIDGE: Anatomizing the Renaissance	16
	Seminar in TRINITY: Corruptible Bodies	16
	Seminar in DUPONT: Working Women/Women's Work: The Role of the Working Woman in Shakespeare's England	16
	Seminar in ESCORIAL & ALHAMBRA: New Economic Criticism	17
5:30 p.m.	Registration and Exhibits close	17
7:00 p.m.	Buses depart for <i>Much Ado About Nothing</i>	17
8:00 p.m.	Performance: <i>Much Ado About Nothing</i>	17

Saturday, 14 April

8:00 a.m.	Information Desk opens on the MEZZANINE LEVEL	18
	Exhibits open on MEZZANINE EAST	18
9:00 a.m.	Paper Session in TRIANON: Middleton: Men, Women, and Money	18
	Paper Session in CHOPIN: Beyond Branagh: New Screen Shakespeare	18
10:30 a.m.	Morning Break; coffee served	19
11:00 a.m.	Paper Session in TRIANON: Antiquarianisms: Past, Present, Future	19
	Paper Session in CHOPIN: Making Electronic Shakespeares	19
12:30 p.m.	Information Desk and Exhibits close	19
2:00 p.m.	Paper Session in TRIANON: Shakespeare and Contemporary Post-Colonial Drama	20
	Paper Session in CHOPIN: Shakespearean Tragedy Revisited: <i>Hamlet, Lear, Bradley</i>	20
4:00 p.m.	Seminar in TUTTLE: Early Modern English Texts and the History of Sexuality	20
	Seminar in BALMORAL: Girls in the 'Hood	21
	Seminar in GUSMAN: Shakespeare on Film: An Electronic Seminar	21
	Workshop in WINDSOR: Literacies/Identities in Early Modern England	21
	Seminar in MARTI: Shakespeare and Latinities	21
	Seminar in RAPHAEL: <i>Titus</i> in Our Time	22
	Seminar in ESCORIAL & ALHAMBRA: Acting Companies	22
	Seminar in CAMBRIDGE: Spanish Culture and the Early Modern English Imaginary	22
	Seminar in TRINITY: Editing Early Modern Playtexts: Theory and Practice	22
	Seminar in MICHELANGELO: The Pleasures of Patterns	23
	Seminar in SANDRINGHAM: Orality, Print, Performance	23
7:00 p.m.	Buses depart for <i>Shakespeare's Journey</i>	23
8:00 p.m.	Performance: <i>Shakespeare's Journey</i>	23
10:00 p.m.	SAA / Malone Society Dance with Cash Bar in BAYFRONT A & B	23

**Hotel Inter-Continental
Lobby Level**

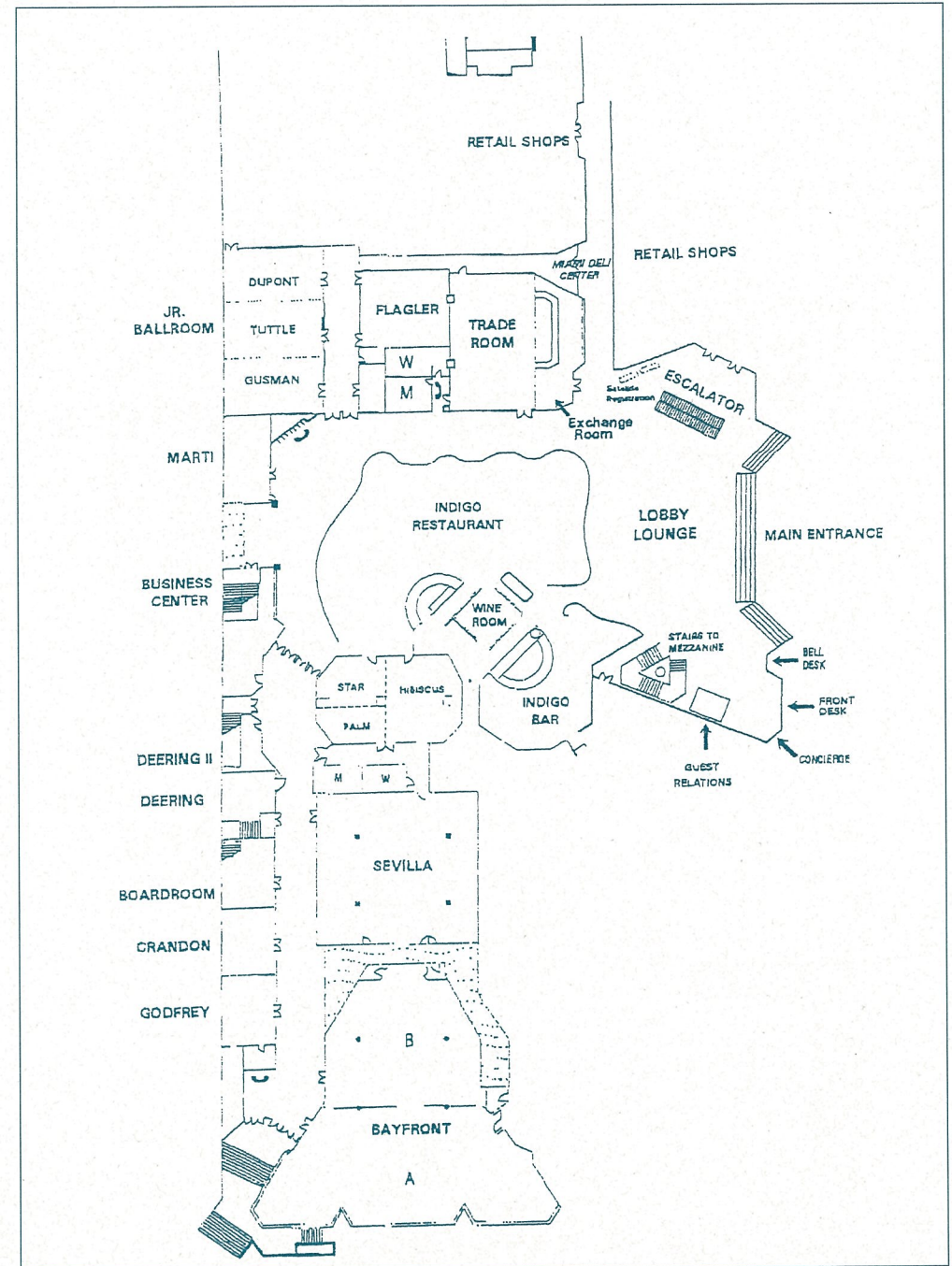

Hotel Inter-Continental
Mezzanine Level

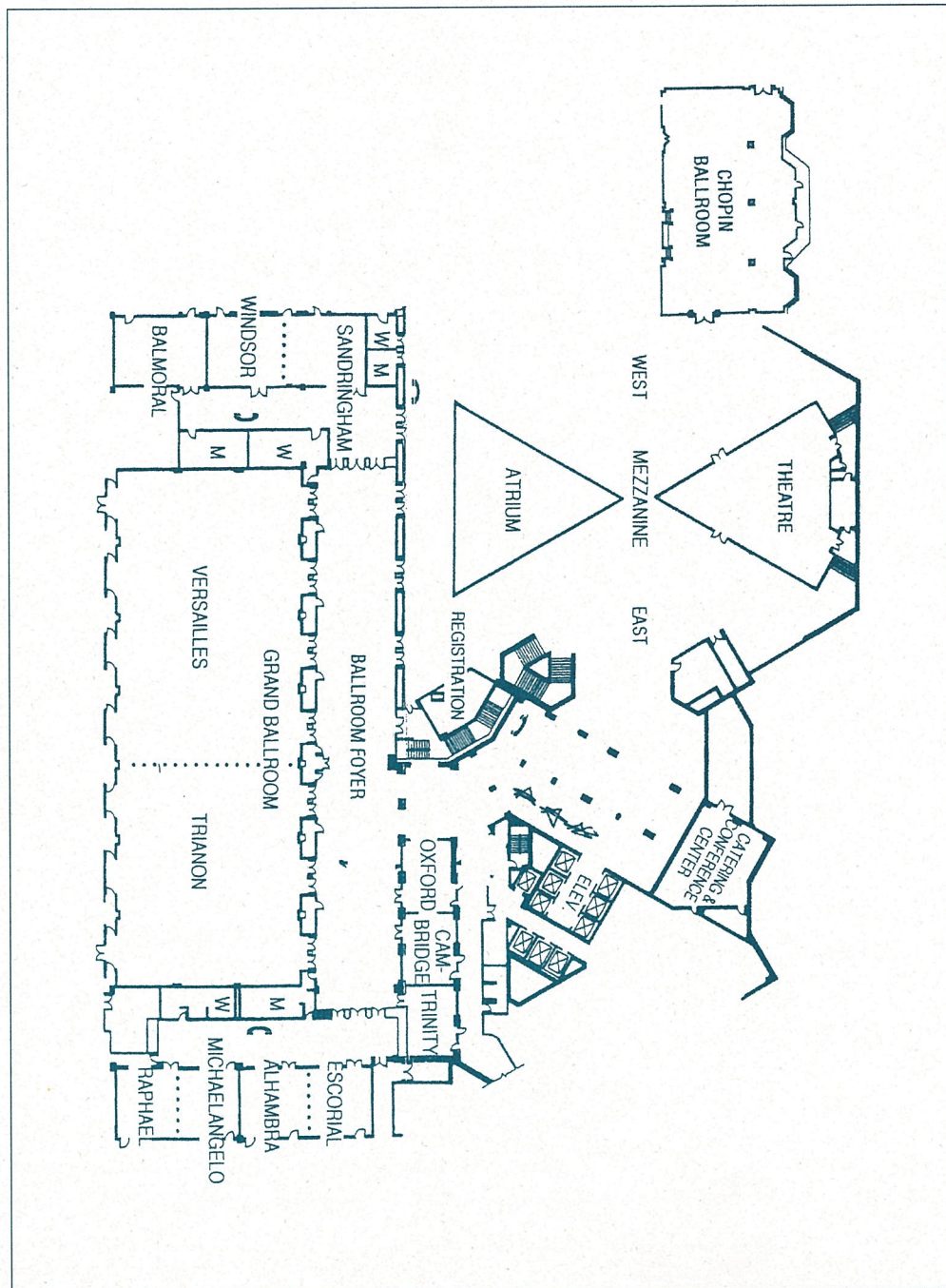

Thursday, 12 April

12:00 noon to 6:00 p.m.

Registration
Mezzanine Level

Exhibits
Mezzanine East

1:30 to 3:00 p.m.

Paper Session: Retracing the Spirit: Shakespearean
Reminiscences of Premodern Devotion and Postmodern Religion

Trianon

Chair: DONNA B. HAMILTON, University of Maryland, College Park

PAUL WHITFIELD WHITE, Purdue University
Drama, Identity, and Devotion in Early Modern England

PHILIPPA BERRY, King's College, Cambridge University
'A salve in the mail': The Touch of the Text
and the Paradox of Salvation in *Love's Labour's Lost*

LOWELL GALLAGHER, University of California, Los Angeles
Blood Memories

Paper Session: Feminist Historiography and
Shakespeare's London: Rewriting Women's History

Chopin

Chair: JOHN MICHAEL ARCHER, University of New Hampshire

MARGO HENDRICKS, University of California, Santa Cruz
Shakespeare's Wives: A Problem of History

KAREN NEWMAN, Brown University
Sex and the City

3:00 to 3:30 p.m.

Afternoon Break

3:30 to 5:30 p.m.

Seminar: Stage Directions in Text and Performance

Tuttle

Leader: ROGER APFELBAUM, Seton Hall University

JODY D. BROWN, Ferrum College
ALAN DESSEN, University of North Carolina
KEVIN EWERT, University of Pittsburgh
JAMES FITZMAURICE, Northern Arizona University
M. J. KIDNIE, South Bank University
CYNTHIA LEWIS, Davidson College

GENEVIEVE LOVE, Cornell University
AUDREY STANLEY, University of California, Santa Cruz
LESLIE THOMSON, University of Toronto
STEVEN URKOWITZ, City University of New York
MICHAEL WARREN, University of California, Santa Cruz

Seminar: Shakespeare's Stationers, 1593-2001: Printers, Publishers, Booksellers

Trinity

Leader: THOMAS L. BERGER, St. Lawrence University

TERRI BOURUS, Northern Illinois University
JEAN R. BRINK, Arizona State University
LUKAS ERNE, University of Geneva
DAVID GANTS, University of Georgia

KIRK MELNIKOFF, Boston University
ANDREW MURPHY, University of St. Andrews
LORI HUMPHREY NEWCOMB, University of Illinois,
Champaign-Urbana

Seminar: Food Studies/Early Modern Studies

Balmoral

Leaders: ANN C. CHRISTENSEN, University of Houston
KATHERINE CONWAY, Wheaton College

RUSSELL J. BODI, Owens College
KATHARINE CRAIK, University College, London
DAVID GOLDSTEIN, Stanford University
JUANA GREEN, Clemson University
THELMA GREENFIELD, University of Oregon

WILLIAM KERWIN, University of Missouri, Columbia
RANDALL NAKAYAMA, San Francisco State University
TERRY J. REILLY, University of Alaska, Fairbanks
DAVID RUITER, University of Texas, El Paso
WENDY WALL, Northwestern University

Seminar: Early Observers of the Shakespearean Stage: Reporters and Interpreters, 1576-1642

Cambridge

Leader: John D. COX, Hope College

DAVID M. BEVINGTON, University of Chicago
DAVID KATHMAN, Morningstar, Chicago
TANYA POLLARD, Macalester College
DENNIS PRINDLE, Ohio Wesleyan University

BARBARA TRAISTER, Lehigh University
BRENT WHITTED, Marlborough School
CHARLES WHITNEY, University of Nevada, Las Vegas

Seminar: Closet or Coterie Drama

Marti

Leader: JULIE CRAWFORD,
Columbia University

SUSAN IWANISZIW, Independent Scholar
LOIS POTTER, University of Delaware
KAREN RABER, University of Mississippi

ANNE RUSSELL, Wilfrid Laurier University
ALAN STEWART, University of London
MELISSA WALTER, University of Wisconsin, Madison

Seminar: Normative Shakespeare

Sandringham

LEADER: JONATHAN V. CREWE,
Dartmouth College

MARLO M. BELSCHNER, St. Cloud State University
KATHERINE BOOTLE, University of Virginia
DOMINICA BORG, Dartmouth College
PATRICIA A. CAHILL, Emory University
SARA MUNSON DEATS, University of South Florida
LARS ENGLE, University of Tulsa
STEPHEN MERRIAM FOLEY, Brown University
SUSAN FRYE, University of Wyoming

SAYRE N. GREENFIELD, University of Pittsburg,
Greensburg
GRACE R. W. HALL, Massachusetts Institute of
Technology
DENNIS KEZAR, Vanderbilt University
PATRICK M. MURPHY, SUNY, Oswego
KATHRYN SCHWARZ, Vanderbilt University
LAURIE SHANNON, Duke University

Seminar: Women Reading and Being Read

Raphael

Leaders: MELINDA GOUGH, Oklahoma State University
SUSAN O'MALLEY, CUNY Kingsborough and the Graduate School

BARBARA BOWEN, Queen's College, CUNY
MICHELLE EPHRAIM, Worcester Polytechnic Institute
GAYLE GASKILL, College of St. Catherine
DEBORAH HUMAN, Eastern Connecticut State
University
REBECCA LEMON, University of Southern California

CHRISTINA LUCKYJ, Dalhousie University
MARGARET MAURER, Colgate University
RICHELLE MUNKHOFF, Stanford University
DENISE TILLERY, Oklahoma State University

Workshop: Getting Published

Windsor

Leader: JEROME E. SINGERMAN, University of Pennsylvania Press

ANNALISA CASTALDO, Temple University
PHILLIP D. COLLINGTON, Niagara University
ROBERT CROSMAN, University of Alaska
EMILY DETMER-GOEBEL, Millikin University
SUJATA IYENGAR, University of Georgia

THERESA D. KEMP, University of Wisconsin, Eau Claire
COURTNEY LEHMANN, University of the Pacific
SUSAN N. MAYBERRY, Alfred University
KATHRYN M. MONCRIEF, Washington College
JENNIFER PANEK, Harvard University

**Seminar: The State of Performance Criticism:
Where Are We Today and Where Are We Headed?**

Gusman

Leader: SARAH WERNER, George Washington University

DAVID G. BRAILOW, McKendree College
CHRISTOPHER COBB, North Carolina State University
MICHAEL D. FRIEDMAN, University of Scranton
STEPHANIE GEARHART, Lehigh University

ANDREW JAMES HARTLEY, State University of West Georgia
JAMES LOEHLIN, University of Texas, Austin
WILLIAM T. LISTON, Ball State University
PAUL PRESCOTT, The Shakespeare Institute

Seminar: Early Modern "Manuals" and the Scripting of Behavior

Escorial & Alhambra

Leader: FRANK WHIGHAM, University of Texas, Austin

HARRY BERGER, JR., University of California, Santa Cruz
CAROL BLOSSER, University of Texas, Austin
REBECCA BUSHNELL, University of Pennsylvania
JOHN A. CARPENTER, University of South Carolina
ANNETTE DREW-BEAR, Washington and Jefferson College
MILISSA ELLISON-MURPHREE, University of West Georgia
MARY FLOYD-WILSON, Yale University

LAGRETTA T. LENKER, University of South Florida
NINA LEVINE, University of South Carolina
JENNIFER LOW, Florida Atlantic University
PAULA MCQUADE, DePaul University
JOHN MORGAN, Ryerson Polytechnic University
JILL PHILLIPS, University of Virginia
JULIE ROBIN SOLOMON, American University

**Seminar: Instructive Formations:
Education, Rhetoric, and Renaissance Drama**

Michelangelo

Leader: ERIC WILSON,
Washington and Lee University

HOLLY CROCKER, Saint Lawrence University
LYNN ENTERLINE, Vanderbilt University
RICHARD HALPERN, University of California, Berkeley
AGNES ORMSBY, University of Toronto

KRISTEN POOLE, University of Delaware
MELANIE ROSS, De Vry University
M. RICK SMITH, Kent State University
PAUL SULLIVAN, University of Texas, Austin

4:00 to 9:00 p.m. (Dinner Break 6:00 to 7:00)

**Workshop for Teachers:
Teaching Outside the Curriculum:
Romeo and Juliet and *The Tempest***

Bayfront B

Leaders: JANET FIELD-PICKERING, Folger Shakespeare Library
MIRIAM GILBERT, University of Iowa
JAMES ANDREAS, Florida International University

6:00 p.m.

Buses marked "Coach U.S.A." will be waiting in front of the Hotel Inter-Continental to take guests to the Opening Reception at Vizcaya. Buses will depart at 6:15 and circulate for an hour between the hotel and Vizcaya. The turn-around time is approximately thirty minutes.

6:30 to 8:30 p.m.

**Opening Reception
Vizcaya**

Open to all registrants for the 29th Annual Meeting and their guests

Co-hosted by

FLORIDA INTERNATIONAL UNIVERSITY, MIAMI; UNIVERSITY OF MIAMI,
CORAL GABLES; MIAMI-DADE COUNTY TOURIST DEVELOPMENT COUNCIL; MIAMI-DADE
COUNTY DEPARTMENT OF CULTURAL AFFAIRS; MIAMI-DADE CULTURAL AFFAIRS COUNCIL; AND
MIAMI-DADE COUNTY MAYOR AND BOARD OF COUNTY COMMISSIONERS

Other Local Hosts:

BARRY UNIVERSITY, MIAMI SHORES;
FLORIDA ATLANTIC UNIVERSITY, BOCA RATON; FLORIDA GULF COAST UNIVERSITY, FORT
MYERS; FLORIDA STATE UNIVERSITY, TALLAHASSEE, AND *JOURNAL FOR EARLY MODERN
CULTURAL STUDIES*; NEW COLLEGE OF THE UNIVERSITY OF SOUTH FLORIDA, SARASOTA, AND
THE NEW COLLEGE PROGRAM IN MEDIEVAL-RENAISSANCE STUDIES;
UNIVERSITY OF SOUTH FLORIDA, TAMPA

8:30 p.m.

Buses return guests from Vizcaya to the Hotel Inter-Continental

Friday, 13 April

8:00 a.m. to 5:30 p.m.

Registration
Mezzanine Level

Exhibits
Mezzanine East

8:00 to 9:00 a.m.

Continental Breakfast for Graduate Students

Flagler

Hosted by the Trustees of the Association

9:00 to 10:30 a.m.

Plenary Session: Not the New Criticism:
Historicizing Shakespeare's Language

Grand Ballroom

Chair: A. R. BRAUNMULLER, University of California, Los Angeles

SYLVIA ADAMSON, University of Manchester
The Urge to Self-Expression

RUSS McDONALD, University of North Carolina, Greensboro
History and Poetry

LYNNE MAGNUSSON, Queen's University, Canada
Shakespeare with Words: Language and History

10:30 to 11:00 a.m.

Morning Break; coffee served

11:00 a.m. to 12:30 p.m.

Paper Session: Knowing Bodies:
Towards an Historical Phenomenology
Sevilla

Chair: BRUCE R. SMITH, Georgetown University

JULIAN YATES, University of Delaware
Michel Serres and Early Modern Studies

ANSTON BOSMAN, Amherst College
Nobody on Stage

CYNTHIA MARSHALL, Rhodes College
Phenomenology in the Audience

JOAN PONG LINTON, Indiana University
Agency of the Voice Withheld in Anne Askew's Examinations

JESSE G. SWAN, University of Northern Iowa
The Amphibolous and Other Positive Problems:
Knowing Bodies Knowing Bodies

Paper Session: Performance as Critical Practice

Chopin

CHAIR: KATHERINE ROWE, Bryn Mawr College

MARGO JEFFERSON, *The New York Times*
Reader or Spectator: Which Is to Be Master?

KATE D. LEVIN, City College, CUNY
What's Performance Got to Do With It?

JOSEPH ROACH, Yale University
Pepys, Shakespeare, and the Performance of Everyday Life

1:00 to 3:00 p.m.

Annual Luncheon
Versailles

Presiding: MEREDITH SKURA, Rice University

3:30 to 5:30 p.m.

Seminar: Pornographic Shakespeare

Marti

Leader: PAUL BUDRA,
Simon Fraser University

JOSEPH CHANEY, Indiana University
DAVID LINTON, Marymount Manhattan College

PETER SMITH, Nottingham Trent University
KAY STANTON, California State University, Fullerton

**Workshop: Shakespeare and the Moving Image:
The Pedagogy of Film**

Balmoral

Leader: DEBORAH T. CURREN-AQUINO,
Folger Shakespeare Library

ALAN ARMSTRONG, Southern Oregon University
CATHERINE G. CANINO, University of South Carolina,
Spartanburg
BARBARA FREEDMAN, Tufts University
WILLIAM W. FRENCH, West Virginia University
C. J. GIANAKARIS, Western Michigan University
LISA GIM, Fitchburg State College
DOUGLAS E. GREEN, Augsburg College

NIELS HEROLD, Oakland University
GORDON LELL, Concordia College
SHERI METZGER, University of New Mexico
LOUISA NEWLIN, Folger Shakespeare Library
KELLY NEWMAN, Montgomery Blair High School
ARNOLD W. PREUSSNER, Truman State University
RICHARD RAMBUSS, Emory University

Workshop: Teaching Through Performance: *Hamlet*, 3.1

Windsor

Leader: MIRIAM GILBERT,
University of Iowa

(This workshop is closed to auditors)

EDNA Z. BORIS, Laguardia Community College, CUNY
JUDITH CLARK, Stephens College
MICHAEL J. COLLINS, Georgetown University
JUDITH DUNBAR, Santa Clara University
MICHAEL GOOCH, DeVry Institute of Technology
KIRK HENDERSHOTT-KRAETZER, Olivet College
DONNA LONG, Fairmont State College
JEN GOLDFARB MATISOFF, Lehigh University

DAVID MIDDLETON, Trinity University
MARIANNE NOVY, University of Pittsburgh
ROBERT PIERCE, Oberlin College
ALISON PRINDLE, Otterbein College
STEPHEN RATCLIFFE, Mills College
PEGGY RUSSO, Pennsylvania State University
LIDIYA TONIC, DeVry Institute of Technology

Seminar: Rivalry and Re-Vision in English Drama, 1580-1642

Michelangelo

Leader: W. DAVID KAY, University of Illinois, Urbana-Champaign

JAMES P. BEDNARZ, Long Island University
SEAN BENSON, Malone College
PETER BEREK, Mount Holyoke College
ELLEN M. CALDWELL, Kalamazoo College
EWAN FERNIE, Queen's University Belfast

SUE MCCURDY HOSTERMAN, Independent Scholar
SARAH LYONS, Boston University
JAMES J. MARINO, Stanford University
C. EDWARD MCGEE, University of Waterloo
STEVEN SOWELL, University of Miami

**Seminar: Anger, Revenge, and the Gendering of
Emotions on the Early Modern Stage**

Sandringham

Leaders: GWYNNE KENNEDY, University of Wisconsin-Milwaukee
KAREN ROBERTSON, Vassar College

DEBBIE BARRETT-GRAVES, The College of Santa Fe
WENDY BEAVER, Rollins College
IRENE S. BURGESS, Wheeling Jesuit University
CORAX FOX, Marquette University
KATHARINE GOODLAND, Staten Island College, CUNY
MELANIE HANSON, University of Nevada-Las Vegas

RHODA S. KACHUCK, University of La Verne
HARRY KEYISHIAN, Fairleigh Dickinson University
JESSICA SLIGHTS, Acadia University
MOLLY E. SMITH, Stephen F. Austin University
AMY TIGNER, Stanford University

Seminar: American Cultural Productions of Shakespeare

Tuttle

Leader: MARGARET KNAPP, Arizona State University

CURTIS BRIGHT, University of Pittsburgh
DOROTHY COOK, Central Connecticut State University
WAYNE COOK, Central Connecticut State University
KATHERINE WEST SCHEIL, University of Rhode Island

FRANCES TEAGUE, University of Georgia
SUZANNE R. WESTFALL, Lafayette College
GARY JAY WILLIAMS, Catholic University of America

Seminar: Personation

Gusman

Leader: CARY M. MAZER, University of Pennsylvania

NELS A. CHRISTENSEN, Michigan State University
GEORGE L. GECKLE, University of South Carolina
JOHN GILLIES, University of Essex
ERIKA T. LIN, University of Pennsylvania
PAUL D. MENZER, University of Virginia

JACALYN ROYCE, University of Puget Sound
BRUCE R. SMITH, Georgetown University
JAN STIRM, University of Wisconsin, Eau Claire
ROBERT WEIMANN, University of California, Irvine

Seminar: The Characters of Shakespeare's Plays

Raphael

Leader: CLAIRE MCEACHERN,
University of California, Los Angeles

JAMES E. BERG, Iowa State University
PAULA S. BERGGREN, Baruch College, CUNY
CHRISTY DESMET, University of Georgia
PHYLLIS GORFAIN, Oberlin College
FRANCES L. HELPHINSTINE, Morehead State University

MICHAEL HOLOHAN, Southern Methodist University
JUDIANA LAWRENCE, Saint John Fisher College
JENNIFER LEWIN, Sewanee-University of the South
JOSEPH A. PORTER, Duke University
LAWRENCE A. RHU, University of South Carolina

Seminar: Anatomizing the Renaissance

Cambridge

Leader: SHANNON MILLER,
Temple University

DAVID BAKER, University of Hawaii
MATTHEW GREENFIELD, Staten Island College, CUNY
SARA MORRISON, University of Colorado, Boulder

DUKE PESTA, Ursinus College
JONATHAN SAWDAY, University of Strathclyde
SHERYL SAWIN, University of North Carolina, Asheville

Seminar: Corruptible Bodies

Trinity

Leader: SIMON MORGAN-RUSSELL,
Bowling Green State University

KATIE KALPIN, University of California, Davis
ROBERT ORMSBY, University of Toronto
KAARA L. PETERSON, Boston University

TRACEY TOMLINSON, Yale University
DOUGLAS TREVOR, University of Iowa

Seminar: Working Women/Women's Work: The Role of the Working Woman in Shakespeare's England

Dupont

Leaders: PETER AYERS, Memorial University of Newfoundland
LINDA VECCHI, Memorial University of Newfoundland

MARTHA J. CRAIG, Bradley University
MICHELLE M. DOWD, Columbia University

TOM RUTTER, University College, London

Seminar: New Economic Criticism

Escorial & Alhambra

Leader: LINDA WOODBRIDGE,
Pennsylvania State University

POMPA BANERJEE, University of Colorado, Denver
SHARON A. BEEHLER, Montana State University, Bozeman
BARBARA CORRELL, Cornell University
ROBERT DARCY, University of Wisconsin-Madison
VALERIE FORMAN, Ball State University
GRAHAM HAMMILL, University of Notre Dame
DAVID HAWKES, Lehigh University
JESSE M. LANDER, University of Notre Dame
MICHAEL L. LEMAHIEU, University of Wisconsin-Madison

KATHARINE EISAMAN MAUS, University of Virginia
STEVE MENTZ, Iona College
MARK NETZLOFF, University of Wisconsin-Milwaukee
TERESA NUGENT, University of Colorado, Boulder
CURTIS PERRY, Arizona State University, Tempe
SCOTT CUTLER SHERSHOW, Miami University (Ohio)
ERIC V. SPENCER, Albertson College (Idaho)
DANIEL J. VITKUS, Florida State University
LUKE WILSON, Ohio State University

8:00 p.m.

Performance:

Much Ado About Nothing

Directed by MATTHEW T. GITKIN

Ring Theatre, University of Miami

Given the large number of people wishing to attend the performance of *Much Ado About Nothing*, the University of Miami's Office of the Executive Vice President and Provost has agreed to provide buses to transport theater-goers.

Buses marked "Carey Club Limousine" will pick up theater-goers in front of the Hotel Inter-Continental at 7:00 p.m.

Buses will return to the hotel at approximately 11:00 p.m.

Saturday, 14 April

8:00 a.m. to 12:30 p.m.

Information
Mezzanine Level

Exhibits
Mezzanine East

9:00 to 10:30 a.m.

Paper Session: Middleton: Men, Women, and Money

Trianon

Chair: SUSAN FRYE, University of Wyoming

VALERIE WAYNE, University of Hawaii

A Genealogy of Marital Impostures: Middleton, Mary Carlton, Aphra Behn

JOHN JOWETT, The Shakespeare Institute, University of Birmingham

Middleton and Debt in *Timon of Athens*

GARY L. TAYLOR, University of Alabama

Middleton in Bed

Paper Session: Beyond Branagh: New Screen Shakespeare

Chopin

Chair: KENNETH S. ROTHWELL, University of Vermont

Lisa S. Starks, University of South Florida

Powers of Horror in Julie Taymor's *Titus*

DOUGLAS M. LANIER, University of New Hampshire

Shakescorp Noir

DONALD HEDRICK, Kansas State University

Shakespace, or the Cultural Logic of Late Shakespeareanism

10:30 to 11:00 a.m.

Morning Break; coffee served

11:00 a.m. to 12:30 p.m.

Paper Session: Antiquarianisms: Past, Present, Future

Trianon

Chair: NATASHA KORDA, Wesleyan University

HENRY S. TURNER, University of Wisconsin, Madison

The Limits of Antiquarianism: The Example of Thomas Nashe

JONATHAN GIL HARRIS, Ithaca College

Shakespeare's Hair: Staging the Object of Material Culture

HUGH GRADY, Beaver College

Is 'Presentist' Historicism an Oxymoron?

Paper Session: Making Electronic Shakespeares

Chopin

Chair: IAN LANCASHIRE, University of Toronto

JESSICA HODGE, Ardenonline

Electronic Shakespeares: Identifying Needs and Saving Trees

MICHAEL BEST, University of Victoria

Seeking Simplicity in Multiplicity:

Exploring Space in the Electronic Text

GREGORY R. CRANE, Tufts University

The Variorum Idea in a Digital World

12:30 to 2:00 p.m.

Lunch Break

World Shakespeare Bibliography Business Meeting and Luncheon

Gather in the Front Lobby of the Inter-Continental Hotel

2:00 to 3:30 p.m.

**Paper Session: Shakespeare and Contemporary
Post-Colonial Drama**

Trianon

Chair: W. B. WORTHEN,
University of California, Berkeley

NANDI BHATIA, University of Western Ontario

Staging Shakespeare/ Reinventing Empire: The Shakespeare Wallah

ADRIAN KEIRNANDER, University of New England in Australia

Intestine Shocks or Shakespeare's Other Eden: The Bell Shakespeare Company's
Australian *Henry IV* and *Henry V*

JOANNE THOMPSON, University of Queensland, Australia

Intercultural Shakespeare: Ong Keng Sen's *Lear* and *Desdemona* and the
Reconfiguration of Asian Identities

**Paper Session: Shakespearean Tragedy Revisited:
*Hamlet, Lear, Bradley***

Chopin

Chair: PEGGY ENDEL, Florida International University

HEATHER HIRSCHFELD, University of Tennessee, Knoxville
Hamlet's 'First Cors': Revenge, Trauma, and Typology

WILLIAM O. SCOTT, University of Kansas

Contracts of Love and Affection: Reading *Lear* Against the Grain

PETER J. HOLBROOK, University of Queensland
Shakespeare as a Force for Good

4:00 to 6:00 p.m.

**Seminar: Early Modern English Texts
and the History of Sexuality**

Tuttle

Leader: REBECCA ANN BACH
University of Alabama, Birmingham

HARRIETTE ANDREADIS, Texas A & M University
DOUGLAS BROOKS, Texas A & M University
WILLIAM FISHER, Lehman College, CUNY
MICHAEL HALL, Virginia Wesleyan College
TERESA LYLE, Independent Scholar

NICHOLAS F. RADEL, Furman University
SID RAY, Pace University
CONSTANCE C. RELIHAN, Auburn University
DENISE WALEN, Vassar College
ROBERT N. WATSON, University of California, Los Angeles

Seminar: Girls in the 'Hood

Balmoral

Leaders: LYNDA E. BOOSE, Dartmouth College
CATHERINE LOOMIS, University of New Orleans

MARY BLY, Fordham University
PAMELA ALLEN BROWN, University of Connecticut
SARA EATON, North Central College
JOHN R. FORD, Delta State University
LOREEN L. GIESE, Ohio University
RICHARD W. GRINNELL, Marist College

LISA MARTINEZ LAJOUS, University of Pennsylvania
KRISTIN LUCAS, McGill University
PATRICIA PHILLIPPY, Texas A & M University
CAROLYN SALE, Stanford University
CRISTINE M. VARHOLY, John Jay College of Criminal
Justice, CUNY

Seminar: Shakespeare on Film: An Electronic Seminar

Gusman

Leader: PETER S. DONALDSON,
Massachusetts Institute of Technology

HARDY M. COOK, Bowie State University
MIMI DIXON, Wittenberg University
DAVID KRANZ, Dickinson College
MARK LAWHORN, University of Hawaii

MICHAEL MULLIN, University of Illinois
THOMAS A. PENDLETON, Iona College
AMY SCOTT-DOUGLASS, California State University, Fullerton
SUSANNE WOFFORD, University of Wisconsin, Madison

Workshop: Literacies/Identities in Early Modern England

Windsor

Leaders: MARGARET W. FERGUSON, University of California, Davis
EVE RACHELE SANDERS, Concordia University, Montréal

PATRICIA BADIR, University of British Columbia
FRANCES BARASCH, Baruch College, CUNY
BIANCA F.-C. CALABRESI, Kenyon College
SUSAN FITZMAURICE, Northern Arizona University
HEIDI BRAYMAN HACKEL, Oregon State University
JENNIFER HELLWARTH, Allegheny College
MARY ELLEN LAMB, Southern Illinois University

IAN FREDERICK MOULTON, Arizona State University
STEPHEN ORGEL, Stanford University
ELIZABETH RIVLIN, University of Wisconsin-Madison
SASHA ROBERTS, University of Kent, Rutherford
JUDITH ROSE, Allegheny College
JANET WRIGHT STARNER, Wilkes University
JENNIFER SUMMIT, Stanford University

Seminar: Shakespeare and Latinities

Marti

Leader: ROLAND GREENE,
Stanford University

SIRLEI SANTOS CAMPOS, Universidade Federal de Viçosa
NINA CHORDAS, University of Oregon
RAPHAEL FALCO, University of Maryland, Baltimore
County

JOHN W. VELZ, University of Texas, Austin
MEREDITH WEBB, University of Oregon

Seminar: *Titus* in Our Time

Raphael

Leader: HEATHER JAMES, University of Southern California

RICHARD BRUCHER, University of Maine
DOUGLAS BRUSTER, University of Texas, Austin
THOMAS CARTELLI, Muhlenberg College
VICTORINE DAIGRE, Georgia Southern University
EVELYN GAJOWSKI, University of Nevada, Las Vegas
BRADLEY GREENBURG, Ithaca College

DAVID MCCANDLESS, Carleton College
NICK MOSCHOVAKIS, University of the South
BARBARA PARKER, William Paterson University
KATHERINE ROWE, Bryn Mawr College
AYANNA TENE THOMPSON, Harvard University

Seminar: Acting Companies

Escorial & Alhambra

Leaders: SCOTT McMILLIN, Cornell University
SALLY-BETH MACLEAN, University of Toronto

MARK BAYER, Ohio State University
EMILY BRYAN, Northwestern University
RICHARD DUTTON, Lancaster University
JAMES H. FORSE, Bowling Green State University
ED GIESKES, University of South Carolina
PETER GREENFIELD, University of Puget Sound
ANDREW GURR, University of Reading / Shakespeare's Globe
WILLIAM INGRAM, University of Michigan

ROSLYN L. KNUTSON, University of Arkansas, Little Rock
ANNE LANCASHIRE, University of Toronto
LAWRENCE MANLEY, Yale University
JAMES MARDOCK, University of Wisconsin-Madison
ALAN H. NELSON, University of California, Berkeley
BARBARA D. PALMER, Mary Washington College
PETER R. ROBERTS, University of Kent, Canterbury
RHONDA LEMKE SANFORD, Fairmont State College
ELZA C. TINER, Lynchburg College

Seminar: Spanish Culture and the Early Modern English Imaginary

Cambridge

Leader: OLGA VALBUENA, Wake Forest University

ERIC GRIFFIN, Millsaps College
IMTIAZ HABIB, Old Dominion University
CHRISTINE R. HUTCHINS, East Carolina University
ELENA LEVY-NAVARRO, University of Wisconsin, Whitewater

ANDREA SOLOMON, Columbia University
DOLORA CHAPELLE WOJCIEHOWSKI, University of Texas, Austin

Seminar: Editing Early Modern Playtexts: Theory and Practice

Trinity

Leader: PAUL WERSTINE, King's College, University of Western Ontario

JAMES HIRSH, Georgia State University
RICHARD A. J. KNOWLES, University of Wisconsin, Madison
CAMPBELL LATHEY, Independent Scholar

MEG POWERS LIVINGSTON, Pennsylvania State University, Altoona
BARBARA A. MOWAT, Folger Shakespeare Library
KAROLINE SZATEK, University of Massachusetts, Dartmouth

Seminar: The Pleasures of Patterns

Michelangelo

Leader: MARK WOMACK, University of Texas, San Antonio

STEPHEN BOOTH, University of California, Berkeley
ANTHONY BURTON, Amherst, Massachusetts
PETER CUMMINGS, Hobart and William Smith Colleges
ELINA HUHTIKANGAS, University of Helsinki
JEREMY LOPEZ, Cornell University

LALITA PANDIT, University of Wisconsin, La Crosse
ALBERT PRINCE, Marietta College
EDMUND M. TAFT, Marshall University
GEORGE T. WRIGHT, University of Minnesota

Seminar: Orality, Print, Performance

Sandringham

Leader: W. B. WORTHEN, University of California, Berkeley

MARY BLACKSTONE, University of Regina
MITA CHOUDHURY, Georgia Institute of Technology
ANTHONY B. DAWSON, University of British Columbia
BARBARA HODGDON, Drake University
LINC KESLER, Oregon State University
JOE LENZ, Drake University

ERIC MASON, Florida Atlantic University
JEFFREY MASTEN, Northwestern University
IAN MUNRO, University of Alberta
LAURIE E. OSBORNE, Colby College
BRYAN REYNOLDS, University of California, Irvine
RICHARD SCHOCH, Queen Mary, University of London

6:00 to 6:30 p.m.

Late Afternoon Break

7:00 p.m.

Buses marked "Millennium Motorcoaches" will pick up theater-goers to *Shakespeare's Journey* in front of the Hotel Inter-Continental

8:00 p.m.

Performance: *Shakespeare's Journey*

Written and directed by LEROY CLARK

*Wertheim Performance Arts Center, Main Stage
Florida International University*

Vans will return passengers to the Hotel Inter-Continental at approximately 10:00 p.m., after the post-performance discussion

10:00 p.m. to 1:00 a.m.

The Dance

Bayfront A & B

Sponsored by the SHAKESPEARE ASSOCIATION OF AMERICA and the MALONE SOCIETY

Tickets available at the door

Participants in the 29th Annual Meeting

Sylvia Adamson, University of Manchester
Denise Albanese, George Mason University
Harriette Andreadis, Texas A & M University
James R. Andreas, Sr., Florida International University
Roger Apfelbaum, Seton Hall University
John Michael Archer, University of New Hampshire
Alan Armstrong, Southern Oregon University
Margaret J. Arnold, University of Kansas
Peter Ayers, Memorial University of Newfoundland

Rebecca Ann Bach, University of Alabama, Birmingham
Patricia Badir, University of British Columbia
David J. Baker, University of Hawaii
Pompa Banerjee, University of Colorado, Denver
Frances K. Barasch, Baruch College, CUNY
Debbie Barrett-Graves, The College of Santa Fe
Mark Bayer, Ohio State University
Wendy M. Beaver, Rollins College
James P. Bednarz, Long Island University
Sharon A. Beehler, Montana State University, Bozeman
Marlo M. Belschner, St. Cloud State University
Sean Benson, Malone College
Peter Berek, Mount Holyoke College
James E. Berg, Iowa State University
Thomas L. Berger, St. Lawrence University
Harry Berger, Jr., University of California, Santa Cruz
David M. Bergeron, University of Kansas
Paula S. Berggren, Baruch College, CUNY
Philippa Berry, King's College, Cambridge University
Michael Best, University of Victoria
David M. Bevington, University of Chicago
Nandi Bhatia, University of Western Ontario
Eric A. Binnie, Hendrix College
James W. Binns, University of York
Mary A. Blackstone, University of Regina
Carol Blosser, University of Texas, Austin
Mary Bly, Fordham University
Russell J. Bodi, Owens College
Lynda E. Boose, Dartmouth College
Stephen Booth, University of California, Berkeley
Katherine Bootle, University of Virginia
Dominica Borg, Dartmouth College
Edna Z. Boris, LaGuardia Community College, CUNY
Anston Bosman, Amherst College
Terri Bourus, Northern Illinois University
Barbara Bowen, Queen's College, CUNY
A. Robin Bowers, Plymouth State College

David G. Brailow, McKendree College
Curtis Bright, University of Pittsburgh
Jean R. Brink, Arizona State University
Pope Brock, Chappaqua, New York
Douglas A. Brooks, Texas A & M University
A. R. Braunnmuller, University of California, Los Angeles
Jody D. Brown, Ferrum College
Pamela Allen Brown, University of Connecticut
Richard Brucher, University of Maine
Douglas Bruster, University of Texas at Austin
Emily D. Bryan, Northwestern University
Paul Budra, Simon Fraser University
Irene S. Burgess, Wheeling Jesuit University
Anthony Burton, Amherst, Massachusetts
Rebecca Bushnell, University of Pennsylvania

Patricia A. Cahill, Emory University
Bianca F.-C. Calabresi, Kenyon College
Ellen M. Caldwell, Kalamazoo College
Sirlei Santos Campos, Universidade Federal de Vicosá
Catherine G. Canino, University of South Carolina, Spartanburg
John A. Carpenter, University of South Carolina
Thomas P. Cartelli, Muhlenberg College
Annalisa Castaldo, Temple University
Joseph R. Chaney, Indiana University, South Bend
Maurice Charney, Rutgers University
Nina Chordas, University of Oregon
Mita Choudhury, Georgia Institute of Technology
Ann C. Christensen, University of Houston
Nels A. Christensen, Michigan State University
Peter G. Christensen, Cardinal Stritch University
Judith Petterson Clark, Stephens College
Christopher Cobb, North Carolina State University
Philip D. Collington, Niagara University
Michael J. Collins, Georgetown University
Katherine Conway, Wheaton College
Ann Jennalie Cook, Vanderbilt University
Dorothy Cook, Central Connecticut State University
Hardy M. Cook, Bowie State University
Wayne Cook, Central Connecticut State University
Barbara Correll, Cornell University
John D. Cox, Hope College
Martha J. Craig, Bradley University
Katharine Craik, University College, London
Gregory R. Crane, Tufts University
Julie Crawford, Columbia University
Jonathan V. Crewe, Dartmouth College
Holly A. Crocker, Saint Lawrence University
Robert Crosman, University of Alaska, Anchorage
J. Clinton Crumley, Providence Day School, Charlotte

Peter Cummings, Hobart and William Smith Colleges
Dolora G. Cunningham, San Francisco State University
Karen Cunningham, University of California, Los Angeles
Deborah T. Curren-Aquino, Folger Shakespeare Library

Victorine E. Daigre, Georgia Southern University
Robert Darcy, University of Wisconsin, Madison
Anthony B. Dawson, University of British Columbia
Martha Dawson, Florida Memorial College
Geraldo U. de Sousa, Xavier University
Sara Munson Deats, University of South Florida
Maureen DesRoches, Marygrove College
Christy Desmet, University of Georgia
Alan C. Dessen, University of North Carolina, Chapel Hill
Emily Detmer-Goebel, Millikin University
Mimi Still Dixon, Wittenberg University
Frances E. Dolan, Miami University, Ohio
Peter S. Donaldson, Massachusetts Institute of Technology
Michelle M. Dowd, Columbia University
Annette Drew-Bear, Washington and Jefferson College
M. Judith Dunbar, Santa Clara University
Richard Dutton, Lancaster University

Sara Eaton, North Central College
Mark Edmundson, University of Virginia
Katherine Eggert, University of Colorado, Boulder
Jeremy Ehrlich, Folger Shakespeare Library
Milissa Ellison-Murphree, University of West Georgia
Peggy Endel, Florida International University
Lars Engle, University of Tulsa
Lynn Enterline, Vanderbilt University
Michelle Ephraim, Worcester Polytechnic Institute
Lukas Erne, University of Geneva
Kevin Ewert, University of Pittsburgh, Bradford

Raphael Falco, University of Maryland, Baltimore County
Margaret W. Ferguson, University of California, Davis
Ewan Fernie, Queen's University, Belfast
Janet Field-Pickering, Folger Shakespeare Library
William Fisher, Lehman College, CUNY
James Fitzmaurice, Northern Arizona University
Margaret Fitzmaurice, University of California, Davis
Susan Fitzmaurice, Northern Arizona University
Mary Floyd-Wilson, Yale University

Stephen Merriam Foley, Brown University
John R. Ford, Delta State University
Valerie Forman, Ball State University
James H. Forse, Bowling Green State University
Cora Fox, Marquette University
Mary Free, Florida International University
Barbara Freedman, Tufts University
William W. French, West Virginia University
Michael D. Friedman, University of Scranton
Susan Frye, University of Wyoming

Evelyn Gajowski, University of Nevada, Las Vegas
Lowell Gallagher, University of California, Los Angeles
David L. Gants, University of Georgia
Gayle Gaskill, College of St. Catherine
Stephannie Gearhart, Lehigh University
George L. Geckle, University of South Carolina
C. J. Gianakaris, Western Michigan University
Loreen L. Giese, Ohio University
Edward Gieskes, University of South Carolina
Miriam Gilbert, University of Iowa
John Gillies, University of Essex
Lisa Gim, Fitchburg State College
David Goldstein, Stanford University
Michael Gooch, DeVry Institute of Technology
Katharine Goodland, Staten Island College, CUNY
Phyllis Gorfain, Oberlin College
Melinda Gough, Oklahoma State University
Hugh Grady, Beaver College
Douglas E. Green, Augsburg College
Juana Green, Clemson University
Bradley Greenburg, Ithaca College
Roland Greene, Stanford University
Peter H. Greenfield, University of Puget Sound
Sayre N. Greenfield, University of Pittsburgh at Greensburg
Thelma N. Greenfield, University of Oregon
Matthew Greenfield, Staten Island College, CUNY
Eric Griffin, Millsaps College
Richard W. Grinnell, Marist College
Andrew Gurr, University of Reading / Shakespeare's Globe

Imtiaz Habib, Old Dominion University
Heidi Brayman Hackel, Oregon State University
Grace R. W. Hall, Massachusetts Institute of Technology
Michael Hall, Virginia Wesleyan College
Richard Halpern, University of California, Berkeley
Donna B. Hamilton, University of Maryland, College Park
Graham Hammill, University of Notre Dame
Elizabeth Hanson, Queen's University
Melanie Ann Hanson, University of Nevada - Las Vegas

James L. Harner, Texas A & M University
Jonathan Gil Harris, Ithaca College
Andrew James Hartley, State University of West Georgia

David Hawkes, Lehigh University
Donald Hedrick, Kansas State University
Jennifer Wynne Hellwarth, Allegheny College
Frances L. Helphinstine, Morehead State University

Kirk Hendershott-Kraetzer, Olivet College
Margo Hendricks, University of California, Santa Cruz

Niels Herold, Oakland University
James Hirsh, Georgia State University
Heather Hirshfeld, University of Tennessee, Knoxville

Barbara Hodgdon, Drake University
Jessica Hodge, The Arden Shakespeare
Michael Holahan, Southern Methodist University
Peter J. Holbrook, University of Queensland
Sue McCurdy Hosterman, University of Tulsa
Jean E. Howard, Columbia University
Elina Huhtikangas, University of Helsinki
Deborah Human, Eastern Connecticut State University
Christine E. Hutchins, East Carolina University

William Ingram, University of Michigan
Susan B. Iwanisziw, Philadelphia, Pennsylvania
Sujata Iyengar, University of Georgia

Heather James, University of Southern California
Margo Jefferson, *The New York Times*
Gloria Johnson, University of Oregon
John Jowett, The Shakespeare Institute, University of Birmingham

Rhoda S. Kachuck, University of La Verne
Katie Kalpin, University of California, Davis
David Kathman, Morningstar, Chicago
W. David Kay, University of Illinois, Urbana-Champaign
Theresa D. Kemp, University of Wisconsin, Eau Claire

Gwynne Kennedy, University of Wisconsin - Milwaukee
William Kerwin, University of Missouri, Columbia
Linc Kesler, Oregon State University
Harry Keyishian, Fairleigh Dickinson University
Marjorie Keyishian, Fairleigh Dickinson University

Dennis Dean Kezar, Vanderbilt University
M. J. Kidnie, South Bank University
Adrian Kiernander, University of New England in Australia

Margaret Knapp, Arizona State University
Richard Paul Knowles, University of Guelph
Richard A. J. Knowles, University of Wisconsin, Madison

Roslyn L. Knutson, University of Arkansas at Little Rock
Natasha Korda, Wesleyan University
David L. Kranz, Dickinson College

Lisa Martinez Lajous, University of Pennsylvania
Mary Ellen Lamb, Southern Illinois University
Anne Lancashire, University of Toronto
Ian Lancashire, University of Toronto
Jesse M. Lander, University of Notre Dame
Douglas M. Lanier, University of New Hampshire
Campbell Lathey, Albany, New York
Mark H. Lawhorn, University of Hawaii
Judiana Lawrence, Saint John Fisher College
Courtney Lehmann, University of the Pacific
Gordon Lell, Concordia College
Michael L. LeMahieu, University of Wisconsin, Madison

Rebecca Lemon, University of Southern California
Lagretta T. Lenker, University of South Florida
Joe Lenz, Drake University
Kate D. Levin, City College, CUNY
Nina Levine, University of South Carolina
Elena Levy-Navarro, University of Wisconsin - Whitewater
Jennifer Lewin, Sewanee - University of the South

Cynthia Lewis, Davidson College
Erika T. Lin, University of Pennsylvania
David Linton, Marymount Manhattan College
Joan Pong Linton, Indiana University
William T. Liston, Ball State University
Meg Powers Livingston, Pennsylvania State University, Altoona
James N. Loehlin, University of Texas, Austin
Donna J. Long, Fairmont State College
Kristi Long, Palgrave / Saint Martin's Press
Catherine Loomis, University of New Orleans
Jeremy Lopez, Cornell University
Eric David Loring, Scottsdale Community College
Genevieve Love, Cornell University
Jennifer Low, Florida Atlantic University
Kristin Lucas, McGill University
Christina Luckyj, Dalhousie University
Teresa Lyle, Atlanta, Georgia
Sarah Lyons, Boston University

Sally-Beth MacLean, University of Toronto
Lynne Magnusson, Queen's University, Canada
Lawrence Manley, Yale University
James Mardock, University of Wisconsin - Madison

James J. Marino, Stanford University
Cynthia Marshall, Rhodes College
Eric D. Mason, Florida Atlantic University
Jeffrey Masten, Northwestern University
Jennifer Goldfarb Matisoff, Lehigh University

Margaret Maurer, Colgate University
Katharine Eisaman Maus, University of Virginia
Susan N. Mayberry, Alfred University
Cary M. Mazer, University of Pennsylvania
David McCandless, Carleton College
Russ McDonald, University of North Carolina, Greensboro
Lisa J. McDonnell, Denison University
Claire McEachern, University of California, Los Angeles

C. Edward McGee, St. Jerome's College, University of Waterloo
Rex McGuinn, Phillips Exeter Academy
Scott McMillin, Cornell University
Kathryn R. McPherson, Utah Valley State College
Paula McQuade, DePaul University
Kirk Melnikoff, Boston University
Steve Mentz, Iona College
Paul D. Menzer, University of Virginia
Sheri Metzger, University of New Mexico
David L. Middleton, Trinity University
Shannon Miller, Temple University
Kathryn M. Moncrief, Washington College
Edward M. Moore, Grinnell College
John Morgan, Ryerson Polytechnic University, Toronto
Simon Morgan-Russell, Bowling Green State University

Sara Morrison, University of Colorado, Boulder
Nicholas R. Moschovakis, University of the South
Ian Frederick Moulton, Arizona State University West
Barbara A. Mowat, Folger Shakespeare Library
Michael Mullin, University of Illinois, Urbana-Champaign
Richelle Munkhoff, Stanford University
Ian Munro, University of Alberta
Patrick M. Murphy, SUNY, Oswego
Andrew Murphy, University of St. Andrews

Randall Nakayama, San Francisco State University
Alan H. Nelson, University of California, Berkeley
Mark Netzloff, University of Wisconsin - Milwaukee
Lori Humphrey Newcomb, University of Illinois - Urbana
Louisa Foulke Newlin, Folger Shakespeare Library
Karen Newman, Brown University
Kelly Newman, Montgomery Blair High School
Marianne Novy, University of Pittsburgh
Teresa Nugent, University of Colorado, Boulder

Susan Gushee O'Malley, CUNY, Kingsborough
Stephen Orgel, Stanford University
Agnes Ormsby, University of Toronto

Robert Ormsby, University of Toronto
Laurie E. Osborne, Colby College

Barbara D. Palmer, Mary Washington College
Lalita Pandit, University of Wisconsin, La Crosse
Jennifer Panek, Harvard University
Barbara L. Parker, William Paterson University
Gail Kern Paster, George Washington University
Thomas A. Pendleton, Iona College
Curtis Perry, Arizona State University, Tempe
J. Duke Pesta, Ursinus College
Kaara L. Peterson, Boston University
Patricia Phillippy, Texas A & M University
Jill Phillips, University of Virginia
Robert B. Pierce, Oberlin College
Melanie Pitts, University of Miami
Marie A. Plasse, Merrimack College
Tanya Pollard, Macalester College
Kristen Elizabeth Poole, University of Delaware

Joseph A. Porter, Duke University
Lois Potter, University of Delaware
Paul Prescott, The Shakespeare Institute
Arnold W. Preussner, Truman State University
Irina S. Prikhod'ko, Bucknell University
Albert Prince, Marietta, Ohio
Alison H. Prindle, Otterbein College
Dennis J. Prindle, Ohio Wesleyan University

Karen L. Raber, University of Mississippi
Nicholas F. Radel, Furman University
Richard Rambuss, Emory University
Stephen Ratcliffe, Mills College
Sid Ray, Pace University
Terry J. Reilly, University of Alaska, Fairbanks
Constance C. Relihan, Auburn University
Bryan Reynolds, University of California, Irvine
Lawrence A. Rhu, University of South Carolina
Raymond J. Rice, University of Maine, Presque Isle

Elizabeth Rivlin, University of Wisconsin - Madison
Joseph Roach, Yale University
Peter R. Roberts, University of Kent, Canterbury
Sasha Roberts, University of Kent, Rutherford
Karen Robertson, Vassar College
Judith Rose, Allegheny College
Melanie Ross, DeVry Institute of Technology
Kenneth S. Rothwell, University of Vermont
Katherine Rowe, Bryn Mawr College
Jacalyn Royce, University of Puget Sound
David A. Ruitter, University of Texas, El Paso
Anne Russell, Wilfrid Laurier University
Peggy A. Russo, Pennsylvania State University
Tom Rutter, University College, London

Carolyn Sale, Stanford University
Brownell Salomon, Bowling Green State University

Eve Rachele Sanders, Concordia University, Montréal
 Rhonda Lemke Sanford, Fairmont State College
 Jonathan Sawday, University of Strathclyde
 Sheryl Sawin, University of North Carolina, Asheville
 Katherine West Scheil, University of Rhode Island
 Richard Schoch, Queen Mary, University of London
 Kathryn Schwarz, Vanderbilt University
 William O. Scott, University of Kansas
 Amy Scott-Douglass, California State University, Fullerton
 Laurie Shannon, Duke University
 Scott Cutler Shershow, Miami University (Ohio)
 Jeffrey Shoulson, University of Miami
 Jerome E. Singerman, University of Pennsylvania Press
 Meredith Skura, Rice University
 Jessica Slights, Acadia University
 Bruce R. Smith, Georgetown University
 Molly E. Smith, Stephen F. Austin University
 M. Rick Smith, Kent State University, Trumbull
 Ian D. Smith, Lafayette College
 Peter J. Smith, Nottingham Trent University
 Susan Snyder, Swarthmore College
 Julie Robin Solomon, American University
 Andrea Solomon, Columbia University
 Steven Sowell, University of Miami
 Eric V. Spencer, Albertson College (Idaho)
 Janet M. Spencer, Wingate University
 Audrey E. Stanley, University of California, Santa Cruz
 Kay Stanton, California State University, Fullerton
 Sarah Stanton, Cambridge University Press
 Lisa S. Starks, University of South Florida
 Janet Wright Starnier, Wilkes University
 Dot Stetson, Florida International University
 Alan Stewart, Birkbeck, University of London
 Jan Stirm, University of Wisconsin, Eau Claire
 Paul V. Sullivan, University of Texas, Austin
 Jennifer Summit, Stanford University
 James M. Sutton, Florida International University
 Mihoko Suzuki, University of Miami
 Jesse G. Swan, University of Northern Iowa
 Karoline Szatek, University of Massachusetts, Dartmouth
 Edmund M. Taft, Marshall University
 Gary L. Taylor, University of Alabama
 Frances Teague, University of Georgia
 Joanne Thompkins, University of Queensland, Australia
 Ayanna Tene Thompson, Harvard University
 Leslie Thomson, University of Toronto

Amy Tigner, Stanford University
 Denise Tillery, Oklahoma State University
 Elza C. Tiner, Lynchburg College
 Tracey E. Tomlinson, Yale University
 Lidiya Tonic, DeVry Institute of Technology
 Barbara Traister, Lehigh University
 Douglas Trevor, University of Iowa
 Marion Trousdale, University of Maryland, College Park
 Henry S. Turner, University of Wisconsin, Madison

Deborah Uman, Eastern Connecticut State University
 Steven Urkowitz, City University of New York

Olga L. Valbuena, Wake Forest University
 Cristine M. Varhol, John Jay College of Criminal Justice, CUNY
 Linda Vecchi, Memorial University of Newfoundland
 John W. Velz, University of Texas, Austin
 Daniel J. Vitkus, Florida State University

Denise A. Walen, Vassar College
 Wendy Wall, Northwestern University
 Melissa E. Walter, University of Wisconsin, Madison
 Michael Warren, University of California, Santa Cruz
 John M. Wasson, Washington State University
 Robert N. Watson, University of California, Los Angeles

Valerie Wayne, University of Hawaii
 Meredith Webb, University of Oregon
 Robert Weimann, University of California, Irvine
 Sarah Werner, George Washington University
 Paul Werstine, King's College, University of Western Ontario

Suzanne R. Westfall, Lafayette College
 Frank Whigham, University of Texas, Austin
 Paul Whitfield White, Purdue University
 Charles Whitney, University of Nevada, Las Vegas
 Brent Whitted, Marlborough School
 Gary Jay Williams, Catholic University of America
 Luke Wilson, Ohio State University
 Eric Wilson, Washington and Lee University
 Susanne L. Wofford, University of Wisconsin, Madison

Dolora Chapelle Wojciehowski, University of Texas - Austin
 Mark Womack, University of Texas, San Antonio
 Linda Woodbridge, Pennsylvania State University
 W. B. Worthen, University of California, Berkeley
 George T. Wright, University of Minnesota

Julian Yates, University of Delaware

New from palgrave

Visit us at our table!



SHAKESPEARE, FILM, FIN DE SIECLE

Edited by Mark Thornton Burnett and Ramona Wray
 242 pp. / 0-312-23148-2 / \$42.00 cl.

SHAKESPEARE, FEMINISM AND GENDER

Edited by Kate Chedgzoy
 279 pp. / 0-333-71652-3 / \$18.95 pb.
 New Casebooks

TRAVEL KNOWLEDGE

European "Discoveries" in the Early Modern Period
 Edited by Ivo Kamps and Jyotsna Singh
 288 pp. / 0-312-22299-8 / \$19.95 pb.

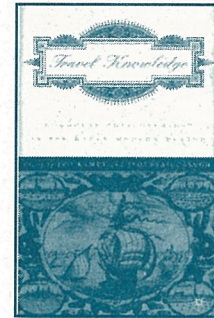

SHAKESPEARE: TEXTS AND CONTEXTS

Edited by Kiernan Ryan
 344 pp. / 0-312-23036-2 / \$24.95 pb.

SHAKESPEARE

The Tragedies
 John Russell Brown
 April / 380 pp. / 0-333-58956-4 / \$29.95 cl.

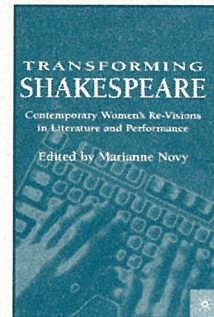

SHAKESPEARE 1609

Cymbeline and the Sonnets
 Edited by Richard Danson Brown and David Johnson
 176 pp. / 0-312-23038-9 / \$24.95 pb.

SHAKESPEARE WITHOUT CLASS

Misappropriations of Cultural Capital
 Edited by Donald K. Hedrick and Bryan Reynolds
 304 pp. / 0-312-22271-8 / \$49.95 cl.

COLONIAL TRANSFORMATIONS

The Cultural Production of the New Atlantic World, 1580-1640
 Rebecca Ann Bach
 304 pp. / 0-312-23099-0 / \$49.95 cl.

NOW IN PAPERBACK!

TRANSFORMING SHAKESPEARE

Contemporary Women's Re-Visions in Literature and Performance
 Marianne Novy
 272 pp. / 0-312-23509-7 / \$18.95 pb.

CHAUCER TO SHAKESPEARE, 1337-1580

SunHee Kim Gertz
 260 pp. / 0-333-72199-3 / \$19.95 pb.
 Transitions

palgrave

Global Publishing at
 St. Martin's Press

1-800-221-7945 ext. 270
 www.palgrave-usa.com

NEW TITLES IN SHAKESPEARE & RENAISSANCE STUDIES FROM ROUTLEDGE

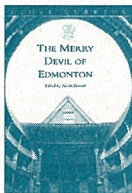

NOW IN PAPERBACK FROM THE SHAKESPEARE CRITICISM SERIES

Series Edited by Philip C. Kolin

SHAKESPEARE SONNETS
Critical Essays
Edited by James Schiffer

LOVE'S LABOUR'S LOST
Critical Essays
Edited by Felicia Hardison Londre

A MIDSUMMER NIGHT'S DREAM
Critical Essays
Edited by Dorothea Kehler

NEW IN ACCENTS ON SHAKESPEARE SERIES

Series Edited by Terence Hawkes

PHILOSOPHICAL SHAKESPEARES
Edited by John J. Joughin

MARXIST SHAKESPEARES
Edited by Jean E. Howard & Scott Cutler Shershow

SHAKESPEARE AND MODERNITY
Early Modern to Millennium
Edited by Hugh Grady

SHAKESPEARE IN PSYCHOANALYSIS
Philip Armstrong

SHAKESPEARE AND MODERN THEATRE
The Performance of Modernity
Edited by Michael Bristol & Kathleen McLuskie

SHAKESPEARE AND FEMINIST PERFORMANCE
Ideology on Stage
Sarah Werner

ENTER THE BODY
Women and Representation on Shakespeare's Stage
Carol Chillington Rutter

WHO KILLED SHAKESPEARE?
What's Happened to English since the Radical Sixties
Patrick Brantlinger

THE RENAISSANCE COMPUTER
Knowledge Technology in the First Age of Print
Neil Rhodes & Jonathan Sawday

CASTRATION
An Abbreviated History of Western Manhood
Gary Taylor

NEW IN GLOBE QUARTOS SERIES

THE MERRY DEVIL OF EDMONTON
Anonymous
Edited by Nicola Bennett

THE ANTIPODES
Robert Brome

To see these and other fine books, please stop by the Routledge booth. 20% conference discount is available.

1 . 8 0 0 . 6 3 4 . 7 0 6 4



www.routledge-ny.com

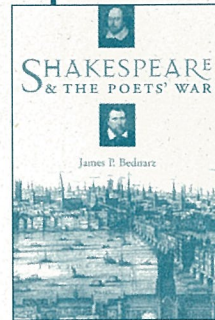

Shakespeare and the Poets' War
James Bednarz
266 pages • \$19.50 paper

Shakespeare on Love and Lust
Maurice Charney
248 pages • \$18.50 paper

Female and Male Voices in Early Modern England
An Anthology of Renaissance Writing
Edited by Betty S. Travitsky and Anne Lake Prescott
432 pages • \$17.50 paper • \$49.50 cloth

Turks, Moors, and Englishmen in the Age of Discovery
Nabil Matar
288 pages • \$14.50 paper • \$34.50 cloth

COLUMBIA CRITICAL GUIDES

Shakespeare: Richard II
Essays • Articles • Reviews
Edited by Martin Coyle
192 pages • \$14.50 paper

William Shakespeare: King Lear
Essays • Articles • Reviews
Edited by Susan Bruce
192 pages • \$15.50 paper

VISIT COLUMBIA UNIVERSITY PRESS

columbia.edu/cu/cup 800-944-8648 or 914-591-9111

UNIVERSITY OF NEBRASKA PRESS publishers of Bison Books www.nebraskapress.unl.edu

Quoting Shakespeare

Form and Culture in Early Modern Drama
By Douglas Bruster

"Bruster presents a timely and original analysis. *Quoting Shakespeare* makes an important and badly needed contribution to the field of early modern studies."

—Michael D. Bristol, author of *Big-Time Shakespeare*

In contrast to the New Historicism's sometimes arbitrary linkage of literary works with elements drawn from the surrounding culture, *Quoting Shakespeare* focuses on the resources that writers used in making their works. Bruster shows how this borrowing can give us valuable insight into the cultural, historical, and political positions of writers and their works. Because Shakespeare's plays have often been quoted by other writers, this study also examines what subsequent uses of Shakespeare's plays reveal about the writers and cultures that use them. In this way, *Quoting Shakespeare* insists that literary production and reception are both integral to a historical approach to literature.
\$50 cloth

"timely & original"

