



SHAKESPEARE
ASSOCIATION
OF AMERICA

PROGRAM OF THE
34TH ANNUAL MEETING

13-15 APRIL 2006

THE LOEWS HOTEL
PHILADELPHIA

shakespeare

The 34th Annual Meeting of The Shakespeare Association of America

Executive Director: LENA COWEN ORLIN
University of Maryland, Baltimore County

Assistant Director: MICHELE OSHEROW
University of Maryland, Baltimore County

President

WILLIAM C. CARROLL
Boston University

Vice-President

GEORGIANNA ZIEGLER
Folger Shakespeare Library

Trustees

FRANCES E. DOLAN
University of California, Davis

KIM F. HALL
Fordham University

ROSLYN L. KNUTSON
University of Arkansas at Little Rock

MARY ELLEN LAMB
Southern Illinois University

MARIANNE NOVY
University of Pittsburgh

GARRETT A. SULLIVAN, JR.
Pennsylvania State University

PAUL YACHNIN
McGill University

Program Planning

Chair: PAUL YACHNIN, McGill University
NATASHA KORDA, Wesleyan University
JEREMY LOPEZ, University of Toronto
VALERIE WAYNE, University of Hawai'i

Sponsors

ALLEGHENY COLLEGE
ARCADIA UNIVERSITY
BRYN MAWR COLLEGE
CHATHAM COLLEGE
CITY COLLEGE OF NEW YORK THEATRE DEPARTMENT
COLUMBIA UNIVERSITY
UNIVERSITY OF DELAWARE
DUQUESNE UNIVERSITY
LEHIGH UNIVERSITY
MUHLENBERG COLLEGE
NEW YORK UNIVERSITY
UNIVERSITY OF PENNSYLVANIA
PENNSYLVANIA STATE UNIVERSITY DEPARTMENT OF ENGLISH
PENNSYLVANIA STATE UNIVERSITY'S INSTITUTE FOR THE ARTS AND HUMANITIES
PITTSBURGH CONSORTIUM OF MEDIEVAL AND RENAISSANCE STUDIES
LITERATURE PROGRAM IN THE ENGLISH DEPARTMENT OF THE UNIVERSITY OF PITTSBURGH
PRINCETON UNIVERSITY DEPARTMENT OF ENGLISH
PRINCETON UNIVERSITY COUNCIL OF THE HUMANITIES
RUTGERS UNIVERSITY
TEMPLE UNIVERSITY
VILLANOVA UNIVERSITY
AND
UNIVERSITY OF MARYLAND, BALTIMORE COUNTY
UNIVERSITY OF MARYLAND, BALTIMORE COUNTY DEPARTMENT OF ENGLISH

Local Arrangements Directors

REBECCA BUSHNELL, University of Pennsylvania
MARGRETA DE GRAZIA, University of Pennsylvania

Conference Administration

Program Coordinator: LEE TYDINGS
With the Assistance of JACKIE HOPKINS and JULIE MORRIS

2006 Program Guide

Thursday, 13 April

10:00 a.m.	Registration opens in Regency Foyer, Second Mezzanine	6
12:00 noon	Exhibits open in Regency Ballroom C	6
1:30 p.m.	Roundtable in Regency Ballroom B: Drafting Shakespeare: The Military Theater	6 6
	Paper Session in Millennium Hall: Risky Business: Early Modern England and Global Trade	6 6
3:30 p.m.	Seminar in Congress Room C: The Shakespearean Idiom	6
	Seminar in Congress Room A: Festival Shakespeare	7
	Seminar in Commonwealth Hall A1: Shakespeare and Modernist Performance	7
	Seminar in Washington Room C: Winter Tales: Shakespeare and the North	7 7
	Seminar in Congress Room B: Spenser and Shakespeare	7
	Seminar in Commonwealth Hall A2: Shakespeare Forums	8
	Seminar in Washington Room B: Early Modern Melancholies	8
	Seminar in Commonwealth Hall D: Shakespeare's Geezers	8
	Seminar in Commonwealth Hall B: Science and Religion in the Early Modern Period	8 8
	Seminar in Washington Room A: Domestic/Civic/National Middleton	9
	Seminar in Commonwealth Hall C: <i>King Lear</i>	9
5:30 p.m.	Buses depart from the 12th Street entrance of the Loews Hotel for the Opening Reception at the World Cafe Live. Buses will make continuous circuits between the hotel and the World Cafe Live.	9 9
9:00 p.m.	Play Reading in Regency Ballroom A: <i>Doctor Faustus</i>	9

Friday, 14 April

8:00 a.m.	Registration opens in Regency Foyer, Second Mezzanine	10
	Exhibits open in Regency Ballroom C	10
	Continental Breakfast for Graduate Students in Lescaze Room, 33rd Floor	10 10
9:00 a.m.	Plenary Session in Millennium Hall: Educating Shakespeare: Early Modern Pedagogy and its Discontents	10 10
10:30 a.m.	Coffee Break in Millennium and Regency Foyers	10
11:00 a.m.	Paper Session in Regency Ballroom B: History/Literature/ London	10 10
	Paper Session in Commonwealth Hall: Religion and Emotion in the Elizabethan Playhouse	10 10
1:00 p.m.	Annual Luncheon in Millennium Hall	11
3:30 p.m.	Seminar in Commonwealth Hall A1: The Presence of Shakespeare	11
	Seminar in Washington Room A: Nature and Environment in Early Modern English Drama	11 11
	Seminar in Washington Room B: The Scottish Play	11
	Seminar in Commonwealth Hall B: Shakespeare and the Reformation, Part One	11 12
	Seminar in Congress Room C: Ben Jonson: New Directions	12
	Seminar in Commonwealth Hall C: Shakespearean Sensations	12
	Seminar in Congress Room A: Renaissance Drama and the Roman Cultural Revolution	12 12
	Seminar in Congress Room B: TV Shakespeare	13

	Seminar in Washington Room C: Staging Justice in Early Modern Drama	13
	Seminar in Commonwealth Hall D: Performance: Primary Sources, 1500–1642, Part One	13
	Seminar in Parlor 1: Shakespeare and Cross-Racial Casting	14
	Workshop in Commonwealth Hall A2: Teaching the “Bad” Quartos	14
8:30 p.m.	Film Screening and Post-Show Discussion in Regency Ballroom B: <i>Shakespeare Behind Bars</i>	14

Saturday, 15 April

8:00 a.m.	Information available in Regency Foyer, Second Mezzanine	14
	Exhibits open in Regency Ballroom C	14
9:00 a.m.	Book Drive in Parlor 2	14
	Paper Session in Regency Ballroom C: Romances of Trade and Trauma: The Open Submissions Panel	14
	Paper Session in Millennium Hall: Scholar in the Rehearsal Room	15
10:30 a.m.	Coffee Break in Millennium and Regency Foyers	15
10:45 a.m.	Workshop in Regency Ballroom A: Shakespearean Dynamics	15
11:00 a.m.	Paper Session in Regency Ballroom B: The Logics of Shakespearean Penitence	15
	Paper Session in Millennium Hall: Working-House of Thought: Shakespeare’s Desk, Marlowe’s Philosopher, Hamlet’s Brain	15
1:00 p.m.	Workshop for Teachers in Regency Ballroom A: Shakespeare Set Free: An Active Workshop on Teaching Shakespeare	16
2:00 p.m.	Paper Session in Millennium Hall: Motley to the View: The Interaction of Lyric and Dramatic Elements in Shakespeare’s Texts	16
	Paper Session in Regency Ballroom B: Play Reading: Second-Best, Sublimation, or Art Form?	16
4:00 p.m.	Seminar in Commonwealth Hall A1: The Literary Afterlives of Shakespearean Tragedy	16
	Seminar in Congress Room A: Shakespeare and the Invention of the Quasi-Human	17
	Seminar in Commonwealth Hall B: Shakespeare and the Reformation, Part Two	17
	Seminar in Commonwealth Hall C: Recontextualizing Shakespeare (and others) on Film	17
	Seminar in Commonwealth Hall A2: Refiguring Shakespeare: Questions of Canon and Theater in the Apocryphal and Collaborative Plays	17
	Seminar in Washington Room B: ‘Tis Pity It’s Not Shakespeare: Rethinking John Ford	18
	Seminar in Commonwealth Hall D: Performance: Primary Sources, 1500–1642, Part Two	18
	Seminar in Congress Room B: Looking Sideways: Queer Perspectives on Heterosexuality	18
	Seminar in Congress Room C: Shakespeare and the Visual Sense	18
	Seminar in Washington Room C: Shakespeare and the French	19
	Workshop in Washington Room A: Big-House Shakespeare	19
7:00 p.m.	Performance and Post-Show Discussion in Regency Ballroom A: <i>Quinnopolis vs. Hamlet</i>	19
10:00 p.m.	The SAA and Malone Society Dance in the Millennium Hall Tickets available at the door.	19

SECOND FLOOR

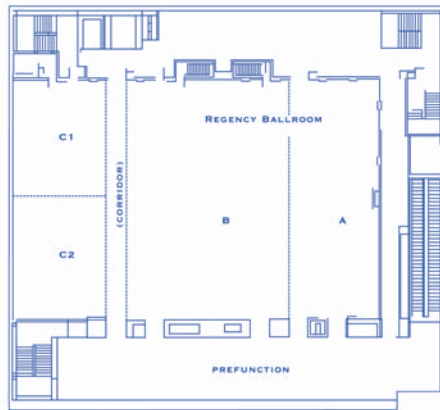
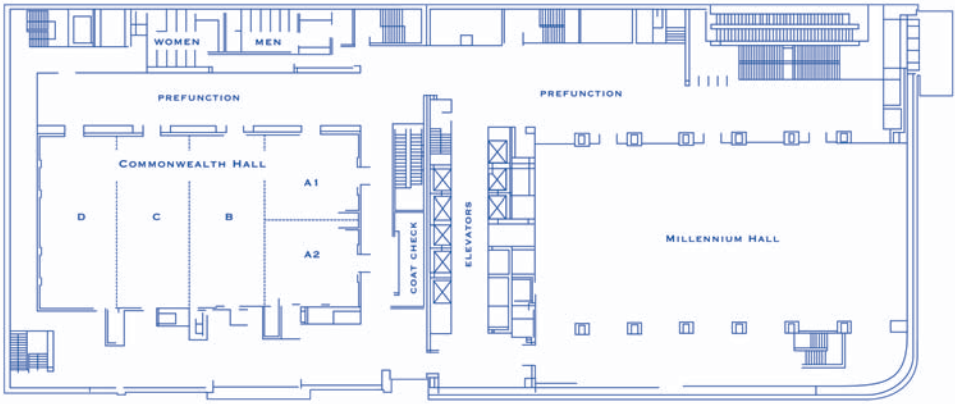

SECOND FLOOR MEZZANINE

Loews Philadelphia Hotel
Second Floor and Second Floor Mezzanine

THIRD FLOOR

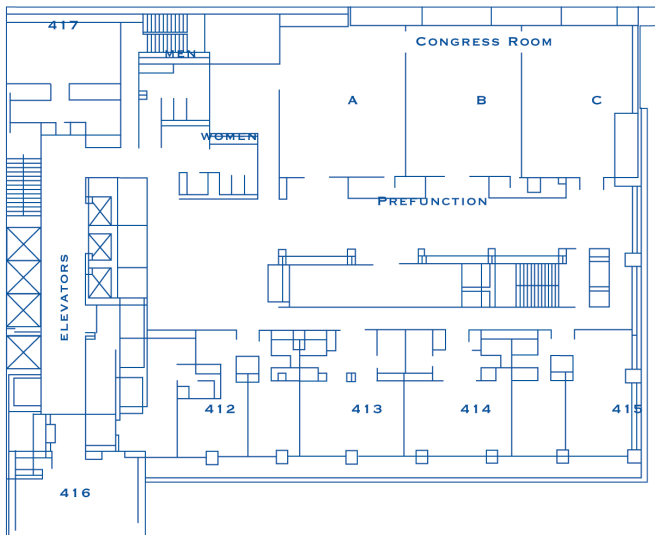
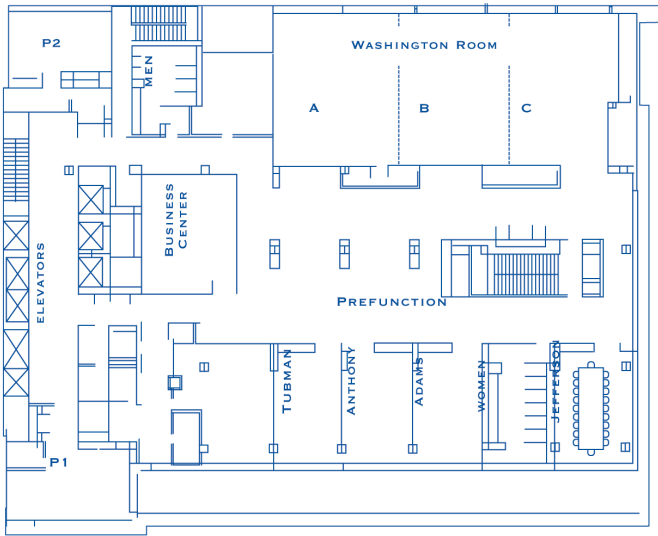

FOURTH FLOOR

Loews Philadelphia Hotel
Third and Fourth Floors

The Lescaze Room is located on the thirty-third floor of the hotel.

THURSDAY, 13 APRIL

10:00 a.m. to 5:30 p.m.

Registration

Regency Foyer, Second Mezzanine

12:00 noon to 5:30 p.m.

Exhibits

Regency Ballroom C

1:30 to 3:00 p.m.

Roundtable: Drafting Shakespeare: The Military Theater

Regency Ballroom B

Chair: SCOTT NEWSTOK, Gustavus Adolphus College

KENNETH ADELMAN, Movers and Shakespeares

STEVEN MARX, California State Polytechnic University

DAVID PERRY, U.S. Army War College

NINA TAUNTON, Brunel University

KENT THOMPSON, Denver Center Theatre Company

Paper Session: Risky Business: Early Modern England and Global Trade

Millennium Hall

Chair: NATASHA KORDA, Wesleyan University

DAVID J. BAKER, University of Hawai'i, Manoa
Doubly-Opaque: Mercantile Knowledge in Early Modern Britain

JONATHAN BURTON, West Virginia University

“Our nation’s custom shall be awed by you”: Reciprocal Comparison, The Global Early Modern, and *Three English Brothers*

ROBERT MARKLEY, University of Illinois, Urbana-Champaign

“Rich with Merchandise”: Shakespeare and the Spice Trade in the 1590s

3:30 to 5:30 p.m.

Seminar: The Shakespearean Idiom

Congress Room C

Leader: SYLVIA ADAMSON, University of Sheffield

CASSANDRA AMUNDSON, University of New Mexico

GREER GILMAN, Harvard University

SARAH GRANDAGE, University of Nottingham

SAYRE N. GREENFIELD, University of Pittsburgh, Greensburg

PAUL J. HECHT, Wake Forest University

JONATHAN HOPE, Strathclyde University

WILLIAM T. LISTON, Ball State University

LYNNE MAGNUSSON, University of Toronto

PENNY MCCARTHY, University of Glasgow

RUSS McDONALD, University of North Carolina, Greensboro

ERIN MINEAR, Harvard University

SIMON PALFREY, University of Liverpool

JOHN J. M. TOBIN, University of Massachusetts, Boston

Seminar: Festival Shakespeare

Congress Room A

Leader: ALAN ARMSTRONG, Southern Oregon University

RALPH ALAN COHEN, American Shakespeare Center

KEVIN CRAWFORD, University of Alabama

JOE FALOCCO, Catawba College

JOHN R. FORD, Delta State University

GAYLE GASKILL, College of St. Catherine

MAUREEN GODMAN, Washburn University

FRANCES L. HELPHINSTINE, Morehead State University

MICHAEL P. JENSEN, Talking Books/Shakespeare Newsletter

JANELLE JENSTAD, University of Victoria

YU JIN KO, Wellesley College

JENNIFER ADAIR MCCAUSLAND, University of South Carolina

MICHAEL SHURGOT, South Puget Sound Community College

BETHANY S. SINNOTT, Catawba College

ALAN SOMERSET, University of Western Ontario

CHAD THOMAS, University of Michigan

MICHAEL WARREN, University of California, Santa Cruz

Seminar: Shakespeare and Modernist Performance

Commonwealth Hall A1

Leaders: CARY DIPETRO, University of Toronto, Mississauga and PAUL PRESCOTT, Oxford Brookes University

STEPHEN MERRIAM FOLEY, Brown University

HUGH GRADY, Arcadia University

ZOLTAN MARKUS, Vassar College

JAMES O'ROURKE, Florida State University

JOAN PARKS, Kent State University, Stark

Seminar: Winter Tales: Shakespeare and the North

Washington Room C

Leaders: MARY FLOYD-WILSON, University of North Carolina, Chapel Hill and DARYL PALMER, Regis University

JOHN MICHAEL ARCHER, New York University

ROBIN E. BATES, Auburn University

EDMUND VALENTINE CAMPOS, Swarthmore College

TIMOTHY FRANCISCO, Youngstown State University

DAVID GOLZ, Kettering University

BARCLAY GREEN, Northern Kentucky University

GAVIN HOLLIS, University of Michigan

CATHERINE LOOMIS, University of New Orleans

AVRAHAM OZ, Haifa University

MARJORIE RUBRIGHT, University of Michigan

ELIZABETH A. SPILLER, Texas Christian University

LINA PERKINS WILDER, Carleton College

Seminar: Spenser and Shakespeare

Congress Room B

Leaders: THOMAS HERRON, East Carolina University and HANNIBAL HAMLIN, Ohio State University

JUDITH H. ANDERSON, Indiana University

TIMOTHY ARNER, Pennsylvania State University

RACHEL HILE BASSETT, University of Missouri, Kansas City

AMY BRADEN, University of Southern California

CATHERINE G. CANINO, University of South Carolina, Upstate

PATRICK CHENEY, Pennsylvania State University

KATHERINE EGGERT, University of Colorado, Boulder

EDWARD GIESKES, University of South Carolina

ALEXANDRA HALASZ, Dartmouth College

MICHAEL L. HAYS, Ashland, OR

Thursday, 13 April

CYRUS G. MULREADY, University of Pennsylvania
KAREN NELSON, University of Maryland, College Park
SUSAN OLDRIEVE, Baldwin-Wallace College
KRISTEN L. OLSON, Pennsylvania State University
ANNE LAKE PRESCOTT, Barnard College
ROBERT L. REID, Emory and Henry College

Seminar: Shakespeare Forums

Commonwealth Hall A2

Leaders: MATT KOZUSKO, Ursinus College
and ROBERT SAWYER, East Tennessee State
University

LYSBETH EM BENKERT, Northern State University
HARDY M. COOK, SHAKSPER Listserv
CHRISTY DESMET, University of Georgia
CHRISTA JANSOHN, University of Bamberg
ERIN PRESLEY, University of Georgia
KATHERINE WEST SCHEIL, University of Rhode Island

Seminar: Early Modern Melancholies

Washington Room B

Leader: ALAN LEWIS, Vancouver, British Columbia

ANUPAM BASU, University of Wisconsin, Madison
ROBERT B. BENNETT, University of Delaware
JASON COHEN, University of Wisconsin, Madison
DANIEL GATES, Rhodes College
JOSEPH JENKINS, University of California, Los Angeles
CHRISTINA LUCKY, Dalhousie University
DAVID J. MORROW, Michigan State University
IRINA S. PRIKHODKO, The Institute of World
Literature, Russian Academy of Sciences
LAWRENCE F. RHU, University of South Carolina
MILLA C. RIGGIO, Trinity College
LISA S. STARKS, University of South Florida,
St. Petersburg

Seminar: Shakespeare's Geezers

Commonwealth Hall D

Leader: NAOMI CONN LIEBLER, Montclair State
University

GINA BLOOM, University of Iowa
ALBERTO CACICEDO, Albright College
JIM E. CASEY, University of Alabama
STEPHANIE CHAMBERLAIN, Southeast Missouri State
University
PETER CUMMINGS, Hobart and William Smith Colleges
SILVER DAMSEN, University of Illinois, Urbana-Champaign
ANTHONY ELLIS, Western Michigan University
LOREEN L. GIESE, Ohio University
ANNE M. GILL, King's College, London
PHYLLIS GORFAIN, Oberlin College
DOROTHEA KEHLER, San Diego State University
ARTHUR F. KINNEY, University of Massachusetts,
Amherst
MARY ELLEN LAMB, Southern Illinois University
RICHARD LEVIN, State University of New York,
Stonybrook
RICHARD L. NOCHIMSON, Yeshiva University
SUSAN O'MALLEY, City University of New York
JEANNE A. ROBERTS, American University
GREGORY M. COLON SEMENZA, University of
Connecticut, Storrs
TIMOTHY ZAJAC, University of Virginia

Seminar: Science and Religion in the Early Modern Period

Commonwealth Hall B

Leaders: CRISTINA MALCOLMSON,
Bates College and SARAH RIVETT,
Washington University

KATHERINE BOOTLE ATTIE, University of Virginia
ADAM MAX COHEN, University of Massachusetts,
Dartmouth
CHRISTOPHER J. CROSBIE, Rutgers University
JOANNE DIAZ, Northwestern University
DARLENE FARABEE, University of Delaware
WENDY BETH HYMAN, Ithaca College
DAVID T. LONG, University of California, Los Angeles
ANIA LOOMBA, University of Pennsylvania
DUKE PESTA, Oklahoma State University
HOLLY CRAWFORD PICKETT, Washington and Lee
University

EILEEN REEVES, Princeton University
RANDALL STEYERS, University of North Carolina,
Chapel Hill
AMY L. TIGNER, Stanford University
DEBORAH UMAN, St. John Fisher College

Seminar: Domestic/Civic/ National Middleton

Washington Room A

Leader: JENNIFER PANEK, University of Ottawa

THOMAS L. BERGER, St. Lawrence University
ANN C. CHRISTENSEN, University of Houston
SUSAN COMILANG, Columbia Union College
J. CAITLIN FINLAYSON, University of Toronto
GIUSEPPINA IACONO, Pennsylvania State University
EMILY ISAACSON, University of Missouri, Columbia
DAVID LANDRETH, University of California, Berkeley
NINA LEVINE, University of South Carolina
KARA NORTHWAY, Xavier University
CRISTINE VARHOLY, Hampden-Sydney College
DENISE A. WALEN, Vassar College
MELISSA WALTER, University of Oregon

Seminar: *King Lear*

Commonwealth Hall C

Leader: RICHARD STRIER, University of Chicago

DAVID KEITH ANDERSON, McGill University
LEEDS BARROLL, Folger Shakespeare Library
ERIC BYVILLE, Loyola University Chicago
ROB CARSON, University of Toronto
ADELE S. DAVIDSON, Kenyon College
KEVIN DONOVAN, Middle Tennessee State University
SANFORD A. FREEDMAN, Bates College
KENNETH J. E. GRAHAM, University of Waterloo
JAMES HIRSH, Georgia State University
CLAIRE MCEACHERN, University of California,
Los Angeles
MARIANNE NOVOY, University of Pittsburgh
ROBERT B. PIERCE, Oberlin College
MARTHA RONK, Occidental College
CAROLE SCHUYLER, Dixie State College
WILLIAM O. SCOTT, University of Kansas
COLLEEN E. SHEA, Queen's University
PETER J. SMITH, Nottingham Trent University
JOHN STAINES, Earlham College

KATHLEEN A. WARD, Thiel College
PAUL WERSTINE, King's University College, University of
Western Ontario

6:00 to 8:00 p.m.

OPENING RECEPTION

World Cafe Live

Open to all registrants for the 34th Annual Meeting and their guests.

Buses may be boarded at the 12th Street entrance of the Loews Philadelphia Hotel beginning at 5:30 p.m. Drivers will make continuous circuits between the Loews and the World Cafe Live.

9:00 to 11:00 p.m.

Play Reading: *Doctor Faustus* by Christopher Marlowe *Regency Ballroom A*

Sponsored by the *Shakespeare Bulletin*.

Open to all registrants for the 34th Annual Meeting and their guests.

FRIDAY, 14 APRIL

8:00 a.m. to 5:30 p.m.

Registration

Regency Foyer, Second Mezzanine

Exhibits

Regency Ballroom C

8:00 to 9:00 a.m.

Continental Breakfast for Graduate Students

Hosted by the Trustees of the Association
Lescaze Room, 33rd Floor

9:00 to 10:30 a.m.

Plenary Session: Educating Shakespeare: Early Modern Pedagogy and its Discontents

Millennium Hall

Chair: REBECCA BUSHNELL, University of Pennsylvania

LYNN ENTERLINE, Vanderbilt University
Shakespeare's Schoolroom

MARGARET FERGUSON, University of California, Davis

"No Breeching Scholar": Reflections on Gender, Class, and Educational Discipline

ELIZABETH HANSON, Queen's University
In the Company of Scholars

10:30 to 11:00 a.m.

Coffee Break

Millennium and Regency Foyers

11:00 a.m. to 12:30 p.m.

Paper Session: History/Literature/London

Regency Ballroom B

Chair: JONATHAN GIL HARRIS,
George Washington University

CRYSTAL BARTOLOVICH, Syracuse University
Optimism of the Will

VANESSA HARDING, Birkbeck College, University of London
The Testimony of Testaments

JEAN E. HOWARD, Columbia University
Counter Narratives

Paper Session: Religion and Emotion in the Elizabethan Playhouse

Commonwealth Hall

Chair: GAIL KERN PASTER, Folger Shakespeare Library

STEVEN MULLANEY, University of Michigan
The Reformation of Emotions

ANTHONY B. DAWSON, University of British Columbia
Claudius at Prayer: Shakespeare and the Question of Repentance

RICHARD C. MCCOY, Queens College and Graduate Center, City University of New York
Believing *As You Like It*: Faith in Shakespeare's Theater

1:00 to 3:00 p.m.

ANNUAL LUNCHEON

Millennium Hall

Open to all registrants for the 34th Annual Meeting.

Tickets for guest luncheons may be purchased at the registration tables.

Presiding: WILLIAM C. CARROLL,
Boston University

3:30 to 5:30 p.m.

Seminar: The Presence of Shakespeare

Commonwealth Hall A1

Leader: SUSAN BENNETT, University of Calgary

CHRISTIE CARSON, Royal Holloway, University of London
KAREN FRICKER, Trinity College
REINA GREEN, Mount Saint Vincent University
DIANA E. HENDERSON, Massachusetts Institute of Technology
ALEXANDER C.Y. HUANG, Pennsylvania State University
FARAH KARIM-COOPER, Shakespeare's Globe
SUSAN KNUTSON, Université Sainte-Anne
PETER PAROLIN, University of Wyoming
ELIZABETH WILLIAMSON, Evergreen State College

Seminar: Nature and Environment in Early Modern English Drama

Washington Room A

Leader: BRUCE BOEHRER, Florida State University

DANA E. ASPINALL, Assumption College
GEORGIA E. BROWN, Queens College, Cambridge University

LYNNE BRUCKNER, Chatham College
DARLENE CIRAULO, Central Missouri State University
HOLLY DUGAN, George Washington University
GABRIEL EGAN, Loughborough University
JEAN FEERICK, Brown University
DONALD HEDRICK, Kansas State University
IAN MACINNES, Albion College
STEVE MENTZ, St. John's University
GAYWIN MOORE, University of Kansas
VIN NARDIZZI, Duke University
ALAN W. POWERS, Bristol Community College
KAREN RABER, University of Mississippi
CHARLOTTE SCOTT, University of Warwick
LAURIE SHANNON, Duke University
JEFFREY S. THEIS, Salem State College
HENRY S. TURNER, University of Wisconsin, Madison
ROBERT N. WATSON, University of California, Los Angeles
PAUL YACHNIN, McGill University

Seminar: The Scottish Play

Washington Room B

Leader: A. R. BRAUNMULLER, University of California, Los Angeles

JONATHAN BALDO, Eastman School of Music of the University of Rochester
PAULA BERGGREN, Baruch College, CUNY
JOHN D. COX, Hope College
EWAN FERNIE, Royal Holloway, University of London
SARAH GODWIN, Auburn University
STUART M. KURLAND, Duquesne University
JESSE M. LANDER, University of Notre Dame
FRED J. LEVY, University of Washington
ALFREDO MICHEL MODENESSI, Universidad Nacional Autónoma de México
ROLF O. MUELLER, Fanny-Leicht-Gymnasium, Stuttgart
ALLISON OUTLAND, Columbia University
LINDA LEVY PECK, George Washington University
SID RAY, Pace University
BEN R. SCHNEIDER, JR., Lawrence University
SARAH WALL-RANDALL, Wellesley College
WILLIAM PROCTOR WILLIAMS, University of Akron
ALAN R. YOUNG, Acadia University

Friday, 14 April

Seminar: Shakespeare and the Reformation, Part One

Commonwealth Hall B

Leaders: DOUGLAS A. BROOKS, Texas A&M University and GLYN PARRY, Victoria University

CYNDIA SUSAN CLEGG, Pepperdine University
MARIA FAHEY, CUNY Graduate Center
DANIEL GIBBONS, University of Wisconsin, Madison
MAURICE HUNT, Baylor University
JAMES KEARNEY, Yale University
JULIA MACDONALD, University of North Texas
KAREN SAWYER MARSALEK, St. Olaf College
IAN MCADAM, University of Lethbridge
GLORIA OLCHOWY, Edmonton, Alberta
PAIGE REYNOLDS, University of North Texas
ANITA GILMAN SHERMAN, American University
BARBARA SILVERSTEIN, University of Delaware
ANDREW TUMMINIA, Fordham University
LEWIS WALKER, University of North Carolina, Wilmington

Seminar: Ben Jonson: New Directions

Congress Room C

Leader: MARTIN BUTLER, University of Leeds

MARY BLY, Fordham University
EUGENE GIDDENS, Anglia Polytechnic University
HEATHER JAMES, University of Southern California
JEAN LAMBERT, Anglia Polytechnic University, Cambridge
ELENA LEVY-NAVARRO, University of Wisconsin, Whitewater
JAMES MARDOCK, Ripon College
KATHARINE EISAMAN MAUS, University of Virginia
IAN MUNRO, University of California, Irvine
JOSEPH NAVITSKY, Boston University
ELISA OH, Boston University
HELEN OSTOVICH, McMaster University
WILLIAM J. ROGERS, University of Wisconsin, Madison
BRADLEY DAVID RYNER, University of Delaware
JULIE SANDERS, University of Nottingham
MATTHEW STEGGLE, Sheffield Hallam University
MARY TRULL, St. Olaf College
JUDITH WEIL, University of Manitoba

Seminar: Shakespearean Sensations

Commonwealth Hall C

Leaders: KATHARINE CRAIK, Worcester College, Oxford and TANYA POLLARD, Montclair State University

PAUL BUDRA, Simon Fraser University
CHRISTOPHER J. COBB, North Carolina State University
LEA LUECKING FROST, Saint Louis University
ELIZABETH HARVEY, University of Toronto
ALLISON P. HOBGOOD, Emory University
WILLIAM KERWIN, University of Missouri, Columbia
GILLIAN KNOLL, University of Maryland, College Park
KENT LEHNHOF, Chapman University
CYNTHIA LEWIS, Davidson College
ZACKARIAH LONG, Sweet Briar College
KRISTIN LUCAS, McGill University
MATHEW R. MARTIN, Brock University
HILLARY M. NUNN, University of Akron
GAIL KERN PASTER, Folger Shakespeare Library
KAARA L. PETERSON, Miami University of Ohio
BRUCE R. SMITH, University of Southern California
MELISSA SMITH, George Washington University
GARRETT A. SULLIVAN, JR., Pennsylvania State University
CHARLES WHITNEY, University of Nevada, Las Vegas

Seminar: Renaissance Drama and the Roman Cultural Revolution

Congress Room A

Leaders: CORA FOX, Arizona State University and CURTIS PERRY, Arizona State University

BROOKE CARLSON, University of Southern California
VERNON GUY DICKSON, Arizona State University
LAURI S. DIETZ, Angelo State University
RAPHAEL FALCO, University of Maryland, Baltimore County
JENNIFER GJULAMETI, New York University
ADAM H. KITZES, University of North Dakota
JOYCE G. MACDONALD, University of Kentucky
MARGARET MAURER, Colgate University
ANDREW MOORE, University of Western Ontario

NICHOLAS MOSCHOVAKIS, Reed College
MARY K. STEIBLE, Southern Illinois University
ALAN STEWART, Columbia University
ALISON TYMOCZKO, University of Southern California
SUSANNE L. WOFFORD, University of Wisconsin,
Madison
LINDA WOODBRIDGE, Pennsylvania State University

Seminar: TV Shakespeare

Congress Room B

Leader: PETER HOLLAND, University of
Notre Dame

ISKA ALTER, Hofstra University
KATHRYN A. BARBOUR, Chesapeake College
TERRI BOURUS, Indiana University
SHEILA T. CAVANAGH, Emory University
SUSANNE GREENHALGH, Roehampton University
KIRK HENDERSHOTT-KRAETZER, Olivet College
MARGO HENDRICKS, University of California,
Santa Cruz
RUSSELL JACKSON, University of Birmingham
M. J. KIDNIE, University of Western Ontario
PATRICIA J. LENNOX, New York University
ELLEN JOY LETOSTAK, University of Florida
SIMON MORGAN-RUSSELL, Bowling Green State
University
LAURIE E. OSBORNE, Colby College
ROBERT MARTIN SHAUGHNESSY, University of Kent
JOSEPH MICHAEL SULLIVAN, Marietta College
HERB WEIL, University of Manitoba
W. B. WORTHEN, University of California, Berkeley

Seminar: Staging Justice in Early Modern Drama

Washington Room C

Leader: W. DAVID KAY, University of Illinois,
Urbana-Champaign

CRISTINA LEON ALFAR, Hunter College, CUNY
CAROL A. BLESSING, Point Loma Nazarene University
KEVIN D. CURRAN, McGill University
EMILY DETMER-GOEBEL, Northern Kentucky University
CHERYL M. DUDGEON, University of Western Ontario
DAVID EVETT, Cleveland State University
KATHRYN FININ, State University of New York,
Oneonta

DAVID GEORGE, Urbana University
PIERRE HECKER, Gettysburg College
HARRY KEYISHIAN, Fairleigh Dickinson University
LISA KLOTZ, University of North Carolina, Chapel Hill
ANDREW MAJESKE, University of California, Davis
HEATHER MURRAY, Pennsylvania State University
ERIC V. SPENCER, Albertson College
HOLGER SCHOTT SYME, University of Toronto,
Mississauga
CATHERINE E. THOMAS, College of Charleston
POLYA TOCHEVA, University of Connecticut
CHRISTOPHER WARLEY, University of Toronto

Seminar: Performance: Primary Sources, 1500–1642, Part One

Commonwealth Hall D

Leader: ALAN H. NELSON, University of
California, Berkeley

JOHN H. ASTINGTON, University of Toronto
MARY A. BLACKSTONE, University of Regina
JOHN RUSSELL BROWN, Middlesex University, London
JOHN A. CARPENTER, University of Central Florida
SUSAN P. CERASANO, Colgate University
PETER H. GREENFIELD, University of Puget Sound
ANNE LANCASHIRE, University of Toronto
WILLIAM J. LLOYD, Olsson's Books
JEREMY LOPEZ, University of Toronto
SALLY-BETH MACLEAN, University of Toronto
LAWRENCE MANLEY, Yale University
LUCY MUNRO, Keele University
BARBARA D. PALMER, Mary Washington College
PETER R. ROBERTS, University of Kent, Canterbury
JENNIFER ROBERTS-SMITH, University of Toronto
JUNE SCHLUETER, Lafayette College
VALERIE WAYNE, University of Hawai'i

Seminar: Shakespeare and Cross-Racial Casting

Parlor 1 (P1)

Leader: AYANNA THOMPSON, Arizona State University

PATRICIA AKHIMIE, Columbia University
COURTNEY LEHMANN, University of the Pacific
ANGELA PAO, Indiana University
ADELE SEEFF, University of Maryland, College Park
SARAH WERNER, Folger Shakespeare Library

Workshop: Teaching the “Bad” Quartos

Commonwealth Hall A2

Leader: ANNALISA CASTALDO, Widener University

RONDA ARAB, State University of New York, Plattsburgh
TIFFANY A. CONROY, Northeastern University
ANNETTE DREW-BEAR, Washington and Jefferson College
JEREMY EHRLICH, Folger Shakespeare Library
JOSEPH HAUGHEY, Western Michigan University
HELEN HULL, University of Maryland, College Park
MICHAEL MCCLINTOCK, McKendree College
KENDRICK W. PREWITT, University of the Ozarks
EDWARD L. ROCKLIN, California State Polytechnic University, Pomona
MEREDITH SKURA, Rice University

8:30 to 10:30 p.m.

Film Screening: Shakespeare Behind Bars

Regency Ballroom B

Open to all registrants for the 34th Annual Meeting and their guests.

Please join us for a post-show discussion with Director Hank Rogerson and the director of the Shakespeare Behind Bars program, Curt L. Toftland. Introduced by Amy Scott-Douglass.

SATURDAY, 15 APRIL

8:00 a.m. to 12:30 p.m.

Information

Regency Foyer, Second Mezzanine

Exhibits

Regency Ballroom C

9:00 a.m. to 5:00 p.m.

Book Drive

Parlor 2 (P2)

9:00 a.m. to 12:00 noon: SAA members affected by Hurricane Katrina are invited to choose from donated books.

12:00 to 3:00 p.m.: Graduate students may choose from among the remaining books.

3:00 to 5:00 p.m.: Unclaimed books are available to SAA members at large. Thereafter books will be donated to a local charity.

9:00 to 10:30 a.m.

Paper Session: Romances of Trade and Trauma: The Open Submissions Panel

Regency Ballroom C

Chair: TOM G. BISHOP, Case Western Reserve University

PATRICIA CAHILL, Emory University
Atrocity in Arcadia: War Wounds and the
Female Face of Trauma

VALERIE FORMAN, University of Colorado,
Boulder
Tragicomic Redemptions and Discourses
of “Free” Trade in the Early 1600s

Paper Session: Scholar in the Rehearsal Room

Millennium Hall

Chair: ANDREW JAMES HARTLEY,
University of North Carolina, Charlotte

STEVEN URKOWITZ, City College, New York
That All Things Might Go Well

GENEVIEVE LOVE, Colorado College
Performing Academic Affect

CARY M. MAZER, University of Pennsylvania
The Perils of Documentation

10:30 to 11:00 a.m.

Coffee Break

Millennium and Regency Foyers

10:45 a.m. to 12:30 p.m.

Workshop: Shakespearean Dynamics

Regency Ballroom A

Instructor: AARON POSNER, Co-Founder and
Resident Director of Arden Theatre Company, with
the assistance of two professional actors.

All registrants are welcome to attend.

11:00 a.m. to 12:30 p.m.

Paper Session: The Logics of Shakespearean Penitence

Regency Ballroom B

Chair: ARTHUR F. KINNEY, University of
Massachusetts, Amherst

ELIZABETH FOWLER, University of Virginia
“Do you confess the bond?”: Toward a
History of Performativity

SARAH BECKWITH, Duke University
“Is’t enough I am sorry?”: Shakespearean
Penitence and the Long Reformation

HEATHER HIRSCHFELD, University of Tennessee
“Taking vengeance of our selves”: The
Penitential Structures of Revenge Tragedy

Paper Session: Working-House of Thought: Shakespeare’s Desk, Marlowe’s Philosopher, Hamlet’s Brain

Millennium Hall

Chair: RAYNA KALAS, Cornell University

MARGRETA DE GRAZIA, University of
Pennsylvania
Staging Thought

JOHN GUILLORY, New York University
Marlowe, Philosophy, and the Death of
Ramus

PETER STALLYBRASS, University of Pennsylvania
Shakespeare’s Desk

12:30 to 2:00 p.m.

Lunch Break

World Shakespeare Bibliography Business Meeting and Luncheon: Gather by the main entrance of The Loews Philadelphia Hotel.

1:00 to 3:30 p.m.

Workshop for Teachers:

Shakespeare Set Free: An Active Workshop on Teaching Shakespeare
Regency Ballroom A
Leaders: JEREMY EHRLICH, Folger Shakespeare Library, MICHAEL LOMONICO, Folger Shakespeare Library, and DAMIAN BARIEXCA, Hunterdon Central Regional High School

All registrants are welcome to attend.

2:00 to 3:30 p.m.

Paper Session: Motley to the View: The Interaction of Lyric and Dramatic Elements in Shakespeare's Texts

Millennium Hall
Chair: VALERIE WAYNE, University of Hawai'i

COLIN BURROW, University of Cambridge
Lyric in its Settings: Multiple Voices and Narrative Contexts in Shakespeare

HEATHER DUBROW, University of Wisconsin
What Imports This Song?

JENNIFER LEWIN, University of Kentucky
Lyric and Lyricism in *A Midsummer Night's Dream*

Paper Session: Play Reading: Second-Best, Sublimation, or Art Form?

Regency Ballroom B
Chair: AUDREY STANLEY, University of California, Santa Cruz

LOIS POTTER, University of Delaware
Reading in and of Shakespeare

EVELYN TRIBBLE, University of Otago
Reading, Recitation, and Entertainments: The Dunedin Shakespeare Club, 1877–1960

ANN THOMPSON, King's College, London
A Club of Our Own: Women's Play Readings in the Nineteenth Century

4:00 to 6:00 p.m.

Seminar: The Literary Afterlives of Shakespearean Tragedy

Commonwealth Hall A1
Seminar Leaders: MARK BAYER, American University of Beirut and GRETCHEN MIINTON, University of Minnesota, Morris

JAMES E. BERG, Harvard University
JAMES P. CONLAN, University of Puerto Rico
ANTONIA FORSTER, University of Akron
ELIZABETH GRUBER, Lock Haven University
PARMITA KAPADIA, Northern Kentucky University
GILLIAN MURRAY KENDALL, Smith College
YVETTE KHOURY, King's College London
ELIZABETH KLETT, University of Houston
RICHARD MEEK, University of Reading
MARK ROBSON, University of Nottingham
JAY A. WARD, Thiel College

Seminar: Shakespeare and the Invention of the Quasi-Human

Congress Room A

Seminar Leader: LARA BOVILSKY, Washington University

REGINA BUCCOLA, Roosevelt University
CLAIRE BUSSE, La Salle University
DOUGLAS ESKEW, University of Texas, Austin
JAY FARNES, Northern Arizona University
ANDREW GRIFFIN, McMaster University
JENNIFER HIGGINBOTHAM, University of Pennsylvania
JUSTIN KOLB, University of Wisconsin, Madison
AARON KUNIN, Pomona College
UNHAE LANGIS, University of Southern California
LYNSEY MCCULLOCH, Anglia Polytechnic University
KATIE MUSGRAVE, Université de Montréal
MARGARET E. OWENS, University of British Columbia
ROBERT REEDER, Providence College
BRYAN REYNOLDS, University of California, Irvine
DAVID RUITER, University of Texas, El Paso
JOEL SLOTKIN, Stanford University

Seminar: Shakespeare and the Reformation, Part Two

Commonwealth Hall B

Seminar Leaders: DOUGLAS A. BROOKS, Texas A&M University and GLYN PARRY, Victoria University

ARIANE MARIE BALIZET, University of Minnesota
MICHELLE DOWD, University of North Carolina, Greensboro
SUSAN DUNN-HENSLEY, University of Kansas
RICHARD FINKELSTEIN, State University of New York, Geneseo
BRADLEY GREENBURG, Northeastern Illinois University
HERBERT JACK HELLER, Huntington College
ERIN E. KELLY, Nazareth College
ERIKA T. LIN, University of Louisville
JOHN J. NORTON, Concordia University
BARBARA L. PARKER, William Paterson University
MARK RANKIN, Ohio State University
TRACEY SEDINGER, University of Northern Colorado
PAUL DUSTIN STEGNER, Pennsylvania State University
GARY WALLER, Purchase College, State University of New York

Seminar: Recontextualizing Shakespeare (and others) on Film

Commonwealth Hall C

Seminar Leader: TOM CARTELLI, Muhlenberg College

MARK AUNE, North Dakota State University
CURTIS BREIGHT, University of Pittsburgh
RICHARD BURT, University of Florida, Gainesville
CHARLES CONAWAY, University of Southern Indiana
BARBARA CORRELL, Cornell University
MELISSA CROTEAU, Geneva College
SAMUEL CROWL, Ohio University
PETER S. DONALDSON, Massachusetts Institute of Technology
HILLARY J. FOGERTY, Mercyhurst College
MICHAEL D. FRIEDMAN, University of Scranton
DOUGLAS E. GREEN, Augsburg College
KEITH HARRISON, Malaspina University-College
DIANNE M. HUNTER, Trinity College
KIRK MELNIKOFF, University of North Carolina, Charlotte
ANNA K. NARDO, Louisiana State University
KATHERINE ROWE, Bryn Mawr College
JESSICA SLIGHTS, Acadia University
ALICIA ANNE SUTLIFF, University of Kansas
AMANDA LEIGH WOOD, Auburn University

Seminar: Refiguring Shakespeare: Questions of Canon and Theater in the Apocryphal and Collaborative Plays

Commonwealth Hall A2

Seminar Leader: JOHN JOWETT, Shakespeare Institute, University of Birmingham

JOYCE BORO, Université de Montréal
ELLEN M. CALDWELL, California State University, Fullerton
JENNIFER FORSYTH, Kutztown University
NICOLE A. JACOBS, Pennsylvania State University
CAMPBELL LATHEY, Albany, New York
SCOTT MAISANO, University of Massachusetts, Boston

RICHARD PREISS, Stanford University
JAMES PURKIS, University of Western Ontario
TOM ROONEY, Eotvos Lorand University
ROGER STRITMATTER, Coppin State University

**Seminar: 'Tis Pity It's Not
Shakespeare: Rethinking
John Ford**

Washington Room B

Seminar Leaders: SONIA MASSAI, King's
College, London and CATHERINE SILVERSTONE,
Anglia Polytechnic University, Cambridge

ELIZABETH A. CHARLEBOIS, St. Mary's College of
Maryland
NICHOLAS CRAWFORD, University of Montevallo
ALAN B. FARMER, Ohio State University
JUDITH HABER, Tufts University
MARK HOULAHAN, University of Waikato
ROSEMARY KEGL, University of Rochester
DAVID L. MIDDLETON, Trinity University
SUBHA MUKHERJI, Fitzwilliam College
MICHAEL NEILL, University of Auckland
CAROLYN SALE, University of Windsor
RHONDA LEMKE SANFORD, Fairmont State College
SOPHIE TOMLINSON, Auckland University
BRIAN WALSH, University of Illinois,
Urbana-Champaign

**Seminar: Performance:
Primary Sources, 1500–1642,
Part Two**

Commonwealth Hall D

Leader: ALAN H. NELSON, University of
California, Berkeley

ALAN C. DESSEN, University of North Carolina,
Chapel Hill
ANNE F. GOSSAGE, Eastern Kentucky University
CHRISTOPHER HOLMES, University of Toronto
WILLIAM INGRAM, University of Michigan
DAVID KATHMAN, Morningstar
ROSLYN L. KNUTSON, University of Arkansas,
Little Rock
WILLIAM B. LONG, Brooklyn, NY
JAMES J. MARINO, Cleveland State University

CHRISTOPHER MATUSIAK, University of Toronto
SCOTT McMILLIN, Cornell University
NONA MONAHIN, Amherst College
TIFFANY STERN, Oxford Brookes University
ANDREA R. STEVENS, University of Virginia
MARTA STRAZNICKY, Queen's University
LESLIE THOMSON, University of Toronto
EMILY WINEROCK, University of Toronto

**Seminar: Looking Sideways:
Queer Perspectives on
Heterosexuality**

Congress Room B

Leader: KATHRYN SCHWARZ, Vanderbilt
University

REBECCA BACH, University of Alabama, Birmingham
JAMES M. BROMLEY, Loyola University Chicago
KRISTEN BROOKES, Miss Porter's School
KATE CHEDGZOY, University of Newcastle
HOLLY A. CROCKER, University of South Carolina
ROBERT DARCY, University of Nebraska, Omaha
WILL FISHER, Lehman College, CUNY
DANIEL JUAN GIL, University of Oregon
STEPHEN GUY-BRAY, University of British Columbia
SHARON O'DAIR, University of Alabama, Tuscaloosa
NIAMH O'LEARY, Pennsylvania State University
MARIA TERESA PRENDERGAST, Grinnell College
SARAH K. SCOTT, College of Charleston
GORAN V. STANIVUKOVIC, University of Sheffield
WILLIAM STOCKTON, Indiana University, Bloomington

**Seminar: Shakespeare and the
Visual Sense**

Congress Room C

Leader: STUART SILLARS, University of Bergen

JENNIFER AILLES, University of Rochester
SIBYLLE BAUMBACH, Ludwig-Maximilians University
JOANNA MONTGOMERY BYLES, University of Cyprus
FRANK NICHOLAS CLARY, Saint Michael's College
REGINALD A. FOAKES, University of California,
Los Angeles
KATHY M. HOWLETT, Northeastern University
MIRIAM EMMA JACOBSON, McGill University
ROBERT I. LUBLIN, University of Massachusetts,
Boston

CHARLES MOSELEY, University of Cambridge
NOVA MYHILL, New College of Florida
JOSEPH A. PORTER, Duke University
JENNIFER WALDRON, University of Pittsburgh
SARAH R. WEBSTER, California State University,
Fullerton
ROBERT E. WOOD, Georgia Tech University

Seminar: Shakespeare and the French

Washington Room C

Leader: DEANNE WILLIAMS, York University

TIMOTHY BILLINGS, Middlebury College
CAROLYN E. BROWN, University of San Francisco
ANTHONY BURTON, Center for Renaissance Studies,
University of Massachusetts, Amherst
ELLEN C. CALDWELL, Clarkson University
ANNE COLDIRON, Louisiana State University
JENNIFER DROUIN, McGill University
LARS ENGLE, University of Tulsa
SUSAN L. FISCHER, Bucknell University
EVELYN GAJOWSKI, University of Nevada, Las Vegas
LOWELL GALLAGHER, University of California,
Los Angeles
JEAN-CHRISTOPHE MAYER, Université de Montpellier
RUTH MORSE, Université Paris - 7
ELIZABETH PENTLAND, Stanford University
MICHAEL SAENGER, Southwestern University
KAY STANTON, California State University, Fullerton

Workshop: Big-House Shakespeare

Washington Room A

Leader: AMY SCOTT-DOUGLASS, Denison University

MELISSA D. AARON, California State Polytechnic University, Pomona
DENISE ALBANESE, George Mason University
LAURA RAIDONIS BATES, Indiana State University
NEILS HEROLD, Oakland University
KATHERINE D. LIU, Amherst College
HANK ROGERSON, Philomath Films
MEG SEMPREGORA, Webster University
CURT TOFTELAND, Shakespeare Behind Bars
AGNES WILCOX, Prison Performing Arts

7:00 to 9:00 p.m.

Performance: *Quinnopolis vs. Hamlet*

Presented by the Quinnopolis Theatre Company.
Regency Ballroom A

Please join us for a post-show discussion with Director David Dalton and Quinnopolis cast members Jeremy Beck and Christopher Yeatts.

Tickets available at the registration tables and the door.

10:00 p.m. to 1:00 a.m.

THE DANCE

with live music by Tom Berger and the Hey Nonny Nonnies
Millennium Hall

Sponsored by the Shakespeare Association of America and the Malone Society.

Tickets available at the registration tables and the door.

FROM CAMBRIDGE

**Privacy, Playreading,
and Women's Closet
Drama, 1550–1700**

Marta Straznicky

**Memory and Forgetting
in English Renaissance
Drama**Shakespeare, Marlowe,
Webster

Garrett A. Sullivan, Jr.

**Performing Blackness
on English Stages,
1500–1800**

Virginia Mason Vaughan

**Sonnet Sequences and
Social Distinction in
Renaissance England**

Christopher Warley

**Service and
Dependency in
Shakespeare's Plays**

Judith Weil

**Shakespeare's
Humanism**

Robin Headlam Wells

**Print and the Poetics of
Modern Drama**

W.B. Worthen

**The Italian Encounter
with Tudor England**

A Cultural Politics of Translation

Michael Wyatt

NEW FROM

**SHAKESPEARE IN
PRODUCTION****Othello***

2nd Edition

William Shakespeare
Edited by Julie Hankey**Troilus and Cressida***William Shakespeare
Edited by Frances A. Shirley**THE NEW CAMBRIDGE SHAKESPEARE**

FORTHCOMING...

**Measure for
Measure***

2nd Edition

William Shakespeare
Edited by Brian Gibbons**The Sonnets***

2nd Edition

William Shakespeare
Edited by
Gwynne Blakemore Evans
Introduction by Anthony Hecht**Titus Andronicus***

2nd Edition

William Shakespeare
Edited by Alan Hughes**The Poems***Venus and Adonis, The Rape of
Lucrece, The Phoenix and the
Turtle, The Passionate Pilgrim
2nd EditionWilliam Shakespeare
Edited by John Roe

NEW...

Antony and Cleopatra*

2nd Edition

William Shakespeare
Edited by David Bevington**Cymbeline***William Shakespeare
Edited by Martin Butler**King Henry V***

2nd Edition

William Shakespeare
Edited by Andrew Gurr**The Tragedy of
King Lear***

2nd Edition

William Shakespeare
Edited by Jay L. Halio**The First Quarto of
Othello****Series: The New Cambridge
Shakespeare Quartos*William Shakespeare
Edited by Scott McMillin

*Available in hardback and paperback.

Visit our display for a 20% discount!For more information, please visit us at
www.cambridge.org/us or call toll-free at
1-800-872-7423**CAMBRIDGE**
UNIVERSITY PRESS

CAMBRIDGE

NEW AND NOTEWORTHY

Drama at the Courts of Queen Henrietta Maria

Karen Britland

Racism, Misogyny, and the Othello Myth*

Inter-racial Couples from Shakespeare to Spike Lee
Celia R. Daileader

Shakespeare and Modernism

Cary DiPietro

Readers and Authorship in Early Modern England

Stephen B. Dobranski

The Cambridge Companion to John Donne*

Edited by Achsah Guibory

Reading Material in Early Modern England

Print, Gender, and Literacy
Heidi Brayman Hackel

Shakespeare and Republicanism

Andrew Hadfield

Shakespeare Survey

Volume 58, Writing about Shakespeare
Edited by Peter Holland

Inventing Polemic

Religion, Print, and Literary Culture in Early Modern England
Jesse Lander

Shakespeare's Tragedies*

Violation and Identity
Alexander Leggatt

NOW AVAILABLE IN PAPERBACK!

The Cambridge History of Early Modern English Literature*

Edited by David Loewenstein and Janel Mueller

Martyrdom and Literature in Early Modern England

Susannah Brietz Monta

Children of the Queen's Revels

A Jacobean Theatre Repertory
Lucy Munro

Literature and Favoritism in Early Modern England

Curtis Perry

Thomas Browne and the Writing of Early Modern Science

Claire Preston

Autobiography and Gender in Early Modern Literature

Reading Women's Lives, 1599–1678

Sharon Seelig

Painting Shakespeare

The Artist as Critic, 1720–1820
Stuart Sillars

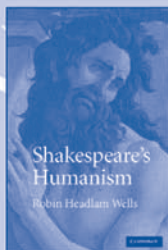

*Available in hardback and paperback.

Visit our display for a 20% discount!

For more information, please visit us at www.cambridge.org/us or call toll-free at 1-800-872-7423



CAMBRIDGE
UNIVERSITY PRESS

Participants in the 34th Annual Meeting

Melissa D. Aaron, California State Polytechnic University, Pomona

Sylvia Adamson, University of Sheffield

Kenneth Adelman, Movers and Shakespeares

Susan W. Ahern, Saint Joseph College

Jennifer Ailles, University of Rochester

Patricia Akhimie, Columbia University

Cristina Alfar, Hunter College, CUNY

Iska Alter, Hofstra University

Cassandra Amundson, University of New Mexico

David Keith Anderson, McGill University

Judith H. Anderson, Indiana University

Ronda Arab, SUNY, Plattsburgh

John Michael Archer, New York University

Alan Armstrong, Southern Oregon University

Timothy Arner, Pennsylvania State University

Dana E. Aspinall, Assumption College

John H. Astington, University of Toronto

Katherine Bootle Attie, University of Virginia

Mark Aune, North Dakota State University

Rebecca Bach, University of Alabama, Birmingham

David Baker, University of Hawai'i, Manoa

Jonathan Baldo, Eastman School of Music

Ariane Marie Balizet, University of Minnesota

Frances K. Barasch, Baruch College, CUNY

Kathryn A. Barbour, Chesapeake College

J. Leeds Barroll, Folger Shakespeare Library

Crystal Bartolovich, Syracuse University

Rachel Hile Bassett, University of Missouri, Kansas City

Anupam Basu, University of Wisconsin, Madison

Laura Raidonis Bates, Indiana State University

Robin E. Bates, Auburn University

Sibylle Baumbach, Ludwig-Maximilians-University

Mark Bayer, American University, Beirut

Sarah Thomasine Beckwith, Duke University

Lysbeth Em Benkert, Northern State University

Emma Bennett, Blackwell Publishing

Robert B. Bennett, University of Delaware

Susan Bennett, University of Calgary

James E. Berg, Harvard University

Thomas L. Berger, St. Lawrence University

David M. Bergeron, University of Kansas

Paula Berggren, Baruch College, CUNY

Marcie Bianco, Rutgers University, New Brunswick

Rob Bigalke, Dillard University

Timothy Billings, Middlebury College

Thomas Bishop, Case Western Reserve University

Mary A. Blackstone, University of Regina

Carol A. Blessing, Point Loma Nazarene University

Gina Bloom, University of Iowa

Mary Bly, Fordham University

Bruce Boehrer, Florida State University

Joyce Boro, Université de Montréal

Terri Bourus, Indiana University

Lara Bovilsky, Washington University, St. Louis

Andrew Bozio, Lexington, KY

Amy Braden, University of Southern California

A. R. Braunmuller, University of California, Los Angeles

Curtis Bright, University of Pittsburgh

James M. Bromley, Loyola University Chicago

Kristen Brookes, Miss Porter's School

Douglas A. Brooks, Texas A&M University

Carolyn E. Brown, University of San Francisco

Georgia E. Brown, Queens College, Cambridge University

John Russell Brown, Middlesex University, London

Lynne Bruckner, Chatham College

Regina Buccola, Roosevelt University

Paul Budra, Simon Fraser University

James C. Bulman, Allegheny College

Nancy Mohrlock Bunker, Macon State College

Colin Burrow, Gonville and Caius College

Richard Burt, University of Florida, Gainesville

Anthony Burton, Center for Renaissance Studies at the University of Massachusetts

Jonathan Burton, West Virginia University

Rebecca Bushnell, University of Pennsylvania

Claire Busse, La Salle University

Katherine Butler, Wayne State University

Martin Butler, University of Leeds

Joanna Montgomery Byles, University of Cyprus

Eric Byville, Loyola University, Chicago

Alberto Cacicedo, Albright College

Patricia A. Cahill, Emory University

Ellen C. Caldwell, Clarkson University

Ellen M. Caldwell, California State University, Fullerton

Ann Cook Calhoun, Vanderbilt University

Joshua M. Calhoun, University of Delaware

Edmund Valentine Campos, Swarthmore College

Catherine G. Canino, University of South Carolina, Upstate

Carol J. Carlisle, University of South Carolina

Brooke Carlson, University of Southern California

John A. Carpenter, University of Central Florida

William C. Carroll, Boston University

Christie Carson, Royal Holloway, University of London

Rob Carson, University of Toronto

Thomas P. Cartelli, Muhlenberg College

Jim E. Casey, University of Alabama

Annalisa Castaldo, Widener University

Sheila T. Cavanagh, Emory University

Susan P. Cerasano, Colgate University

Stephanie Chamberlain, Southeast Missouri State University

Elizabeth A. Charlebois, St. Mary's College of Maryland

Roger Andre Chartier, University of Pennsylvania

Kate Chedgoy, University of Newcastle

Patrick Cheney, Pennsylvania State University

Ann C. Christensen, University of Houston

Darlene Ciraulo, Central Missouri State University

Judith Petterson Clark, Stephens College

Frank Nicholas Clary, Saint Michael's College

Cyndia Susan Clegg, Pepperdine University

Christopher J. Cobb, North Carolina State University

Adam Max Cohen, University of Massachusetts, Dartmouth

Jason Cohen, University of Wisconsin, Madison

Ralph Alan Cohen, American Shakespeare Center

Stephen Cohen, Central Connecticut State University

Anne Coldiron, Louisiana State University

Drew Colenbrander, Delta College

Dan Collins, Nichols School

Susan Comilang, Columbia Union College

Charles Conaway, University of Southern Indiana

James P. Conlan, University of Puerto Rico

Tiffany A. Conroy, Northeastern University

Hardy M. Cook, SHAKSPER

Barbara Correll, Cornell University

Kevin J. Costa, McDonogh School/Chesapeake Shakespeare Company

— FROM THE FOLGER SHAKESPEARE LIBRARY —

Acclaimed editions of Shakespeare's plays

Edited by Barbara A. Mowat and Paul Werstine

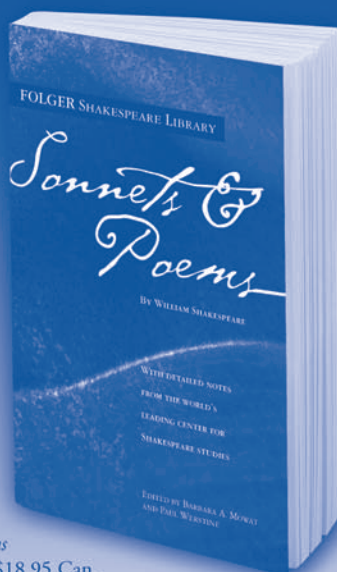

Sonnets & Poems

0-7432-7328-1 • \$13.95/\$18.95 Can.

Each edition includes:

- Freshly edited text based directly on what the editors consider the best early printed version of the play
- Full explanatory notes conveniently placed on pages facing the text of the play
- Scene-by-scene summaries
- An introduction to reading the language of the play
- An essay by an outstanding scholar providing a modern perspective on the play
- Illustrations from the Folger Shakespeare Library's rare-book archives

For a complete list of Folger Shakespeare Library editions,
please send your request to folger.marketing@simonandschuster.com.

To electronically request a desk copy of a Folger Shakespeare Library edition of one of
Shakespeare's plays, log onto to www.simonsaysacademic.com.

For more information, visit www.simonsays.com.

For more information about the Folger Shakespeare Library, visit www.folger.edu.

Folger Shakespeare Library editions are published by Simon & Schuster.



WE HOPE TO SEE YOU
AT OUR BOOTH DURING THE SHOW!

www.simonsays.com

John D. Cox, Hope College
Sandra S. Coyle, College of St. Joseph
Katharine Craik, University of Oxford
Nicholas Crawford, University of Montevallo
Holly A. Crocker, University of South Carolina
Christopher J. Crosbie, Rutgers University
Melissa Croteau, Geneva College
Samuel Crowl, Ohio University
Peter Cummings, Hobart and William Smith Colleges
Kevin D. Curran, McGill University

Alice Dailey, Villanova University
Silver Damsen, University of Illinois, Urbana-Champaign
Robert Darcy, University of Nebraska, Omaha
Adele S. Davidson, Kenyon College
Anthony B. Dawson, University of British Columbia
Margreta de Grazia, University of Pennsylvania
Christy Desmet, University of Georgia
Alan Dessen, University of North Carolina, Chapel Hill
Emily Detmer-Goebel, Northern Kentucky University
Joanne Diaz, Northwestern University
Vernon Guy Dickson, Arizona State University
Lauri S. Dietz, Angelo State University
Cary Anthony DiPietro, University of Toronto, Mississauga
Frances E. Dolan, University of California, Davis
Peter S. Donaldson, Massachusetts Institute of Technology
Kevin Donovan, Middle Tennessee State University
Kurt Douglass, Lehigh University
Lue Douthit, Oregon Shakespeare Festival
Michelle Dowd, University of North Carolina, Greensboro
Annette Drew-Bear, Washington and Jefferson College
Jennifer Drouin, McGill University
Heather Dubrow, University of Wisconsin, Madison
Cheryl M. Dudgeon, University of Western Ontario
Holly Dugan, George Washington University
Leslie C. Dunn, Vassar College
Susan Dunn-Hensley, University of Kansas

Hannah Eagleson, University of Delaware
Gabriel Egan, Loughborough University
Katherine Eggert, University of Colorado, Boulder
Jeremy Ehrlich, Folger Shakespeare Library
Anthony Ellis, Western Michigan University
Lars Engle, University of Tulsa
Lynn Enterline, Vanderbilt University
Douglas Eskew, University of Texas, Austin
David Evett, Cleveland State University

Maria Fahey, CUNY Graduate Center
Raphael Falco, University of Maryland, Baltimore County
Joe Falocco, Catawba College
Darlene Farabee, University of Delaware
Alan B. Farmer, Ohio State University
Jay Farness, Northern Arizona University
Jean Feerick, Brown University
Margaret W. Ferguson, University of California, Davis
Ewan Fernie, Royal Holloway University of London
Kathryn Finin, SUNY, Oneonta
Richard Finkelstein, SUNY, Geneseo
J. Caitlin Finlayson, University of Toronto
Susan L. Fischer, Bucknell University
Will Fisher, CUNY, Lehman
Mary Floyd-Wilson, University of North Carolina, Chapel Hill

Reginald A. Foakes, University of California, Los Angeles
Hillary J. Fogerty, Mercyhurst College
Stephen Merriam Foley, Brown University
John R. Ford, Delta State University
Susan Allen Ford, Delta State University
Valerie Forman, University of Colorado, Boulder
Antonia Forster, University of Akron
Jennifer Forsyth, Kutztown University
Elizabeth Fowler, University of Virginia
Cora Fox, Arizona State University
Timothy Francisco, Youngstown State University
Sanford A. Freedman, Bates College
Karen Fricker, Trinity College, Dublin
Michael D. Friedman, University of Scranton
Lea Luecking Frost, Saint Louis University
Barbara Fuchs, University of Pennsylvania

Evelyn Gajowski, University of Nevada, Las Vegas
Lowell Gallagher, University of California, Los Angeles
Gayle Gaskill, College of St. Catherine
Daniel Gates, Rhodes College
David George, Urbana University
Daniel Gibbons, University of Wisconsin, Madison
Eugene Giddens, Anglia Polytechnic University
Loreen L. Giese, Ohio University
Edward Gieskes, University of South Carolina
Daniel Juan Gil, Texas Christian University
Anne M. Gill, King's College London
Greer Gilman, Harvard University
Jennifer Gjulameti, New York University
Maureen Godman, Washburn University
Sarah Godwin, Auburn University
Tamara A. Goglein, Franklin and Marshall
David Golz, Kettering University
Phyllis Gorfain, Oberlin College
Hugh Grady, Arcadia University
Kenneth Graham, University of Waterloo
Sarah Grandage, University of Nottingham
Barclay Green, Northern Kentucky University
Douglas E. Green, Augsburg College
Martin Green, Baltimore, Maryland
Reina Green, Mount Saint Vincent University
Bradley Greenburg, Northeastern Illinois University
Peter H. Greenfield, University of Puget Sound
Sayre N. Greenfield, University of Pittsburgh, Greensburg
Susanne Greenhalgh, Roehampton University
Andrew Griffin, McMaster University
Elizabeth Gruber, Lock Haven University
John Guillory, New York University
Stephen Guy-Bray, University of British Columbia

Judith Haber, Tufts University
Alexandra Halasz, Dartmouth College
Kim F. Hall, Fordham University
Hannibal Hamlin, Ohio State University
Elizabeth Hanson, Queen's University
Vanessa Harding, Birkbeck, University of London
James L. Harner, World Shakespeare Bibliography/Texas A & M University
Jonathan Gil Harris, George Washington University
Keith Harrison, Malaspina University-College
Andrew James Hartley, University of North Carolina, Charlotte
Elizabeth Harvey, University of Toronto
Joseph Haughey, Western Michigan University
Michael L. Hays, Ashland, OR
Paul J. Hecht, Wake Forest University

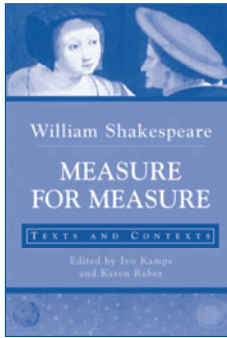

Edited by **Ivo Kamps**
and **Karen Raber**
both of *University of Mississippi*

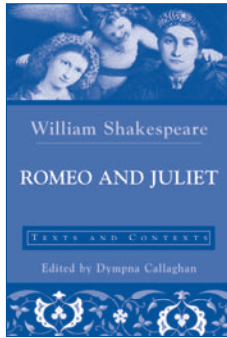

Edited by **Dympna Callaghan**
Syracuse University

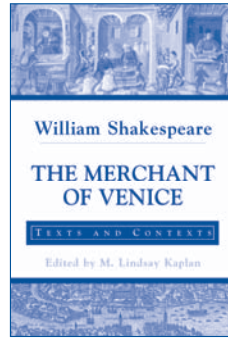

Edited by **M. Lindsay Kaplan**
Georgetown University

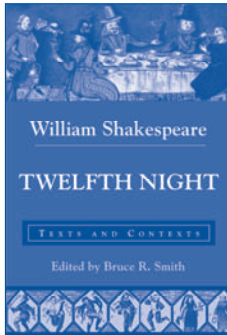

Edited by **Bruce R. Smith**
Georgetown University

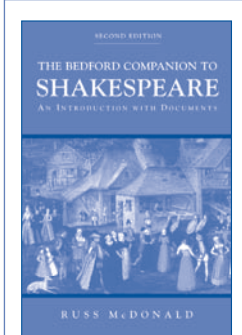

Second Edition
Russ McDonald
University of North Carolina at Greensboro

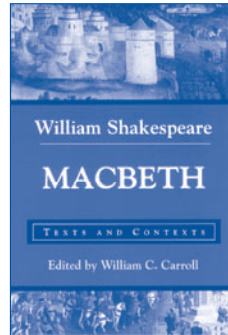

Edited by **William C. Carroll**
Boston University

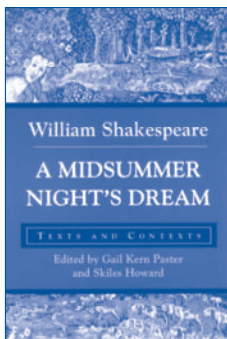

Edited by **Gail Kern Paster**
George Washington University
Skiles Howard, *Rutgers University at New Brunswick*

The Bedford Companion to Shakespeare introduces students to the topics most important to the study of Shakespeare in their full historical and cultural context — now with a chapter on Shakespeare in performance.

2001/paper/373 pages

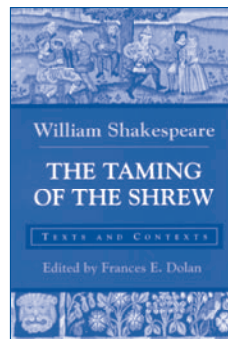

Edited by **Frances E. Dolan**
Miami University

Pierre Hecker, Gustavus Adolphus College
 Donald Hedrick, Kansas State University
 Martha Heimberg, Northwood University
 Herbert Jack Heller, Huntington College
 Frances L. Helphinstine, Morehead State University
 Kirk Hendershott-Kraetzer, Olivet College
 Diana E. Henderson, Massachusetts Institute of Technology
 Margo Hendricks, University of California, Santa Cruz
 Karen S. Henry, Bedford /St. Martin's Press
 Niels Herold, Oakland University
 Thomas Herron, East Carolina University
 Jennifer Higginbotham, University of Pennsylvania
 Heather Anne Hirschfeld, University of Tennessee, Knoxville
 James Hirsh, Georgia State University
 Allison P. Hobgood, Emory University
 Peter Holland, University of Notre Dame
 Gavin Hollis, University of Michigan
 Joan Ozark Holmer, Georgetown University
 Christopher Holmes, University of Toronto
 Jonathan Hope, Strathclyde University
 Mark Houlahan, University of Waikato
 Jean E. Howard, Columbia University
 Kathy M. Howlett, Northeastern University
 Alexander C. Y. Huang, Pennsylvania State University
 Maurice Hunt, Baylor University
 Dianne M. Hunter, Trinity College
 Wendy Beth Hyman, Ithaca College

Giuseppina Iacono, Pennsylvania State University
 William Ingram, University of Michigan
 Emily Isaacson, University of Missouri, Columbia

Russell Jackson, University of Birmingham
 Nicole A. Jacobs, Pennsylvania State University
 Miriam Emma Jacobson, McGill University
 Heather James, University of Southern California
 Christa Jansohn, University of Bamberg
 Joseph Jenkins, University of California, Los Angeles
 Michael P. Jensen, "Talking Books"/Shakespeare Newsletter
 Janelle Jenstad, University of Victoria
 Eric Johnson-DeBaufre, Boston University
 John Jowett, Shakespeare Institute, University of Birmingham
 Ginger Jurecka, Carnegie Mellon University

Rayna Kalas, Cornell University
 Jonathan Kamholtz, University of Cincinnati
 Peter Kanelos, University of San Diego
 Parmita Kapadia, Northern Kentucky University
 Farah Karim-Cooper, Shakespeare's Globe
 David Scott Kastan, Columbia University
 David Kathman, Morningstar
 W. David Kay, University of Illinois, Urbana-Champaign
 James Kearney, Yale University
 Rosemary Kegl, University of Rochester
 Dorothea Kehler, San Diego State University
 Erin E. Kelly, Nazareth College
 Charles Kelly, Howland Research
 Gillian Murray Kendall, Smith College
 William Kerwin, University of Missouri, Columbia
 Harry Keyishian, Fairleigh Dickinson University
 Yvette Khoury, King's College London
 Lucinda Kidder, University of Massachusetts, Amherst
 Mary Jane Kidnie, University of Western Ontario
 Ra Ok Kim, Woosuk University
 Arthur F. Kinney, University of Massachusetts, Amherst

Adam H. Kitzes, University of North Dakota
 Elizabeth Klett, University of Houston
 Bernice W. Kliman, Nassau Community College
 Lisa Klotz, University of North Carolina, Chapel Hill
 Gillian Knoll, University of Maryland, College Park
 Roslyn L. Knutson, University of Arkansas, Little Rock
 Susan Knutson, Université Sainte-Anne
 Yu Jin Ko, Wellesley College
 Justin Kolb, University of Wisconsin, Madison
 Natasha Korda, Wesleyan University
 Lynne Kositsky, Toronto, Canada
 Matt Kozusko, Ursinus College
 Barbara I. Krepes, University of Pisa
 Aaron Kunin, Pomona College
 Stuart M. Kurland, Duquesne University

Mary Ellen Lamb, Southern Illinois University, Carbondale
 Jean Lambert, Anglia Polytechnic University Cambridge
 Anne Lancashire, University of Toronto
 Jesse M. Lander, University of Notre Dame
 David Landreth, University of California, Berkeley
 Unhae Langis, University of Southern California
 Campbell Lathey, Albany, New York
 Courtney Lehmann, University of the Pacific
 Kent Lehnhof, Chapman University
 Rebecca Lemon, University of Southern California
 Patricia J. Lennox, New York University
 Ellen Joy Letostak, University of Florida
 Jill L. Levenson, Trinity College, University of Toronto
 Richard Levin, Stony Brook
 Nina Levine, University of South Carolina
 Fred J. Levy, University of Washington
 Elena Levy-Navarro, University of Wisconsin, Whitewater
 Jennifer Lewin, University of Kentucky
 Cynthia Lewis, Davidson College
 Alan Lewis, Vancouver, BC
 Naomi Conn Liebler, Montclair State University
 Erika T. Lin, University of Louisville
 Anna Lindhe, Centre for Languages and Literature, Lund University
 Elena Lioubimova, Jamestown-Yorktown Foundation
 William T. Liston, Ball State University
 Katherine D. Liu, Amherst College
 William J. Lloyd, Olsson's Books
 Michael LoMonico, Folger Shakespeare Library
 William B. Long, Brooklyn, NY
 Zackariah Long, Sweet Briar College
 David T. Long, University of California, Los Angeles
 Ania Loomba, University of Pennsylvania
 Catherine Loomis, University of New Orleans
 Jeremy Lopez, University of Toronto
 Philip Lorenz, University of Wisconsin, Milwaukee
 Cameron W. Louis, University of Regina
 Genevieve Love, Colorado College
 Robert I. Lublin, University of Massachusetts, Boston
 Kristin Lucas, McGill University
 Christina Luckyj, Dalhousie University
 Kathleen Lynch, Folger Shakespeare Library

Marie Macaia, Sourcebooks, Inc.
 Joyce G. MacDonald, University of Kentucky
 Julia MacDonald, University of North Texas
 Ian MacInnes, Albion College
 Elizabeth Mackay, Miami University, Ohio
 Sally-Beth MacLean, University of Toronto
 Laury Magnus, U.S. Merchant Marine Academy
 Lynne Magnusson, University of Toronto

New from OXFORD

Visit the Oxford booth for discounts on these and many other titles



THE EARLY STUART MASQUE

Dance, Costume, and Music
BARBARA RAVELHOFFER
2006 \$99.00

RECONCEIVING THE RENAISSANCE

EWAN FERNIE, RAMONA WRAY, MARK THORNTON BURNETT, and CLARE MCMANUS
2005 paper \$29.95

CHRISTOPHER MARLOWE

Poet & Spy
PARK HONAN
2006 \$32.50

BEN JONSON IN THE ROMANTIC AGE

TOM LOCKWOOD
2005 \$85.00

LANCELOT ANDREWES

Selected Sermons and Lectures
Edited by PETER MCCULLOUGH
2006 \$165.00

DRUGS AND THEATER IN EARLY MODERN ENGLAND

TANYA POLLARD
2005 \$74.00

SHAKESPEARE AND WOMEN

PHYLLIS RACKIN
(Oxford Shakespeare Topics)
2005 paper \$19.95 cloth \$49.95

RENAISSANCE ENGLAND'S CHIEF RABBI

John Selden
JASON P. ROSENBLATT
2006 \$110.00

THE TWO NOBLE KINSMEN

WILLIAM SHAKESPEARE and JOHN FLETCHER
Edited by ERIC RASMUSSEN and G. R. PROUDFOOT
(Malone Society Reprints 169)
2006 \$49.95

OTHELLO

WILLIAM SHAKESPEARE
Edited by MICHAEL NEILL
(The Oxford Shakespeare)
March 2006 paper \$8.95 cloth \$99.00

THE ENGLISH RENAISSANCE STAGE

Geometry, Poetics, and the Practical Spatial Arts 1580–1630
HENRY S. TURNER
2006 \$99.00

WRITING UNDER TYRANNY

English Literature and the Henrician Reformation
GREG WALKER
2005 \$120.00

A DICTIONARY OF SHAKESPEARE

Reissue
STANLEY WELLS
(Oxford Paperback Reference)
2005 paper \$16.95

THE OXFORD SHAKESPEARE

The Complete Works
Second Edition
Edited by STANLEY WELLS, GARY TAYLOR, JOHN JOWETT, and WILLIAM MONTGOMERY
2005 \$40.00

FICTIONS OF AUTHORSHIP IN LATE ELIZABETHAN NARRATIVES

Euphues in Arcadia
KATHARINE WILSON
(Oxford English Monographs)
2006 \$74.00

SHAKESPEARE: AN OXFORD GUIDE

Edited by STANLEY WELLS and LENA COWEN ORLIN
2003 paper \$29.95

OXFORD
UNIVERSITY PRESS

Prices are subject to change and apply only in the US. To order, or for more information, please call 1-800-451-7556. In Canada, call 1-800-387-8020. Visit our website at www.oup.com/us.

Laurie E. Maguire, Magdalen College, Oxford
 Scott Maisano, University of Massachusetts, Boston
 Andrew Majeske, University of California, Davis
 Cristina Malcolmsen, Bates College
 Lawrence Manley, Yale University
 James Mardock, Ripon College
 James J. Marino, Cleveland State University
 Robert Markley, University of Illinois, Urbana-Champaign
 Zoltan Markus, Vassar College
 Karen Sawyer Marsalek, St. Olaf College
 Mathew R. Martin, Brock University
 Steven Marx, California Polytechnic State University
 Sonia Massai, King's College London
 Christopher Matusiak, University of Toronto
 Margaret Maurer, Colgate University
 Katharine Eisaman Maus, University of Virginia
 Jean-Christophe Mayer, French National Center for Scientific Research
 Cary M. Mazer, University of Pennsylvania
 Ian McAdam, University of Lethbridge
 Penny McCarthy, University of Glasgow
 Jennifer Adair McCausland, University of South Carolina
 Michael McClintock, McKendree College
 Richard C. McCoy, CUNY
 Lynsey McCulloch, Anglia Ruskin University
 Russ McDonald, University of North Carolina, Greensboro
 Lisa J. McDonnell, Denison University
 Maureen McDonnell, Eastern Connecticut State University
 Claire McEachern, University of California, Los Angeles
 Gordon McMullan, King's College London
 Richard Meek, University of Reading
 Dieter Mehl, University of Bonn
 Kirk Melnikoff, University of North Carolina, Charlotte
 Sergio Nunes Melo, University of Toronto
 Steve Mentz, St. John's University
 David L. Middleton, Trinity University
 Barbara Miller, Hughsonville, NY
 Erin Minear, Harvard University
 Gretchen E. Minton, University of Minnesota, Morris
 Bella Mirabella, New York University
 Alfredo Michel Modenesi, Universidad Nacional Autonoma De Mexico
 Nona Monahan, Five College Early Music Program/Amherst College
 Robert L. Montgomery, University of California, Irvine
 John Moore, Pennsylvania State University
 Andrew Moore, University of Western Ontario
 Gaywin Moore, University of Kansas
 Simon Morgan-Russell, Bowling Green State University
 David J. Morrow, Michigan State University
 Ruth Morse, Université Paris - 7
 Nicholas Moschovakis, Reed College
 Charles Moseley, University of Cambridge
 Barbara A. Mowat, Folger Shakespeare Library
 Rolf O. Mueller, Fanny-Leicht-Gymnasium, Stuttgart
 Subha Mukherji, Fitzwilliam College
 Steven Mullaney, University of Michigan
 Cyrus G. Mulready, University of Pennsylvania
 Ian Munro, University of California, Irvine
 Lucy Munro, Keele University
 Heather Murray, Pennsylvania State University
 Katie Musgrave, Université de Montréal
 Nova Myhill, New College of Florida
 Vin Nardizzi, Duke University
 Anna K. Nardo, Louisiana State University
 Joseph Navitsky, Boston University
 Carol Thomas Neely, University of Illinois, Urbana-Champaign
 Michael Neill, University of Auckland
 Alan H. Nelson, University of California, Berkeley
 Karen Nelson, University of Maryland, College Park
 Scott Newstok, Gustavus Adolphus College
 Richard L. Nochimson, Yeshiva University
 Kara Northway, Xavier University
 John J. Norton, Concordia University
 Marianne Novy, University of Pittsburgh
 Hillary M. Nunn, University of Akron
 John O'Connor, Silver Spring, MD
 Sharon O'Dair, University of Alabama
 Niamh O'Leary, Pennsylvania State University
 Susan O'Malley, City University of New York
 James O'Rourke, Florida State University
 Frank Occhiogrosso, Drew University
 Elisa Oh, Boston University
 Gloria Olchoway, Edmonton, Alberta
 Susan Oldrieve, Baldwin-Wallace College
 Kristen L. Olson, Pennsylvania State University
 Lena Cowen Orlin, University of Maryland, Baltimore County
 Laurie E. Osborne, Colby College
 Michele Osherow, University of Maryland, Baltimore County
 Helen Ostovich, McMaster University
 Allison Outland, Columbia University
 Margaret E. Owens, University of British Columbia
 Avraham Oz, University of Haifa
 Simon Palfrey, University of Liverpool
 Barbara D. Palmer, University of Mary Washington
 Daryl W. Palmer, Regis University
 Jennifer Panek, University of Ottawa
 Angela Pao, Indiana University
 Barbara L. Parker, William Paterson University
 Joan Parks, Kent State University, Stark
 Peter Parolin, University of Wyoming
 Glyn Parry, Victoria University of Wellington
 Gail Kern Paster, Folger Shakespeare Library
 Linda Levy Peck, George Washington University
 Elizabeth Pentland, Stanford University
 Curtis Perry, Arizona State University
 David Perry, U.S. Army War College
 Duke Pesta, Oklahoma State University
 Kaara L. Peterson, Miami University
 Holly Crawford Pickett, Washington and Lee University
 Robert B. Pierce, Oberlin College
 Elizabeth E. Pohland, Folger Shakespeare Library
 Tanya Pollard, Montclair State University
 Kristen Poole, University of Delaware
 Joseph A. Porter, Duke University
 Aaron Posner, Arden Theatre Company
 Lois Potter, University of Delaware
 Alan W. Powers, Bristol Community College
 Richard Preiss, Stanford University
 Maria Teresa Prendergast, Grinnell College
 Anne Lake Prescott, Barnard College
 Paul Prescott, Warwick University
 Erin Presley, University of Georgia
 Kendrick W. Prewitt, University of the Ozarks
 Irina S. Prikhod'ko, The Institute of World Literature, Russian Academy of Sciences
 George Richard Proudfoot, King's College London
 James Purkis, University of Western Ontario

Hamlet was first printed in 1603, but within twenty years two further texts had appeared. All previous editors have constructed a single play out of at least two of these three early texts. Ann Thompson and Neil Taylor edit each separately, in modern spelling and with its own explanatory notes.

Published in two volumes, this edition gives readers the opportunity to read the three major surviving texts of Shakespeare's greatest play in a modernised, fully annotated edition for the first time.

Hamlet

The core, free-standing volume gives readers the Second Quarto text of 1604-1605. With a full, illustrated introduction to the play's historical, cultural and performance contexts and a thorough survey of critical approaches to the play, the volume also includes an appendix with the additional passages found only in the 1623 text.

Edited by Ann Thompson and Neil Taylor

Paperback • 1904271332 • \$13.99

Hardback • 1904271324 • \$79.99



Hamlet: The Texts of 1603 and 1623

This second, companion volume gives readers the First Quarto text of 1603 and the Folio Text of 1623. Both play texts are modernised and fully edited to the usual Arden standard and the introduction contains the fullest available stage history of the First Quarto text.

Edited by Ann Thompson and Neil Taylor

Hardback • 1904271553 • \$59.99



Ann Thompson is Professor of English and Head of the School of Humanities at King's College, London. She is a General Editor of the Arden Shakespeare, co-editor of the Arden Shakespeare Complete Works, editor of *The Taming of the Shrew* and author of many critical works.

Neil Taylor is Dean of Research at Roehampton Institute. He has previously edited *Henry IV Part Two* and written a number of critical studies of Shakespeare.

Visit the Arden stand to find out more and to receive unique conference discounts.

Karen Raber, University of Mississippi
 Phyllis Rackin, University of Pennsylvania
 Mark Rankin, Ohio State University
 Sid Ray, Pace University
 Robert Reeder, Providence College
 Eileen Reeves, Princeton University
 Robert L. Reid, Emory and Henry College
 Bryan Reynolds, University of California, Irvine
 Paige Reynolds, University of North Texas
 Lawrence F. Rhu, University of South Carolina
 Jane Rickard, University of Leeds
 Milla C. Riggio, Trinity College
 Sarah Rivett, Washington University in St. Louis
 Jeanne A. Roberts, American University
 Peter R. Roberts, University of Kent, Canterbury
 Markley Roberts, American University
 Jennifer Roberts-Smith, University of Toronto
 Karen Robertson, Vassar College
 Marsha S. Robinson, Kean University
 Mark Robson, University of Nottingham
 Edward L. Rocklin, California State Polytechnic
 University, Pomona
 William J. Rogers, University of Wisconsin, Madison
 Hank Rogerson, Philomath Films
 Martha Ronk, Occidental College
 Tom Rooney, Eotvos Lorand University
 Katherine Rowe, Bryn Mawr College
 Marjorie Rubright, University of Michigan
 David Ruitter, University of Texas, El Paso
 Valentina Ryapolova, Russian Academy of Sciences
 Shakespeare Commission
 Bradley David Ryner, University of Delaware

 Michael Saenger, Southwestern University
 Carolyn Sale, University of Windsor
 Julie Sanders, University of Nottingham
 Rhonda Lemke Sanford, Fairmont State College
 Matthew Sauter, University of Delaware
 Robert Sawyer, East Tennessee State University
 Katherine Scheil, University of Minnesota
 June Schlueter, Lafayette College
 Ben R. Schneider, Jr., Lawrence University
 Kurt Schreyer, University of Pennsylvania
 Carole Schuyler, Dixie State College of Utah
 Kathryn Schwarz, Vanderbilt University
 Charlotte Scott, Goldsmiths College, University of
 London
 Sarah K. Scott, College of Charleston
 William O. Scott, University of Kansas
 Amy Scott-Douglass, Denison University
 Tracey Sedinger, University of Northern Colorado
 Gregory M. Colon Semenza, University of Connecticut
 Meg Semprea, Webster University
 Laurie Shannon, Duke University
 James Shapiro, Columbia University
 Robert Martin Shaughnessy, University of Kent
 Colleen E. Shea, Queen's University
 Anita Gilman Sherman, American University
 William H. Sherman, University of York
 Emily Sherwood, Hunter College, CUNY
 Katherine Shrieves, University of North Carolina,
 Chapel Hill
 Michael Shurgot, South Puget Sound Community
 College
 James R. Siemon, Boston University
 Stuart Sillars, University of Bergen
 Barbara Silverstein, University of Delaware
 Catherine Silverstone, Anglia Ruskin University
 Alan Sinfield, University of Sussex
 Bethany S. Sinnott, Catawba College

 Gerald P. Skelton, Jr., Summer Shakespeare,
 University of Notre Dame
 Meredith Skura, Rice University
 Jessica Slights, Acadia University
 Joel Slotkin, Stanford University
 Bruce R. Smith, University of Southern California
 Emma Smith, University of Oxford
 Ian Smith, Lafayette College
 Melissa Smith, George Washington University
 Peter J. Smith, Nottingham Trent University
 Alan Somers, University of Western Ontario
 Geraldo U. de Sousa, University of Kansas
 Eric V. Spencer, Albertson College
 Elizabeth A. Spiller, Texas Christian University
 John Staines, Earlham College
 Peter Stallybrass, University of Pennsylvania
 Goran V. Stanivukovic, University of Sheffield
 Audrey E. Stanley, University of California, Santa Cruz
 Kay Stanton, California State University, Fullerton
 Michael L. Stapleton, Indiana University/Purdue
 University, Fort Wayne
 Rebecca Stark-Gendrano, Fordham University
 Lisa S. Starks, University of South Florida, St.
 Petersburg
 Janet Wright Starner, Wilkes University
 Matthew Steggle, Sheffield Hallam University
 Paul Dustin Stegner, Pennsylvania State University
 Mary K. Steible, Southern Illinois University
 Tiffany Stern, University College, Oxford
 Andrea R. Stevens, University of Virginia
 Alan Stewart, Columbia University
 William Stockton, Indiana University, Bloomington
 Marta Straznicki, Queen's University
 Richard Strier, University of Chicago
 Roger Stritmatter, Coppin State University
 Randall Styers, University of North Carolina, Chapel
 Hill
 Garrett A. Sullivan, Jr., Pennsylvania State University
 Joseph Michael Sullivan, Marietta College
 Alicia Anne Sutliff, University of Kansas
 Holger Schott Syme, University of Toronto,
 Mississauga

 Patricia E. Tatspaugh, London, United Kingdom
 Nina Taunton, Brunel University
 Neil Taylor, Roehampton University
 Jeffrey S. Theis, Salem State College
 Catherine E. Thomas, College of Charleston
 Chad Thomas, University of Michigan
 Ann Thompson, King's College London
 Ayanna Thompson, Arizona State University
 Liz Thompson, Routledge
 Leslie Thomson, University of Toronto
 Amy L. Tigner, Stanford University
 John J. M. Tobin, University of Massachusetts, Boston
 Lucy Tobin, Philadelphia Shakespeare Festival
 Polyxa Tocheva, University of Connecticut
 Curt L. Tofteland, Shakespeare Behind Bars
 Sophie Tomlinson, University of Auckland
 Barbara Traister, Lehigh University
 Evelyn B. Tribble, University of Otago
 Mary Trull, St. Olaf College
 Andrew Tummia, Fordham University
 Henry S. Turner, University of Wisconsin, Madison
 Alison Tymoczko, University of Southern California

 Deborah Uman, St. John Fisher College
 Steven Urkowitz, City College of New York
 Cristine M. Varholj, Hampden-Sydney College
 Virginia Mason Vaughan, Clark University

“One of the few genuinely original biographies of Shakespeare.”

—Jonathan Bate, *Sunday Telegraph*

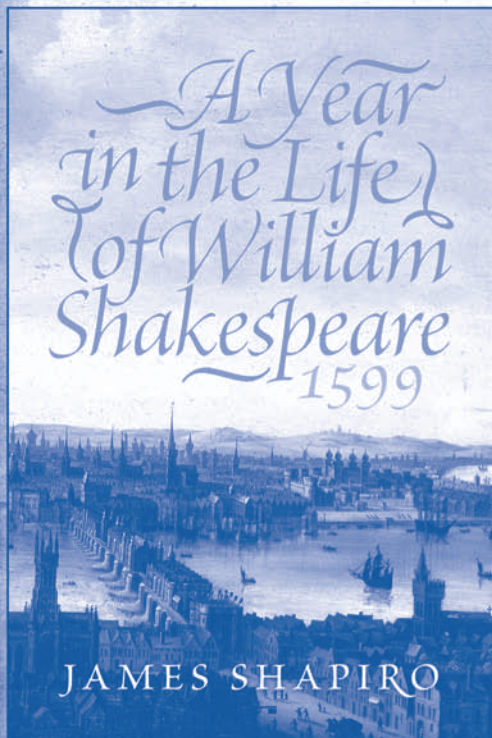

*A Year in the
Life of William
Shakespeare*

1599

James Shapiro

ISBN 0-06-008873-7

416 pages • hardcover

\$27.95 (\$37.95 Can.)

Also available abridged
on CD from HarperAudio
and as an e-book from
PerfectBound

“This passionately written study, the product of deep scholarship and acute critical thought, offers fascinating illumination of some of Shakespeare’s greatest plays and of the experiences that produced them.”

—Stanley Wells, Editor of *The Oxford Shakespeare*



HarperCollins Publishers

www.HarperAcademic.com

Visit the HarperCollins booth in the Exhibit Hall!

Jennifer Waldron, University of Pittsburgh
Denise A. Walen, Vassar College
Lewis Walker, University of North Carolina,
Wilmington
Sarah Wall-Randall, Wellesley College
Gary Waller, Purchase College, SUNY
Brian Walsh, University of Illinois, Urbana-Champaign
Melissa Walter, University of Oregon
Jay A. Ward, Thiel College
Kathleen A. Ward, Thiel College
Christopher Warley, University of Toronto
Michael Warren, University of California, Santa Cruz
Edward T. Washington, Mansfield University
Robert N. Watson, University of California, Los
Angeles
Valerie Wayne, University of Hawai'i
Sarah R. Webster, California State University,
Fullerton
Herb Weil, University of Manitoba
Judith Weil, University of Maryland
Lawrence Weiss, New York, NY
Sarah Werner, Folger Shakespeare Library

Paul Werstine, King's University College, University of
Western Ontario
Charles Whitney, University of Nevada, Las Vegas
Agnes Wilcox, Prison Performing Arts
Lina Perkins Wilder, Carleton College
William Proctor Williams, University of Akron
Deanne Williams, York University
Elizabeth Williamson, Evergreen State College
Emily Wineroock, University of Toronto
Susanne L. Wofford, University of Wisconsin, Madison
Robert E. Wood, Georgia Tech
Amanda Leigh Wood, Auburn University
Linda Woodbridge, Pennsylvania State University
W. B. Worthen, University of California, Berkeley

Paul Yachnin, McGill University
Sharon R. Yang, Worcester State College
Alan R. Young, Acadia University

Timothy Zajac, University of Virginia
John Ziegler, Fordham University
Georgianna Ziegler, Folger Shakespeare Library

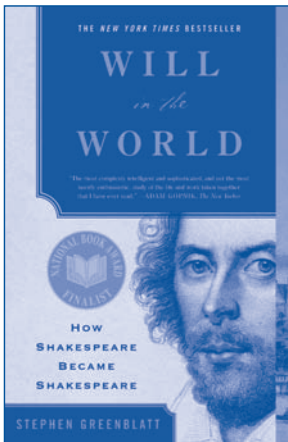

New! College Paperback Edition

Stephen Greenblatt

WILL IN THE WORLD

How Shakespeare Became Shakespeare

“Certain to secure a place among the essential studies of the greatest of all writers.”
—William E. Cain, Wellesley College

Instructors may order *Will in the World* packaged with *The Norton Shakespeare* for a low supplemental cost by using ISBN 0-393-16312-4.

W. W. Norton & Company



Independent and Employee-Owned

wwnorton.com • 800.233.4830



KNOPF

A DIVISION OF RANDOM HOUSE, INC.

BOOTH 710

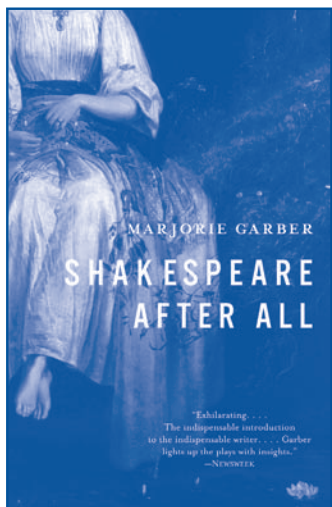

MARJORIE GARBER

SHAKESPEARE AFTER ALL

ANCHOR | PAPER | 1008 PAGES | \$20.00

A brilliant and comprehensive tour through all thirty-eight plays, *Shakespeare After All* is the best one-volume critical guide to the bard by one of the country's foremost authorities on his life and work. Drawing on her hugely popular lecture courses at Yale and Harvard over the past thirty years, Marjorie Garber offers passionate and revealing readings of the plays in chronological

sequence, from *The Two Gentlemen of Verona* to *The Two Noble Kinsmen*. Supremely readable and engaging, and complete with a comprehensive introduction to Shakespeare's life and times and an extensive bibliography, this magisterial work is an ever-replenishing fount of insight on the most celebrated writer of all time.

"Until somebody even smarter than Garber comes along... this is the indispensable introduction to the indispensable writer... She's continually mindful of both Shakespeare's universality and his specific historical context as well as his original stage... Garber's is the most exhilarating seminar room you'll ever enter."

—David Gates, *Newsweek*

"Marjorie Garber's Shakespeare courses at Yale and Harvard have played to packed houses for years. Now, in a bravura performance, she offers all readers of Shakespeare the benefits of her wit and learning, in a wondrously lively and authoritative study that takes up the plays one by one."

—Jonathan Culler, Professor of English and Comparative Literature, Cornell University

Knopf Academic Marketing, 1745 Broadway, 20th Floor, New York, NY 10019
www.randomhouse.com/academic | acmart@randomhouse.com



NEW and FORTHCOMING LITERATURE STUDIES from Blackwell



**English
Renaissance Drama**
PETER WOMACK
Blackwell Guides to Literature
MAY ~ 6 X 9 ~ 296 PAGES

**How to Read a
Shakespeare Play**
DAVID BEVINGTON
How to Study Literature
APRIL ~ 6 X 9 ~ 176 PAGES

**A Companion to
Shakespeare and
Performance**
Edited by
BARBARA HODGDON,
W. B. WORTHEN
Blackwell Companions to Literature
and Culture
JANUARY ~ 6.75 X 9.75 ~ 704 PAGES

**A Concise Companion
to Shakespeare
on Screen**
Edited by
DIANA HENDERSON
Concise Companions to Literature
and Culture
JANUARY ~ 6 X 9 ~ 288 PAGES

**Renaissance and
Reformations**
An Introduction to Early Modern
English Literature
MICHAEL HATTAWAY
Blackwell Introductions to Literature
2005 ~ 6 X 9 ~ 264 PAGES

**England and the
Italian Renaissance**
*The Growth of Interest in its
History and Art*
FOURTH EDITION
JOHN HALE
Blackwell Classic Histories of Europe
2005 ~ 6 X 9 ~ 192 PAGES



New in paperback!
**A Companion to
Shakespeare's Works,
Volume I**
The Tragedies
Edited by RICHARD DUTTON,
JEAN HOWARD
Blackwell Companions to Literature
and Culture
2005 ~ 6.75 X 9.75 ~ 504 PAGES

New in paperback!
**A Companion to
Shakespeare's Works,
Volume II**
Shakespeare's Histories
Edited by RICHARD DUTTON,
JEAN HOWARD
Blackwell Companions to Literature
and Culture
2005 ~ 6.75 X 9.75 ~ 496 PAGES

New in paperback!
**A Companion to
Shakespeare's Works,
Volume III**
The Comedies
Edited by RICHARD DUTTON,
JEAN HOWARD
Blackwell Companions to Literature
and Culture
2005 ~ 6.75 X 9.75 ~ 480 PAGES

New in paperback!
**A Companion to
Shakespeare's Works,
Volume IV**
*The Poems, Problem Comedies,
Late Plays*
Edited by RICHARD DUTTON,
JEAN HOWARD
Blackwell Companions to Literature
and Culture
2005 ~ 6.75 X 9.75 ~ 496 PAGES

Shakespeare
The Seven Ages of Human Experience
SECOND EDITION
DAVID BEVINGTON
2005 ~ 6 X 9 ~ 280 PAGES

**A Companion to
Tragedy**
Edited by
REBECCA BUSHNELL
Blackwell Companions to Literature
and Culture
2005 ~ 6.75 X 9.75 ~ 568 PAGES

JOURNALS FROM BLACKWELL

Now 5 issues!
Renaissance Studies
*Journal of the Society for
Renaissance Studies*
Editor: JOHN E. LAW
Renaissance Studies is a multi-
disciplinary journal which
publishes articles and editions of
documents on all aspects of
Renaissance history and culture.
www.blackwellpublishing.com/rest

**English Literary
Renaissance**
Editor: ARTHUR F. KINNEY
English Literary Renaissance is a
journal devoted to current criticism
and scholarship of Tudor and early
Stuart English literature, 1485-1665,
including Shakespeare, Spenser,
Donne, and Milton.
www.blackwellpublishing.com/elr

Milton Quarterly
Editor: EDWARD JONES
Milton Quarterly reflects the aims
and interests of the world-wide
community of people interested in the
poet and author best known for
Paradise Lost, John Milton.
www.blackwellpublishing.com/mlt

**History Compass and
Literature Compass**
Inspiring New Online Journals

History Compass and *Literature
Compass* offer peer-reviewed surveys
of the most important research across
the disciplines. There are nearly 200
articles available on both *History
Compass* and *Literature Compass*
with a further 100 papers added each
year.
Explore The *Compass* Journals at
www.blackwell-compass.com and
sign up for email table of contents
alerts!

Also Available
*New in 2006 and now publishing
three issues per volume!*
Leviathan
www.blackwellpublishing.com/levi
**The Journal of Aesthetics and
Art Criticism**
www.blackwellpublishing.com/jaac
Now Online!
The Yale Review
www.blackwellpublishing.com/yr



For more information on our full list of Literature books and journals
visit www.blackwellpublishing.com, or
visit our booth and pick up a free catalog of publications.



THE SHAKESPEARE HANDBOOKS

The *Shakespeare Handbooks* are introductory guides to each of the key plays, offering students a scene-by-scene commentary, contextual documents, a brief history of the text and its first performances and productions, as well as a wide sampling of critical opinion and annotated further reading.

Focusing on the plays in performance, their primary aim is to help students experience the play as a text to be performed rather than to be read. The Handbooks provide an experience as close to a visit to the theater as possible in print and offer a scene-by-scene aid to coming to an informed and independent opinion about the achievement of each play.

MUCH ADO ABOUT NOTHING

Roger Apfelbaum
Shakespeare Handbooks
May 2006 / 176 pp. / 1-4039-9357-2 / \$59.95 cl.
1-4039-9358-0 / \$16.95 pb.

THE TAMING OF THE SHREW

Margaret Jane Kidnie
Shakespeare Handbooks
May 2006 / 176 pp. / 1-4039-4539-X / \$59.95 cl.
1-4039-4540-3 / \$16.95 pb.

HENRY V

Kevin Ewert
Shakespeare Handbooks
176 pp. / 1-4039-4076-2 / \$59.95 cl.
1-4039-4077-0 / \$16.95 pb.

ANTONY AND CLEOPATRA

Bridget Escolme
Shakespeare Handbooks
176 pp. / 1-4039-4206-4 / \$59.95 cl.
1-4039-4207-2 / \$16.95 pb.

MACBETH

John Russell Brown
Shakespeare Handbooks
188 pp. / 1-4039-2093-1 / \$16.95 pb.
1-4039-3385-5 / \$59.95 cl.

AS YOU LIKE IT

Lesley Wade Soule
Shakespeare Handbooks
184 pp. / 1-4039-3629-3 / \$16.95 pb.
1-4039-3630-7 / \$59.95 cl.

TWELFTH NIGHT

Paul Edmondson
Shakespeare Handbooks
192 pp. / 1-4039-2094-X / \$16.95 pb.
1-4039-3386-3 / \$59.95 cl.

HAMLET

John Russell Brown
Shakespeare Handbooks
176 pp. / 1-4039-2092-3 / \$16.95 pb.
1-4039-3387-1 / \$59.95 cl.

RICHARD III

Paul Prescott
Shakespeare Handbooks
May 2006 / 176 pp. / 1-4039-4143-2 / \$59.95 cl.
1-4039-4144-0 / \$16.95 pb.

THE MERCHANT OF VENICE

Christopher McCullough
Shakespeare Handbooks
176 pp. / 1-4039-3959-4 / \$59.95 cl.
1-4039-3960-8 / \$16.95 pb.

PERFORMANCE TO PRINT IN SHAKESPEARE'S ENGLAND

Edited by Peter Holland and Stephen Orgel
Redefining British Theatre History
256 pp. / 1-4039-9228-2 / \$90.00 cl.

REMATERIALIZING SHAKESPEARE

Authority and Representation on the Early Modern English Stage
Edited by Bryan Reynolds and William West
256 pp. / 1-4039-9120-0 / \$65.00 cl.

THE SHAKESPEAREAN DRAMATURG

A Theoretical and Practical Guide
Andrew James Hartley
248 pp. / 1-4039-7007-6 / \$24.95 pb.
1-4039-7006-8 / \$65.00 cl.

SHAKESPEARE'S ENTRAILS

Skepticism, Solitude and the Interior Body
David Hillman
Palgrave Shakespeare Studies
256 pp. / 1-4039-4267-6 / \$74.95 cl.

TRAGEDY AND SCEPTICISM IN SHAKESPEARE'S ENGLAND

William M. Hamlin
Early Modern Literature in History
304 pp. / 1-4039-4598-5 / \$69.95 cl.

TRANSVERSAL ENTERPRISES IN THE DRAMA OF SHAKESPEARE AND HIS CONTEMPORARIES

Fugitive Explorations
Bryan Reynolds
May 2006 / 256 pp. / 1-4039-3211-5 / \$69.95 cl.

VISIT US AT OUR DISPLAY!

palgrave
macmillan

Distributor of Berg Publishers, I.B.Tauris,
Manchester University Press, and Zed Books
(888) 330-8477 • Fax: (800) 672-2054 • www.palgrave-usa.com

Searching for Shakespeare

A major exhibition at the Yale Center for British Art

June 23–September 17, 2006



The National Portrait Gallery in London is celebrating its 150th anniversary with an exhibition of 150 objects contextualizing the Gallery's first acquisition (in 1856), the "Chandos" portrait of Shakespeare. On display will be "contender" portraits of Shakespeare, portraits of his contemporaries and patrons (including Richard Burbage, the Earl of Southampton, Ben Jonson, and Francis Bacon), documents from his life (including his will), first editions of his plays and poems, rare Elizabethan theatrical costumes, and manuscript and print materials relating to the Elizabethan stage. Other lending institutions include the Victoria and Albert Museum, the Shakespeare Birthplace Trust, the Royal Shakespeare Company, the Museum of London, the Folger Shakespeare Library, the Yale Center for British Art, the Yale Elizabethan Club, and the Beinecke Rare Book and Manuscript Library.

The Yale Center for British Art is the only U.S. venue to present "Searching for Shakespeare." The Center has arranged for reduced rates at the New Haven Omni Hotel for members of the Shakespeare Association of America.

The Yale Center for British Art

1080 Chapel Street, New Haven, Connecticut 06520-8280

Website: www.yale.edu/ycba

E-mail: ycba.info@yale.edu

Phone: 203 432 2800

AVAILABLE FOR PURCHASE
THE AWARD WINNING DOCUMENTARY

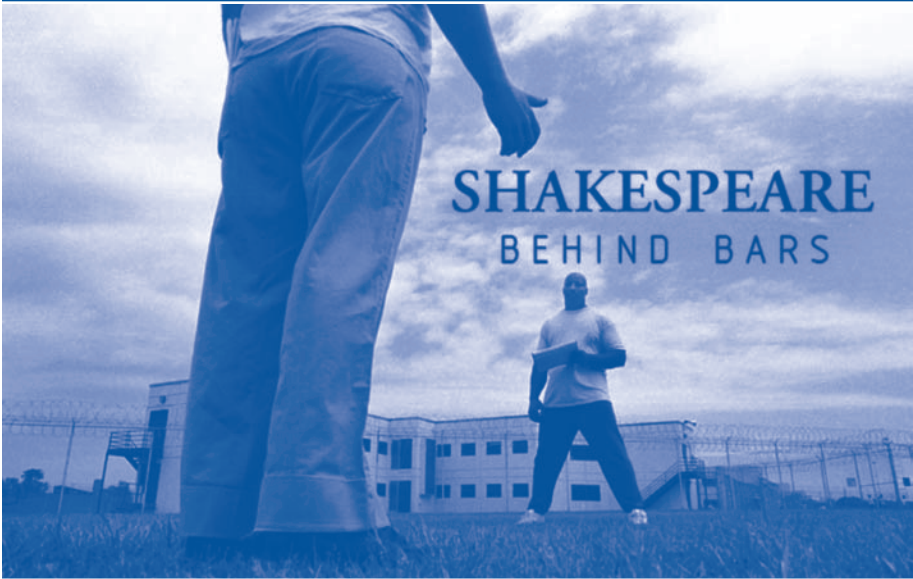

SHAKESPEARE BEHIND BARS is a profoundly moving film that follows the casting, rehearsal, and presentation of Shakespeare's play, *The Tempest*, by convicted felons inside a Kentucky prison.

"Remarkable!" - *NY Times*

"Powerful. Ingenious." - *Village Voice*

**DVD COPIES AVAILABLE BY ORDER FOR
SAA 2006 Meeting ATTENDEES ONLY
SPECIAL PRICE OF \$175.00 (normally \$295.00)**
Order your DVD at www.philomathfilms.com or mail this form.

I would like _____ copy / copies of the DVD *Shakespeare Behind Bars* at the exclusive SAA price of \$175.00 per DVD, plus \$5.00 for shipping and handling per DVD. Please ship my order to:

Name _____

Address _____

Please enclose a check or money order (no credit cards, please) for the total amount, and mail your completed order form to:
Philomath Films, 454 ½ North Spaulding Avenue, Los Angeles, CA 90036
info@philomathfilms.com



THE SHAKESPEARE
ASSOCIATION
OF AMERICA

University of Maryland,
Baltimore County
1000 Hilltop Circle
Baltimore, Maryland
21250

PHONE: 410-455-6788
FAX: 410-455-1063
E-MAIL: saa@umbc.edu

Shakespeare