



SHAKESPEARE
ASSOCIATION
OF AMERICA

PROGRAM OF THE
38TH ANNUAL MEETING

1-3 APRIL 2010

THE HYATT REGENCY
CHICAGO

shakespeare

The 38th Annual Meeting of the Shakespeare Association of America

Executive Director

LENA COWEN ORLIN
Georgetown University

Memberships Manager

DONNA EVEN-KESEF
Georgetown University

Publications Manager

BAILEY YEAGER
Georgetown University

President

PAUL YACHNIN
McGill University

Vice-President

RUSS McDONALD
Goldsmiths College, University of London

Immediate Past President

COPPÉLIA KAHN
Brown University

Trustees

REBECCA BUSHNELL
University of Pennsylvania

KENT CARTWRIGHT
University of Maryland

HEATHER JAMES
University of Southern California

LYNNE MAGNUSSON
University of Toronto

ERIC RASMUSSEN
University of Nevada

VALERIE WAYNE
University of Hawai'i

Program Planning Committee

REBECCA BUSHNELL, Chair
University of Pennsylvania

LINDA CHARNES
Indiana University

ANDREW JAMES HARTLEY
University of North Carolina, Charlotte

JAMES KEARNEY
University of California, Santa Barbara

Local Arrangements

SUZANNE GOSSETT
Loyola University Chicago

With the assistance of:

DAVID BEVINGTON
University of Chicago

JOHN D. COX
Hope College

BRADLEY GREENBURG
Northeastern Illinois University

PETER HOLLAND
University of Notre Dame

KENNETH S. JACKSON
Wayne State University

CAROL THOMAS NEELY
University of Illinois, Urbana-Champaign

CURTIS PERRY
University of Illinois, Urbana-Champaign

RICHARD STRIER
University of Chicago

VALERIE TRAUB
University of Michigan

WENDY WALL
Northwestern University

MICHAEL WITMORE
University of Wisconsin

**Sponsors of the 38th
Annual Meeting**

Loyola University Chicago

University of Notre Dame

University of Chicago

University of Illinois, Urbana-
Champaign

University of Michigan

Northwestern University

Wayne State University

Northeastern Illinois University

University of Wisconsin

Hope College

and

Georgetown University

2010 Program Guide

Thursday, 1 April

10:00 a.m.	Registration in Regency Foyer	6
	Book Exhibits in Regency Foyer	6
	Buses Depart for Backstage Tour of the Chicago Shakespeare Theater	6
1:30 p.m.	Presentation in Regency AB: Understanding the Work and Vitality of Chicago Shakespeare Theater's Art on the World's Stage	6
	Presentation in Regency CD: Women and the Invention of Early Modern Law	6
3:00 p.m.	Party in Regency Foyer: <i>SEL</i> Anniversary	6
3:30 p.m.	Film Screening in Grand AB: <i>Othello: The Tragedy of the Moor</i>	6
	Seminar in Ogden Room: Artisanal Knowledge and the Stage	7
	Seminar in Columbian Room: Gendering Childhood in Shakespeare's England	7
	Seminar in Dusable Room: Genre and/as Culture	7
	Seminar in Buckingham Room: Making History: Archives and Anecdotes	7
	Seminar in Field Room: New Approaches to <i>Hamlet</i>	7
	Seminar in Wrigley Room: The Publics of the Public Stage, Part One	8
	Seminar in Water Tower Room: Reading Faces and Bodies on the Early Modern Stage	8
	Workshop in Gold Coast Room: Shakespeare 2.0	8
	Seminar in Horner Room: Shakespeare and Medieval Poetry	8
	Seminar in Soldier Field Room: Shakespeare and Race	8
	Seminar in Haymarket Room: Shakespeare and Social Neuroscience	9
	Seminar in Atlanta Room: Shakespeare and the Perverse	9
	Workshop in Comiskey Room: Shakespeare without Chairs: Open-Space Pedagogies, Part One	9
	Seminar in Wright Room: Shakespearean Comedy: The Trade in Words	9
	Seminar in Burnham Room: The Shakespearean Immaterial	9
	Seminar in McCormick Room: Shakespearean Theatrical Reconstructions	10
	Seminar in New Orleans Room: Shakespeare's Female Icons	10
	Seminar in Picasso Room: Textual Collection in Shakespeare's England	10
6:00 p.m.	Opening Reception at the Chicago Cultural Center	10

Friday, 2 April

8:00 a.m.	Registration in Regency Foyer	11
	Book Exhibits in Regency Foyer	11
	Trustees' Breakfast for Graduate Students in Crystal B	11
9:00 a.m.	Plenary Presentation in Regency Ballroom: Person, Property, and Entitlement	11
10:30 a.m.	Coffee Break in Regency Foyer	11
11:00 a.m.	Presentation in Regency AB: Putting Philosophy on Stage: Thinking with Shakespeare	11
	Presentation in Regency CD: Early Modern Erotics	11
1:00 p.m.	Annual Luncheon in Crystal Ballroom	12
3:30 p.m.	Seminar in Soldier Field Room: Becoming Indian in Early Modern Writing	12
	Seminar in Burnham Room: Marlowe and Shakespeare	12
	Seminar in Columbian Room: New Variations in Texts and Editing	12
	Seminar in Gold Coast Room: Performance is History: Intertheatricality, Part One	12
	Seminar in Wrigley Room: The Publics of the Public Stage, Part Two	13
	Seminar in Field Room: Resituating Romance: Comparative Contexts	13
	Seminar in Ogden Room: Shakespeare among the Professors	13
	Seminar in Picasso Room: Shakespeare and Cheap Print	13
	Seminar in Dusable Room: Shakespeare and Donne	13
	Seminar in Horner Room: Shakespeare and Emotional Realism on the Modern Stage	14

	Seminar in Wright Room: Shakespeare and Global Capitalism	14
	Seminar in Atlanta Room: Shakespeare and World Cinema	14
	Seminar in McCormick Room: Shakespeare, Language, and Change	14
	Workshop in Comiskey Room: Shakespeare without Chairs: Open-Space Pedagogies, Part Two	14
	Seminar in Buckingham Room: Ties that Bind: Queering Shakespearean Social Contracts	15
	Seminar in Water Tower Room: What is the History Play? Part One	15
	Seminar in New Orleans Room: The Word against the Word: Shakespeare and Scripture	15
6:00 p.m.	Performance: The Improvised Shakespeare Company in Grand AB	15
8:30 p.m.	Film Screening and Discussion in Grand AB: <i>Mickey B</i>	16

Saturday, 3 April

8:00 a.m.	Information in Regency Foyer	17
	Book Exhibits in Regency Foyer	17
9:00 a.m.	Workshop for Teachers in Crystal C	17
	Presentation in Regency AB: Shakespeare and the Extended Mind	17
	Presentation in Regency CD: Feminism and Shakespearean Adaptation	17
10:30 a.m.	Coffee Break in Regency Foyer	17
11:00 a.m.	Presentation in Regency AB: Global and Temporal	17
	Presentation in Regency CD: Poetics of Song and Tapestry	18
1:30 p.m.	Presentation in Regency AB: Market, Crisis, and Trauma	18
	Presentation in Regency CD: Reading in the Kitchen	18
3:30 p.m.	Film Screening and Discussion in Grand AB: <i>Mickey B</i>	18
	Workshop in Buckingham Room: Close Reading without Readings	19
	Seminar in Field Room: The Common	19
	Workshop in Comiskey Room: Developing Performance Activities for Teaching <i>Measure for Measure</i>	19
	Seminar in McCormick Room: The Great Critics?	19
	Seminar in New Orleans Room: Law and Marriage	19
	Seminar in Wrigley Room: <i>A Midsummer Night's Dream</i> : Early Modern Contexts	20
	Seminar in Gold Coast Room: Performance is History: Intertheatricality, Part Two	20
	Seminar in Atlanta Room: Renaissance Posthumanism	20
	Seminar in Wright Room: Shakespeare and Systems of Rehearsal	20
	Seminar in Horner Room: Shakespeare and the Cultures of Commemoration	20
	Seminar in Burnham Room: Shakespeare and the New Media	21
	Seminar in Dusable Room: Shakespeare: Immigrants and Aliens	21
	Seminar in Ogden Room: Shakespeare in Transit	21
	Seminar in Soldier Field Room: Shakespeare's Sonnets in Context	21
	Seminar in Columbian Room: Staging the Blazon	21
	Seminar in Water Tower Room: What is the History Play? Part Two	22
	Seminar in Picasso Room: Who Hears? Shakespeare's Stage and Screen Audiences	22
6:00 p.m.	Open House at Timothy O'Toole's Pub: <i>Shakespeare Encyclopedia</i> visuals and previews	22
9:00 p.m.	Film Screening and Discussion in Grand AB: <i>Othello: The Tragedy of the Moor</i>	22
10:00 p.m.	The SAA/Malone Society Dance in Crystal Ballroom	22

HYATT REGENCY CHICAGO HOTEL

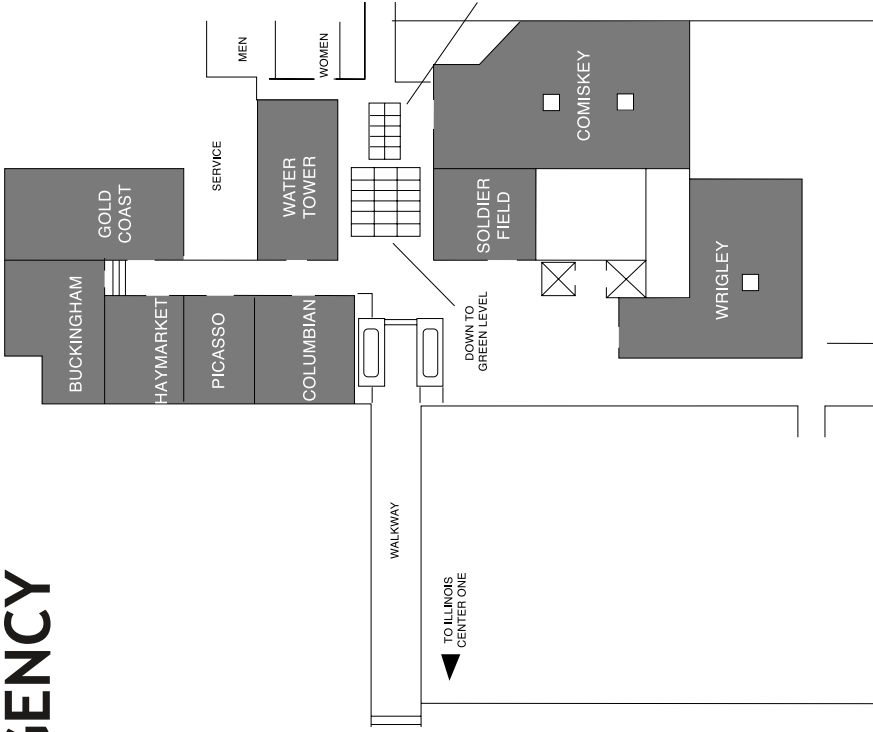

WEST TOWER
BRONZE LEVEL

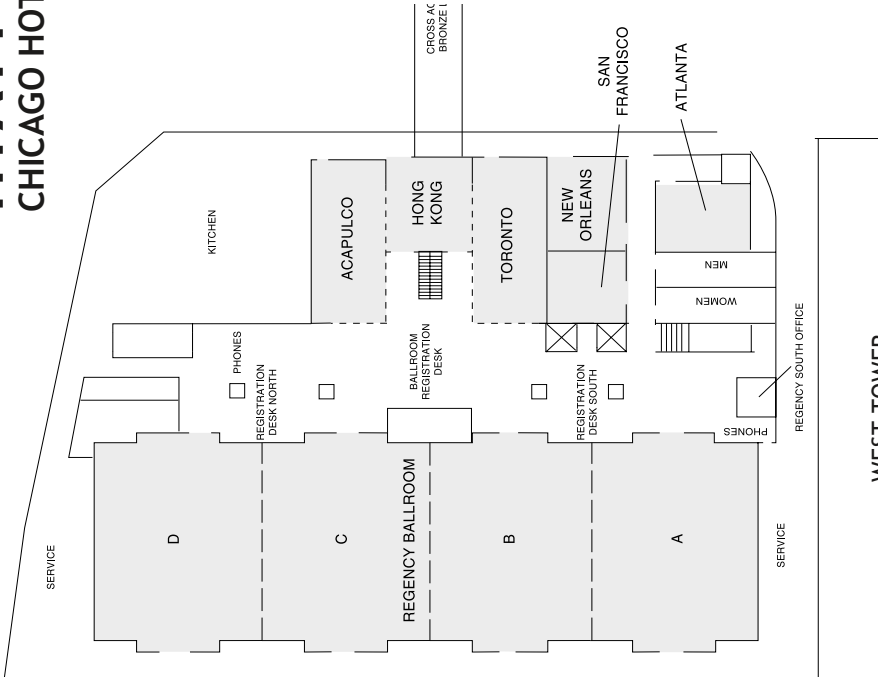

WEST TOWER
GOLD LEVEL

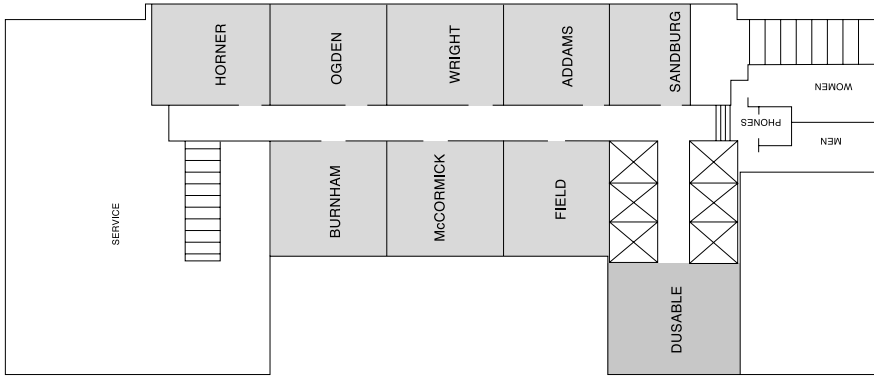

**WEST TOWER
SILVER LEVEL**

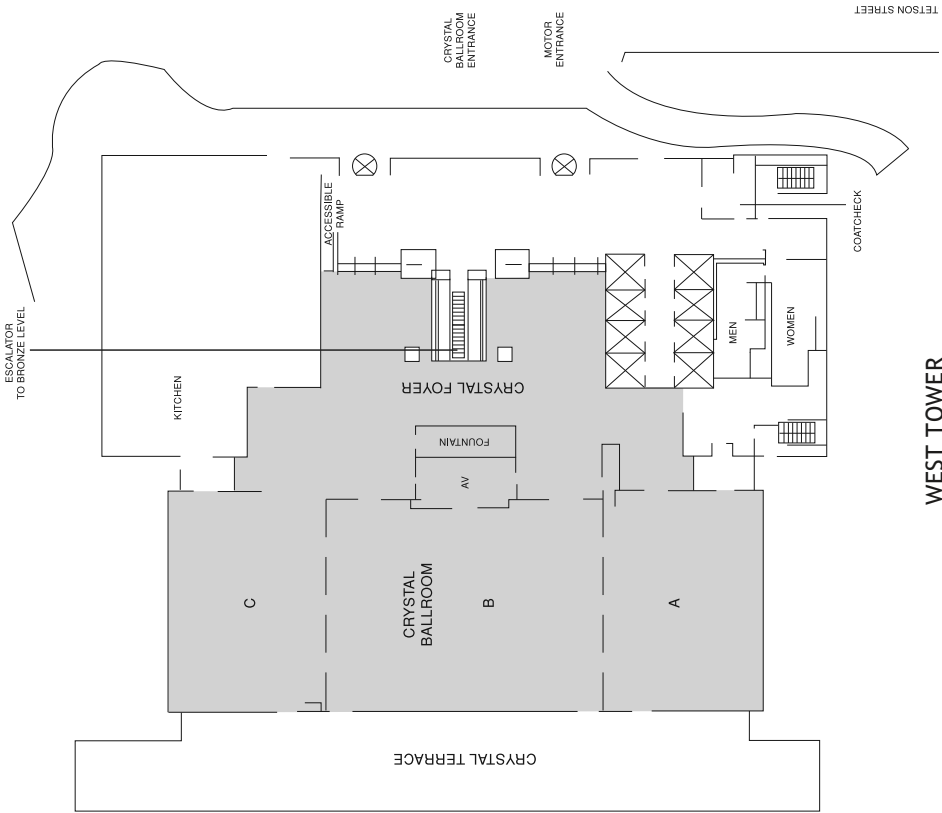

**WEST TOWER
GREEN LEVEL**

THURSDAY, 1 APRIL

10:00 a.m. to 5:30 p.m.

Registration and Book Exhibits

Regency Foyer, Gold Level

10:00 a.m. to 1:00 p.m.

Backstage Tour of the Chicago Shakespeare Theater

*West Tower Entrance of the Hyatt
Regency Chicago*

Backstage tour open only to those who have pre-registered. The bus departs from the West Tower entrance of the Hyatt Regency Chicago and returns in time for the 1:30 p.m. presentation sessions.

1:30 to 3:00 p.m.

Presentation: Understanding the Work and Vitality of Chicago Shakespeare Theater's Art on the World's Stage

Regency AB, Gold Level

Session Organizer: BARBARA GAINES
Chair: STUART SHERMAN, Fordham University

BARBARA GAINES, Chicago Shakespeare
Theater

CHAON CROSS, Chicago Shakespeare Theater

KEVIN GUDAHL, Chicago Shakespeare Theater

Presentation: Women and the Invention of Early Modern Law

Regency CD, Gold Level

Session Organizer: KAREN CUNNINGHAM
Chair: SUZANNE GOSSETT, Loyola University
Chicago

KAREN CUNNINGHAM, University of California,
Los Angeles
Mothers of the Law

THEODORA A. JANKOWSKI, Pennsylvania State
University, Wilkes-Barre
Patriarchal Law and the Queering of
Gender Roles

MIHOKO SUZUKI, University of Miami
Daughters of Coke: Brilliana Harley
and the Female Levellers

3:00 to 3:30 p.m.

Party

Regency Foyer, Gold Level

Toast the 50th Anniversary of *SEL STUDIES IN
ENGLISH LITERATURE 1500-1900*. Champagne
and cake for as long as quantities last.

3:30 to 5:30 p.m.

Film Screening: *Othello: The Tragedy of the Moor*

Grand AB, East Tower

Directed by ZAIB SHAIKH (2008)

Screening open to all registrants for the 38th Annual Meeting and their guests. Allow five minutes to walk from meeting rooms in the West Tower of the Hyatt Regency Chicago to the Grand Ballroom in the East Tower. From the Gold Level of the West Tower, take the escalator to the Bronze Level, cross the walkway to the East Tower, and then take the escalator one level down to the Grand Ballroom.

Seminar: Artisanal Knowledge and the Stage

Ogden Room, Silver Level

Leaders: DAVID J. BAKER, University of North Carolina and MARY FLOYD-WILSON, University of North Carolina

BENJAMIN V. BEIER, University of Wisconsin
CAROLYN E. BROWN, University of San Francisco
NORA L. CORRIGAN, Mississippi University for Women
HILLARY M. NUNN, University of Akron
SARAH E. PARKER, University of North Carolina
SALLY ROMOTSKY, California State University, Fullerton
DEBAPRIYA SARKAR, Rutgers University
KATHERINE IRENE SHRIEVES, University of North Carolina
YOLANA WASSERSUG, Shakespeare Institute
KATHERINE WILLIAMS, Rutgers University

Seminar: Gendering Childhood in Shakespeare's England

Columbian Room, Bronze Level

Leader: JENNIFER HIGGINBOTHAM, Ohio State University

EMILY DETMER-GOEBEL, Northern Kentucky University
SUSAN MICHELE DUNN-HENSLEY, Wheaton College
EMILY RUTH ISAACSON, Chowan University
MARK A. JOHNSTON, University of Windsor
EDEL MARY LAMB, University of Sydney
DONNA J. LONG, Fairmont State University
KRISTEN McDERMOTT, Central Michigan University
BETHANY M. PACKARD, Vanderbilt University

Seminar: Genre and/as Culture

Dusable Room, Silver Level

Leaders: MARTINE VAN ELK, California State University, Long Beach and LLOYD KERMODE, California State University, Long Beach

CARALYN ALYSSA BIALO, University of California, San Diego
JANE HWANG DEGENHARDT, University of Massachusetts, Amherst
MICHELLE M. DOWD, University of North Carolina, Greensboro
LAUREN S. GARRETT, University of North Carolina
CORY L. GREWELL, Thiel College
RACHEL E. HILE, Indiana University-Purdue University, Fort Wayne

RUSSELL L. KECK, Purdue University
SHANNON ELIZABETH KELLEY, Fairfield University
HARRY KEYISHIAN, Fairleigh Dickinson University
CHRISTINE MAFFUCCIO, University of Maryland
MAYA MATHUR, University of Mary Washington
JULIA E. SCHLECK, University of Nebraska, Lincoln
JOHN D. STAINES, John Jay College, CUNY
KRISTIANE R. STAPLETON, University of Wisconsin
RACHEL L. ZLATKIN, University of Cincinnati

Seminar: Making History: Archives and Anecdotes

Buckingham Room, Bronze Level

Leader: PAUL MENZER, Mary Baldwin College

ALAN C. DESSEN, University of North Carolina
RICHARD DUTTON, Ohio State University
WILLIAM INGRAM, University of Michigan
DAVID KATHMAN, Chicago, Illinois
ROSLYN L. KNUTSON, University of Arkansas, Little Rock
WILLIAM J. LLOYD, Damascus, Maryland
LAWRENCE MANLEY, Yale University
JAMES J. MARINO, Cleveland State University
CHRISTOPHER MATUSIAK, University of Toronto
ALAN H. NELSON, University of California, Berkeley
KARA NORTHWAY, Kansas State University
LESLIE THOMSON, University of Toronto
MICHAEL ULLYOT, University of Calgary

Seminar: New Approaches to Hamlet

Field Room, Silver Level

Leader: HUGH GRADY, Arcadia University

BYRON B. BAILEY, University of Cincinnati
RONALD J. BOLING, Lyon College
DARLENE CIRAULO, University of Central Missouri
J. P. CONLAN, University of Puerto Rico
VERNON DICKSON, Florida International University
SAYRE GREENFIELD, University of Pittsburgh, Greensburg
JOE KEENER, Indiana University, Kokomo
JONATHAN P. LAMB, University of Texas
HEATHER J. MURRAY, Pennsylvania State University
KRISTEN KAYEM POLSTER, Southern Methodist University
CHARLES WHITNEY, University of Nevada
DAVID H. WOOD, Northern Michigan University

Thursday, 1 April

Seminar: The Publics of the Public Stage, Part One

Wrigley Room, Bronze Level

Leaders: PETER LAKE, Vanderbilt University and ANDRÁS KISÉRY, City College, CUNY

ROB CARSON, Hobart and William Smith Colleges
JEFFREY S. DOTY, West Texas A&M University
ANDREW J. FLECK, San Jose State University
PENELOPE H. GENG, University of Southern California
REBECCA LEMON, University of Southern California
NINA LEVINE, University of South Carolina
GAYWYN E. MOORE, University of Kansas
JOSEPH NAVITSKY, University of Southern Mississippi
MARK NETZLOFF, University of Wisconsin, Milwaukee
PAUL YACHNIN, McGill University
TIMOTHY W. ZAJAC, University of Massachusetts, Amherst
JOHN R. ZIEGLER, Fordham University

Seminar: Reading Faces and Bodies on the Early Modern Stage

Water Tower Room, Bronze Level

Leaders: SIBYLLE BAUMBACH, Stanford University and MICHAEL NEILL, University of Auckland

JOSHUA LEA BRAZEE, University of Wisconsin
ASHLEY M. BRINKMAN, New York, New York
JAMES M. BROMLEY, Miami University of Ohio
JIM E. CASEY, High Point University
VANESSA I. CORREDERA, Northwestern University
EDWARD J. GEISWEIDT, University of Alabama
WILLIAM GERMANO, Cooper Union
TIFFANY T. HOFFMAN, McGill University
NAOMI CONN LIEBLER, Montclair State University
LIAM J. MEYER, Boston University
RUTH MORSE, Université Paris Diderot
KELLY M. NEIL, University of California, Davis
ANNA RIEHL, Auburn University
DAVID SCHALKWYK, Folger Shakespeare Library
MEREDITH ANNE SKURA, Rice University
LINDA WOODBRIDGE, Pennsylvania State University

Workshop: Shakespeare 2.0

Gold Coast Room, Bronze Level

Leader: KATHERINE ROWE, Bryn Mawr College

M. G. AUNE, California University of Pennsylvania
CHRISTY DESMET, University of Georgia
JEREMY EHRLICH, Internet Shakespeare Editions
ROBIN FARABAUGH, University of Maryland, Baltimore County
VALERIE M. FAZEL, Arizona State University
TIMOTHY FRANCISCO, Youngstown State University
NIELS HEROLD, Oakland University
ERIC M. JOHNSON, George Mason University
CHARLES ADAMS KELLY, Howland Research, LLC
KATHARINE K. LIU, Folger Shakespeare Library
BRUCE R. SMITH, University of Southern California

Seminar: Shakespeare and Medieval Poetry

Horner Room, Silver Level

Leaders: STEELE NOWLIN, Hampden-Sydney College and DANIEL BREEN, Ithaca College

JILL DELSIGNE, Rice University
DARREN J. DYCK, Dalhousie University
JASON GLECKMAN, Chinese University of Hong Kong
ABIGAIL HEALD, San Francisco, California
CAMERON HUNT-MCNABB, University of South Florida
REBECCA MUNSON, University of California, Berkeley
LINDSAY ANN REID, University of Toronto
CLAUDIA ROSS, Wayne State University

Seminar: Shakespeare and Race

Soldier Field Room, Bronze Level

Leaders: VIRGINIA MASON VAUGHAN, Clark University and BRINDA CHARRY, Keene State College

PATRICIA AKHIMIE, Columbia University
JEAN E. FEERICK, Brown University
JOHN R. FORD, Delta State University
M. LINDSAY KAPLAN, Georgetown University
JOYCE G. MACDONALD, University of Kentucky
CAROL MEJIA LAPERLE, Wright State University
MARIANNE NOVY, University of Pittsburgh
JOHN RAYFIELD PROCTOR III, University of Wisconsin
ADELE SEEFF, University of Maryland
GITANJALI SHAHANI, San Francisco State University
IAN SMITH, Lafayette College
AYANNA THOMPSON, Arizona State University

Seminar: Shakespeare and Social Neuroscience

Haymarket Room, Bronze Level

Leaders: PAUL BUDRA, Simon Fraser University and KIRSTEN USZKALO, University of Illinois, Urbana-Champaign

MICHAEL J. BERNTSEN, University of Louisiana, Lafayette

CHRISTOPHER COBB, St. Mary's College

EMMA FIRESTONE, University of Cambridge

LIANNE HABINEK, Bard College

NICHOLAS RYAN HELMS, University of Alabama, Tuscaloosa

PATRICK COLM HOGAN, University of Connecticut

ROS KING, University of Southampton

SUSAN L. KNUTSON, Université Sainte-Anne

ALLISON KELLER LENHARDT, University of Georgia

RORY G. LUKINS, University of Southern California

RICHARD J. MEEK, De Montfort University

CLIFFORD RONAN, Texas State University

JOSEPH MICHAEL SULLIVAN, Marietta College

Seminar: Shakespeare and the Perverse

Atlanta Room, Gold Level

Leader: ERIC S. MALLIN, University of Texas, Austin

NATASHA DISTILLER, University of Cape Town

EWAN FERNIE, Royal Holloway University of London

CORINEE W. GUY, East Carolina University

KIMBERLY A. HUTH, Ithaca College

THEODORE LEINWAND, University of Maryland

JENNIFER K. PAGE, University of Louisiana, Lafayette

TRIPTHI PILLAI, Loyola University Chicago

MATTHEW L. SIMPSON, University of Connecticut

DEANNE WILLIAMS, York University

GABRIEL A. RIEGER, Concord University

Workshop: Shakespeare without Chairs: Open-Space Pedagogies, Part One

Comiskey Room, Bronze Level

Leaders: CAROL CHILLINGTON RUTTER, University of Warwick and JONATHAN HERON, University of Warwick

Please note that the "Shakespeare without Chairs" workshop is closed to auditors.

DANA E. ASPINALL, Alma College

ERIC BINNIE, Hendrix College

SHEILA T. CAVANAGH, Emory University

ELIZABETH GAFFNEY, SUNY, Westchester Community

MAUREEN E. GODMAN, Washburn University

STUART HAMPTON-REEVES, University of Central Lancashire

MATTHEW C. HANSEN, Boise State University

UNHAE LANGIS, Slippery Rock University

JESSICA M. MAERZ, University of Wisconsin, Milwaukee

BERNICE M. NEAL, York University

KATHRYN PRINCE, University of Ottawa

KEVIN ARTHUR QUARMBY, Globe Education

AMY J. RODGERS, University of Michigan

DEBORAH WILLIS, University of California, Riverside

Seminar: Shakespearean Comedy: The Trade in Words *Wright Room, Silver Level*

Leader: WES FOLKERTH, McGill University

JEAN-FRANCOIS BERNARD, Université de Montréal

DAVID GOLZ, Kettering University

CHRISTOPHER HOLMES, SUNY, Maritime College

BARBARA I. KREPS, University of Pisa

WILLIAM T. LISTON, Ball State University

IAN FREDERICK MOULTON, Arizona State University

RACHEL E. POULSEN, Edgewood College

KATHERINE M. ROMACK, University of West Florida

KELLY J. STAGE, Ripon College

RIKITA TYSON, Harvard University

Seminar: The Shakespearean Immaterial

Burnham Room, Silver Level

Leader: JAMES A. KNAPP, Eastern Michigan University

ANDREW CUTROFELLO, Loyola University Chicago

JESSICA E. DELL, McMaster University

CLAIRE MELISSA FALCK, University of Wisconsin

WENDY BETH HYMAN, Oberlin College

KENNETH S. JACKSON, Wayne State University

KATHERINE KELLETT, Boston College

JUSTIN KOLB, University of Wisconsin

ZACKARIAH LONG, Ohio Wesleyan University

GENEVIEVE LOVE, Colorado College

Thursday, 1 April

ANN M. MARTINEZ, University of Kansas
MADHAVI MENON, American University
ERIN MARIE SULLIVAN, University College, London
SCOTT A. TRUDELL, Rutgers University
JONATHAN A. WALKER, Portland State University

Seminar: Shakespearean Theatrical Reconstructions

McCormick Room, Silver Level

Leader: FARAH KARIM-COOPER,
Shakespeare's Globe

DOUGLAS H. ARRELL, University of Winnipeg
ROB CONKIE, La Trobe University
TOM CORNFORD, University of Warwick
LESLIE C. DUNN, Vassar College
JEREMY RAY FIEBIG, Waldorf College
PETER KANELOS, Loyola University Chicago
JAMES N. LOEHLIN, University of Texas
SARA E. THOMPSON, Shakespeare Institute
DON WEINGUST, Center for Shakespeare Studies
PENELOPE WOODS, Shakespeare's Globe

Seminar: Shakespeare's Female Icons

New Orleans Room, Gold Level

Leader: FRANCESCA ROYSTER, DePaul
University

PASCALÉ AEBISCHER, University of Exeter
JENNIFER FEATHER, University of North Carolina,
Greensboro
KATHRYN FININ, SUNY, Oneonta
BRENDA HENRY-OFFOR, Brooklyn, New York
ELIZABETH A. HUTCHEON, University of Chicago
KENDRA LEONARD, Westminster Choir College
NATALIE JONES LOPER, University of Alabama
NIAMH J. O'LEARY, Ohio State University
DEE ANNA PHARES, Northern Illinois University
AMY SCOTT-DOUGLASS, University of Maryland and
Georgetown University
KAY STANTON, California State University, Fullerton
CATHERINE E. THOMAS, College of Charleston
CATHERINE WEIDNER, DePaul University
ALAN R. YOUNG, Acadia University

Seminar: Textual Collection in Shakespeare's England

Picasso Room, Bronze Level

Leader: LEAH KNIGHT, Brock University

EDMUND CAMPOS, Northwestern University
ADAM G. HOOKS, University of Iowa
JEFFREY TODD KNIGHT, University of Michigan
ELIZABETH ZEMAN KOLKOVICH, Ohio State University
TARA LYNN LYONS, University of Illinois, Urbana-
Champaign
ERIN ANN MCCARTHY, Ohio State University
KIRK MELNIKOFF, University of North Carolina,
Charlotte
PHILIP S. PALMER, University of Massachusetts,
Amherst
ALAN STEWART, Columbia University
HOLGER SCHOTT SYME, University of Toronto
KATHRYN K. WILL, University of Michigan
MARSELLE WOODWARD, University of Wisconsin

6:00 to 8:00 p.m.

Opening Reception

The Chicago Cultural Center

Reception open to all registrants for the 38th Annual Meeting and their guests. Name tags are required for entry.

The Chicago Cultural Center, located at 78 East Washington Street, is a half-mile walk from the Hyatt Regency Chicago. From the hotel, go left (west) on East Wacker for one block and then turn left (south) onto Michigan Avenue. Cross to the far (west) side of Michigan Avenue before reaching Washington Street, four blocks to the south. The Chicago Cultural Center is at the northwest corner of Michigan Avenue and Washington Street.

Guides are also available at the Hyatt's West Tower entrance and along the route.

FRIDAY, 2 APRIL

8:00 a.m. to 6:00 p.m.

Registration and Book Exhibits

Regency Foyer, Gold Level

8:00 to 9:00 a.m.

Trustees' Breakfast for Graduate Students

Crystal B, Green Level

Open to all graduate student members of the SAA and hosted by the SAA Trustees.

Breakfast meeting of contributors to the World Shakespeare Bibliography

Meet outside The Bistro at 151, in the East Tower of the Hyatt Regency Chicago.

9:00 to 10:30 a.m.

Plenary Presentation: Person, Property, and Entitlement

Regency Ballroom, Gold Level

Session Organizer: AMANDA BAILEY, University of Connecticut

Chair: COPPÉLIA KAHN, Brown University

KATHARINE EISAMAN MAUS, University of Virginia

Princes and Prodigals

LAURIE SHANNON, Northwestern University
The Law's First Subjects: Human Authority and Animal Entitlement in Early Modernity

LUKE WILSON, Ohio State University
When the Thing is the Use of the Thing, and When It's Not

10:30 to 11:00 a.m.

Coffee Break

Regency Foyer, Gold Level

11:00 a.m. to 12:30 p.m.

Presentation: Putting Philosophy on Stage: Thinking with Shakespeare

Regency AB, Gold Level

Session Organizer and Chair: HENRY S. TURNER, Rutgers University

PAUL A. KOTTMAN, The New School
Tragic Conditions in Shakespeare

MICHAEL WITMORE, University of Wisconsin
Shakespeare, Sensation, and Renaissance Existentialism

JULIA REINHARD LUPTON, University of California, Irvine
Hospitality and Risk in *The Winter's Tale*

Presentation: Early Modern Erotics

Regency CD, Gold Level

Session Organizers: WILL FISHER and VALERIE TRAUB

Chair: JAMES KEARNEY, University of California, Santa Barbara

JENNIFER PANEK, University of Ottawa
He-whores and the Masculinity of Sexual Performance

WILL FISHER, Lehman College, CUNY
"Love's Wealthy Croppe of Kisses": Tongue Kissing and the History of Sexuality

VALERIE TRAUB, University of Michigan
Shakespeare's Sex

Friday, 2 April

1:00 to 3:00 p.m.

Annual Luncheon

Crystal Ballroom, Green Level

Presiding: **PAUL YACHNIN**, McGill University

Open to all registrants for the 38th Annual Meeting. Tickets for guests' luncheons may be purchased at the registration tables (based on availability).

3:30 to 5:30 p.m.

Seminar: Becoming Indian in Early Modern Writing

Soldier Field Room, Bronze Level

Leader: **JONATHAN GIL HARRIS**, George Washington University

KEVIN A. BOETTCHER, University of Wisconsin
GINA MARIE CAISON, University of California, Davis
THOMAS P. CARTELLI, Muhlenberg College
SARA EATON, North Central College
MARION HOLLINGS, Middle Tennessee State University
GAVIN HOLLIS, Hunter College, CUNY
ARUL KUMARAN, St. Thomas More College
BINDU MALIECKAL, Saint Anselm College
CARMEN NOCENTELLI, University of New Mexico
KAREN ROBERTSON, Vassar College
CRAIG M. RUSTICI, Hofstra University
JEANETTE NGUYEN TRAN, University of Wisconsin
MELISSA E. WALTER, University of the Fraser Valley

Seminar: Marlowe and Shakespeare

Burnham Room, Silver Level

Leaders: **SARAH K. SCOTT**, Mount St. Mary's University and **M.L. STAPLETON**, Indiana University-Purdue University, Fort Wayne

ANN BASSO, University of South Florida
ROBIN E. BATES, Lynchburg College
JAMES BIESTER, Loyola University Chicago
SARA M. DEATS, University of South Florida
JOHN W. ELLIS-ETCHISON, University of Louisiana, Lafayette

BRETT FOSTER, Wheaton College
LIZZ KETTERER, Shakespeare Institute
BARBARA L. PARKER, William Paterson University
SARAH D. RASHER, University of Connecticut, Storrs
ANNETTE STENNING, Simon Fraser University
MATTHEW THIELE, Auburn University
JACOB A. TOOTALIAN, University of Wisconsin

Seminar: New Variations in Texts and Editing

Columbian Room, Bronze Level

Leader: **GABRIEL EGAN**, Loughborough University

JOHN D. COX, Hope College
MARK DAVID FARNSWORTH, University of Nevada, Reno
MICHAEL D. FRIEDMAN, University of Scranton
SUZANNE GOSSETT, Loyola University Chicago
CATHERINE A. HENZE, University of Wisconsin, Green Bay
BRETT D. HIRSCH, University of Victoria
TREY JANSEN, University of Nevada, Reno
ADRIAN R. D. KIERNANDER, University of New England
SARAH J. NEVILLE, University of New Brunswick
WILL SHARPE, University of Warwick
ANDREA SILVA, Wayne State University
JESÚS TRONCH PÉREZ, Universitat de València
PAUL WERSTINE, University of Western Ontario
JENNIFER M. YOUNG, King's College, London

Seminar: Performance is History: Intertheatricality, Part One

Gold Coast Room, Bronze Level

Leader: **WILLIAM N. WEST**, Northwestern University

PATRICIA BADIR, University of British Columbia
JUAN FRANCISCO CERDÁ MARTÍNEZ, University of Murcia
ANNETTE DREW-BEAR, Washington and Jefferson College
LUCIAN GHITA, Yale University
MARISSA GREENBERG, University of New Mexico
TOBY P. MALONE, Toronto, Ontario
NEDDA MEHDIZADEH, Washington, D.C.
MICHELLE PARKINSON, University of Wisconsin, River Falls
RICHARD PREISS, University of Utah

RICHARD SCHOCH, Queen Mary, University of London
TARA KRISTEN SCHUPNER, American University
ANDREA R. STEVENS, University of Illinois,
Urbana-Champaign

Seminar: The Publics of the Public Stage, Part Two

Wrigley Room, Bronze Level

Leaders: PETER LAKE, Princeton University
and ANDRÁS KISÉRY, City College, CUNY

PETER BEREK, Mount Holyoke College
VICTORIA M. R. BROWNLEE, Armagh, United Kingdom
ERIC ANDREW CARLSON, Queen's University
THOMAS COGSWELL, University of California,
Riverside
J. CAITLIN FINLAYSON, University of Michigan,
Dearborn
BRIONY S. FROST, University of Exeter
MUSA GURNIS, Columbia University
SUSAN ELIZABETH HARLAN, Wake Forest University
KRISTINE ANNE JOHANSON, Cellardyke, United
Kingdom
FRITZ J. LEVY, University of Washington
STEVEN MULLANEY, University of Michigan
AMRITA SEN, Michigan State University
ANDREW TUMMINIA, Marymount Manhattan College

Seminar: Resituating Romance: Comparative Contexts

Field Room, Silver Level

Leader: LAUREN SHOHEIT, Villanova University

HARDIN AASAND, Indiana University-Purdue
University, Fort Wayne
SCOTT BLACK, University of Utah
DAVID GLIMP, University of Colorado
MAURICE HUNT, Baylor University
JAMES KEARNEY, University of California, Santa
Barbara
CLARE KINNEY, University of Virginia
JAMES S. LAMBERT, University of Iowa
LUCY MUNRO, Keele University
CHAEYOON PARK, University of Illinois, Urbana-
Champaign
KAARA PETERSON, Miami University of Ohio
DIMITRY ALEXANDER SENYSHYN, Toronto, Ontario
KATIE SUE SISNEROS, University of Nebraska, Lincoln

Seminar: Shakespeare among the Professors

Ogden Room, Silver Level

Leader: ANDREW MURPHY, University of St.
Andrews

MARK BAYER, University of Texas, San Antonio
RUSS BODI, Owens College
ANTONIA FORSTER, University of Akron
SUSANNE GREENHALGH, Roehampton University
MICHAEL L. HAYS, Las Cruces, New Mexico
JEREMY LOPEZ, University of Toronto

Seminar: Shakespeare and Cheap Print

Picasso Room, Bronze Level

Leader: SIMONE CHESS, Wayne State
University

CLAIRE M. L. BOURNE, University of Pennsylvania
ADAM H. KITZES, University of North Dakota
ZACHARY LESSER, University of Pennsylvania
CATHERINE LOOMIS, University of New Orleans
KRIS McABEE, University of California, Santa Barbara
SUSAN O'MALLEY, Kingsborough, CUNY
MARK RANKIN, James Madison University
NATHANIEL AMOS ROTHSCHILD, Boston University
JOEL ELLIOT SLOTKIN, Towson University
ALICIA V. TOMASIAN, William Rainey Harper College
BLAIRE ZEIDERS, University of Wisconsin

Seminar: Shakespeare and Donne

Dusable Room, Silver Level

Leaders: JUDITH H. ANDERSON, Indiana
University and JENNIFER C. VAUGHT,
University of Louisiana, Lafayette

JAMES P. BEDNARZ, New York, New York
ELIZABETH N. BOBO, University of Louisiana,
Lafayette
ELLEN M. CALDWELL, California State University,
Fullerton
BARBARA CORRELL, Cornell University
SARAH G. DAWSON, University of Notre Dame
MARSHALL GROSSMAN, University of Maryland
MICHAEL HALL, Virginia Wesleyan College
JULIAN LAMB, Chinese University of Hong Kong
CATHERINE G. MARTIN, University of Memphis

Friday, 2 April

HARRY REX NEWMAN, University of Birmingham
ANITA GILMAN SHERMAN, American University
REBECCA WISEMAN, University of Michigan

Seminar: Shakespeare and Emotional Realism on the Modern Stage

Horner Room, Silver Level

Leaders: ROBERTA BARKER, Dalhousie University and CARY M. MAZER, University of Pennsylvania

BRETT GAMBOA, Harvard University
ANDREW JAMES HARTLEY, University of North Carolina, Charlotte

JAN M. HAWKLEY, University of Nevada, Reno
ELIZABETH KLETT, University of Houston, Clear Lake
ROSS M. KNECHT, New York University
MATT KOZUSKO, Ursinus College
JENNIFER LOW, Florida Atlantic University
ROBERT ORMSBY, St. John's, Newfoundland
KIM SOLGA, University of Western Ontario
SARAH WERNER, Folger Shakespeare Library
CELESTINE WOO, SUNY, Empire State College

Seminar: Shakespeare and Global Capitalism

Wright Room, Silver Level

Leaders: MARCELA KOSTIHOVÁ, Hamline University and NIKOLAI ZAKHAROV, Moscow Institute for the Humanities

PATRICK CRAPANZANO, St. John's University
ALICE A. DAILEY, Villanova University
CARLA DELLA GATTA, San Francisco State University
LAURIE ELLINGHAUSEN, University of Missouri, Kansas City

COLETTE GORDON, London, United Kingdom
MEREDITH MOLLY HAND, Florida State University
IAN MACINNES, Albion College

Seminar: Shakespeare and World Cinema

Atlanta Room, Gold Level

Leader: MARK THORNTON BURNETT, Queen's University, Belfast

RICHARD BURT, University of Florida
MAURIZIO CALBI, University of Salerno
MELISSA M. CROTEAU, California Baptist University
KEITH HARRISON, Vancouver Island University
LALITA PANDIT HOGAN, University of Wisconsin, La Crosse
ALEXANDER C. Y. HUANG, Pennsylvania State University
YU JIN KO, Wellesley College
DOUGLAS LANIER, University of New Hampshire
ALFREDO MICHEL MODENESSI, Universidad Nacional Autónoma de México
LAURIE E. OSBORNE, Colby College
ELINOR PARSONS, De Montfort University
ELIZABETH PENTLAND, York University
GREGORY M. SEMENZA, University of Connecticut, Storrs

Seminar: Shakespeare, Language, and Change

McCormick Room, Silver Level

Leader: ALYSIA KOLENTSIS, Stanford University

SYLVIA ADAMSON, University of Sheffield
HANNAH J. CRAWFORTH, King's College, London
JENNIFER FORSYTH, Kutztown University
JONATHAN HOPE, Strathclyde University
CAMPBELL LATHEY, Albany, New York
LYNNE MAGNUSSON, University of Toronto
RUSS McDONALD, Goldsmiths College, University of London
SIMON PALFREY, Brasenose College, Oxford University
MIREILLE RAVASSAT, Université de Valenciennes
MAURA M. TARNOFF, Saint Louis University, Madrid
ANDREA F. TROCHA-VAN NORT, United States Air Force Academy
EMMA ANNETTE WILSON, University of Western Ontario

Workshop: Shakespeare without Chairs: Open-Space Pedagogies, Part Two

Comiskey Room, Bronze Level

Leaders: CAROL CHILLINGTON RUTTER, University of Warwick and JONATHAN HERON, University of Warwick

Please note that this workshop is closed to auditors. See page 9 for membership of the workshop.

Seminar: Ties that Bind: Queering Shakespearean Social Contracts

Buckingham Room, Bronze Level

Leaders: KATHERYN SCHWARZ, Vanderbilt University and JULIE CRAWFORD, Columbia University

BRANDON CHRISTOPHER, University of Winnipeg
ARI FRIEDLANDER, University of Michigan, Ann Arbor
JOHN GARRISON, University of California, Davis
AMY GREENSTADT, Portland State University
JESSICA LANDIS, University of Massachusetts, Amherst
ARTHUR L. LITTLE, JR., University of California, Los Angeles
LYNN M. MAXWELL, Emory University
RODERICK H. MCKEOWN, University of Toronto
TRACEY E. MILLER-TOMLINSON, New Mexico State University
ERIN MURPHY, Boston University
DAVID L. ORVIS, Appalachian State University
SARAH Q. OSTENDORF, New York University
ANTHONY G. PATRICIA, University of Nevada
CHAD ALLEN THOMAS, University of Michigan

Seminar: What is the History Play? Part One

Water Tower Room, Bronze Level

Leader: BRIAN WALSH, Yale University

JONATHAN BALDO, Eastman School of Music
JAMES C. BULMAN, Allegheny College
JOHN HUGH CAMERON, Dalhousie University
CATHERINE GRACE CANINO, University of South Carolina, Upstate
PAUL M. DOWLING, Canisius College
LEA LUECKING FROST, Saint Louis University
CYNTHIA LEWIS, Davidson College
SANDRA A. LOGAN, Michigan State University
CHRISTOPHER J. MADSON, University at Buffalo
ALLISON E. MEYER, University of Illinois
CYRUS G. MULREADY, SUNY, New Paltz
CHRISTOPHER SHIRLEY, Northwestern University
JAMES R. SIEMON, Boston University
MARY K. STEIBLE, Southern Illinois University, Edwardsville

Seminar: The Word against the Word: Shakespeare and Scripture

New Orleans Room, Gold Level

Leader: JOHN L. PARKER, University of Virginia

DAVID KEITH ANDERSON, University of Oklahoma
ANDREW BARNABY, University of Vermont
MARGRETA DE GRAZIA, University of Pennsylvania
JOANNE DIAZ, Illinois Wesleyan University
JOSEPH JENKINS, University of California, Irvine
MAURICIO ESTEBAN MARTINEZ, University of Guelph
MICHELE OSHEROW, University of Maryland, Baltimore County
HOLLY CRAWFORD PICKETT, Raphine, Virginia
CODY REIS, New York University
MARILYN D. SIMON, University of Toronto
PAUL DUSTIN STEGNER, California Polytechnic State University
WILLIAM H. STOCKTON, Ball State University
ADRIAN STREETE, Queen's University, Belfast
JENNIFER WALDRON, Pittsburgh, Pennsylvania
LEWIS WALKER, University of North Carolina, Wilmington

5:30 to 6:15 p.m.

Meeting of the Editors of the Arden Early Modern Drama

Addams Room, Silver Level

6:00 to 7:00 p.m.

Performance: The Improvised Shakespeare Company

Grand AB, East Tower

Performance open to all registrants for the 38th Annual Meeting and their guests. Allow five minutes to walk from meeting rooms in the West Tower of the Hyatt Regency Chicago to the Grand Ballroom in the East Tower. From the Gold Level of the West Tower, take the escalator to the Bronze Level, cross the walkway to the East Tower, and then take the escalator one level down to the Grand Ballroom.

Friday, 2 April

6:00 to 7:00 p.m.

**Meeting of the Editorial Board
of *Shakespeare Quarterly***

Haymarket Room, Bronze Level

8:30 to 10:30 p.m.

Film Screening: *Mickey B*

Grand AB, East Tower

Directed by TOM MAGILL (2006)

Post-Screening Discussion led by TOM MAGILL, Educational Shakespeare Company; MARK THORNTON BURNETT, Queen's University Belfast; and AMY SCOTT-DOUGLASS, Georgetown University and University of Maryland.

Performance open to all registrants for the 38th Annual Meeting and their guests. Allow five minutes to walk from meeting rooms in the West Tower of the Hyatt Regency Chicago to the Grand Ballroom in the East Tower. From the Gold Level of the West Tower, take the escalator to the Bronze Level, cross the walkway to the East Tower, and then take the escalator one level down to the Grand Ballroom.

SATURDAY, 3 APRIL

7:30 to 9:00 a.m.

Breakfast meeting of the Editors of the Internet Shakespeare

Wrigley Room, Bronze Level

8:00 a.m. to 12:00 noon

Information and Book Exhibits

Regency Foyer, Gold Level

9:00 a.m. to 12:00 noon

Workshop for Teachers

Crystal C, Green Level

Workshop Leaders: ROBERT YOUNG and
MICHAEL LOMONICO, Folger Shakespeare Library

9:00 to 10:30 a.m.

Presentation: Shakespeare and the Extended Mind

Regency AB, Gold Level

Session Organizer: GAIL KERN PASTER
Chair: LINDA CHARNES, Indiana University

JOHN SUTTON, Macquarie University
Embodied Cognition in the Time of
Shakespeare: Ghost Gestures and
Anachronic Traces

EVELYN B. TRIBBLE, University of Otago
Cognitive Ecologies and the Extended
Mind in Early Modern England

GAIL KERN PASTER, Folger Shakespeare
Library
Seeing the Spider: Cognition and
Jealousy in *The Winter's Tale*

Presentation: Feminism and Shakespearean Adaptation

Regency CD, Gold Level

Session Organizer: CELIA ROSE DAILEADER
Chair: ANDREW JAMES HARTLEY, University of
North Carolina, Charlotte

CELIA ROSE DAILEADER, Florida State
University

Kissing a Negress: Racial
Hermaphroditism in Virginia Woolf's
Orlando

JENNIFER DROUIN, University of Alabama
Nationalism, Feminism, and the
Politics of Recognition in Normand
Chaurette's *The Queens*

MELISSA J. JONES, Eastern Michigan
University
Alter Egos/Alter Eros: Shakespeare
and Henry VIII in Popular Culture

10:30 to 11:00 a.m.

Coffee Break

Regency Foyer, Gold Level

11:00 a.m. to 12:00 noon

Presentation: Global and Temporal

Regency AB, Gold Level

Session Organizers: MEMBERS OF THE OPEN
SUBMISSIONS COMMITTEE FOR 2010
Chair: RUTH MORSE, Université Paris Diderot

BARBARA SEBEK, Colorado State University
"Wine and sugar of the best and fairest":
Canary and the Canaries in Windsor

ERIC V. SPENCER, College of Idaho
Faith, Finitude, and Philosophy: A
Hermeneutic *Winter's Tale*

Saturday, 3 April

Presentation: Poetics of Song and Tapestry

Regency CD, Gold Level

Session Organizers: MEMBERS OF THE OPEN SUBMISSIONS COMMITTEE FOR 2010

Chair: MARION O'CONNOR, University of Kent, Canterbury

JOHN H. ASTINGTON, University of Toronto
Venus in Silks

ANDREW MATTISON, University of Toledo
Literary Listening: Shakespeare, Pater, and Poetic Song

1:30 to 3:00 p.m.

Presentation: Market, Crisis, and Trauma

Regency AB, Gold Level

Session Organizer: DONALD HEDRICK

Chair: LINDA WOODBRIDGE, Pennsylvania State University

DOUGLAS BRUSTER, University of Texas
Shakespeare and Representational Inflation

VALERIE FORMAN, University of Colorado
Developing New Worlds: Crises of Neoliberalism in the Seventeenth Century?

DONALD HEDRICK, Kansas State University
Something for Nothing/Nothing for Something: Theater, Market Trauma, and the Cultural Logic of Early Modern Entertainment Value

Presentation: Reading in the Kitchen

Regency CD, Gold Level

Session Organizer: DIANE PURKISS

Chair: NINA LEVINE, University of South Carolina

JOAN FITZPATRICK, Loughborough University
Shakespeare and the Language of Food: Discoveries and Conclusions

DIANE PURKISS, Keble College, Oxford University
Why is Bread so Distressful?

KEN ALBALA, University of the Pacific
The Tudor Kitchen as Theater: Translating Cooking Texts into Food Performance

3:30 to 5:30 p.m.

Film Screening: *Mickey B*

Grand AB, East Tower

Directed by TOM MAGILL (2006)

Post-Screening Discussion led by TOM MAGILL, Educational Shakespeare Company and AMY SCOTT-DOUGLASS, Georgetown University and University of Maryland.

Performance open to all registrants for the 38th Annual Meeting and their guests. Allow five minutes to walk from meeting rooms in the West Tower of the Hyatt Regency Chicago to the Grand Ballroom in the East Tower. From the Gold Level of the West Tower, take the escalator to the Bronze Level, cross the walkway to the East Tower, and then take the escalator one level down to the Grand Ballroom.

Workshop: Close Reading without Readings

Buckingham Room, Bronze Level

Leader: STEPHEN BOOTH, University of
California, Berkeley

JOHN MICHAEL ARCHER, New York University
SEAN BENSON, University of Dubuque
JOSHUA M. CALHOUN, University of Delaware
IRENE G. DASH, Hunter College, CUNY
HEATHER DUBROW, Fordham University
JAMIE H. FERGUSON, University of Houston
DOUGLAS E. GREEN, Augsburg College
JULIA B. GRIFFIN, Statesboro, Georgia
DAVID GUO, Georgetown University
COLLEEN E. KENNEDY, Ohio State University
PAULA MCQUADE, DePaul University
MARIANNE MONTGOMERY, East Carolina University
JOHN M. MUCCIOLLO, Chatham, New Jersey
WILLIAM P. WEAVER, Baylor University
TRAVIS D. WILLIAMS, University of Rhode Island

Seminar: The Common *Field Room, Silver Level*

Leader: CAROLYN SALE, University of Alberta

CHARLOTTE ARTESE, Agnes Scott College
MARY A. BLACKSTONE, University of Regina
ERIC VINCENT BYVILLE, Loyola University Chicago
CYNDIA SUSAN CLEGG, Pepperdine University
ANDREW R. GRIFFIN, University of California, Santa
Barbara
TRISH THOMAS HENLEY, University of Cincinnati
ROZE HENTSCHELL, Colorado State University
JOHN C. HIGGINS, University of California, San Diego
BILL KERWIN, University of Missouri
BRIAN K. KNIGHT, University of Wisconsin
VIMALA C. PASUPATHI, Hofstra University
ELIZABETH M. STURGEON, Mount St. Mary's College
DAVID SUMMERS, Capital University
JEFFREY S. THEIS, Salem State College

Workshop: Developing Performance Activities for Teaching *Measure for Measure* *Comiskey Room, Bronze Level*

Leader: EDWARD L. ROCKLIN, California State
Polytechnic University, Pomona

REGINA BUCCOLA, Roosevelt University
MARY ANN BUSHMAN, Illinois Wesleyan University
ANTHONY ELLIS, Western Michigan University
DANIEL GATES, Saginaw Valley State University
JOSÉ M. GONZÁLEZ, Universidad de Alicante
PIERRE HECKER, Carleton College
KIRK HENDERSHOTT-KRAETZER, Olivet College
MEGAN LYNN ISAAC, Elon University
MICHAEL MCCLINTOCK, Bridgewater State College
KRISTEN L. OLSON, Pennsylvania State University
PAUL PRESCOTT, Warwick University
KENDRICK W. PREWITT, University of the Ozarks
ELIZABETH J. RIVLIN, Clemson University

Seminar: The Great Critics? *McCormick Room, Silver Level*

Leader: RICHARD STRIER, University of
Chicago

JONATHAN ARAC, University of Pittsburgh
JOHN ROBERT BAXTER, Dalhousie University
CHRISTOPHER J. CROSBIE, North Carolina State
University
LARS ENGLE, University of Tulsa
KENNETH J.E. GRAHAM, University of Waterloo
PAUL J. HECHT, Purdue University, North Central
ANDREW D. MCCARTHY, Washington State University
RICHARD C. MCCOY, Queen's College, CUNY
ROLF O. MUELLER, Fanny-Leicht-Gymnasium,
Stuttgart
SARAH OLIVE, Shakespeare Institute
ROBERT B. PIERCE, Oberlin College
LAWRENCE F. RHU, University of South Carolina
KURT A. SCHREYER, University of Missouri, St. Louis
BRUCE YOUNG, Brigham Young University

Seminar: Law and Marriage *New Orleans Room, Gold Level*

Leader: LOREEN L. GIESE, Ohio University

CRISTINA LEÓN ALFAR, Hunter College, CUNY
ALBERTO CACICEDO, Albright College
STEPHANIE CHAMBERLAIN, Southeast Missouri State
University
KATHARINE CLELAND, Pennsylvania State University
ANN JENNALIE COOK, Vanderbilt University
GRACE IOPPOLO, University of Reading
DOROTHEA KEHLER, San Diego State University
WESLEY R. KISTING, Augusta State University
ANDREA CAROLINE LAWSON, San Clemente, California
CHRISTINA LUCKYJ, Dalhousie University
SARA D. SCHOTLAND, United States Naval Academy

Saturday, 3 April

AMY L. SMITH, Kalamazoo College
LAWRENCE N. WEISS, New York, New York
KIMBERLY R. WEST, Sewanee School of Letters
FRANK WHIGHAM, University of Texas

Seminar: *A Midsummer Night's Dream: Early Modern Contexts*

Wrigley Room, Bronze Level

Leader: PETER HOLLAND, University of Notre Dame

LAURA AYDELOTTE, University of Chicago
LYNNE DICKSON BRUCKNER, Chatham College
REBECCA DARK, University of Texas, Arlington
LOUISE C. GEDDES, Adelphi University
FRANCES L. HELPHINSTINE, Morehead State University
PETER C. HERMAN, San Diego State University
SCOTT A. HOLLIFIELD, University of Nevada
JESSE M. LANDER, University of Notre Dame
LAURA E. LEVINE, New York University
JEAN M. MERRILL, Loras College
PATRICIA A. PARKER, Stanford University
MICHAEL B. SAENGER, Southwestern University
JOHN TOBIN, University of Massachusetts, Boston
ROBERT N. WATSON, University of California, Los Angeles

Seminar: Performance is History: Intertheatricality, Part Two

Gold Coast Room, Bronze Level

Leader: WILLIAM N. WEST, Northwestern University

LINDA AUSTERN, Northwestern University
GINA BLOOM, University of California, Davis
ANSTON BOSMAN, Amherst College
ANDREW BOZIO, University of Michigan
KATHERINE STEELE BROKAW, University of Michigan
ERIKA T. LIN, George Mason University
MARGA MUNKELT, University of Munster
DAVID NICOL, Dalhousie University
STEVEN URKOWITZ, City College of New York
ERIC D. VIVIER, University of Wisconsin
DENISE A. WALLEN, Vassar College
SUSANNE L. WOFFORD, New York University

Seminar: Renaissance Posthumanism

Atlanta Room, Gold Level

Leaders: JOSEPH CAMPANA, Rice University and SCOTT MAISANO, University of Massachusetts, Boston

REBECCA ANN BACH, University of Alabama, Birmingham
ELIZABETH A. BLAKE, New York University
KEITH M. BOTELHO, Kennesaw State University
LARA BOVILSKY, University of Oregon
MICHAEL C. CLODY, University of Houston, Clear Lake
JASON ELLIOT COHEN, Berea College
CRAIG DIONNE, Eastern Michigan University
LOWELL NELSON DUCKERT, George Washington University
HOLLY E. DUGAN, George Washington University
BRYAN J. LOWRANCE, Columbia University
HOWARD MARCHITELLO, Rutgers University
STEVE MENTZ, St. John's University
VIN NARDIZZI, University of British Columbia
BRADLEY D. RYNER, Arizona State University
MICHAEL G. URSELL, University of California, Santa Cruz

Seminar: Shakespeare and Systems of Rehearsal

Wright Room, Silver Level

Leaders: CHRISTIAN M. BILLING, University of Hull and ADAM J. LEDGER, University of Hull

BRIDGET ESCOLME, Queen Mary, University of London
W. L. GODSHALK, University of Cincinnati
PATRICIA J. LENNOX, New York University
ADAM SHEAFFER, Eastern Michigan University
CHARLENE V. SMITH, Silver Spring, Maryland
DARREN V. TUNSTALL, University of Central Lancaster

Seminar: Shakespeare and the Cultures of Commemoration

Horner Room, Silver Level

Leaders: TON HOENSELAARS, Utrecht University and CLARA CALVO, University of Murcia

YU-CHUN CHIANG, University College London
MICHAEL DOBSON, Birkbeck College, University of London
DAVID GEORGE, Urbana University
ANITA M. HAGERMAN, Washington University

GRAHAM HOLDERNESS, University of Hertfordshire
MARGARET KNAPP, Arizona State University
ADRIAN DOUGLAS POOLE, University of Cambridge
ROBERT SAWYER, East Tennessee State University
KATHERINE WEST SCHEIL, University of Minnesota
EMILY SHORTSLEF, Columbia University
MONIKA SMIALKOWSKA, Northumbria University
SUZANNE STEIN, University of South Florida
JOYCE SUTPHEN, Gustavus Adolphus College

Seminar: Shakespeare and the New Media

Burnham Room, Silver Level

Leaders: DAVID LEE MILLER, University of South Carolina and DOUG LARUE RESIDE, Maryland Institute of Technology in the Humanities

MICHAEL BEST, University of Victoria
AMELIA R. BITELY, SUNY, Buffalo
CHRISTIE CARSON, Royal Holloway, University of London

ADRIENNE EASTWOOD, San Jose State University
ALAN GALEY, University of Toronto
DIANE K. JAKACKI, University of Waterloo
DAN KULMALA, Fort Hays State University
ANETA MANCEWICZ, Kazimierz Wielki University
JESSICA MCCALL, University of Nevada
SHARON O'DAIR, University of Alabama

Seminar: Shakespeare: Immigrants and Aliens

Dusable Room, Silver Level

Leaders: RUBEN ESPINOSA, University of Texas, El Paso and DAVID RUITER, University of Texas, El Paso

ELIZABETH ACOSTA, Wayne State University
BERNADETTE ANDREA, University of Texas, San Antonio
MARY L. DUDY BJORK, Arizona State University
URVASHI CHAKRAVARTY, University of Pennsylvania
MARISA ROSE CULL, Randolph-Macon College
PETER ERICKSON, Williams College
ERIC GRIFFIN, Millsaps College
IMTIAZ HABIB, Old Dominion University
PHILIPPA M. KELLY, University of New South Wales
MARJORIE RUBRIGHT, University of Toronto
KATHRYN VOMERO SANTOS, New York University
GERALDO DE SOUSA, University of Kansas

Seminar: Shakespeare in Transit

Ogden Room, Silver Level

Leader: ROBERT SHAUGHNESSY, University of Kent

LAURA WILLIAMSON AMBROSE, Saint Mary's College
DARLENE FARABEE, University of South Dakota
BARBARA HODGDON, University of Michigan
ANDREW LAVENDER, Central School of Speech and Drama

SONIA MASSAI, King's College, London
GRETCHEN E. MINTON, Montana State University
ANN PLEISS MORRIS, University of London
ROBERT TOPINKA, University of Kansas
BRONWYN V. WALLACE, University of Pennsylvania
RAMONA WRAY, Queen's University

Seminar: Shakespeare's Sonnets in Context

Soldier Field Room, Bronze Level

Leader: DYPMNA C. CALLAGHAN, Syracuse University

DENISE ALBANESE, George Mason University
KEVIN D. CURRAN, University of North Texas
ROBERT F. DARCY, University of Nebraska, Omaha
STEPHEN DENG, Michigan State University
CHRISTINE E. HUTCHINS, Hostos Community College, CUNY

RICHARD A. LEVIN, University of California, Davis
ROBERT MATZ, George Mason University
MICHAEL W. PETERSEN, Northern Illinois University
STEPHANIE PIETROS, Fordham University
SUPARNA ROYCHOUDHURY, Harvard University
MATTHEW ZARNOWIECKI, Auburn University

Seminar: Staging the Blazon

Columbian Room, Bronze Level

Leaders: DEBORAH UMAN, St. John Fisher College and SARA MORRISON, William Jewell College

ARIANE MARIE BALIZET, Texas Christian University
JAMES J. CONDON, University of California, Riverside
LISA A. DICKSON, University of Northern British Columbia
LYNN ENTERLINE, Vanderbilt University
CORA FOX, Arizona State University

Saturday, 3 April

LAURA H. FRIEDMAN, University of Virginia
EVELYN GAJOWSKI, University of Nevada, Reno
XOCHITL GILKESON, University of Wisconsin
FREDERICK KIEFER, University of Arizona
SARA D. LUTTFRING, University of Illinois, Urbana-Champaign
JOSEPH M. ORTIZ, SUNY, Brockport
JAMES D. PESTA, University of Wisconsin, Oshkosh
RHONDA LEMKE SANFORD, Fairmont State University
NANCY L. SIMPSON, University of Wisconsin
LISA STARKS-ESTES, University of South Florida, St. Petersburg

Seminar: What is the History Play? Part Two

Water Tower Room, Bronze Level

Leader: BRIAN WALSH, Yale University

DAVID M. BERGERON, University of Kansas
RICHARD BRUCHER, University of Maine
MARLISS C. DESENS, Texas Tech University
GINA M. DISALVO, Northwestern University
EDWARD GIESKES, University of South Carolina
BRADLEY GREENBURG, Northeastern Illinois University
BRIAN J. HARRIES, University of Kansas
JAMES D. MARDOCK, University of Nevada, Reno
SUSANNAH B. MONTA, University of Notre Dame
KAVITA VIDYA MUDAN, University of Oxford
KAREN MELISSA OBERER, Montréal, Québec
JEFFREY A. RUFO, Trinity University
ANNE-MARIE E. SCHULER, Columbus, Ohio
AMY SCOTT, McGill University
WILLIAM PROCTOR WILLIAMS, University of Akron

Seminar: Who Hears? Shakespeare's Stage and Screen Audiences

Picasso Room, Bronze Level

Leader: LAURY MAGNUS, United States
Merchant Marine Academy

HEIDI BRAYMAN HACKEL, University of California, Riverside
ANTHONY BURTON, University of Massachusetts, Amherst
WALTER W. CANNON, Central College-Iowa
GAYLE GASKILL, St. Catherine University
JAMES HIRSH, Georgia State University
JENNIFER R. HOLL, Graduate Center, CUNY
KATHLEEN KALPIN, University of South Carolina, Aiken

BERNICE W. KLIMAN, hamletworks.org
ERIN MINEAR, College of William and Mary
NOVA MYHILL, New College of Florida
SAMUEL B. PRIME, Northwestern University
PHILIPPA MARY SHEPPARD, University of Toronto
KIRILKA STAVREVA, Cornell College
ALICIA SUTLIFF-BENUSIS, University of Kansas

6:00 to 10:00 p.m.

Open House

Timothy O'Tooles Pub

(622 North Fairbanks Court)

<http://www.timothytooles.com/map.html>

Sponsored by *THE SHAKESPEARE ENCYCLOPEDIA: LIFE, WORKS, WORLD, AND LEGACY*

Join the Editors, contributors, and fellow SAA members, any time during this evening Open House in the restaurant district, for food, drink, visuals, and previews.

9:00 to 11:00 p.m.

Film Screening: *Othello: The Tragedy of the Moor* *Grand AB, East Tower*

Directed by ZAIB SHAIKH (2008)

Post-Screening Discussion led by AVRAHAM OZ, University of Haifa.

10:00 p.m. to 1:00 a.m.

The Dance

Crystal Ballroom, Green Level

With music by FIG MEDIA and a cash bar.

Sponsored by the SAA and the Malone Society. Tickets are available at the registration tables and at the door.

Participants in the 38th Annual Meeting

Hardin Aasand, Indiana University-Purdue University,
Fort Wayne

Elizabeth Acosta, Wayne State University
Pascale Aebischer, University of Exeter
Patricia Akhimie, Columbia University
Ken Albala, University of the Pacific
Denise Albanese, George Mason University
Cristina Leon Alfar, Hunter College, CUNY
David Keith Anderson, University of Oklahoma
Judith H. Anderson, Indiana University
Bernadette Andrea, University of Texas, San Antonio
Jonathan Arac, University of Pittsburgh
John M. Archer, New York University
Douglas H. Arrell, University of Winnipeg
Charlotte Artese, Agnes Scott College
Dana E. Aspinall, Alma College
John H. Astington, University of Toronto
M. G. Aune, California University of Pennsylvania
Linda Austern, Northwestern University
Laura Aydelotte, University of Chicago

Rebecca Ann Bach, University of Alabama, Birmingham
Patricia Badir, University of British Columbia
Byron B. Bailey, University of Cincinnati
David J. Baker, University of North Carolina
Jonathan Baldo, Eastman School of Music
Ariane Marie Balizet, Texas Christian University
Roberta Barker, Dalhousie University
Andrew Barnaby, University of Vermont
J. Leeds Barroll, Folger Shakespeare Library
Margaret Bartley, Bloomsbury Books
Ann Basso, University of South Florida
Robin E. Bates, Lynchburg College
Sibylle Baumbach, Stanford University
John Robert Baxter, Dalhousie University
Mark Bayer, University of Texas, San Antonio
Audrey L. Becker, Marygrove College
James P. Bednarz, Long Island University
Benjamin V. Beier, University of Wisconsin
Sean Benson, University of Dubuque
Peter Berek, Mount Holyoke College
Thomas L. Berger, Mary Baldwin College
David M. Bergeron, University of Kansas
Jean-Francois Bernard, Université de Montréal
Michael J. Berntsen, University of Louisiana, Lafayette
Michael Best, University of Victoria
David Bevington, University of Chicago
Caratyn Alyssa Bialo, University of California, San
Diego
James Biester, Loyola University Chicago
Christian M. Billing, University of Hull
Eric Alexander G. Binnie, Hendrix College
Amelia R. Bitely, SUNY, Buffalo
Mary L. Dudy Bjork, Arizona State University
Scott Black, University of Utah
Mary A. Blackstone, University of Regina
Elizabeth A. Blake, New York University
Gina Bloom, University of California, Davis
Elizabeth N. Bobo, University of Louisiana, Lafayette
Russ Bodi, Owens College
Kevin A. Boettcher, University of Wisconsin
Ronald J. Boling, Lyon College

Stephen Booth, University of California, Berkeley
Anston Bosman, Amherst College
Keith M. Botelho, Kennesaw State University
Claire M.L. Bourne, University of Pennsylvania
Lara Bovilsky, University of Oregon
Andrew Bozio, University of Michigan
A.R. Braummuller, University of California, Los Angeles
Heidi Brayman Hackel, University of California,
Riverside
Joshua Lea Brazee, University of Wisconsin
Daniel Breen, Ithaca College
Ashley M. Brinkman, Columbia University
Karen R. Britland, University of Wisconsin
Katherine Steele Brokaw, University of Michigan
James M. Bromley, Miami University of Ohio
Carolyn E. Brown, University of San Francisco
Victoria M.R. Brownlee, Queen's University, Belfast
Richard Brucher, University of Maine
Lynne Dickson Bruckner, Chatham College
Douglas Bruster, University of Texas
Regina Buccola, Roosevelt University
Paul Budra, Simon Fraser University
James C. Bulman, Allegheny College
Nancy Mohrlock Bunker, Macon State College
Mark Thornton Burnett, Queen's University, Belfast
Richard Burt, University of Florida, Gainesville
Anthony Burton, University of Massachusetts, Amherst
Mary Ann Bushman, Illinois Wesleyan University
Rebecca Bushnell, University of Pennsylvania
Eric Vincent Byville, Loyola University Chicago

Alberto Cacicedo, Albright College
Gina Marie Caison, University of California, Davis
Maurizio Calbi, University of Salerno
Ellen M. Caldwell, California State University,
Fullerton
Joshua M. Calhoun, University of Delaware
Dympna C. Callaghan, Syracuse University
Clara Calvo, University of Murcia
John Hugh Cameron, Dalhousie University
Joseph Campana, Rice University
Edmund Valentine Campos, Northwestern University
Catherine G. Canino, University of South Carolina,
Upstate
Walter W. Cannon, Central College-Iowa
Eric Andrew Carlson, Queen's University
William C. Carroll, Boston University
Christie Carson, Royal Holloway University of London
Rob Carson, Hobart and William Smith Colleges
Thomas P. Cartelli, Muhlenberg College
Kent Cartwright, University of Maryland
Jim E. Casey, High Point University
Sheila T. Cavanagh, Emory University
Juan Francisco Cerda Martinez, University of Murcia
Urvashi Chakravarty, University of Pennsylvania
Stephanie Chamberlain, Southeast Missouri State
University
Brinda Charry, Keene State College
Simone Chess, Wayne State University
Yu-Chun Chiang, University College London
Brandon Christopher, University of Winnipeg
Darlene Ciraulo, University of Central Missouri
Glenn Clark, University of Manitoba
Christopher M. Clary, Northwestern University
Cyndia Susan Clegg, Pepperdine University
Katharine Cleland, Pennsylvania State University

Michael C. Clody, University of Houston, Clear Lake
 Christopher J. Cobb, Saint Mary's College
 Thomas Cogswell, University of California, Riverside
 Jason Elliot Cohen, Berea College
 Ralph Alan Cohen, Mary Baldwin College
 James J. Condon, University of California, Riverside
 Rob Conkie, La Trobe University
 James P. Conlan, University of Puerto Rico
 Ann Jennalie Cook, Vanderbilt University
 Tom Cornford, University of Warwick
 Vanessa I. Corredera, Northwestern University
 Barbara Correll, Cornell University
 Nora L. Corrigan, Mississippi University for Women
 John D. Cox, Hope College
 Patrick Crapanzano, St. John's University
 Julie Crawford, Columbia University
 Hannah J. Crawford, King's College London
 Christopher J. Crosbie, North Carolina State University
 Melissa M. Croteau, California Baptist University
 Marisa Rose Cull, Randolph-Macon College
 Karen Cunningham, University of California, Los Angeles
 Kevin D. Curran, University of North Texas
 Andrew Cutrofello, Loyola University Chicago

Celia Rose Daileader, Florida State University
 Alice A. Dailey, Villanova University
 Andrew Nicholas Daniel, Johns Hopkins University
 Ailbhe Darcy, University of Notre Dame
 Robert F. Darcy, University of Nebraska, Omaha
 Rebecca Dark, University of Texas, Arlington

Irene G. Dash, Hunter College, CUNY
 Sarah G. Dawson, University of Notre Dame
 Margreta de Grazia, University of Pennsylvania
 Sara M. Deats, University of South Florida
 Jane Hwang Degenhardt, University of Massachusetts
 Jessica E. Dell, McMaster University
 Carla Della Gatta, San Francisco State University
 Jill Delsigne, Rice University
 Jason M. Demeter, Arizona State University
 Stephen Deng, Michigan State University
 Marliiss C. Desens, Texas Tech University
 Christy Desmet, University of Georgia
 Alan C. Dessen, University of North Carolina
 Emily Detmer-Goebel, Northern Kentucky University
 Gina M. Di Salvo, Northwestern University
 Joanne Diaz, Illinois Wesleyan University
 Lisa A. Dickson, University of Northern British Columbia
 Vernon Guy Dickson, Florida International University
 Craig Dionne, Eastern Michigan University
 Natasha Distiller, University of Cape Town
 Hank Dobin, Washington & Lee
 Michael Dobson, Birkbeck College, University of London
 Frances E. Dolan, University of California, Davis
 Jeffrey S. Doty, West Texas A&M
 Lue Douthit, Oregon Shakespeare Festival
 Michelle M. Dowd, University of North Carolina, Greensboro
 Paul M. Dowling, Canisius College
 Annette Drew-Bear, Washington and Jefferson College

 **GREENWOOD** from the collections of
ABC CLIO

The Shakespeare Encyclopedia

Life, Works, World, and Legacy

Forthcoming

Edited by Patricia Parker

In the most comprehensive work of its kind, nearly 4,000 entries by hundreds of expert contributors examine all aspects of Shakespeare.

September 2010, 2,280 pages, 8 1/2x11
ISBN: 978-0-313-33639-3, \$495.00
eISBN: 978-0-313-05589-8

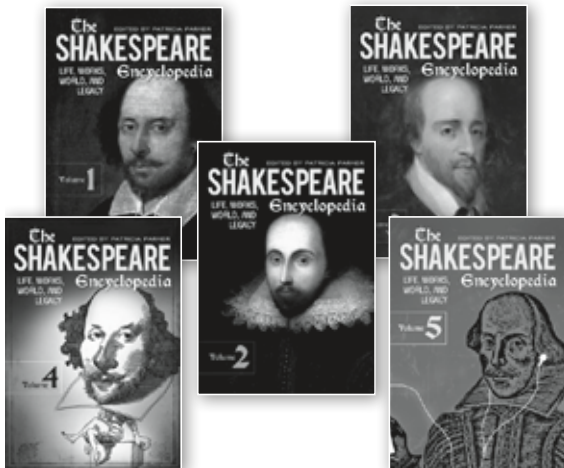

OPEN HOUSE
SATURDAY 3 APRIL, 6 to 10 pm
 Timothy O'Toole's Pub
 622 North Fairbanks Court

Join the Editors, contributors, and fellow SAA members for food, drink, visuals, and previews.

20% off conference discount. Code: **101SKA4**

For more information, visit the Scholar's Choice booth.

ORDER ONLINE: www.abc-clio.com | BY PHONE: 1.800.368.6868 | BY FAX: 866.270.3856

New from **OXFORD**

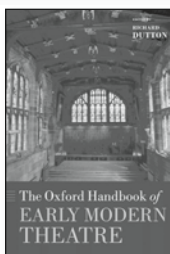

Shakespeare and Biography

DAVID BEVINGTON
(Oxford Shakespeare Topics)
2010 192 pp.
Hardback \$45.00 Paperback \$24.95

Milton's Words

ANNABEL PATTERSON
2009 224 pp.
Hardback \$34.95

The Strangeness of Tragedy

PAUL HAMMOND
2009 224 pp.
Hardback \$55.00

Shakespeare and Literary Theory

JONATHAN GIL HARRIS
(Oxford Shakespeare Topics)
2010 216 pp.
Hardback \$45.00 Paperback \$24.95

**Narcissism and Suicide and
in Shakespeare and his
Contemporaries**

ERIC LANGLEY
2010 288 pp.
Hardback \$95.00

The Oxford Handbook of Milton

Edited by NICHOLAS MCDOWELL
and NIGEL SMITH
(Oxford Handbooks of Literature)
2009 656 pp.
Hardback \$150.00

**The Oxford Handbook of Early
Modern Theatre**

Edited by RICHARD DUTTON
(Oxford Handbooks of Literature)
2009 624 pp. 24 halftones
Hardback \$150.00

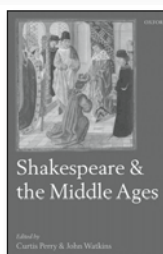

Shakespeare and the Middle Ages

Edited by CURTIS PERRY
and JOHN WATKINS
2009 304 pp. 3 halftones
Hardback \$99.00

Publishing, Politics, and Culture

**The King's Printers in the Reign
of James I and VI**
GRAHAM REES and MARIA WAKELY
2010 320 pp.
Hardback \$99.00

Selected Letters and Other Papers

EDMUND SPENSER
Edited by CHRISTOPHER BURLINSON
and ANDREW ZURCHER
2009 420 pp. 8 halftones; 2 maps
Hardback \$250.00

Shakespeare, Sex, and Love

STANLEY WELLS
2010 228 pp. 25 halftones
Hardback \$27.95

Divinity and State

DAVID WOMERSLEY
2010 400 pp. 2 halftones
Hardback \$110.00

New in Paperback

**Thomas Middleton:
The Collected Works**

Edited by GARY TAYLOR
and JOHN LAVAGNINO
2008 (paper 2010) 2018 pp. 79 halftones, 1 map
Paperback \$45.00 Hardback \$199.00

Locating Privacy in Tudor London

LENA COWEN ORLIN
2008 (paper 2010) 392 pp. 45 halftones
Paperback \$45.00 Hardback \$110.00

Visit our booth for 20% off!
Visit us online at www.oup.com/us.

OXFORD
UNIVERSITY PRESS

Jennifer Drouin, University of Alabama
Heather Dubrow, Fordham University
Lowell Nelson Duckert, George Washington University
Holly E. Dugan, George Washington University
Leslie C. Dunn, Vassar College
Susan Michele Dunn-Hensley, Wheaton College
Richard Dutton, Ohio State University
Darren J. Dyck, Dalhousie University

Adrienne L. Eastwood, San Jose State University
Sara Eaton, North Central College
Gabriel Egan, Loughborough University
Katherine E. Eggert, University of Colorado
Jeremy Ehrlich, Internet Shakespeare Editions
Laurie Ellinghausen, University of Missouri, Kansas City
Anthony Ellis, Western Michigan University
John W. Ellis-Etchison, University of Louisiana,
Lafayette
Richard Joseph Ellum, University of Notre Dame
Lars Engle, University of Tulsa
Lynn Enterline, Vanderbilt University
Peter Erickson, Williams College
Bridget Escolme, Queen Mary, University of London
Ruben Espinosa, University of Texas, El Paso

Claire Melissa Falck, University of Wisconsin
Robin Farabaugh, University of Maryland, Baltimore
County

Darlene Farabee, University of South Dakota
Mark David Farnsworth, University of Nevada, Reno
Valerie M. Fazel, Arizona State University
Jennifer Feather, University of North Carolina,
Greensboro

Jean Feerick, Brown University
Jamie H. Ferguson, University of Houston
Ewan Fernie, Royal Holloway, University of London
Jeremy Fiebig, Waldorf College
Kathryn Finin, SUNY, Oneonta
J. Caitlin Finlayson, University of Michigan, Dearborn
Emma Firestone, University of Cambridge
William Fisher, Lehman College, CUNY
Joan Fitzpatrick, Loughborough University
Andrew J. Fleck, San Jose State University
Mary Floyd-Wilson, University of North Carolina
Wes Folkerth, McGill University
John R. Ford, Delta State University
Susan Allen Ford, Delta State University
Valerie Forman, University of Colorado
Antonia Forster, University of Akron
Jennifer Forsyth, Kutztown University
Brett Foster, Wheaton College
Cora Fox, Arizona State University
Timothy Francisco, Youngstown State University
Ari Friedlander, University of Michigan
Laura H. Friedman, University of Virginia
Michael D. Friedman, University of Scranton
Briony S. Frost, University of Exeter
Lea Luecking Frost, Saint Louis University

Elizabeth Gaffney, SUNY, Westchester Community
College
Barbara Gaines, Chicago Shakespeare Theatre
Evelyn Gajowski, University of Nevada
Alan Galey, University of Toronto
Brett Gamboa, Harvard University

Daisy Garofalo, Shakespeare Institute
Lauren S. Garrett, University of North Carolina
John Garrison, University of California, Davis
Gayle Gaskill, St. Catherine University
Daniel Gates, Saginaw Valley State University
Louise C. Geddes, Adelphi University
Edward J. Geisweidt, University of Alabama
Penelope H. Geng, University of Southern California
David George, Urbana University
William Germano, Cooper Union
Regina E. Gesicki, University of Notre Dame
Lucian Ghita, Yale University
Loreen L. Giese, Ohio University
Edward Gieskes, University of South Carolina
Xochitl Gilkeson, University of Wisconsin
Jason Gleckman, Chinese University of Hong Kong
David Glimp, University of Colorado
Maureen E. Godman, Washburn University
W. L. Godshalk, University of Cincinnati
L. G. Godwin, New Mexico State University
Tamara A. Goeglein, Franklin & Marshall College
Philip Goldfarb, University of Chicago
David Golz, Kettering University
Jose Manuel Gonzalez, Universidad de Alicante
Colette Gordon, London, United Kingdom
Suzanne Gossett, Loyola University Chicago
Hugh Grady, Arcadia University
Kenneth J.E. Graham, University of Waterloo
Douglas E. Green, Augsburg College
Martin Green, Baltimore, Maryland
Marissa Greenberg, University of New Mexico
Bradley Greenburg, Northeastern Illinois University
Sayre N. Greenfield, University of Pittsburgh,
Greensburg
Amy Greenstadt, Portland State University
Cory L. Grewell, Thiel College
Andrew R. Griffin, University of California, Santa
Barbara
Eric Griffin, Millsaps College
Julia B. Griffin, Georgia Southern University
Marshall Grossman, University of Maryland
Ethan John Guagliardo, University of Notre Dame
David Guo, Georgetown University
Musa Gurnis, Columbia University
Renuka Gusain, Wayne State University
Corine W. Guy, East Carolina University

Imtiaz Habib, Old Dominion University
Lianne Habinek, Bard College
Anita M. Hagerman, Washington University
Michael Hall, Virginia Wesleyan College
Graham Hammill, University at Buffalo, SUNY
Stuart Hampton-Reeves, University of Central
Lancashire
Meredith Molly Hand, Florida State University
Lara D. Hansen, University of Nevada
Matthew C. Hansen, Boise State University
Susan Elizabeth Harlan, Wake Forest University
James L. Harner, World Shakespeare Bibliography
Brian J. Harries, University of Kansas
Jonathan Gil Harris, George Washington University
Keith Harrison, Vancouver Island University
Andrew James Hartley, University of North Carolina,
Charlotte
Jan M. Hawkey, University of Nevada, Reno

— FROM THE FOLGER SHAKESPEARE LIBRARY —

Acclaimed editions of Shakespeare's plays

EDITED BY BARBARA A. MOWAT AND PAUL WERSTINE



<i>The Merchant of Venice</i> 9781439191163 \$9.95/\$12.99 Can.	<i>The Two Noble Kinsman</i> 9780671722968 \$5.99/\$7.99 Can.
---	---

EACH EDITION INCLUDES:

- Freshly edited text based directly on what the editors consider the best early printed version of the play
- Full explanatory notes conveniently placed on pages facing the text of the play
- Scene-by-scene summaries
- An introduction to reading the language of the play
- An essay by an outstanding scholar providing a modern perspective on the play
- Illustrations from the Folger Shakespeare Library's rare-book archives

For more information including title list, curriculum guides or to order an examination copy, visit academic.simonandschuster.net. For more information about the Folger Shakespeare Library, visit www.folger.edu. Folger Shakespeare Library editions are published by Simon & Schuster.



www.simonandschuster.net

Michael L. Hays, Las Cruces, New Mexico
 Abigail Heald, Stanford University
 Paul J. Hecht, Purdue University, North Central
 Pierre Hecker, Carleton College
 Donald Hedrick, Kansas State University
 Nicholas Ryan Helms, University of Alabama
 Frances L. Helphinstine, Morehead State University
 Kirk Hendershott-Kraetzer, Olivet College
 Trish Thomas Henley, University of Cincinnati
 Brenda Henry-Offor, Brooklyn, New York
 Roze Hentschell, Colorado State University
 Catherine A. Henze, University of Wisconsin,
 Green Bay
 Peter C. Herman, San Diego State University
 Niels Herold, Oakland University
 Jonathan Heron, University of Warwick
 Jennifer Higginbotham, Ohio State University
 John C. Higgins, University of California, San Diego
 Rachel E. Hile, Indiana University-Purdue University,
 Fort Wayne
 Michael J. Hirrel, Arlington, Virginia
 Brett D. Hirsch, British Shakespeare Association
 James Hirsh, Georgia State University
 Barbara Hodgdon, University of Michigan
 Ton Hoenselaars, Utrecht University
 Tiffany T. Hoffman, McGill University
 Lalita Pandit Hogan, University of Wisconsin,
 La Crosse
 Patrick Colm Hogan, University of Connecticut
 Graham Holderness, University of Hertfordshire

Jennifer R. Holl, Graduate Center, CUNY
 Peter D. Holland, University of Notre Dame
 Scott A. Hollifield, University of Nevada, Las Vegas
 Marion Hollings, Middle Tennessee State University
 Gavin Hollis, Hunter College, CUNY
 Christopher Holmes, SUNY, Maritime
 Adam G. Hooks, University of Iowa
 Jonathan Hope, Strathclyde University
 Alexander C. Y. Huang, Pennsylvania State University
 Clark Hulse, University of Illinois, Chicago
 Maurice Hunt, Baylor University
 Elizabeth A. Hutcheon, University of Chicago
 Christine E. Hutchins, Hostos Community College,
 CUNY
 Kimberly A. Huth, Ithaca College
 Wendy Beth Hyman, Oberlin College

William Ingram, University of Michigan
 Grace Ioppolo, University of Reading
 Megan Lynn Isaac, Elon University
 Emily Ruth Isaacson, Chowan University
 Kenneth S. Jackson, Wayne State University
 Diane K. Jakacki, University of Waterloo
 Heather James, University of Southern California
 Theodora A. Jankowski, Pennsylvania State University,
 Wilkes-Barre
 Trey Jansen, University of Nevada, Reno
 Joseph Jenkins, University of California, Irvine
 Kristine Anne Johanson, University of St. Andrews
 Eric M. Johnson, George Mason University

New from Stanford University Press

On Demand

*Writing for the Market in Early
 Modern England*

DAVID J. BAKER



“A very astute and provocative work ... makes a significant contribution to our understanding of early modern literature and culture.”

—Robert Markley,
 University of Illinois at
 Urbana-Champaign

“*On Demand* presents us with a fresh, lucid, and persuasive account of what it meant and what it felt like to live and to write at a transitional moment in English socio-economic history.”

—Theodore Leinwand,
 University of Maryland

\$55.00 cloth

Philosophers on Shakespeare

Edited by PAUL A. KOTTMAN

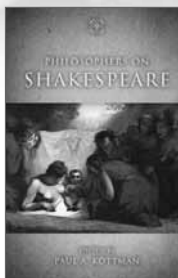

“Kottman’s ambitious book draws our attention to the role of Shakespeare and his plays in forging a crucial strain of philosophical discourse for the past two centuries.”

—W. B. Worthen,
 Barnard College

“A sense of genuine engagement and creative re-encounter with the legacy of Shakespeare runs through the selected essays, as well as Kottman’s lucid, determined, and compassionate introduction.”

—Julia Reinhard Lupton,
 University of California, Irvine

\$21.95 paper \$60.00 cloth

Stanford
 University Press

800.621.2736 www.sup.org

Literature's biggest controversy resolved.

For centuries, the authorship of Shakespeare's plays has been challenged by luminaries as diverse as Sigmund Freud, Helen Keller, Orson Welles, Henry James, and Mark Twain. How could a young man from rural Warwickshire, lacking a university education, write some of the greatest works in the English language?

Contested Will unravels the mystery of Shakespeare's authorship, retracing why and when doubts first arose, what's at stake in the controversy for how we value Shakespeare's achievement, and why, in the end, there can be no doubt about who wrote the plays.

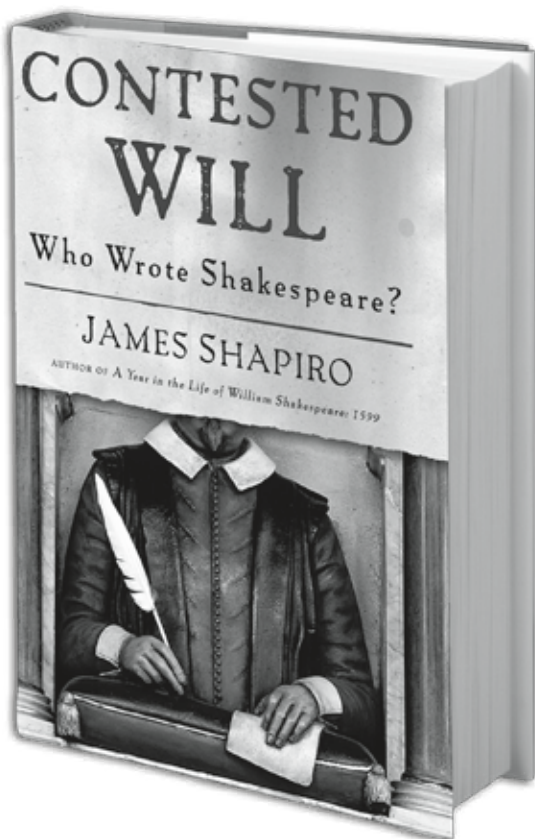

Available wherever books are sold.



www.simonandschuster.com

Eric Johnson-DeBaufre, Boston University
Mark A. Johnston, University of Windsor
Melissa J. Jones, Eastern Michigan University

Coppelia Kahn, Brown University
Kathleen Kalpin, University of South Carolina, Aiken
Peter Kanelos, Loyola University Chicago
M. Lindsay Kaplan, Georgetown University
Farah Karim-Cooper, Shakespeare's Globe
Isabel C. Karremann, University of Munich
David Kathman, Chicago, Illinois
W. David Kay, University of Illinois, Urbana-Champaign
James Kearney, University of California, Santa Barbara
Russell L. Keck, Purdue University
Joe Keener, Indiana University, Kokomo
Dorothea Kehler, San Diego State University
Katherine R. Kellett, Boston College
Shannon Elizabeth Kelley, Fairfield University
Charles Adams Kelly, Howland Research
Philippa M. Kelly, University of New South Wales
Colleen E. Kennedy, Ohio State University
Lloyd Edward Kermode, California State University,
Long Beach

Bill Kerwin, University of Missouri, Columbia
Lizz Ketterer, University of New Mexico
Harry Keyishian, Fairleigh Dickinson University
Frederick Kiefer, University of Arizona
Adrian R.D. Kiernander, University of New England
Yugon Kim, University of Notre Dame
Ros King, University of Southampton
Arthur F. Kinney, University of Massachusetts, Amherst
Clare Kinney, University of Virginia
Andras Kisery, City College, CUNY
Wesley R. Kisting, Augusta State University
Adam H. Kitzes, University of North Dakota
Elizabeth Klett, University of Houston, Clear Lake
Bernice W. Kliman, hamletworks.org
James A. Knapp, Eastern Michigan University
Margaret Knapp, Arizona State University
Ross M. Knecht, New York University
Brian K. Knight, University of Wisconsin
Jeffrey T. Knight, Northwestern University
Leah Knight, Brock University
Roslyn L. Knutson, University of Arkansas, Little Rock
Susan L. Knutson, Université Sainte-Anne
Yu Jin Ko, Wellesley College
Justin Kolb, University of Wisconsin
Alysia M. Kolentsis, Stanford University
Elizabeth Zeman Kolkovich, Ohio State University
Marcela Kostihova, Hamline University
Paul A. Kottman, New School University
Matt Kozusko, Ursinus College
Barbara I. Kreps, University of Pisa
Matthew J. Kubus, Shakespeare Institute
Dan Kulmala, Fort Hays State University
Arul Kumaran, St. Thomas More College

Peter Lake, Princeton University
Edel Mary Lamb, University of Sydney
Jonathan P. Lamb, University of Texas
Julian Lamb, Chinese University of Hong Kong
James S. Lambert, University of Iowa
Jesse M. Lander, University of Notre Dame
Jessica Landis, University of Massachusetts, Amherst
Sarah B. Langan, Oregon Shakespeare Festival
Unhae Langis, Slippery Rock University

Douglas M. Lanier, University of New Hampshire
Caroline Dodge Latta, Columbia College Chicago
Andrew Lavender, Central School of Speech and
Drama

Iris Amy Law, University of Notre Dame
Andrea Caroline Lawson, San Clemente, California
Adam J. Ledger, University of Hull
Theodore Leinwand, University of Maryland
Rebecca Lemon, University of Southern California
Allison Kellar Lenhardt, University of Georgia
Patricia J. Lennox, New York University
Kendra Leonard, Westminster Choir College
Zachary Lesser, University of Pennsylvania
Richard A. Levin, University of California, Davis
Laura Levine, New York University
Nina Levine, University of South Carolina
Fritz J. Levy, University of Washington
Jemma Alix Levy, Mary Baldwin College
Cynthia Lewis, Davidson College
Dallin Lewis, University of Notre Dame
Naomi Conn Liebler, Montclair State University
Erika T. Lin, George Mason University
William T. Liston, Ball State University
Arthur L. Little, Jr., University of California, Los
Angeles
Katharine K. Liu, Folger Shakespeare Library
William J. Lloyd, Damascus, Maryland
James N. Loehlin, University of Texas
Sandra A. Logan, Michigan State University
Michael LoMonico, Folger Shakespeare Library
Donna J. Long, Fairmont State University
Zackariah Long, Ohio Wesleyan University
Catherine Loomis, University of New Orleans
Natalie Jones Loper, University of Alabama
Jeremy Lopez, University of Toronto
Cameron W. Louis, University of Regina
Genevieve Love, Colorado College
Jennifer Low, Florida Atlantic University
Bryan J. Lowrance, Columbia University
Christina Luckyj, Dalhousie University
Rory G. Lukins, University of Southern California
Julia Reinhard Lupton, University of California, Irvine
Sara D. Luttfiring, University of Illinois, Urbana-
Champaign
Tara Lynn Lyons, University of Illinois, Urbana-
Champaign

Joyce G. MacDonald, University of Kentucky
Ian MacInnes, Albion College
Ellen MacKay, Indiana University
Frank F. Madden, SUNY, Westchester Community
College
Christopher J. Madson, University at Buffalo
Jessica M. Maerz, University of Wisconsin, Milwaukee
Christine Maffuccio, University of Maryland
Laury Magnus, U.S. Merchant Marine Academy
Lynne Magnusson, University of Toronto
Scott Maisano, University of Massachusetts, Boston
Bindu Malieckal, Saint Anselm College
Eric S. Mallin, University of Texas
Toby P. Malone, Toronto, Ontario
Aneta Mancewicz, Kazimierz Wielki University
Lawrence Manley, Yale University
Howard Marchitello, Rutgers University
James D. Mardock, University of Nevada
James J. Marino, Cleveland State University

The Bedford Shakespeare Series



Also of interest

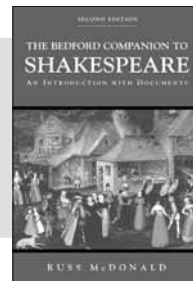

Catherine Gimelli Martin, University of Memphis
 Ann M. Martinez, University of Kansas
 Mauricio Esteban Martinez, University of Guelph
 Sonia Massai, King's College London
 Maya Mathur, University of Mary Washington
 Christopher Matusiak, University of Toronto
 Robert Matz, George Mason University
 Katharine Eisaman Maus, University of Virginia
 Lynn M. Maxwell, Emory University
 Cary M. Mazer, University of Pennsylvania
 Kris McAbee, University of California, Santa Barbara
 Jessica McCall, University of Nevada
 Andrew D. McCarthy, Washington State University
 Erin Ann McCarthy, Ohio State University
 Michael McClintock, Bridgewater State College
 Aaron McCollough, University of Michigan
 Richard C. McCoy, Queens College, CUNY
 Kristen McDermott, Central Michigan University
 Russ McDonald, Goldsmiths, University of London
 Lisa J. McDonnell, Denison University
 Roderick H. McKeown, University of Toronto
 Gordon McMullan, King's College London
 Cameron Hunt McNabb, University of South Florida
 Paula McQuade, DePaul University
 Richard J. Meek, De Montfort University
 Nedda Mehdizadeh, George Washington University
 Dieter Mehl, University of Bonn
 Carol Mejia-LaPerle, Wright State University
 Kirk Melnikoff, University of North Carolina, Charlotte
 Madhavi Menon, American University
 Steve Mentz, St. John's University

Paul D. Menzer, Mary Baldwin College
 Jean M. Merrill, Loras College
 Allison E. Meyer, University of Illinois
 David Lee Miller, University of South Carolina
 Tracey E. Miller-Tomlinson, New Mexico State University
 Erin Minear, College of William and Mary
 Gretchen E. Minton, Montana State University
 Alfredo Michel Modenessi, Universidad Nacional Autónoma de México
 Susannah Brietz Monta, University of Notre Dame
 Marianne Montgomery, East Carolina University
 Gaywyn E. Moore, University of Kansas
 Sara Morrison, William Jewell College
 Ruth Morse, Université Paris Diderot
 Ian Frederick Moulton, Arizona State University
 John M. Mucciolo, Chatham, New Jersey
 Kavita Vidya Mudan, University of Oxford
 Rolf O. Mueller, Fanny-Leicht-Gymnasium, Stuttgart
 Steven Mullaney, University of Michigan
 Cyrus G. Mulready, SUNY, New Paltz
 Marga Munkelt, University of Munster
 Lucy Munro, Keele University
 Rebecca Munson, University of California
 Andrew Declan Murphy, University of St. Andrews
 Erin Murphy, Boston University
 Heather J. Murray, Pennsylvania State University
 M. Stephanie Murray, University of Chicago
 Nova Myhill, New College of Florida
 Vin Nardizzi, University of British Columbia
 Joseph Navitsky, University of Southern Mississippi

New Shakespeare titles from Ashgate Publishing...

Visit us in the exhibit hall and receive 50% off display copies!



Negotiating Shakespeare's Language in *Romeo and Juliet*

Reading Strategies from Criticism, Editing and the Theatre

Lynette Hunter and **Peter Lichtenfels**

STUDIES IN PERFORMANCE
AND EARLY MODERN DRAMA

Jun 2009. 254 pgs. Hbk. 978-0-7546-5844-3

The Materiality of Religion in Early Modern English Drama **Elizabeth Williamson**

STUDIES IN PERFORMANCE
AND EARLY MODERN DRAMA

Sep 2009. 242 pgs. Hbk. 978-0-7546-6827-5

Marriage, Performance, and Politics at the Jacobean Court **Kevin Curran**

STUDIES IN PERFORMANCE
AND EARLY MODERN DRAMA

Oct. 2009. 198 pgs. Hbk. 978-0-7546-6351-5

Locating the Queen's Men, 1583–1603

Material Practices and Conditions of Playing

Edited by **Helen Ostovich**,
Holger Schott Syme
and **Andrew Griffin**

STUDIES IN PERFORMANCE
AND EARLY MODERN DRAMA

Jun 2009. 284 pgs. Hbk. 978-0-7546-6661-5

NEW **Thomas Heywood's Theatre, 1599–1639**

Locations, Translations,
and Conflict

Richard Rowland

STUDIES IN PERFORMANCE
AND EARLY MODERN DRAMA

Mar 2010. 394 pgs. Hbk. 978-0-7546-6925-8



WWW.ASHGATE.COM/SAA2010

All online orders receive a discount • www.ashgate.com • PO Box 2225 • Williston, VT 05495-2225 • Toll-free: 1-800-535-9544

New from **PALGRAVE MACMILLAN**

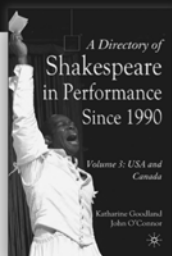

A DIRECTORY OF SHAKESPEARE IN PERFORMANCE FROM 1970 TO 1989

Volume 2, USA and Canada
Katharine Goodland
and John O'Connor
April 2010 / 1762 pp.
978-0-230-54677-6
\$225.00 hc. (C\$275.00)

SHAKESPEARE AND YOUTH CULTURE

Jennifer Hulbert,
Kevin J. Wetmore, Jr., and
Robert L. York
2010 / 264 pp.
ISBN: 978-0-230-62307-1
\$30.00 pb. (C\$36.00)

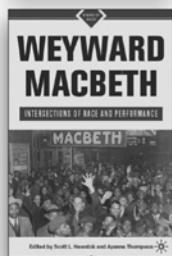

RELOCATING SHAKESPEARE AND AUSTEN ON SCREEN

Lisa Hopkins
2009 / 240 pp.
ISBN: 978-0-230-57955-2
\$90.00 hc. (C\$109.00)

SHAKESPEARE'S COMEDIES

Kiernan Ryan
2009 / 224 pp.
ISBN: 978-0-333-59932-7
\$30.00 pb. (C\$36.00)

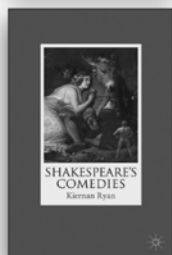

WEYWARD MACBETH

Intersections of Race and Performance
Edited by Scott L. Newstok and
Ayanna Thompson
Signs of Race
2009 / 308 pp.
ISBN: 978-0-230-61642-4
\$28.95 pb. (C\$35.00)

SHAKESPEARE'S LATE PLAYS

Pericles, Cymbeline, The Winter's Tale, The Tempest
Nicholas Potter
Readers' Guides to Essential Criticism
2009 / 192 pp.
ISBN: 978-0-230-20050-0
\$21.95 pb. (C\$25.95)

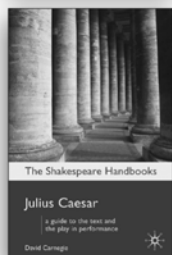

SHAKESPEARE

Poetry, History, and Culture
Jonathan Hart
2009 / 288 pp.
ISBN: 978-0-230-61677-6
\$80.00 hc. (C\$102.00)

SHAKESPEARE'S WIDOWS

Dorothea Kehler
2009 / 256 pp.
ISBN: 978-0-230-61703-2
\$85.00 hc. (C\$103.00)



SHAKESPEARE AND RELIGIOUS CHANGE

Edited by Kenneth J. E. Graham and
Philip D. Collington
Early Modern Literature in History
2009 / 288 pp.
ISBN: 978-0-230-21309-8
\$85.00 hc. (C\$103.00)

CROSS-GENDER SHAKESPEARE AND ENGLISH NATIONAL IDENTITY

Wearing the Codpiece
Elizabeth Klett
2009 / 220 pp.
ISBN: 978-0-230-61632-5
\$80.00 hc. (C\$97.00)

SHAKESPEARE AND THE INSTITUTION OF THEATRE

The Best in this Kind
Erica Sheen
Palgrave Shakespeare Studies
2009 / 256 pp.
ISBN: 978-0-230-52480-4
\$75.00 hc. (C\$91.00)

JULIUS CAESAR

David Carnegie
2009 / 176 pp.
ISBN: 978-1-4039-4891-5
\$18.00 pb. (C\$22.00)

KING LEAR

John Russell Brown
2009 / 176 pp.
ISBN: 978-1-4039-8689-4
\$16.95 pb. (C\$19.95)

READING, WRITING AND THE INFLUENCE OF HAROLD BLOOM

Alan Rawes and Jonathon Shears
2010 / 288 pp.
ISBN: 978-0-7190-7701-2
\$79.95 hc.

LADY MACBETH IN AMERICA

From the Stage to the White House
Gay Smith
Palgrave Studies in Theatre and Performance History
2010 / 252 pp.
ISBN: 978-0-230-62288-3
\$85.00 hc. (C\$103.00)



palgrave
macmillan

Distributor of Berg Publishers, I.B.Tauris,
Manchester University Press, Pluto Press and Zed Books
(888) 330-8477 • Fax: (800) 672-2054 • www.palgrave-usa.com

Bernice M. Neal, York University
 Carol Thomas Neely, University of Illinois, Urbana-Champaign
 Kelly M. Neil, University of California, Davis
 Michael A.F. Neill, University of Auckland
 Alan H. Nelson, University of California, Berkeley
 Mark Netzloff, University of Wisconsin, Milwaukee
 Sarah J. Neville, University of New Brunswick
 Lori Humphrey Newcomb, University of Illinois, Urbana-Champaign
 Harry Rex Newman, University of Birmingham
 David Nicol, Dalhousie University
 Carmen Nocentelli, University of New Mexico
 Kara Northway, Kansas State University
 Marianne Novy, University of Pittsburgh
 Steele Nowlin, Hampden-Sydney College
 Hillary M. Nunn, University of Akron

Marion O'Connor, University of Kent, Canterbury
 Sharon O'Dair, University of Alabama
 Niamh J. O'Leary, Ohio State University
 Susan G. O'Malley, Kingsborough, CUNY
 Karen Oberer, McGill University
 Sarah E. Olive, Shakespeare Institute
 Emily K. Oliver, Shakespeare Institute
 Kristen L. Olson, Pennsylvania State University
 Lena Cowen Orlin, Georgetown University
 Robert Ormsby, Memorial University of Newfoundland
 Joseph M. Ortiz, SUNY, Brockport
 David L. Orvis, Appalachian State University
 Laurie E. Osborne, Colby College

Michele Osherow, University of Maryland, Baltimore County
 Sarah Q. Ostendorf, New York University
 Avraham Oz, University of Haifa
 Bethany M. Packard, Vanderbilt University
 Jennifer K. Page, University of Louisiana, Lafayette
 Simon Palfrey, Brasenose College, Oxford
 Philip S. Palmer, University of Massachusetts, Amherst
 Jennifer Panek, University of Ottawa
 Chaeyoon Park, University of Illinois, Urbana-Champaign
 Barbara L. Parker, William Paterson University
 John L. Parker, University of Virginia
 Patricia A. Parker, Stanford University
 Sarah E. Parker, University of North Carolina
 Michelle Parkinson, University of Wisconsin, River Falls
 Elinor Parsons, De Montfort University
 Gail Kern Paster, Folger Shakespeare Library
 Vimala C. Pasupathi, Hofstra University
 Anthony G. Patricia, University of Nevada
 Elizabeth Pentland, York University
 James D. Pesta, University of Wisconsin, Oshkosh
 Michael W. Petersen, Northern Illinois University
 Kaara L. Peterson, Miami University of Ohio
 Dee Anna Phares, Northern Illinois University
 Holly Crawford Pickett, Washington and Lee University
 Robert B. Pierce, Oberlin College
 Stephanie Pietros, Fordham University
 Tripti Pillai, Loyola University Chicago
 L. Monique Pittman, Andrews University
 Ann Pleiss Morris, University of Iowa

Shakespeare

Journal of the British Shakespeare Association

Included in the Thomson Reuters Arts & Humanities Citation Index®



Shakespeare is a major peer-reviewed journal, publishing articles drawn from the best of current international scholarship on the most recent developments in Shakespearean criticism. Its principal aim is to bridge the gap between the disciplines of Shakespeare in Performance Studies and Shakespeare in English Literature and Language. The journal builds on the existing aim of the British Shakespeare Association, to exploit the synergies between academics and performers of Shakespeare.

Download a free online sample copy, register for table of contents alerts, or subscribe to the journal at: www.tandf.co.uk/journals/shakespeare



Routledge Annotated Bibliography of English Studies

Renaissance and Early Modern Literature section

Unlock the best in English Literary Studies with a free trial at:
www.routledgeabes.com

Quote code XB92501A when ordering

Routledge
 Taylor & Francis Group

ARDEN SHAKESPEARE

Must-Have Giveaway!
Arden "Genius at Work"
Coffee Mugs at our booth!

NEW THIRD SERIES PLAYS

TWELFTH NIGHT



Keir Elam,
Editor

"Astounding knowledge of elements of performance...a must-read...A wealth of... information and analysis. The introduction exemplifies scholarly achievement... Magisterial footnotes."

—*Shakespeare Quarterly*

9781903436998/PB \$17
9781903436981/HC \$100
428 pages

TIMON OF ATHENS

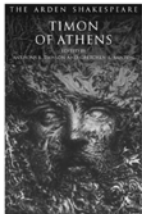

Anthony
Dawson,
Gretchen
Minton,
Editors

"Survey of scholarly issues is excellent...A critical introduction that...could scarcely be bettered...Spiced with details from a range of stage productions....An admirable edition."

—*Shakespeare Quarterly*

9781903436974/PB \$17
9781903436967/HC \$100
480 pages

KING RICHARD III

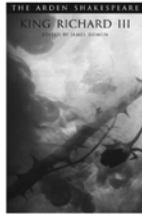

James R.
Siemon,
Editor

Examines the attraction of this villain to audiences and focuses on how beguiling, even funny, he can be. Siemon adds key historical context.

9781903436899 /PB \$17
9781903436882 /HC \$100
456 pages

NEW IN 2010

DOUBLE FALSEHOOD

May

**Pre-Pub Exam Copies
available at our booth!**

Brean Hammond, Editor

9781903436776 /PB \$17
9781903436769 /HC \$100

THE TAMING OF THE SHREW

June

Barbara Hodgdon, Editor
9781903436963 /PB \$17
9781903436929 /HC \$100

THE WINTER'S TALE

Aug

John Pitcher, Editor
9781903436356 /PB \$17
9781903436349 /HC \$100

ARDEN EARLY MODERN DRAMA

Includes the plays of non-Shakespearean dramatists of the period and is formatted like the Arden Shakespeare offering the same depth of information and scholarship.

THE DUCHESS OF MALFI

Leah Marcus, Editor
9781904271512 /PB
\$17
9781408119488 /HC
\$100

EVERYMAN AND MANKIND

Eric Rasmussen, Douglas
Bruster, Editors
9781904271628 /PB \$18
9781408119464 /HC \$100

PHILASTER

Suzanne Gossett,
Editor
9781904271734 /PB
\$20
9781408119471 /HC
\$100

THE RENEGADO

May

Michael Neill, Editor
9781904271611/ PB
\$19.95
9781408125182 /HC
\$100

THE ARDEN SHAKESPEARE & methuen drama

now published by BLOOMSBURY ACADEMIC & PROFESSIONAL

BLOOMSBURYACADEMICUSA.COM

DISTRIBUTED BY MACMILLAN. To order contact your local bookseller or order from us directly at: 888-330-8477
* while supplies last.

Kristen Kayem Polster, Southern Methodist University
Gabriela Ponce, Southern Illinois University
Adrian Douglas Poole, University of Cambridge
Rachel E. Poulsen, Edgewood College
Richard Preiss, University of Utah
Paul Prescott, University of Warwick
Kendrick W. Prewitt, University of the Ozarks
Samuel B. Prime, Northwestern University
Kathryn Prince, University of Ottawa
John Ray Proctor III, University of Wisconsin
George Richard Proudfoot, King's College London
Diane Purkiss, Keble College, Oxford University

Kevin Arthur Quarmby, Globe Education

Phyllis Rackin, University of Pennsylvania
Jennifer Rahm, Folger Shakespeare Library
Mark Rankin, James Madison University
Sarah D. Rasher, University of Connecticut, Storrs
Eric Rasmussen, University of Nevada
Mireille Ravassat, University of Valenciennes
Adrienne A. Redding, Western Michigan University
Lindsay Ann Reid, University of Toronto
Julia Anne Reidhead, W.W. Norton & Company
Cody Reis, New York University
Douglas Larue Reside, University of Maryland
Lawrence F. Rhu, University of South Carolina
Stacy L. Rice, Northern Virginia Community College
Jane Rickard, University of Leeds
Gabriel A. Rieger, Concord University
Anna Riehl, Auburn University
Julia Rigby, Chicago, Illinois
Elizabeth J. Rivlin, Clemson University
Karen Robertson, Vassar College
Joanne Rochester, University of Saskatchewan
Edward L. Rocklin, California State Polytechnic University, Pomona
Amy J. Rodgers, University of Michigan
Joel T.N. Rodgers, University of Toronto
Katherine M. Romack, University of West Florida
Sally Romotsky, California State University, Fullerton
Clifford Ronan, Texas State University
Mary Beth Rose, University of Illinois, Chicago
Claudia Ross, Wayne State University
Brenda Rossini, Winnetka, Illinois
Nathaniel Amos Rothschild, Boston University
Katherine Rowe, Bryn Mawr College
Suparna Roychoudhury, Harvard University
Francesca T. Royster, DePaul University
Marjorie Rubright, University of Toronto
Jeffrey A. Rufo, Trinity University
David Ruter, University of Texas, El Paso
Craig M. Rustici, Hofstra University
Carol Chillington Rutter, University of Warwick
Bradley D. Ryner, Arizona State University

Michael B. Saenger, Southwestern University
Carolyn Sale, University of Alberta
Rhonda Lemke Sanford, Fairmont State University
Kathryn Vomer Santos, New York University
Debapriya Sarkar, Rutgers University
Robert Sawyer, East Tennessee State University
Joan Saxton, Sausalito, California
David Schalkwyk, Folger Shakespeare Library
Katherine West Scheil, University of Minnesota
Julia E. Schleck, University of Nebraska

June Schlueter, Lafayette College
Richard Schoch, Queen Mary, University of London
Sara D. Schotland, United States Naval Academy
Kurt A. Schreyer, University of Missouri, St. Louis
Anne-Marie E. Schuler, Ohio State University
Tara Kristen Schupner, American University
Kathryn Schwarz, Vanderbilt University
Amy Scott, McGill University
Sarah K. Scott, Mount St. Mary's University
William O. Scott, University of Kansas
Amy Scott-Douglass, Georgetown University, University of Maryland
Barbara Sebek, Colorado State University
Adele Seeff, University of Maryland
Courtney L. Self, Southern Illinois University, Carbondale
Gregory M. Semenza, University of Connecticut, Storrs
Amrita Sen, Michigan State University
Paula L. Senkowski, Poynette, Wisconsin
Dimitry Alexander Senyshyn, University of Toronto
Gitanjali Shahani, San Francisco State University
Laurie Shannon, Northwestern University
Will Sharpe, University of Warwick
Robert Shaughnessy, University of Kent
Amanda B. Shaw, University of Notre Dame
Michael Shea, Southern Connecticut State University
Adam Sheaffer, Eastern Michigan University
Philippa Mary Sheppard, University of Toronto
Anita Gilman Sherman, American University
Christopher Shirley, Northwestern University
Lauren Shohet, Villanova University
Emily Shortstef, Columbia University
Katherine Irene Shrieves, University of North Carolina
James R. Siemon, Boston University
Andrea Silva, Wayne State University
Marilyn D. Simon, Toronto, Ontario
Matthew L. Simpson, University of Connecticut
Nancy L. Simpson, University of Wisconsin
Jyotsna G. Singh, Michigan State University
Katie Sue Sisneros, University of Nebraska
Jay Paul Skelton, University of Notre Dame
Meredith Anne Skura, Rice University
Joel Elliot Slotkin, Towson University
Monika Smialkowska, Northumbria University
Amy L. Smith, Kalamazoo College
Bruce R. Smith, University of Southern California
Charlene V. Smith, Silver Spring, Maryland
Ian Smith, Lafayette College
Kim Solga, University of Western Ontario
Geraldo de Sousa, University of Kansas
Eric V. Spencer, College of Idaho
Kelly J. Stage, Ripon College
John Staines, John Jay College, CUNY
Audrey E. Stanley, University of California, Santa Cruz
Kay Stanton, California State University, Fullerton
Sarah Stanton, Cambridge University Press
Kristiane R. Stapleton, University of Wisconsin
Michael L. Stapleton, Indiana University-Purdue University, Fort Wayne
Lisa S. Starks-Estes, University of South Florida, St. Petersburg
Kirilka Stavreva, Cornell College
Jeffrey C. Steele, Principia College
Paul Dustin Stegner, California Polytechnic State University
Mary K. Steible, Southern Illinois University, Edwardsville

Suzanne Stein, University of South Florida
Annette Stenning, Simon Fraser University
Tiffany Stern, Oxford University
Andrea R. Stevens, University of Illinois, Urbana-
Champaign
Alan Stewart, Columbia University
Kent D. Stewart, Gurnee, Illinois
Sarah Louise Stewart, University of Nevada, Reno
William H. Stockton, Ball State University
James W. Stone, National University of Singapore
Marta Straznicky, Queen's University
Adrian G. T. Streete, Queen's University, Belfast
Richard Strier, University of Chicago
Elizabeth M. Sturgeon, Mount St. Mary's College
Erin Marie Sullivan, University College London
Joseph Michael Sullivan, Marietta College
David Summers, Capital University
Alicia Sutliff-Benusis, University of Kansas
Joyce Sutphen, Gustavus Adolphus College
John Sutton, Macquarie University
Mihoko Suzuki, University of Miami
David W. Swain, Southern New Hampshire University
Holger Schott Syme, University of Toronto

Maura M. Tarnoff, Saint Louis University, Madrid
Gary L. Taylor, Florida State University
Jeffrey S. Theis, Salem State College
Matthew Thiele, Auburn University
Catherine E. Thomas, College of Charleston
Chad Allen Thomas, University of Michigan
Ann Thompson, King's College London
Ayanna Thompson, Arizona State University
Sara E. Thompson, Shakespeare Institute
Leslie Thomson, University of Toronto
Beverly A. Thornton, Cuyahoga Community College
Grace C. Tiffany, Western Michigan University
John J. M. Tobin, University of Massachusetts, Boston
Alicia V. Tomasian, William Rainey Harper College
Jacob A. Tootalian, University of Wisconsin
Robert Topinka, University of Kansas
Jeanette Nguyen Tran, University of Wisconsin
Valerie Traub, University of Michigan
Evelyn B. Tribble, University of Otago
Andrea Trocha-Van Nort, United States Air Force
Academy

Jesus Tronch Perez, Universitat de Valencia
Scott A. Trudell, Rutgers University
Andrew Tuminia, Marymount Manhattan College
Darren V. Tunstall, University of Central Lancashire
Henry S. Turner, Rutgers University
Rikita Tyson, Harvard University

Michael Ulyot, University of Calgary
Deborah Uman, St. John Fisher College
Steven Urkowitz, University of Perpignan
Michael G. Ursell, University of California, Santa Cruz
Kirsten Uszkalo, University of Illinois, Urbana-
Champaign

Martine Van Elk, California State University, Long Beach
Virginia Mason Vaughan, Clark University
Jennifer C. Vaught, University of Louisiana, Lafayette
Eric D. Vivier, University of Wisconsin

Jennifer Waldron, University of Pittsburgh
Denise A. Walen, Vassar College

Jonathan A. Walker, Portland State University
Lewis Walker, University of North Carolina,
Wilmington
Bronwyn V. Wallace, University of Pennsylvania
Gary Waller, SUNY, Purchase College
Brian Walsh, Yale University
Melissa E. Walter, University of the Fraser Valley
Michael Warren, University of California, Santa Cruz
Edward T. Washington, Mansfield University
Yolana Wassersug, Shakespeare Institute
Robert N. Watson, University of California, Los
Angeles
Valerie Wayne, University of Hawai'i
William Weaver, Baylor University
Catherine Weidner, DePaul University
Herb Weil, University of Manitoba
Judith Weil, University of Manitoba
Don Weingust, Southern Oregon University
Lawrence N. Weiss, New York, New York
James Wells, Belmont University
Sarah Werner, Folger Shakespeare Library
Paul Werstine, University of Western Ontario
Kimberly R. West, Sewanee School of Letters
William N. West, Northwestern University
Frank Whigham, University of Texas
D. Jerry White, University of Central Missouri
Kendra Whitmire, Shakespeare Institute
Charles Whitney, University of Nevada
Kathryn K. Will, University of Michigan
Claude Willan, Stanford University
Deanne Williams, York University
Edwin S. Williams, Ohio State University
Katherine Williams, Rutgers University
Travis D. Williams, University of Rhode Island
William Proctor Williams, University of Akron
Jane Williamson, University of Missouri, St. Louis
Laura Williamson Ambrose, Saint Mary's College
Deborah Willis, University of California, Riverside
Emma Annette Wilson, University of Western Ontario
Luke Wilson, Ohio State University
Sarah Wingo, Shakespeare Institute
Rebecca Wiseman, University of Michigan
Michael Witmore, University of Wisconsin
Susanne L. Wofford, New York University
Celestine Woo, SUNY, Empire State College
David H. Wood, Northern Michigan University
Linda Woodbridge, Pennsylvania State University
Penelope S. Woods, Queen Mary's, University of
London
Marshelle Woodward, University of Wisconsin
Ramona Wray, Queen's University
George T. Wright, University of Minnesota
Paul Yachnin, McGill University
Alan R. Young, Acadia University
Bruce Young, Brigham Young University
Jennifer M. Young, King's College, London
Robert G. Young, Folger Shakespeare Library

Timothy W. Zajac, University of Massachusetts,
Amherst
Nikolay Zakharov, Moscow University for Humanities
Matthew Zarnowiecki, Auburn University
Blaire Zeiders, University of Wisconsin
John Ziegler, Fordham University
Rachel L. Zlatkin, University of Cincinnati
Adam Zucker, University of Massachusetts, Amherst

ACTORS FROM THE LONDON STAGE

Five Days. Five Actors. One Unforgettable Experience.



Discover how Shakespeare's texts become scripts, scripts become actions, and actions become meaning.

Explore Shakespeare through a dynamic five-day residency of workshops and performances brought to life by five of London's finest professional actors.

Visit us in the exhibit hall to find out how you can bring **Actors From The London Stage** to your campus.



NOW BOOKING
2010–2012

UPCOMING AFTLS TOURS

- A Midsummer Night's Dream* • Fall 2010 (Sept–Nov)
- As You Like It* • Spring 2011 (Jan–March)
- The Tempest* • Fall 2011 (Sept–Nov)
- Twelfth Night* • Spring 2012 (Jan–March)

574.631.3777 • aftls@nd.edu • nd.edu/~aftls

 SHAKESPEARE
AT NOTRE DAME

NOTRE DAME SHAKESPEARE FESTIVAL

World-Class Theatre. Right Next Door.



FOLLOW: [shakespeareatnd](#) on   

EXPLORE: [shakespeare.nd.edu](#)

Shakespeare *and* the Middle Ages

a two-day conference

25 June 2010

University of Notre Dame,
London Centre

26 June 2010

Shakespeare's Globe,
Bankside

Supported by:

University of Notre Dame • University of Cambridge
Université Paris-Diderot • Shakespeare's Globe

[shakespeare.nd.edu/conference](#)

WAYNE STATE UNIVERSITY



EARLY MODERN STUDIES

Detroit, where we never stop talking about the Renaissance.



Our Early Modern Faculty Includes:

Eric Ash (History)
Simone Chess (English)
Anne Duggan (French)
Margaret Franklin (Art History)
Michael Giordano (French)
Jaime Goodrich (English)
Ken Jackson (English)
Christiane Joost Gaugier (Art History)
Leisa Kauffman (Spanish)
Arthur Marotti (English)
Lisa Maruca (English)
Jose Antonio Rico-Ferrer (Spanish)

for more information, visit us on the web at

wayne.edu

or email us at ai4054@wayne.edu



Renaissance Literature from Chicago



The Improbability of Othello

*Rhetorical Anthropology and
Shakespearean Selfhood*

JOEL B. ALTMAN

Cloth \$49.00

Blood Relations

*Christian and Jew in
The Merchant of Venice*

JANET ADELMAN

Cloth \$35.00

Memory's Library

*Medieval Books in Early
Modern England*

JENNIFER SUMMIT

Cloth \$35.00

The Key of Green

*Passion and Perception in
Renaissance Culture*

BRUCE R. SMITH

Cloth \$39.00

Tudor Autobiography

Listening for Inwardness

MEREDITH ANNE SKURA

Cloth \$45.00

Shakespeare Only

JEFFREY KNAPP

Cloth \$35.00

Plague Writing in Early Modern England

ERNEST B. GILMAN

Cloth \$35.00

Now in Paperback

This Wide and Universal Theater

*Shakespeare in Performance,
Then and Now*

DAVID BEVINGTON

Paper \$16.00

The Selected Poems of Fulke Greville

FULKE GREVILLE

*Edited with an Introduction by Thom Gunn
With a New Afterword by Bradin Cormack*

Paper \$20.00

Visit the Scholar's Choice
display for a 20% discount on
these and related titles.





WELCOME TO CHICAGO!

LOYOLA UNIVERSITY CHICAGO DEPARTMENT OF ENGLISH

The Graduate School, the College of Arts and Sciences, and the Department of English are proud to sponsor the Shakespeare Association of America annual conference.

To learn more about our BA, MA, and PhD programs, visit **LUC.edu/english**.



Preparing people to lead extraordinary lives



LOYOLA UNIVERSITY CHICAGO
CENTER FOR TEXTUAL STUDIES AND
DIGITAL HUMANITIES

Loyola University Chicago's Center for Textual Studies and Digital Humanities (CTSDH) supports research across the humanities as well as research in computer science, communication, the social sciences, law, and libraries.

Learn more at ctsdh.luc.edu.



Preparing people to lead extraordinary lives



Northwestern University

The Weinberg College of Arts and Sciences and the Early Modern Colloquium at Northwestern University

are proud to sponsor the 2010 meeting of

The Shakespeare Association of America

Northwestern's Early Modern Colloquium hosts a series of interdisciplinary conversations on scholarly work by faculty and doctoral students working from a variety of academic disciplines and departments. The doctoral program in the English Department offers full coverage in sixteenth- and seventeenth-century literature and culture, with particular strengths in drama and poetry, the comparative and classical Renaissance, gender and sexuality, history of the book, history of ideas, religion, Shakespeare, Spenser, and Milton, and writing by early modern women. Northwestern's Renaissance faculty include:

Kasey Evans
Jeffrey Masten
Martin Mueller
Susan Phillips
Regina Schwartz
Laurie Shannon
Wendy Wall
William N. West

www.english.northwestern.edu

Printing

Typographia

MEDIEVAL & EARLY MODERN STUDIES

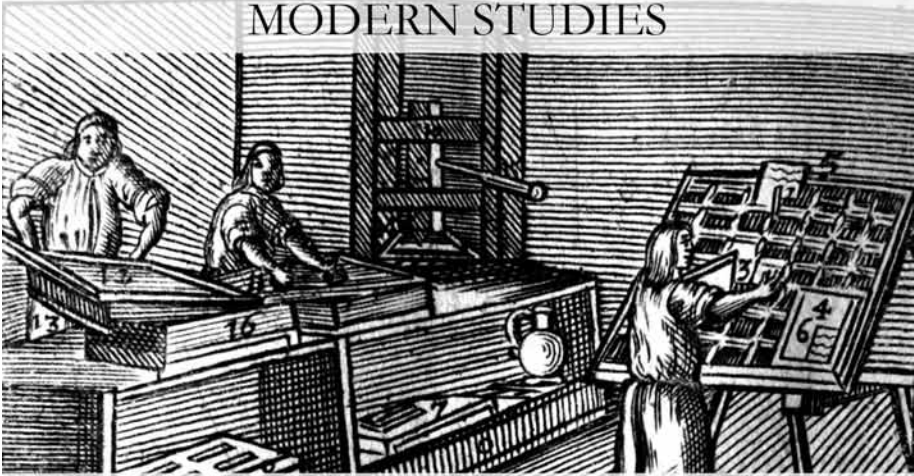

AT THE UNIVERSITY OF ILLINOIS AT URBANA-CHAMPAIGN

- World Class Library with an Excellent Rare Book Room
- Seven Years of Funding: Combination of Fellowships, Teaching, Mentoring, Research and Administrative Assistantships, Writer's Workshop Tutoring
- Exceptional Tenure-Track Placement Record in Medieval and Early Modern Studies

Rewarding Interdisciplinary Opportunities

(including certificate programs, reading groups, and opportunities for course work, teaching, and fellowships)

- Program in Medieval Studies
- Early Modernist Faculty in History, Theater, French, Italian, German, and Spanish
- Unit for Criticism and Interpretive Theory
- Illinois Program for Research in the Humanities
- Gender and Women's Studies
- Latina/o Studies
- Program in Jewish Culture and Society

Excellent and Diverse Faculty

Medieval: Robert W. Barrett, Jr., Martin Camargo, Renée R. Trilling, Charles D. Wright

16th and 17th Century: Catharine Gray, Feisal Mohamed, Lori Humphrey Newcomb, Curtis Perry, Andrea Stevens

Restoration and 18th Century: Robert Markley, Hina Nazar, Anthony Pollock.



**THE EARLY MODERN FACULTY
OF THE UNIVERSITY OF MICHIGAN**

**CONGRATULATE AND THANK
OUR CHICAGO AREA HOSTS
ON THE 2010**

**SHAKESPEARE ASSOCIATION OF AMERICA
CONVENTION**

LINDA GREGERSON
BARBARA HODGDON

WILLIAM INGRAM

JEFFREY KNIGHT

JOHN KNOTT

STEVEN MULLANEY

SUSAN SCOTT PARRISH

MICHAEL SCHOENFELDT

SEAN SILVER

VALERIE TRAUB

DOUG TREVOR

RALPH WILLIAMS

GRADUATE STUDENT-RUN

EARLY MODERN COLLOQUIUM INTEREST GROUP

<http://www.umich.edu/~earlymod/>

INTERDISCIPLINARY GRADUATE CERTIFICATE IN

MEDIEVAL AND EARLY MODERN STUDIES

<http://www.lsa.umich.edu/mems/>

RESIDENCY OF THE ROYAL SHAKESPEARE COMPANY

<http://www.lsa.umich.edu/english/>

M UNIVERSITY OF MICHIGAN



Learn
in the city.
Lead
in the world.

Undergraduate & Graduate Programs | www.neiu.edu

Northeastern Illinois University
is proud to support the 2010 meeting of the
Shakespeare Association of America in Chicago

 **Northeastern
Illinois
University**
5500 NORTH ST. LOUIS AVENUE
CHICAGO, ILLINOIS 60625-4699

The Medieval and Early Modern Studies faculty
and the Department of English Literature of the

UNIVERSITY OF WISCONSIN-MADISON

are proud to sponsor the annual meeting of

The Shakespeare Association of America

<http://www.english.wisc.edu/>



THE MASTER'S PROGRAM IN ENGLISH AT GEORGETOWN UNIVERSITY



We are unique among stand-alone MA programs in supporting a full third of our students with tuition waivers and generous stipends, providing professional development activities in teaching writing and working with new media, and offering access to the Folger Shakespeare Library, the Library of Congress, the Smithsonian Institution, and the National Archives.

For more information consult our website:
<http://english.georgetown.edu/programs/graduate>



Wrinkled Deep in Time

Aging in Shakespeare

Maurice Charney

From *Romeo and Juliet* to *The Tempest*, a fascinating look at aging in Shakespeare.

978-0-231-14230-4 - cloth - \$29.50



Chinese Shakespeares

Two Centuries of Cultural Exchange

Alexander C. Y. Huang

The first book to concentrate on both Shakespearean performance and Shakespeare's appearance in Sinophone culture

978-0-231-14849-8 - paper - \$26.50 / 978-0-231-14848-1 - cloth - \$84.50 - Global Chinese Culture

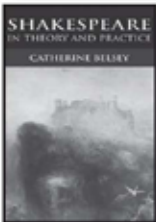

Shakespeare in Theory and Practice

Catherine Belsey

Through theory, world-renowned critic Catherine Belsey registers

Shakespeare's powers of seduction together with his moment in history.

978-0-7486-3301-2 - cloth - \$95.00

C O L U M B I A

Read book excerpts at www.cup.columbia.edu

*Important Titles in Shakespeare Studies:***The New Cambridge Companion
to Shakespeare**EDITED BY
**MARGRETA DE GRAZIA
AND STANLEY WELLS**2nd
Edition!*Cambridge Companions to Literature*\$90.00; Hb: 978-0-521-88632-1; 376 pp.
\$28.99; Pb: 978-0-521-71393-1**The Cambridge Companion
to Shakespeare's Last Plays**EDITED BY **CATHERINE M. S. ALEXANDER***Cambridge Companions to Literature*\$90.00; Hb: 978-0-521-88178-4; 244 pp.
\$29.99; Pb: 978-0-521-70819-7**Shakespeare's Globe
A Theatrical Experiment**EDITED BY **CHRISTIE CARSON
AND FARAH KARIM-COOPER**\$81.00; Hb: 978-0-521-87778-7; 304 pp.
\$24.99; Pb: 978-0-521-70166-2**Shakespeare
in Stages**

New Theatre Histories

EDITED BY
**CHRISTINE DYMKOWSKI
AND CHRISTIE CARSON**
\$95.00; Hb: 978-0-521-88479-2;
336 pp.**The Shakespearean Stage
1574-1642**

ANDREW GURR

\$81.00; Hb: 978-0-521-50981-7; 358 pp.
\$29.99; Pb: 978-0-521-72966-64th
Edition!**Shakespeare's Individualism**

PETER HOLBROOK

\$95.00; Hb: 978-0-521-76067-6; 256 pp.

**Shakespeare, the Queen's Men, and
the Elizabethan Performance of History**

BRIAN WALSH

\$95.00; Hb: 978-0-521-76692-0; 246 pp.

**Shakespeare in Asia
Contemporary Performance**EDITED BY **DENNIS KENNEDY
AND YONG LI LAN**\$95.00; Hb: 978-0-521-51552-8;
304 pp.**Shakespeare and Early
Modern Political Thought**EDITED BY **DAVID ARMITAGE,
CONAL CONDREN, AND ANDREW FITZMAURICE**

\$95.00; Hb: 978-0-521-76808-5; 302 pp.

Shakespeare and the Modern Poet

NEIL CORCORAN

\$85.00; Hb: 978-0-521-19982-7; 264 pp.

Shakespearean Verse Speaking

Text and Theatre Practice

ABIGAIL ROKISON

\$95.00; Hb: 978-0-521-76434-6; 248 pp.

**The Illustrated Shakespeare,
1709-1875**

STUART SILLARS

\$108.00; Hb: 978-0-521-87837-1; 416 pp.

Prices subject to change.



THE SHAKESPEARE
ASSOCIATION
OF AMERICA

Department of English
Georgetown University
37th and O Streets, N.W.
Washington, D.C. 20057-1131

PHONE: 202.687.6315

FAX: 202.687.5445

E-MAIL: shakespeare@georgetown.edu

WEB: www.ShakespeareAssociation.org

Shakespeare