



SHAKESPEARE
ASSOCIATION
OF AMERICA

PROGRAM OF THE
39TH ANNUAL MEETING

7-9 APRIL 2011

THE HYATT REGENCY
BELLEVUE, WASHINGTON

shakespeare

The 39th Annual Meeting of the Shakespeare Association of America

Executive Director

LENA COWEN ORLIN
Georgetown University

Memberships Manager

DONNA EVEN-KESEF
Georgetown University

Publications Manager

BAILEY YEAGER
Georgetown University

President

RUSS McDONALD
Goldsmiths College, University of London

Vice-President

SUZANNE GOSSETT
Loyola University Chicago

Immediate Past President

PAUL YACHNIN
McGill University

Trustees

REBECCA BUSHNELL
University of Pennsylvania

HEATHER JAMES
University of Southern California

DOUGLAS M. LANIER
University of New Hampshire

LYNNE MAGNUSSON
University of Toronto

ERIC RASMUSSEN
University of Nevada

JAMES R. SIEMON
Boston University

Program Planning Committee

HEATHER JAMES, Chair
University of Southern California

MICHAEL DOBSON
Birkbeck College, University of London

HEIDI BRAYMAN HACKEL
University of California, Riverside

VALERIE WAYNE
University of Hawai'i

ADAM ZUCKER
University of Massachusetts

Local Arrangements

MICHAEL SHURGOT
South Puget Sound Community College

Sponsors of the 39th Annual Meeting

THE VANDOLSEN TRUST

THE UNIVERSITY OF WASHINGTON

THE UNIVERSITY OF OREGON

THE UNIVERSITY OF BRITISH COLUMBIA

THE OREGON SHAKESPEARE FESTIVAL

VANCOUVER ISLAND UNIVERSITY

WESTERN WASHINGTON UNIVERSITY

THE UNIVERSITY OF BRITISH COLUMBIA AT
OKANAGAN

THE UNIVERSITY OF PUGET SOUND

REED COLLEGE

SIMON FRASER UNIVERSITY

THE UNIVERSITY OF VICTORIA

AND

GEORGETOWN UNIVERSITY

2011 Program Guide

Thursday, 7 April

10:00 a.m.	Registration in Evergreen Foyer	7
12:00 noon	Book Exhibits in Evergreen Ballroom	7
1:30 p.m.	Presentation in Grand Ballroom: Actors as Shakespeare Critics	7
	Presentation in Regency Ballroom: Shakespeare and Ethical Skepticism	7
3:30 p.m.	Seminar in Cedar Ballroom B: The Book on Stage	7
	Seminar in Evergreen Ballroom C: Figures of Speech	7
	Seminar in Grand Ballroom G: Green Scenes in Shakespeare	8
	Seminar in Grand Ballroom K: Intertextuality, Audiences, and Memory	8
	Seminar in Evergreen Ballroom B: Lacunae in Theater History, Part One	8
	Seminar in Grand Ballroom I: Liberty and Bondage on the Early Modern Stage	8
	Seminar in Cedar Ballroom A: Mary Wroth and Shakespeare	9
	Seminar in Evergreen Ballroom I: (Re)Imagining Europe through Shakespeare	9
	Seminar in Maple Room: Shakespeare and Early Modern Pauline Discourses	9
	Seminar in Evergreen Ballroom A: Shakespeare and Political Theology	9
	Seminar in Juniper Room: Shakespeare and the Actress	9
	Seminar in Grand Ballroom F: Shakespeare and the New Feminisms	9
	Seminar in Larch Room: Shakespeare and the Question of Theory	10
	Seminar in Evergreen Ballroom G: Shakespeare and the Rejection of Sexuality	10
	Seminar in Evergreen Ballroom H: Staging Torture, Staging the World	10
	Workshop in Grand Ballroom E: Getting Published	10
	Workshop in Grand Ballroom J: Hear Here: Shakespeare's Sound and Collective Listening	11
6:00 p.m.	Opening Reception at the Westin Bellevue	11
8:00 p.m.	Performance in Grand Ballroom: <i>Bond</i> by Taiwan <i>Bangzi</i> Opera	11
10:00 p.m.	Post-Performance Discussion in Grand Ballroom	11

Friday, 8 April

7:30 a.m.	Meeting in Laurel Room: Editorial Board of <i>Shakespeare Studies</i>	12
8:00 a.m.	Registration in Evergreen Foyer	12
	Book Exhibits in Evergreen Ballroom	12
	Trustees' Breakfast for Graduate Students in Cedar Ballroom	12
9:00 a.m.	Plenary Presentation in Grand Ballroom: The Stories Texts Tell	12
10:30 a.m.	Coffee Break in Grand Foyer	12
11:00 a.m.	Presentation in Regency Ballroom: Depicting the Subject in Early Modern Drama	12
	Presentation in Grand Ballroom: Memorializing Shakespeare	12
1:00 p.m.	Annual Luncheon in Grand Ballroom	13
3:30 p.m.	Film Screening in Auditorium: <i>Prince of the Himalayas</i>	13
	Seminar in Cedar Ballroom A: The Character of Reported Speech in Shakespeare	13
	Seminar in Grand Ballroom K: Delinquent Shakespeare	13
	Seminar in Larch Room: Diet and Identity in Shakespeare's England	13
	Seminar in Grand Ballroom J: Drama and/of the Reformation	14
	Seminar in Maple Room: Gender and Song in Early Modern England	14
	Seminar in Grand Ballroom I: <i>Henry IV, Part Two</i>	14
	Seminar in Cottonwood Room: Jests in Early Modern Culture	14
	Seminar in Evergreen Ballroom B: Lacunae in Theater History, Part Two	15
	Seminar in Evergreen Ballroom A: <i>Macbeth</i> : The State of Play, Part One	15
	Seminar in Juniper Room: The Politics of Female Alliance	15

	Seminar in Evergreen Ballroom I: Prosthetics and Performance	15
	Seminar in Regency Ballroom EF: Shakespeare and Classicism: Redux	16
	Seminar in Laurel Room: Stratford	16
	Seminar in Regency Ballroom B: The “Ungodly” in Shakespeare’s England	16
	Seminar in Regency Ballroom A: Violent Masculinities	16
	Seminar in Evergreen Ballroom H: <i>The Winter’s Tale</i>	16
	Workshop in Evergreen Ballroom G: The Shakespeare Quartos Archive	17
	Workshop in Evergreen Ballroom C: Teaching Our Other Shakespeare (Middleton)	17
5:30 p.m.	ELR Anniversary Party in Grand Ballroom	17
6:00 p.m.	Meeting in Juniper Room: Editorial Board of <i>Shakespeare Quarterly</i>	17
8:00 p.m.	Performance in Grand Ballroom: Traditional Skits by Taiwan <i>Bangzi</i> Opera	17

Saturday, 9 April

7:30 a.m.	Meeting in Juniper Room: Editorial Board of the Internet Shakespeare	18
8:00 a.m.	Information in Evergreen Foyer	18
	Book Exhibits in Evergreen Ballroom	18
9:00 a.m.	Presentation in Grand Ballroom: Editing Shakespeare	18
	Presentation in Regency Ballroom: Experimental Shakespeare in Theory and Practice	18
	Workshop for Teachers in Cedar Ballroom: From Script to Performance	18
10:30 a.m.	Coffee Break in Grand and Regency Foyers	18
11:00 a.m.	Presentation in Grand Ballroom: Black Studies in the English Renaissance	18
	Presentation in Regency Ballroom: Decoding Playwrights’ Options and Choices	19
2:00 p.m.	Presentation in Grand Ballroom: Beyond Playbooks	19
	Presentation in Regency Ballroom: Marlowe’s Vitality	19
4:00 p.m.	Film Screening in Auditorium: <i>Prince of the Himalayas</i>	19
	Seminar in Grand Ballroom E: Cosmopolitans and Barbarians	19
	Seminar in Evergreen Ballroom B: Early Modern Women and the Discourse of Death	20
	Seminar in Grand Ballroom G: Hot Protestant Shakespeare	20
	Seminar in Larch Room: Likeness in Shakespeare’s England	20
	Seminar in Evergreen Ballroom A: <i>Macbeth</i> : The State of Play, Part Two	20
	Seminar in Evergreen Ballroom H: Memory Culture in Shakespeare	21
	Seminar in Grand Ballroom C: Queer Theory Now	21
	Seminar in Grand Ballroom A: Redefining Theatrical Culture: The Theater of the Streets	21
	Seminar in Evergreen Ballroom I: Sanctity	21
	Seminar in Juniper Room: Shakespeare and Opera	21
	Seminar in Regency Ballroom EF: Shakespeare and Renaissance Ideas of a Life	22
	Seminar in Grand Ballroom F: Shakespeare and Science	22
	Seminar in Maple Room: Shakespeare for Sale	22
	Seminar in Grand Ballroom B: Shakespeare’s Poetry	22
	Seminar in Evergreen Ballroom C: Silenced Shakespeare Films	23
	Workshop in Cedar Ballroom: Performing Shakespeare for Popular Audiences	23
	Workshop in Evergreen Ballroom G: Shakespearean Fetish	23
6:15 p.m.	Recital in Auditorium: <i>Ophelia, from Song to Stage</i>	23
10:00 p.m.	The SAA/Malone Society Dance in Grand Ballroom	23

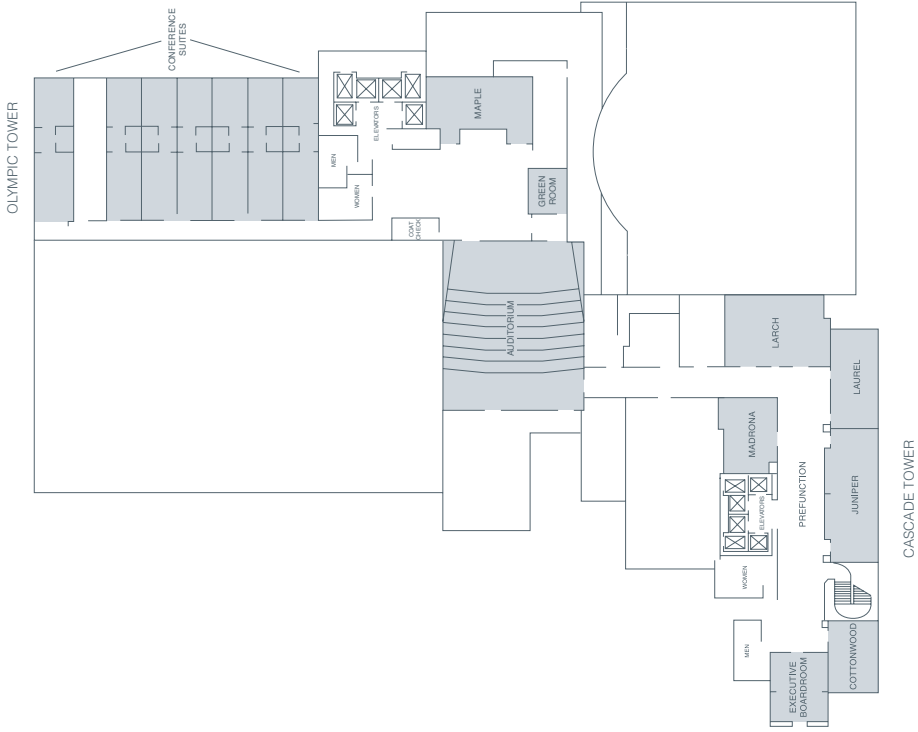

THIRD FLOOR

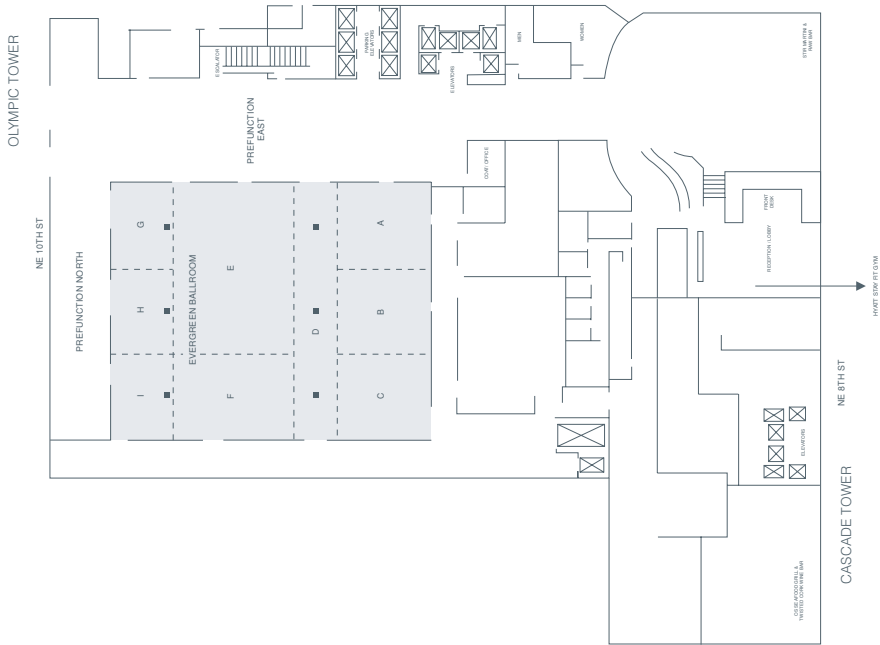

LOBBY LEVEL

HYATT REGENCY BELLEVUE HOTEL

OLYMPIC TOWER

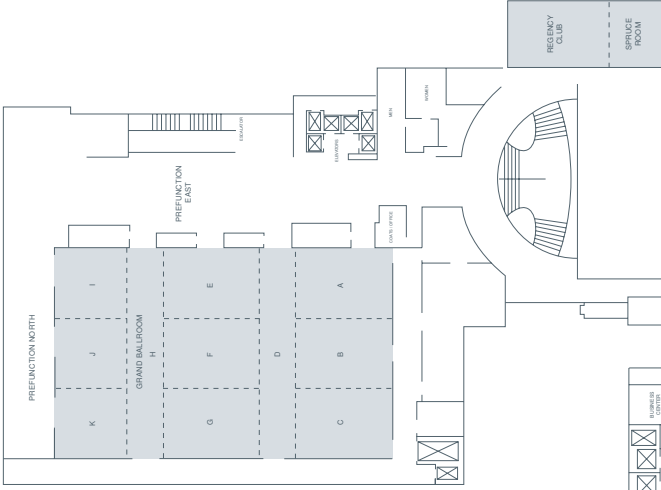

CASCADE TOWER

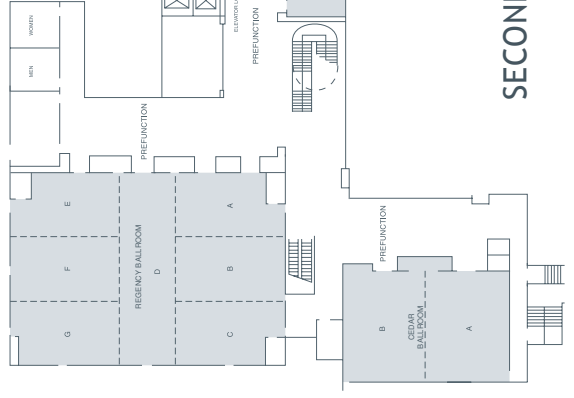

SECOND FLOOR

Shuttle Service to Seattle

Free shuttles to Seattle operate on Friday and Saturday nights. All seats are on a space-available basis only and must be booked in advance. Tickets are distributed at the conference registration table in the Evergreen Foyer of the Hyatt Regency.

Friday: Buses depart Bellevue on the half hour, beginning at 5:30 p.m. and ending at 9:30 p.m. Buses return from Seattle on the half-hour, with the last bus at 10:00 p.m.

Saturday: Buses depart Bellevue on the half hour, beginning at 6:30 p.m. and ending at 10:30 p.m. Buses return from Seattle on the half-hour, with the last bus at 11:00 p.m.

All buses depart from the hotel's NE 10th Street entrance, at the north end of the Evergreen Foyer. Drop-off in Seattle is on Union Street between 6th and 7th Avenues. Drivers have walking maps of Seattle.

Anyone who misses a return bus is welcome to try another, although substitutions cannot be guaranteed. It is also possible to return by cab; Union Station is near the Seattle Sheraton, where taxis are readily available.

Local Attractions

Bellevue Shopping

A second-floor skybridge connects the Hyatt Regency to clusters of shops in Bellevue Place, Bellevue Square, and Lincoln Square. Nordstrom and Macy's are the anchors for other clothing and accessory stores, including Ann Taylor, Burberry, Clarks of England, Coach, Eileen Fisher, Hugo Boss, J. Crew, Lacoste, Michael Kors, and Talbots. Also available are Container Store, Crate and Barrel, Pottery Barn, and Williams Sonoma, as well as Montblanc.

A few blocks further afield, the Bravern features upscale shopping: Neiman Marcus, Brooks Brothers, Hermès, Jimmy Choo, Karen Millen, Kreiss, Louis Vuitton, Salvatore Ferragamo, Tory Burch, and more. Sur La Table and Silberman Brown Stationers are at the Bravern.

Bellevue Dining

Venues in the Hyatt include the Twisted Cork, open for breakfast, happy hour and cocktails (from 4:00 p.m. to 2:00 a.m.), and dinner (with late light meals); Needs Deli, open for lunch; and Tewada Gourmet Thai, open for lunch. A branch of the Seattle-based Tully's Coffee is located near the hotel entrance. Nearby restaurants and fast-food outlets include the Cheesecake Factory, Dai Tai Fung, Daniel's Broiler, Maggiano's Little Italy, McCormick & Schmick, Paddy Coyne's Irish Pub, Palomino, Pearl, Ruth's Chris Steak House, and Trophy Cupcakes.

Bellevue Health and Well-Being

The fitness club at the Hyatt, Stay Fit, is free to all hotel guests and accessible by key card. The nearby Westin has Truce Spa. At the Bravern are an Elizabeth Arden Red Door Spa and David Barton Gym.

Bellevue Entertainment

Also connected to the Hyatt by skybridge are the Lucky Strike Bowling Lanes, the Parlor Billiards and Spirits, and the Lincoln Square Cinemas. On Friday, the Parlor Live features karaoke; on Friday and Saturday, Felipe Esparaza performs from the Last Comic Standing tour.

Bellevue Museums

The Bellevue Arts Museum specializes in local arts and crafts. The Rosalie Whyel Museum has a collection of over 1,000 dolls.



THURSDAY, 7 APRIL

10:00 a.m. to 6:00 p.m.

Registration

Evergreen Foyer, Olympic Tower

12:00 noon to 6:00 p.m.

Book Exhibits

Evergreen Ballroom, Olympic Tower



1:30 to 3:00 p.m.

Presentation: Actors as Shakespeare Critics

Grand Ballroom, Olympic Tower

Session Organizer: RICHARD SCHOCH

Chair: MICHAEL SHURGOT, South Puget Sound Community College

GAIL MARSHALL, University of Leicester
Victorian Actresses as Shakespeare Critics

DENIS SALTER, McGill University
Terrorizing the Subject: Henry Irving's 1895 Address to Columbia College on *The Character of Macbeth*

RICHARD SCHOCH, Queen Mary, University of London
The Grimaldi Shakespeare

Presentation: Shakespeare and Ethical Skepticism

Regency Ballroom, Cascade Tower

Session Organizer: LARS ENGLE

Chair: KATHERINE EGGERT, University of Colorado

DOUGLAS TREVOR, University of Michigan
Skeptical Theology

DAVID B. GOLDSTEIN, York University
"Faithful Feeders": Eating and Skeptical Ethics in *As You Like It*

LARS ENGLE, University of Tulsa
Shame and Ethical Skepticism in *Antony and Cleopatra*

3:30 to 5:30 p.m.

Seminar: The Book on Stage

Cedar Ballroom B, Cascade Tower

Leader: CHARLOTTE SCOTT, Goldsmiths College, University of London

TODD LANDON BARNES, Ramapo College of New Jersey
DAVID M. BERGERON, University of Kansas
ELEANOR LOWE, Oxford Brookes University
JEANNE H. MCCARTHY, Oglethorpe University
JOSEPH M. ORTIZ, SUNY, Brockport
ELIZABETH M. STURGEON, Mount St. Mary's College
SARAH WALL-RANDELL, Wellesley College

Seminar: Figures of Speech

Evergreen Ballroom C, Olympic Tower

Leaders: LARA BOVILSKY, University of Oregon and AARON KUNIN, Pomona College

PAVNEET AULAKH, University of California, Santa Barbara

ROBERT BESHARE, University of North Carolina
TODD BORLIK, Bloomsburg University
KATHLEEN BOSSERT, Franklin & Marshall College
ASHLEY DENHAM BUSSE, George Washington University
SCOTT CRIDER, University of Dallas
STEPHEN MERRIAM FOLEY, Brown University
JUSTIN KOLB, University of Minnesota, Morris
JULIAN LAMB, Chinese University of Hong Kong
JENNY MANN, Cornell University

Thursday, 7 April

SIMON PALFREY, Brasenose College Oxford
STEPHANIE PIETROS, Fordham University
COLLEEN ROSENFELD, Pomona College
MATTHEW SMITH, University of Southern California
MICHAEL URSELL, University of California, Santa Cruz
JAMES WELLS, Muskingum University

Seminar: Green Scenes in Shakespeare

Grand Ballroom G, Olympic Tower

Leader: SHARON O'DAIR, University of Alabama

ROBIN E. BATES, Lynchburg College
KEITH M. BOTELHO, Kennesaw State University
DANIEL BRAYTON, Middlebury College
LYNNE BRUCKNER, Chatham University
PATRICK CRAPANZANO, St. John's University
LOWELL DUCKERT, George Washington University
DAVID HARTWIG, Rhodes State College
ERIN KATHERINE KELLY, Ohio State University
ANN MARTINEZ, University of Kansas
VIN NARDIZZI, University of British Columbia
MARY STEIBLE, Southern Illinois University, Edwardsville
JEFFREY THEIS, Salem State University
CHARLES WHITNEY, University of Nevada, Las Vegas

Seminar: Intertextuality, Audiences, and Memory

Grand Ballroom K, Olympic Tower

Leaders: ALLISON MACHLIS MEYER, Assumption College and LORI HUMPHREY NEWCOMB, University of Illinois, Urbana-Champaign

LISA BOLDING, University of Georgia
BRIAN CHALK, Manhattan College
BROOKE CONTI, SUNY, Brockport
CORA FOX, Arizona State University
REBECA HELFER, University of California, Irvine
PETER HOLLAND, University of Notre Dame
ANDRÁS KISÉRY, City College of New York, CUNY
SONYA LOFTIS, Morehouse College
RORY LOUGHNANE, Trinity College, Dublin
GAYWYN MOORE, University of Kansas
ANNE MYERS, University of Missouri
MEG F. PEARSON, University of West Georgia
JANET WRIGHT STARNER, Wilkes University
KATHRYN WILL, University of Michigan
RACHEL ZLATKIN, University of Cincinnati

Seminar: Lacunae in Theater History, Part One

Evergreen Ballroom B, Olympic Tower

Leader: LESLIE THOMSON, University of Toronto

DOUGLAS ARRELL, University of Winnepeg
RICHMOND BARBOUR, Oregon State University
ALAN C. DESSEN, University of North Carolina
W. L. GODSHALK, University of Cincinnati
NATHANIEL HODES, Brandeis University
KARA NORTHWAY, Kansas State University
ELISA OH, Howard University
J. GAVIN PAUL, University of British Columbia
JESÚS TRONCH PÉREZ, University of Valencia
EOIN PRICE, The Shakespeare Institute
KIRK QUINSLAND, Fordham University
MEREDITH SKURA, Rice University
EVELYN TRIBBLE, University of Otago

Seminar: Liberty and Bondage on the Early Modern Stage

Grand Ballroom I, Olympic Tower

Leaders: OLIVER ARNOLD, University of California, Berkeley and BERNADETTE A. MEYLER, Cornell University

ANDREW RAYMOND BOSSERT, Franklin & Marshall College
URVASHI CHAKRAVARTY, Vanderbilt University
BRINDA CHARRY, Keene State College
ANN C. CHRISTENSEN, University of Houston
ARI FRIEDLANDER, University of Michigan
BLAINE GRETEMAN, University of Iowa
ZSOLT MOHI, University of Kansas
JOEL RODGERS, University of Toronto
MELISSA E. SANCHEZ, University of Pennsylvania
RHONDA LEMKE SANFORD, Fairmont State University
ANNE-MARIE E. SCHULER, Ohio State University
ABRAHAM STOLL, University of San Diego
RICHARD STRIER, University of Chicago
SUSANNE L. WOFFORD, New York University

Seminar: Mary Wroth and Shakespeare

Cedar Ballroom A, Cascade Tower

Leaders: ILONA BELL, Williams College and
MARY ELLEN LAMB, Southern Illinois University

NANDINI DAS, University of Liverpool
LARA A. DODDS, Mississippi State University
KARI JENE DURGAN, University of California, Davis
LAURA H. FRIEDMAN, University of Virginia
GAYLE GASKILL, St. Catherine University
CYNDI MARIE HEADLEY, University of Arizona
PAUL J. HECHT, Purdue University North Central
FRANCES L. HELPHINSTINE, Morehead State University
CLARE R. KINNEY, University of Virginia
PENNY MCCARTHY, University of Glasgow
KRISTEN KAYEM POLSTER, University of North Texas
LEILA RUTH WATKINS, University of Michigan

Seminar: (Re)Imagining Europe through Shakespeare

Evergreen Ballroom I, Olympic Tower

Leader: SABINE SCHÜLTING, Freie Universität Berlin

AMBEREEN DADABHOY, Harvey Mudd College
DIANA E. HENDERSON, Massachusetts Institute of Technology
KEN R. JACOBSEN, Sir Wilfred Grenfell College, Memorial University
LEA PULJCAN JURIC, New York University
PETER KANELOS, Loyola University Chicago
SANDRA D. LINDBERG, Illinois Wesleyan University
HUGH MACRAE RICHMOND, University of California, Berkeley

Seminar: Shakespeare and Early Modern Pauline Discourses

Maple Room, Olympic Tower

Leader: RANDALL MARTIN, University of New Brunswick

TONY ANTONIADES, University of Toronto
JOSEPH JENKINS, University of California, Irvine
JAMES KUZNER, Case Western Reserve University
SEAN LAWRENCE, University of British Columbia, Okanagan
ELIZABETH MALSON-HUDDLE, University of Wisconsin
MARSHA S. ROBINSON, Kean University
JONATHAN SIRCY, University of South Carolina

Seminar: Shakespeare and Political Theology

Evergreen Ballroom A, Olympic Tower

Leaders: JENNIFER R. RUST, Saint Louis University and
NICHOLE E. MILLER, Temple University

JOSEPH CAMPANA, Rice University
JASON COHEN, Berea College
DOUG ESKEW, Colorado State University, Pueblo
GREGORY FORAN, Nazareth College of Rochester
GRAHAM HAMMILL, University of Buffalo, SUNY
ANDREAS HÖFELE, University of Munich
GARY KUCHAR, University of Victoria
JULIA REINHARD LUPTON, University of California, Irvine
MARTIN MORAW, Brandeis University
INEKE MURAKAMI, University at Albany, SUNY
KAREN SAUPE, Calvin College
JENNIFER TOMS, Michigan State University
JAYME YEO, Rice University

Seminar: Shakespeare and the Actress

Juniper Room, Cascade Tower

Leader: KATHRYN PRINCE, University of Ottawa

ANN BASSO, University of South Florida
TERRI BOURUS, Indiana University-Purdue University, Indianapolis
DONNA S. BREWER, Sewanee School of Letters
ANNE F. GOSSAGE, Eastern Kentucky University
KIM H. NOLING, Hartwick College
NANCY SELLECK, University of Massachusetts, Lowell
DENISE A. WALEN, Vassar College
CELESTINE WOO, SUNY, Empire State College

Seminar: Shakespeare and the New Feminisms

Grand Ballroom F, Olympic Tower

Leader: DEANNE WILLIAMS, York University

CHRISTINA LEON ALFAR, Hunter College, CUNY
MEGHAN ANDREWS, University of Texas, Austin
DYMPNA C. CALLAGHAN, Syracuse University
ANNALISA CASTALDO, Widener University
EVELYN GAJOWSKI, University of Nevada, Las Vegas
KATHERINE ANNE GILLEN, University of New Hampshire

Thursday, 7 April

COPPÉLIA KAHN, Brown University
SETH LERER, University of California, San Diego
JESSICA McCALL, University of Nevada, Las Vegas
JENNIFER A. MUNROE, University of North Carolina,
Charlotte
MARIANNE NOVY, University of Pittsburgh
PHYLLIS RACKIN, University of Pennsylvania
CAROLYN SALE, University of Alberta
KAROLINE SZATEK-TUDOR, Curry College

Seminar: Shakespeare and the Question of Theory

Larch Room, Cascade Tower

Leader: LISA MYOBUN FREINKEL, University of Oregon

TIMOTHY FRANCISCO, Youngstown State University
JOSH MAGSAM, University of Oregon
SHANKAR RAMAN, Massachusetts Institute of
Technology
TRACEY SEDINGER, University of Northern Colorado
LINDA TREDENNICK, Gonzaga University
RICHARD VAN OORT, University of Victoria
MICHAEL WITMORE, University of Wisconsin, Madison
TIMOTHY MICHAEL WONG, University of California,
Irvine

Seminar: Shakespeare and the Rejection of Sexuality

Evergreen Ballroom G, Olympic Tower

Leader: IAN FREDERICK MOULTON, Arizona State University

REBECCA BACH, University of Alabama, Birmingham
RUSS BODI, Owens College
JAMES M. BROMLEY, Miami University
NATALIE KATERINA ESCHENBAUM, University of
Wisconsin, La Crosse
ADAM H. KITZES, University of North Dakota
JEREMY LOPEZ, University of Toronto
CRISTINA MALCOLMSON, Bates College
KRIS McAABEE, University of Arkansas, Little Rock
EMILY G. SHERWOOD, The Graduate Center, CUNY
KAY STANTON, California State University, Fullerton
AARON THUROW, University of Texas, Austin

Seminar: Staging Torture, Staging the World

Evergreen Ballroom H, Olympic Tower

Leader: AYANNA THOMPSON, Arizona State University

ANTHONY GERARD BARTHELEMY, University of Miami
DAVID HAWKES, Arizona State University
JOHN M. MUCCIOLLO, Glen Ridge Public Schools
JOHN D. STAINES, John Jay College, CUNY
TIMOTHY A. TURNER, University of Texas, Austin

Workshop: Getting Published

Grand Ballroom E, Olympic Tower

Leader: JEROME SINGERMAN, University of Pennsylvania Press

PATRICIA AKHIMIE, Rutgers University, Newark
MARA AMSTER, Randolph College
CHARLOTTE ARTESE, Agnes Scott College
RONALD J. BOLING, Lyon College
MARISA R. CULL, Randolph-Macon College
ROBERT DARCY, University of Nebraska, Omaha
JASON R. DENMAN, Utica College
JEFFREY DOTY, West Texas A&M University
JENNIFER DROUIN, University of Alabama
JUANA GREEN-NICOLETTA, Towson University
TRISH THOMAS HENLEY, University of Cincinnati
CATHERINE A. HENZE, University of Wisconsin,
Green Bay
JENNIFER HIGGINBOTHAM, Ohio State University
KATHLEEN KALPIN, University of South Carolina, Aiken
KATHERINE KELLETT, Boston University
CAROL MEJIA LAPERLE, Wright State University
IRENE MIDDLETON, Georgia Institute of Technology
DANIEL D. MOSS, Southern Methodist University
JESSICA C. MURPHY, University of Texas, Dallas
GLORIA OLCHOWY, Grant MacEwan College
JAMES N. ORTEGO, Troy University, Dothan
KYLE A. PIVETTI, University of California, Davis
DANIEL POLLACK-PELZNER, Linfield College
KENDRICK PREWITT, University of West Alabama
AMY J. RODGERS, Rhode Island College
DENEEN M. SENASI, Mercer University
AMEER SOHRAWARDY, Rutgers University
ANDREA F. TROCHA-VAN NORT, United States Air
Force Academy
MELISSA WALTER, University of Fraser Valley

Workshop: Hear Here: Shakespeare's Sound and Collective Listening

Grand Ballroom J, Olympic Tower

Leader: P. A. SKANTZE, Roehampton
University

ERIC G. BINNIE, Hendrix College

KATHERINE STEELE BROKAW, University of Michigan

SHEILA T. CAVANAGH, Emory University

MARC GEISLER, Western Washington University

HEIDI BRAYMAN HACKEL, University of California,
Riverside

LINDA MCJANNET, Bentley University

CAMERON HUNT MCNABB, University of South Florida

AUDREY E. STANLEY, University of California,
Santa Cruz

JOYCE SUTPHEN, Gustavus Adolphus College

6:00 to 8:00 p.m.

Opening Reception

The Westin Bellevue



The Westin Bellevue is less than a quarter-mile walk from the Hyatt Regency Bellevue and is located at 601 Bellevue Way NE. Exit the front entrance of the Hyatt and cross NE 8th Street at the crosswalk. Walk one block south on Bellevue Way.

A full dinner will be served in the Grand Ballroom. Additional seating is provided in the nearby Lake Coeur d'Alene and Lake Chelan Rooms.

The reception is open to all registrants for the 39th Annual Meeting and their guests. Name tags are required for entry.

8:00 to 10:00 p.m.

Performance: *Bond*

Grand Ballroom, Olympic Tower



Adapted from *The Merchant of Venice* by Ching Hsi-Perng and Chen Fang.

Presented by the Taiwan *Bangzi* Company.

Thanks to grants from the Taiwanese government and the Vandolsen Trust, the performance is open to all registrants for the 39th Annual Meeting and their guests.

10:00 to 11:00 p.m.

Post-Performance Discussion

Grand Ballroom, Olympic Tower

Post-performance discussion with members of the cast of *Bond*. Open to all registrants for the 39th Annual Meeting and their guests.

FRIDAY, 8 APRIL

7:30 to 9:00 a.m.

Meeting of the Editorial Board of *Shakespeare Studies*

Laurel Room, Cascade Tower

8:00 a.m. to 6:00 p.m.

Registration and Book Exhibits

Evergreen Foyer and Ballroom,
Olympic Tower

8:00 to 9:00 a.m.

Trustees' Breakfast for Graduate Students

Cedar Ballroom, Cascade Tower

Open to all graduate student members of the
SAA and hosted by the SAA Trustees.

9:00 to 10:30 a.m.

Plenary Presentation: The Stories Texts Tell

Grand Ballroom, Olympic Tower

Session Organizer: STEPHEN ORGEL
Chair: PAUL YACHNIN, McGill University

LAURIE MAGUIRE, University of Oxford
Hail, Muse! *et cetera*

BRADIN CORMACK, University of Chicago
Q: A Love Story

STEPHEN ORGEL, Stanford University
Textual Narratives

10:30 to 11:00 a.m.

Coffee Break

Grand Foyer, Olympic Tower

11:00 a.m. to 12:30 p.m.

Presentation: Depicting the Subject in Early Modern Drama

Regency Ballroom, Cascade Tower

Session Organizer and Chair:
LEEDS BARROLL, Folger Shakespeare Library

JOEL B. ALTMAN, University of California
"Your sorrow was too sore laid on":
Shakespeare and the Subject of
Ekphrasis

HARRY BERGER JR., University of California,
Santa Cruz

Silent Complicity: The Subjectivity of
Emilia in *Othello*

LORNA HUTSON, University of St. Andrews
Subjects, Selves, and Circumstances

Presentation: Memorializing Shakespeare

Grand Ballroom, Olympic Tower

Session Organizer: KAREN NEWMAN
Chair: ADAM ZUCKER, University of
Massachusetts

RAMIE TARGOFF, Brandeis University
Posthumous Love: The Afterlife of
Romeo and Juliet

KAREN NEWMAN, Brown University
Memorializing Shakespeare

ALAN STEWART, Columbia University
The Actor and the Bad Poet:
The Memorial Reconstruction of
Shakespeare

1:00 to 3:00 p.m.

Annual Luncheon

Grand Ballroom, Olympic Tower



Presiding: **RUSS McDONALD**,
Goldsmiths College, University of London

Open to all registrants for the 39th Annual Meeting. Tickets for guests' luncheons may be purchased at the registration tables (based on availability).

3:30 to 5:30 p.m.

Film Screening: *Prince of the Himalayas* *Auditorium, Cascade Tower*



Directed by **SHERWOOD HU** (2006)

Open to all registrants for the 39th Annual Meeting and their guests.

Seminar: The Character of Reported Speech in Shakespeare

Cedar Ballroom A, Cascade Tower

Leaders: **RUTH MORSE**, Université Paris Diderot and **DAVID SCHALKWYK**, Folger Shakespeare Library

JOHN BAXTER, Dalhousie University
DAVID BEVINGTON, University of Chicago
SUKANTA CHAUDHURI, Jadavpur University
JONATHAN HOPE, Strathclyde University
JAMES LOEHLIN, University of Texas, Austin
LYNNE MAGNUSSON, University of Toronto
JELENA MARELJ, Queen's University
EDWARD ROCKLIN, California State Polytechnic University, Pomona
JANE WANNINGER, Vanderbilt University

Seminar: Delinquent Shakespeare

Grand Ballroom K, Olympic Tower

Leader: **MICHELLE M. DOWD**, University of North Carolina, Greensboro

AMANDA BAILEY, University of Connecticut
ANUPAM BASU, University of Wisconsin
CLAIRE M. BUSSE, La Salle University
BRANDON CHRISTOPHER, University of Winnipeg
CHARLES CONAWAY, University of Southern Indiana
CHIKAKO D. KUMAMOTO, College of DuPage
JESSICA LANDIS, University of Massachusetts
ANNA M. PRUITT, University of California, Davis
STEPHEN SPIESS, University of Michigan
JEANETTE NGUYEN TRAN, University of Wisconsin
VALERIE TRAUB, University of Michigan

Seminar: Diet and Identity in Shakespeare's England

Larch Room, Cascade Tower

Leaders: **KIMBERLY COLES**, University of Maryland and **GITANJALI SHAHANI**, San Francisco State University

ROBERT APPELBAUM, Lancaster University
KERI SANBURN BEHRE, University of Kansas
STEPHANIE CHAMBERLAIN, Southeast Missouri State University

Friday, 8 April

STEPHEN COHEN, Central Connecticut State University
HILLARY EKLUND, Loyola University New Orleans
REBECCA LAROCHE, University of Colorado, Colorado Springs
JOHN LEPAGE, Vancouver Island University
SHERI McCORD, Saint Louis University
JENNIFER M. PARK, University of North Carolina
CRAIG M. RUSTICI, Hofstra University
BARBARA SEBEK, Colorado State University
DAVID SWAIN, Southern New Hampshire University
AMY L. TIGNER, University of Texas, Arlington
WENDY WALL, Northwestern University
TIMOTHY W. ZAJAC, University of Massachusetts

Seminar: Drama and/of the Reformation

Grand Ballroom J, Olympic Tower

Leader: JAMES D. MARDOCK, University of Nevada

BRIAN HARRIES, Concordia University Wisconsin
ROBERT HORNBACK, Oglethorpe University
NATHANIEL C. LEONARD, University of Massachusetts
KATHRYN MCPHERSON, Utah Valley University
STEPHEN MULLANEY, University of Michigan
JULIE PAULSON, San Francisco State University
ELIZABETH PENTLAND, York University
WILLIAM W. E. SLIGHTS, University of Saskatchewan
ANDREW TUMMINIA, Spring Hill College
JACQUELINE WYLDE, University of Toronto
JASON ZYSK, Brown University

Seminar: Gender and Song in Early Modern England

Maple Room, Olympic Tower

Leaders: LESLIE C. DUNN, Vassar College and
KATHERINE R. LARSON, University of Toronto

LINDA AUSTERN, Northwestern University
NORA L. CORRIGAN, Mississippi University for Women
AMANDA WINKLER EUBANKS, Syracuse University
ANGELA HEETDERKS, University of Michigan
KENDRA PRESTON LEONARD, Westminster Choir College
ERIN KATHLEEN MINEAR, College of William and Mary
SCOTT A. TRUDELL, Rutgers University
SARAH WILLIAMS, University of South Carolina
JENNIFER LINHART WOOD, George Washington University

Seminar: *Henry IV, Part Two* *Grand Ballroom I, Olympic Tower*

Leader: JAMES C. BULMAN, Allegheny College

PAUL F. ALLEN, Sheffield, United Kingdom
JONATHAN BALDO, Eastman School of Music
JOHN CAMERON, Dalhousie University
ROB CARSON, Hobart and William Smith Colleges
RALPH ALAN COHEN, American Shakespeare Center
PENELOPE H. GENG, University of Southern California
EDWARD GIESKES, University of South Carolina
MIRIAM GILBERT, University of Iowa
JAMES HIRSH, Georgia State University
MARGARET MAURER, Colgate University
WILLIAM O. SCOTT, University of Kansas
WILL SHARPE, University of Leeds
BARBARA H. TRAISTER, Lehigh University

Seminar: Jests in Early Modern Culture

Cottonwood Room, Cascade Tower

Leader: ADAM SMYTH, Birkbeck College, University of London

SABINE ZHOMARTOVNA AMANBAYEVA, University of Delaware
MAURICE HUNT, Baylor University
MAYA MATHUR, University of Mary Washington
RODERICK MCKEOWN, University of Toronto
KIRK MELNIKOFF, University of North Carolina, Charlotte
IAN MUNRO, University of California, Irvine
PHILIP S. PALMER, University of Massachusetts
TONY PERRELLO, California State University, Stanislaus
MATTHEW STEGGLE, Sheffield Hallam University
HELEN M. WHALL, College of the Holy Cross
ADAM ZUCKER, University of Massachusetts

Seminar: Lacunae in Theater History, Part Two

Evergreen Ballroom B, Olympic Tower

Leader: LESLIE THOMSON, University of Toronto

MELISSA D. AARON, California State Polytechnic University, Pomona

ELEANOR COLLINS, Oxford University Press

PETER H. GREENFIELD, University of Puget Sound

GRACE IOPPOLO, University of Reading

JOHN JOWETT, University of Birmingham

DAVID KATHMAN, Chicago, Illinois

ROSLYN L. KNUTSON, University of Arkansas, Little Rock

LAWRENCE MANLEY, Yale University

CHRISTOPHER MATUSIAK, University of Toronto

DAVID MCINNIS, University of Melbourne

REBECCA MUNSON, University of California, Berkeley

HOLGER SYME, University of Toronto

Seminar: *Macbeth*: The State of Play, Part One

Evergreen Ballroom A, Olympic Tower

Leader: ANN THOMPSON, King's College, University of London

LAURA AYDELOTTE, University of Chicago

SANDRA SCOTT CLARK, Institute of English Studies, University of London

ANTHONY B. DAWSON, University of British Columbia

KATE SONYA HARVEY, Trinity College Dublin

MICHAEL L. HAYS, Las Cruces, New Mexico

GILLIAN MURRAY KENDALL, Smith College

DARRAGH GERARD MARTIN, Columbia University

E. K. MCFALL, University of Washington

ROBERT S. MIOLA, Loyola University Maryland

ALFREDO MODENESSI, Universidad Nacional Autónoma de México

ROLF O. MUELLER, Fanny-Leicht-Gymnasium, Stuttgart

DEBAPRIYA SARKAR, Rutgers University

PHILIPPA SHEPPARD, University of Toronto

GERALDO U. DE SOUSA, University of Kansas

DEBORAH WILLIS, University of California, Riverside

Seminar: The Politics of Female Alliance

Juniper Room, Cascade Tower

Leaders: ELIZABETH ZEMEN KOLKOVICH, Ohio State University, Mansfield and NIAMH J. O'LEARY, Xavier University

RONDA ARAB, Simon Fraser University

CLAIRE A. DAWKINS, University of California, Davis

MARLISS C. DESENS, Texas Tech University

MARTHA A. KALNIN DIEDE, Northwest University

MARION HOLLINGS, Middle Tennessee State University

EMILY RUTH ISAACSON, Chowan University

NAOMI CONN LIEBLER, Montclair State University

CHRISTINA LUCKYJ, Dalhousie University

SARA D. LUTTFRING, University of Illinois, Urbana-Champaign

JESSICA LIN MALAY, University of Huddersfield

ALICIA V. TOMASIAN, William Rainey Harper College

STEVEN URKOWITZ, City College of New York

MARTINE VAN ELK, California State University, Long Beach

Seminar: Prosthetics and Performance

Evergreen Ballroom I, Olympic Tower

Leaders: GENEVIEVE LOVE, Colorado College and ANDREA STEVENS, University of Illinois, Urbana-Champaign

THOMAS P. ANDERSON, Mississippi State University

NICOLA M. IMBRACIO, University of New Hampshire

ELIZABETH KLETT, University of Houston, Clear Lake

MATT KOZUSKO, Ursinus College

JENNIFER ROBERTS-SMITH, University of Waterloo

IAN SMITH, Lafayette College

KATHERINE SCHAAP WILLIAMS, Rutgers University

ELIZABETH ANNE WILLIAMSON, Evergreen State College

Friday, 8 April

Seminar: Shakespeare and Classicism: Redux

Regency Ballroom EF, Cascade Tower

Leader: LYNN ENTERLINE, Vanderbilt University

AMY M. BRADEN, University of Southern California
ANDREW BRETZ, University of Guelph
MICHAEL C. CLODY, University of Houston, Clear Lake
JAY FARNES, Northern Arizona University
BRADLEY GREENBURG, Northeastern Illinois University
CORY LOWELL GREWELL, Thiel College
JONATHAN GIL HARRIS, George Washington University
ABIGAIL HEALD, Stanford University
JEAN E. HOWARD, Columbia University
ELIZABETH A. HUTCHEON, University of Chicago
HEATHER JAMES, University of Southern California
WILLIAM R. JONES, Murray State University
AARON WELLS KITCH, Bowdoin College
KATHRYN SCHWARZ, Vanderbilt University

Seminar: Stratford

Laurel Room, Cascade Tower

Leader: KATHERINE SCHEIL, University of Minnesota

CLARA CALVO, University of Murcia
CHRISTY DESMET, University of Georgia
SUSANNE GREENHALGH, Roehampton University London
TON HOENSELAARS, Utrecht University
GRAHAM HOLDERNESS, University of Hertfordshire
M. LINDSAY KAPLAN, Georgetown University
CAMPBELL LATHEY, Albany, New York
ALAN H. NELSON, University of California
JULIE SANDERS, University of Nottingham

Seminar: The “Ungodly” in Shakespeare’s England

Regency Ballroom B, Cascade Tower

Leader: TIFFANY WERTH, Simon Fraser University

JENNIFER LOTTE ANDERSEN, California State University, San Bernardino
DENNIS A. BRITTON, University of New Hampshire
RINKU CHATTERJEE, Syracuse University
JULIE CRAWFORD, Columbia University
KURT DOUGLASS, Lehigh University
CODY REIS, New York University
ANNETTE STENNING, Simon Fraser University
VERENA THEILE, North Dakota State University

Seminar: Violent Masculinities

Regency Ballroom A, Cascade Tower

Leaders: CATHERINE THOMAS, College of Charleston and JENNIFER FEATHER, University of North Carolina, Greensboro

GINA BLOOM, University of California, Davis
DAVID BOYLES, University of Nevada, Las Vegas
PATRICIA CAHILL, Emory University
JIM CASEY, High Point University
FRANCES E. DOLAN, University of California, Davis
LAURIE ELLINGHAUSEN, University of Missouri, Kansas City
RUBEN ESPINOSA, University of Texas, El Paso
JENNIFER FORSYTH, Kutztown University
DANIEL GATES, Saginaw Valley State University
LOREEN L. GIESE, Ohio University
JENNIFER A. LOW, Florida Atlantic University
ANDREW D. MCCARTHY, University of Tennessee, Chattanooga
REBECCA OLSON, Oregon State University
LISA S. STARKS-ESTES, University of South Florida, St. Petersburg

Seminar: *The Winter’s Tale*

Evergreen Ballroom H, Olympic Tower

Leaders: PETER G. PLATT, Barnard College and BENEDICT S. ROBINSON, Stony Brook University

MARIO DIGANGI, Lehman College, CUNY
BARBARA L. ESTRIN, Stonehill College
JOHN R. FORD, Delta State University
ALEXANDRA HALASZ, Dartmouth College
NIELS HEROLD, Oakland University
JASMINE S. LELLOCK, University of Maryland
LAURA E. LEVINE, Tisch School of the Arts, New York University
SUBHA MUKHERJI, University of Cambridge
HEATHER J. MURRAY, Pennsylvania State University
MARGARET OWENS, Nipissing University
ROBERT B. PIERCE, Oberlin College
VELMA BOURGEOIS RICHMOND, Holy Names University
JOANNE ROCHESTER, University of Saskatchewan
HIEWON SHIN, North Greenville University

Workshop: The Shakespeare Quartos Archive

Evergreen Ballroom G, Olympic Tower

Leaders: JIM KUHN, Folger Shakespeare Library and CARTER HAILEY, College of William and Mary

MICHAEL BEST, University of Victoria

NICHOLE DEWALL, McKendree University

JEREMY EHRLICH, Internet Shakespeare Editions

BRETT D. HIRSCH, University of Western Australia

KATHERINE ROWE, Bryn Mawr College

JESSICA SLIGHTS, Acadia University

SARAH WERNER, Folger Shakespeare Library

Workshop: Teaching Our Other Shakespeare (Middleton)

Evergreen Ballroom C, Olympic Tower

Leader: GARY TAYLOR, Florida State University

DANA E. ASPINALL, Alma College

MARY BLY, Fordham University

REGINA BUCCOLA, Roosevelt University

JONATHAN V. CREWE, Dartmouth University

ANNETTE DREW-BEAR, Washington and Jefferson College

EDWARD J. GEISWEIDT, Wartburg College

HEATHER ANNE HIRSCHFELD, University of Tennessee

JEFFREY KAHAN, University of La Verne

MATTHEW J. KUBUS, The Shakespeare Institute

SARAH E. OLIVE, University of York

GREGORY M. SCHNITZSPAHN, Tufts University

5:30 to 6:30 p.m.

ELR Anniversary Party

Grand Ballroom, Olympic Tower

Toast the 40th Anniversary of *English Literary Renaissance*. Champagne and cake for as long as quantities last.

6:00 to 7:00 p.m.

Meeting of the Editorial Board of *Shakespeare Quarterly*

Juniper Room, Cascade Tower

8:00 to 10:00 p.m.

Performance: Traditional Skits

Grand Ballroom, Olympic Tower



Skits in the style of traditional Chinese opera, performed by members of the Taiwan *Bangzi* Company.

Thanks to grants from the Taiwanese government and the Vandolsen Trust, the performance is open to all registrants for the 39th Annual Meeting and their guests.

SATURDAY, 9 APRIL

7:30 to 9:00 a.m.

Meeting of the Editorial Board of the Internet Shakespeare

Juniper Room, Cascade Tower

8:00 a.m. to 12:00 noon

Information and Book Exhibits

Evergreen Foyer and Ballroom, Olympic Tower

9:00 a.m. to 12:00 noon

Workshop for Teachers: *From Script to Performance*

Cedar Ballroom, Cascade Tower

Workshop Leaders: MICHAEL SHURGOT, South Puget Sound Community College, KATHRYN LAMOREAUX, Battle Ground High School, Washington, BILL RAUCH and LUE DOUTHIT, Oregon Shakespeare Festival

9:00 to 10:30 a.m.

Presentation: Editing Shakespeare

Grand Ballroom, Olympic Tower

Session Organizers: BARBARA MOWAT and PAUL WERSTINE

Chair: BARBARA MOWAT, Folger Shakespeare Library

A. R. BRAUNMULLER, University of California, Los Angeles

Editing *Measure*—a View from the Trenches

ALAN GALEY, University of Toronto
The Shakespearean Archive: Critical Prehistories of Digital Editing

PAUL WERSTINE, University of Western Ontario
Alfred W. Pollard Redux

Presentation: Experimental Shakespeare in Theory and Practice

Regency Ballroom, Cascade Tower

Session Organizer: THOMAS CARTELLI

Chair: GINA BLOOM, University of California, Davis

SUSAN BENNETT, University of Calgary
Historicizing the Experimental

THOMAS CARTELLI, Muhlenberg College
High-Tech Shakespeare in a Mediatized Globe

W. B. WORTHEN, Barnard College
“What light through yonder window speaks?” Dedramatizing Shakespeare

10:30 to 11:00 a.m.

Coffee Break

Grand Foyer, Olympic Tower, and Regency Foyer, Cascade Tower

11:00 a.m. to 12:30 p.m.

Presentation: Black Studies in the English Renaissance

Grand Ballroom, Olympic Tower

Session Organizer: IMTIAZ HABIB

Chair: CAROLYN SALE, University of Alberta

IMTIAZ HABIB, Old Dominion University
The Reasonables of Boroughside, Southwark: An Elizabethan Black Family near the Rose Theater

DUNCAN SALKELD, University of Chichester
Othello and Assimilation

MARGO HENDRICKS, University of California, Santa Cruz

“I saw him in my visage”: Problems with Race Studies in Early Modern English Literature

Presentation: Decoding Playwrights' Options and Choices

Regency Ballroom, Cascade Tower

Session Organizers: MEMBERS OF THE OPEN SUBMISSIONS COMMITTEE FOR 2011

Chair: DAVID BEVINGTON, University of Chicago

RICHARD ABRAMS, University of Southern Maine
"The name of Prosper"

MATTEO PANGALLO, University of Massachusetts
"Mayn't a Spectator Write a Comedy?"
Playgoer-Playwrights in Shakespeare's Theater

JACQUELINE VANHOUTTE, University of North Texas
"Shew Him in Love": Falstaff among the Minions of the Moon

2:00 to 3:30 p.m.

Presentation: Beyond Playbooks

Grand Ballroom, Olympic Tower

Session Organizer and Chair: BARBARA HODGDON, University of Michigan

RICHARD PREISS, University of Utah
What Audiences Did

JAMES J. MARINO, Cleveland State University
Shakespeare After Editing

TIFFANY STERN, University College, Oxford
Marts and Fairs: Shakespeare and Mass Entertainment

Presentation: Marlowe's Vitality

Regency Ballroom, Cascade Tower

Session Organizer: GARRETT SULLIVAN
Chair: HEIDI BRAYMAN HACKEL, University of California, Riverside

JEFFREY MASTEN, Northwestern University
Edward II: Queer Theories, Vital Signs

LUCY MUNRO, Keele University
Language, Temporality, and the Vitality of Marlowe's "Mighty Line"

GARRETT SULLIVAN, Pennsylvania State University
Vitality, Spirit, and Oblivion in *Tamburlaine the Great*

4:00 to 6:00 p.m.

Film Screening: *Prince of the Himalayas* *Auditorium, Cascade Tower*

Directed by SHERWOOD HU (2006)

Open to all registrants for the 39th Annual Meeting and their guests.

Seminar: Cosmopolitans and Barbarians

Grand Ballroom E, Olympic Tower

Leaders: BARBARA FUCHS, University of California, Los Angeles and CATHERINE NICHOLSON, Yale University

DAVID J. BAKER, University of North Carolina
POMPA BANERJEE, University of Colorado, Denver
JESSICA ROBERTS FRAZIER, George Washington University

ANDREW HISCOCK, Bangor University, Wales

KATHY M. LAVEZZO, University of Iowa

NEDDA MEHDIZADEH, George Washington University

KATHRYN VOMERO SANTOS, New York University

JOEL ELLIOT SLOTKIN, Towson University

VALERIE WAYNE, University of Hawai'i

MIMI YIU, Georgetown University

Saturday, 9 April

Seminar: Early Modern Women and the Discourse of Death

Evergreen Ballroom B, Olympic Tower

Leader: MARION WYNNE-DAVIES, University of Surrey

KASEY EVANS, Northwestern University
SUSAN FRYE, University of Wyoming
ELIZABETH HODGSON, University of British Columbia
DONALD C. JELLERSON, Rhodes College
ROSEMARY KEGL, University of Rochester
DONNA J. LONG, Fairmont State University
MARION F. O'CONNOR, University of Kent
TARA ELIZABETH PEDERSEN, Sonoma State University
TRIPTHI PILLAI, Coastal Carolina University
DANA MICHELLE SCHUMACHER-SCHMIDT, University of Minnesota, Twin Cities
KRISTIANE R. STAPLETON, University of Wisconsin
MARY TRULL, St. Olaf College
DEBORAH UMAN, St. John Fisher College
HARRY AUSTIN WHITVER, University of Alabama

Seminar: Hot Protestant Shakespeare

Grand Ballroom G, Olympic Tower

Leader: CLAIRE MCEACHERN, University of California, Los Angeles

DAVID ANDERSON, University of Oklahoma
ANTHONY BURTON, Amherst, Massachusetts
DARLENE CIRAULO, University of Central Missouri
CYNDIA SUSAN CLEGG, Pepperdine University
LORI ANNE FERRELL, Claremont Graduate University
JASON GLECKMAN, Chinese University of Hong Kong
KENNETH J. E. GRAHAM, University of Waterloo
KRISTINE ANNE JOHANSON, University of St. Andrews
ERIN E. KELLY, University of Victoria
JESSE M. LANDER, University of Notre Dame
GRETCHEN E. MINTON, Montana State University
MARILYN SIMON, University of Toronto
ROBERT N. WATSON, University of California, Los Angeles

Seminar: Likeness in Shakespeare's England

Larch Room, Cascade Tower

Leader: MARJORIE RUBRIGHT, University of Toronto

ALEXANDRA MILLS BLOCK, Bucknell University
VERNON GUY DICKSON, Florida International University
ERIN ELLERBECK, University of Toronto
MARIA FAHEY, Friends Seminary
SANNER GAROFALO, University of Birmingham
JUDITH HABER, Tufts University
MEGAN HEFFERNAN, University of Chicago
JENNIFER R. HOLL, The Graduate Center, CUNY
ANDREW HUI, Stanford University
MARY JANELL METZGER, Western Washington University
HARRY REX NEWMAN, Birmingham University
BETHANY M. PACKARD, Vanderbilt University
ROBERT SAWYER, East Tennessee State University
ROBERT E. STRETTER, Providence College
YOLANA WASSERSUG, The Shakespeare Institute
WILLIAM N. WEST, Northwestern University

Seminar: *Macbeth*: The State of Play, Part Two

Evergreen Ballroom A, Olympic Tower

Leader: ANN THOMPSON, King's College, University of London

JENNIFER ADAIR, The Citadel
DARLENE FARABEE, University of South Dakota
BRETT GAMBOA, Dartmouth College
EMILY KING, Tufts University
JEMMA ALIX LEVY, Mary Baldwin College
HILDA H. MA, Saint Mary's College of California
HOWARD MARCHITELLO, Rutgers University
BARBARA MELLO, University of Southern California
SUSAN G. O'MALLEY, City University of New York
ERIN PRESLEY, University of Georgia
KEVIN ARTHUR QUARMBY, Shakespeare's Globe, London
ELIZABETH J. RIVLIN, Clemson University
RAMONA WRAY, Queen's University, Belfast

Seminar: Memory Culture in Shakespeare

Evergreen Ballroom H, Olympic Tower

Leaders: J. K. BARRET, University of Texas, Austin and LINA PERKINS WILDER, Connecticut College

PAUL BUDRA, Simon Fraser University
BARBARA CORRELL, Cornell University
XOCHITL GILKESON, University of Wisconsin
MATTHEW C. HANSEN, Boise State University
SUSAN HARLAN, Wake Forest University
PHEBE JENSEN, Utah State University
LLOYD EDWARD KERMODE, California State University, Long Beach
BILL KERWIN, University of Missouri
ZACKARIAH C. LONG, Ohio Wesleyan University
JULIA ELIZABETH MACDONALD, University of North Texas
FIONNUALA RUTH CLARA O'NEILL, University of Edinburgh
ANTHONY GUY PATRICIA, University of Nevada, Las Vegas
LUKE WILSON, Ohio State University

Seminar: Queer Theory Now

Grand Ballroom C, Olympic Tower

Leaders: STEPHEN GUY-BRAY, University of British Columbia and DAVID L. ORVIS, Appalachian State University

CASEY CHARLES, University of Montana
SIMONE CHESS, Wayne State University
HOLLY E. DUGAN, George Washington University
WILL FISHER, Lehman College, CUNY
COREY McEENEY, Brown University
MADHAVI MENON, American University
RYAN SINGH PAUL, Allegheny College
MARIA TERESA PRENDERGAST, College of Wooster
NICHOLAS RADEL, Furman University
WILLIAM REGINALD RAMPONE, JR., South Carolina State University
SARAH D. RASHER, University of Connecticut, Storrs
WILLIAM STOCKTON, Clemson University
CHRISTINE VARNADO, Columbia University

Seminar: Redefining Theatrical Culture: The Theater of the Streets

Grand Ballroom A, Olympic Tower

Leader: S. P. CERASANO, Colgate University

CATHERINE R. CLIFFORD, University of Birmingham
J. CAITLIN FINLAYSON, University of Michigan, Dearborn
INDIRA GHOSE, Université de Fribourg
ANNE M. GILL, King's College, London
JILL PHILLIPS INGRAM, Ohio University
JANELLE JENSTAD, University of Victoria
ANNE LANCASHIRE, University of Toronto
JENNA LAY, Lehigh University
ERIKA T. LIN, George Mason University
CATHERINE LOOMIS, University of New Orleans
M. BELLA MIRABELLA, New York University
NOVA MYHILL, New College of Florida
AMRITA SEN, Michigan State University

Seminar: Sanctity

Evergreen Ballroom I, Olympic Tower

Leaders: ALICE DAILEY, Villanova University and KRISTEN POOLE, University of Delaware

ALISON A. CHAPMAN, University of Alabama, Birmingham
SUSAN COMILANG, Columbia Union College
GINA M. DI SALVO, Northwestern University
SUSAN MICHELE DUNN-HENSLEY, Wheaton College
LAURA GALLAGHER, Queen's University, Belfast
MUSA GURNIS-FARRELL, Columbia University
KENT R. LEHNHOF, Chapman University
KATHLEEN LYNCH, Folger Shakespeare Library
DAVID SUMMERS, Capital University

Seminar: Shakespeare and Opera

Juniper Room, Cascade Tower

Leader: WILLIAM GERMANO, Cooper Union

NICHOLAS JONES, Oberlin College
RUSS McDONALD, Goldsmiths College, University of London
ELINOR PARSONS, De Montfort University
BRUCE R. SMITH, University of Southern California
JAMES J. YOCH, University of Oklahoma

Saturday, 9 April

Seminar: Shakespeare and Renaissance Ideas of a Life

Regency Ballroom EF, Cascade Tower

Leader: **STEPHEN GREENBLATT**, Harvard University

JAMES E. BERG, Middlebury College
SARA COODIN, University of Oklahoma
ANDREW NICHOLAS DANIEL, Johns Hopkins University
JOSE MANUEL GONZALEZ, Universidad de Alicante
ANSELM HAVERKAMP, New York University
DONALD HEDRICK, Kansas State University
LALITA PANDIT HOGAN, University of Wisconsin, La Crosse
YU JIN KO, Wellesley College
NICK MOSCHOVAKIS, Washington, D.C.
KELLY M. NEIL, University of California, Davis
SUPARNA ROYCHOUDHURY, Harvard University
ERIN MARIE SULLIVAN, University College London
DON WEINGUST, Center for Shakespeare Studies
DAVID H. WOOD, Northern Michigan University
PAUL YACHNIN, McGill University

Seminar: Shakespeare and Science

Grand Ballroom F, Olympic Tower

Leader: **REBECCA LEMON**, University of Southern California

JEAN-FRANÇOIS BERNARD, Université de Montréal
LIZA BLAKE, New York University
JOHN D. COX, Hope College
MARY THOMAS CRANE, Boston College
STEPHEN DENG, Michigan State University
ALLISON KAY DEUTERMANN, Baruch College, CUNY
KATHERINE EGGERT, University of Colorado
JEAN E. FEERICK, Brown University
JOHN GARRISON, University of California, Davis
JOE KEENER, Indiana University, Kokomo
ALLISON KELLAR LENHARDT, University of Georgia
SCOTT MAISANO, University of Massachusetts, Boston
JENNIFER RAE McDERMOTT, University of Toronto
HENRY S. TURNER, Rutgers University

Seminar: Shakespeare for Sale

Maple Room, Olympic Tower

Leader: **ADAM G. HOOKS**, University of Iowa

PETER BEREK, Mount Holyoke College
DOUGLAS BRUSTER, University of Texas, Austin
FRANCIS XAVIER CONNOR, Indiana University-Purdue University, Indianapolis
EMMA LESLEY DEPLEDGE, University of Geneva
ALAN B. FARMER, Ohio State University
CHRISTINA A. FURTADO, Fordham University
PETER PHILIP KIRWAN, University of Warwick
TARA LYNN LYONS, University of Illinois, Urbana-Champaign
SARAH J. NEVILLE, Indiana University-Purdue University, Indianapolis
VIMALA C. PASUPATHI, Hofstra University
RYAN ZUROWSKI, Stanford University

Seminar: Shakespeare's Poetry

Grand Ballroom B, Olympic Tower

Leaders: **PATRICK CHENEY**, Pennsylvania State University and **MICHAEL SCHOENFELDT**, University of Michigan

KATHERINE BOOTLE ATTIE, American University
KATHARINE CLELAND, Pennsylvania State University
MEGHAN DAVIS, University of Southern California
HEATHER DUBROW, Fordham University
ELIZABETH A. FOWLER, University of Virginia
DANIEL JUAN GIL, Texas Christian University
ELIZABETH HARVEY, University of Toronto
JEFFREY PAXTON HEHMEYER, University of California, Santa Barbara
SCOTT A. HOLLIFIELD, University of Nevada, Las Vegas
CHRISTINE E. HUTCHINS, Hostos Community College, CUNY
MIRIAM EMMA JACOBSON, University of Georgia
WILLIAM JUNKER, University of St. Thomas
JASON LEUBNER, University of Texas, Austin
ERIN ANN MCCARTHY, Ohio State University

Seminar: Silenced Shakespeare Films

Evergreen Ballroom C, Olympic Tower

Leader: COURTNEY LEHMANN, University of the Pacific

M. G. AUNE, California University of Pennsylvania
CURTIS BREIGHT, University of Pittsburgh
STEPHEN M. BUHLER, University of Nebraska, Lincoln
MELISSA M. CROTEAU, California Baptist University
SAMUEL CROWL, Ohio University
PETER S. DONALDSON, Massachusetts Institute of Technology
LIANNE HABINEK, Bard College
KEITH HARRISON, Vancouver Island University
RUSSELL BENNETT JACKSON, University of Birmingham
DOUGLAS M. LANIER, University of New Hampshire
PATRICIA LENNOX, New York University
AMY SCOTT-DOUGLASS, Marymount University
DONNA WOODFORD-GORMLEY, New Mexico Highlands University

Workshop: Performing Shakespeare for Popular Audiences

Cedar Ballroom, Cascade Tower

Leader: STEPHEN PURCELL, Southampton Solent University with actors from THE AMERICAN SHAKESPEARE CENTER and THE SEATTLE SHAKESPEARE COMPANY

ANDREW BARNABY, University of Vermont
LISA DICKSON, University of Northern British Columbia
ROBIN INGRAHAM FARABAUGH, University of Maryland, Baltimore County
DOUGLAS E. GREEN, Augsburg College
FIONA J. HARRIS-RAMSBY, University of Utah
DOUGLAS J. KING, Gannon University
CAROLINE DODGE LATTA, Columbia College, Chicago
LAURY MAGNUS, United States Merchant Marine Academy
CARY M. MAZER, University of Pennsylvania
STEPHANIE SHINE, Seattle Shakespeare Company
MICHAEL W. SHURGOT, South Puget Sound Community College
SARA E. THOMPSON, University of Maryland

The workshop is open to all registrants for the 39th Annual Meeting.

Workshop: Shakespearean Fetish

Evergreen Ballroom G, Olympic Tower

Leader: MARK JOHNSTON, University of Windsor

ELIZABETH HANSON, Queen's University
ZOLTÁN MÁRKUS, Vassar College
BRADLEY DAVID RYNER, Arizona State University

6:15 to 7:15 p.m.

Recital

Ophelia, From Song to Stage
Auditorium, Cascade Tower



Music for Ophelia by William Linley, Johannes Brahms, Jake Heggie, and others, performed by MEGAN McCAULEY (soprano) and DANIEL OVERLY (piano).

Open to all registrants for the 39th Annual Meeting and their guests, but please note that seating is limited.

10:00 p.m. to 1:00 a.m.

The Dance

Grand Ballroom, Olympic Tower

With music by WAVE LINK MUSIC and a cash bar. Sponsored by the SAA and the Malone Society. Tickets are available at the registration tables and at the door.

Participants in the 39th Annual Meeting

Melissa D. Aaron, California State Polytechnic University, Pomona

Richard Abrams, University of Southern Maine

Heather Ackerman, Arizona State University

Jennifer Adair, The Citadel

Patricia Akhimie, Rutgers University, Newark

Cristina León Alfar, Hunter College, CUNY

Paul F. Allen, Sheffield, U.K.

Joel B. Altman, University of California, Berkeley

Sabina Amanbayeva, University of Delaware

Mara Amster, Randolph College

Jennifer Lotte Andersen, California State University, San Bernardino

David Anderson, University of Oklahoma

Thomas P. Anderson, Mississippi State University

Meghan Andrews, University of Texas, Austin

Tony Antoniadis, University of Toronto

Robert Appelbaum, Lancaster University

Ronda Arab, Simon Fraser University

Oliver Arnold, University of California, Berkeley

Douglas Arrell, University of Winnipeg

Charlotte Artese, Agnes Scott College

Dana E. Aspinall, Alma College

Katherine Bootle Attie, American University

Pavneet Aulakh, University of California, Santa Barbara

M. G. Aune, California University of Pennsylvania

Linda Austern, Northwestern University

Laura Aydelotte, University of Chicago

Rebecca Bach, University of Alabama, Birmingham

Amanda Bailey, University of Connecticut

David J. Baker, University of North Carolina

Jonathan Baldo, Eastman School of Music

Pompa Banerjee, University of Colorado, Denver

Richmond Barbour, Oregon State University

Andrew Barnaby, University of Vermont

Todd Landon Barnes, Ramapo College of New Jersey

J.K. Barret, University of Texas, Austin

Leeds Barroll, Folger Shakespeare Library

Emily Bartels, Rutgers University

Anthony Barthelemy, University of Miami

Ann Basso, University of South Florida

Anupam Basu, University of Wisconsin

Robin E. Bates, Lynchburg College

John Baxter, Dalhousie University

Sarah Beckwith, Duke University

Keri Sanburn Behre, University of Kansas

Ilona Bell, Williams College

Emma Bennett, Wiley-Blackwell

Susan Bennett, University of Calgary

Peter Berek, Mount Holyoke College

James E. Berg, Middlebury College

Harry Berger Jr., University of California, Santa Cruz

David M. Bergeron, University of Kansas

Jean-François Bernard, Université de Montréal

Robert Beshere, University of North Carolina

Michael Best, University of Victoria

David Bevington, University of Chicago

Eric Binnie, Hendrix College

Liza Blake, New York University

Alexandra Mills Block, Bucknell University

Gina Bloom, University of California, Davis

Mary Bly, Fordham University

Russ Bodi, Owens College

Lisa Bolding, University of Georgia

Ronald J. Boling, Lyon College

Stephen Booth, University of California, Berkeley

Todd Borlik, Bloomsburg University

Kathleen Bossert, Franklin & Marshall College

Andrew Raymond Bossert, Franklin & Marshall College

Keith M. Botelho, Kennesaw State University

Terri Bourus, Indiana University-Purdue University, Indianapolis

Lara Bovilsky, University of Oregon

David Boyles, University of Nevada, Las Vegas

Amy M. Braden, University of Southern California

A. R. Braunmuller, University of California, Los Angeles

Daniel Brayton, Middlebury College

Curtis Breight, University of Pittsburgh

Andrew Bretz, University of Guelph

Donna S. Brewer, Sewanee School of Letters

Dennis A. Britton, University of New Hampshire

Katherine Steele Brokaw, University of Michigan

James M. Bromley, Miami University

Lynne Bruckner, Chatham University

Douglas Bruster, University of Texas, Austin

Regina Buccola, Roosevelt University

Paul Budra, Simon Fraser University

Stephen M. Buhler, University of Nebraska, Lincoln

James C. Bulman, Allegheny College

Anthony Burton, Amherst, Massachusetts

Rebecca Bushnell, University of Pennsylvania

Ashley Denham Busse, George Washington University

Claire M. Busse, La Salle University

Patricia Cahill, Emory University

Dympna Callaghan, Syracuse University

Clara Calvo, University of Murcia

John Cameron, Dalhousie University

Joseph Campana, Rice University

Walter Cannon, Central College, Iowa

Rob Carson, Hobart and William Smith Colleges

Thomas Cartelli, Muhlenberg College

Jim Casey, High Point University

Annalisa Castaldo, Widener University

Sheila T. Cavanagh, Emory University

S. P. Cerasano, Colgate University

Urvashi Chakravarty, Vanderbilt University

Brian Chalk, Manhattan College

Stephanie Chamberlain, Southeast Missouri State University

Alison A. Chapman, University of Alabama, Birmingham

Casey Charles, University of Montana

Brinda Charry, Keene State College

Rinku Chatterjee, Syracuse University

Sukanta Chaudhuri, Jadavpur University

Patrick Cheney, Pennsylvania State University

Simone Chess, Wayne State University

Ann Christensen, University of Houston

Brandon Christopher, University of Winnipeg

Darlene Ciraulo, University of Central Missouri

New Shakespeare Titles from Ashgate...

Visit us in the exhibit hall and receive
50% off display copies!



Anonymity in Early Modern England

'What's In A Name?'

Edited by **Janet Wright Starner**
and **Barbara Howard Traister**

Feb 2011. 198 pages. Hbk. 978-0-7546-6949-4



Adapting *King Lear* for the Stage

Lynne Bradley

Nov 2010. 280 pages. Hbk. 978-1-4094-0597-9

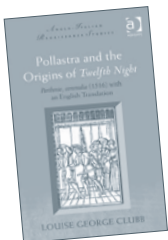

At Home in Shakespeare's Tragedies

Geraldo U. de Sousa

Includes 14 b&w illustrations
Jul 2010. 216 pages. Hbk. 978-0-7546-6886-2

Ecocritical Shakespeare

Edited by **Lynne Bruckner**
and **Dan Brayton**

LITERARY AND SCIENTIFIC CULTURES
OF EARLY MODERNITY

Include 3 b&w illustrations
Apr 2011. 300 pages. Hbk. 978-0-7546-6919-7



Pollastra and the Origins of *Twelfth Night*

Parthenio, commedia (1516)

with an English Translation
Louise George Clubb

ANGLO-ITALIAN RENAISSANCE STUDIES
Includes 8 b&w illustrations
Dec 2010. 258 pages. Hbk. 978-0-7546-6890-9

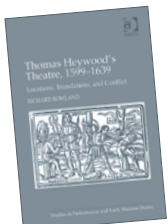

Popular Medicine, Hysterical Disease, and Social Controversy in Shakespeare's England

Kaara L. Peterson

LITERARY AND SCIENTIFIC CULTURES
OF EARLY MODERNITY

Includes 13 b&w illustrations
July 2010. 230 pages. Hbk. 978-0-7546-6993-7

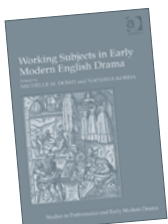

Shakespeare and the Just War Tradition

Paola Pugliatti

May 2010. 260 pages. Hbk. 978-0-7546-5927-3

Shakespeare and Venice

Graham Holderness

ANGLO-ITALIAN RENAISSANCE STUDIES
Dec 2010. 162 pages. Hbk. 978-0-7546-6606-6

COMING SOON!

Religion and Drama in Early Modern England

Edited by **Jane Hwang Degenhardt**
and **Elizabeth Williamson**

978-1-4094-0902-1

The Shakespearean International Yearbook

Volume 10: Special Section,

The Achievement of Robert Weimann
Edited by **Graham Bradshaw**, **Tom Bishop**
and **David Schalkwyk**

THE SHAKESPEAREAN INTERNATIONAL YEARBOOK
Dec 2010. 338 pages. Hbk. 978-1-4094-0858-1

This England, That Shakespeare

New Angles on Englishness
and the Bard

Edited by **Willy Maley**

and **Margaret Tudeau-Clayton**

Includes 8 b&w illustrations
Sep 2010. 272 pages. Hbk. 978-0-7546-6602-8

Thomas Heywood's Theatre, 1599-1639

Locations, Translations, and Conflict

Richard Rowland

STUDIES IN PERFORMANCE AND EARLY MODERN DRAMA
Includes 12 b&w illustrations

Mar 2010. 394 pages. Hbk. 978-0-7546-6925-8

Visions of Venice in Shakespeare

Edited by **Laura Tosi** and **Shaul Bassi**

ANGLO-ITALIAN RENAISSANCE STUDIES

Includes 6 b&w illustrations
Feb 2011. 278 pages. Hbk. 978-1-4094-0547-4

Working Subjects in Early Modern English Drama

Edited by **Michelle M. Dowd**

and **Natasha Korda**

STUDIES IN PERFORMANCE AND EARLY MODERN DRAMA
Feb 2011. 310 pages. Hbk. 978-1-4094-1077-5

The University Wits: 6-Volume Set

Robert Logan

THE UNIVERSITY WITS

These volumes demonstrate the importance of the small group of university-educated Renaissance writers commonly known as the "University Wits": John Lyly, Thomas Lodge, George Peele, Robert Greene, Christopher Marlowe and Thomas Nashe. Each of these Wits is the subject of a dedicated volume of perceptive and wide-ranging critical essays which bring together the most important scholarly work to date on the group and illuminate the distinctive characteristics of each Wit.

Apr 2011. 3000 pages. Hbk. 978-0-7546-2880-4

PREVIEW THE BOOKS ON DISPLAY AT

WWW.ASHGATE.COM/SA2011

101 Cherry St.

Suite 420

Burlington, VT 05401

To order, call (800) 535-9544

Sandra Scott Clark, Institute of English Studies,
University of London

Cyndia Susan Clegg, Pepperdine University

Katharine Cleland, Pennsylvania State University

Catherine Clifford, University of Birmingham

Michael Clody, University of Houston, Clear Lake

Jason Cohen, Berea College

Ralph Alan Cohen, American Shakespeare Center

Stephen Cohen, Central Connecticut State
University

Kimberly Coles, University of Maryland

Eleanor Collins, Oxford University Press

Susan Comilang, Columbia Union College

Charles Conaway, University of Southern Indiana

Francis Xavier Connor, Indiana University-Purdue
University, Indianapolis

Brooke Conti, SUNY, Brockport

Sara Coodin, University of Oklahoma

Ann Jennalie Cook, Vanderbilt University

Bradin Cormack, University of Chicago

Barbara Correll, Cornell University

Nora L. Corrigan, Mississippi University for Women

John D. Cox, Hope College

Mary Thomas Crane, Boston College

Patrick Crapanzano, St. John's University

Julie Crawford, Columbia University

Jonathan Crewe, Dartmouth College

Scott Crider, University of Dallas

Lezlie C. Cross, University of Washington

Melissa M. Croteau, California Baptist University

Samuel Crowl, Ohio University

Marisa R. Cull, Randolph-Macon College

Ambereen Dadabhoj, Harvey Mudd College

Alice Dailey, Villanova University

Andrew Nicholas Daniel, Johns Hopkins University

Robert Darcy, University of Nebraska, Omaha

Nandini Das, University of Liverpool

Matthew Davies, Mary Baldwin College

Meghan Davis, University of Southern California

Claire A. Dawkins, University of California, Davis

Anthony B. Dawson, University of British Columbia

Stephen Deng, Michigan State University

Jason R. Denman, Utica College

Emma Lesley Depledge, University of Geneva

Martiss C. Desens, Texas Tech University

Christy Desmet, University of Georgia

Alan C. Dessen, University of North Carolina

Allison K. Deutermann, Baruch College, CUNY

Nichole DeWall, McKendree University

Gina M. Di Salvo, Northwestern University

Lisa Dickson, University of Northern British
Columbia

Vernon Guy Dickson, Florida International
University

Martha A. Kalnin Diede, Northwest University

Mario DiGangi, Lehman College, CUNY

Lara A. Dodds, Mississippi State University

Frances E. Dolan, University of California, Davis

Peter S. Donaldson, Massachusetts Institute of
Technology

Jeffrey Doty, West Texas A&M

Kurt Douglass, Lehigh University

Lue Morgan Douthit, Oregon Shakespeare Festival

Michelle M. Dowd, University of North Carolina,
Greensboro

Annette Drew-Bear, Washington and Jefferson
College

Jennifer Drouin, University of Alabama

Heather Dubrow, Fordham University

Lowell E. Duckert, George Washington University

Holly Dugan, George Washington University

Leslie C. Dunn, Vassar College

Susan Michele Dunn-Hensley, Wheaton College

Kari Jene Durgan, University of California, Davis

Katherine Eggert, University of Colorado

Jeremy Ehrlich, Internet Shakespeare Editions

Hillary Eklund, Loyola University New Orleans

Erin Ellerbeck, University of Victoria

Laurie Ellinghausen, University of Missouri,
Kansas City

Lars Engle, University of Tulsa

Sarah Enloe, American Shakespeare Center

Lynn Enterline, Vanderbilt University

Natalie Katerina Eschenbaum, University of
Wisconsin, La Crosse

Doug Eskew, Colorado State University, Pueblo

Ruben Espinosa, University of Texas, El Paso

Barbara L. Estrin, Stonehill College

Amanda Winkler Eubanks, Syracuse University

Kasey Evans, Northwestern University

Maria Fahey, Friends Seminary

Robin Ingraham Farabaugh, University of
Maryland, Baltimore County

Darlene Farabee, University of South Dakota

Alan B. Farmer, Ohio State University

Jay Farness, Northern Arizona University

Valerie M. Fazel, Arizona State University

Jennifer Feather, University of North Carolina,
Greensboro

Jean Feerick, Brown University

Lori Anne Ferrell, Claremont Graduate University

J. Caitlin Finlayson, University of Michigan,
Dearborn

Rachel L. Graf Fisher, Bob Jones University

Will Fisher, Lehman College, CUNY

Patrick Flor, University of Kansas

Stephen Merriam Foley, Brown University

Greg Foran, Nazareth College of Rochester

John R. Ford, Delta State University

Susan Allen Ford, Delta State University

Jennifer Forsyth, Kutztown University

Elizabeth A. Fowler, University of Virginia

Cora Fox, Arizona State University

Timothy Francisco, Youngstown State University

Jessica Roberts Frazier, George Washington
University

Lisa Myobun Freinkel, University of Oregon

Ari Friedlander, University of Michigan

Laura H. Friedman, University of Virginia

Susan Frye, University of Wyoming

Barbara Fuchs, University of California, Los Angeles

Christina A. Furtado, Fordham University

Evelyn Gajowski, University of Nevada, Las Vegas

Alan Galey, University of Toronto

Laura Gallagher, Queen's University, Belfast

The Bedford Shakespeare Series



Brett Gamboa, Dartmouth College
Marjorie Garber, Harvard University
Sanner Garofalo, University of Birmingham
John Garrison, University of California, Davis
Gayle Gaskill, St. Catherine University
Daniel Gates, Saginaw Valley State University
Marc Geisler, Western Washington University
Edward J. Geisweidt, Wartburg College
Penelope H. Geng, University of Southern California
William Germano, Cooper Union
Indira Ghose, University of Fribourg, Switzerland
Loreen L. Giese, Ohio University
Edward Gieskes, University of South Carolina
Daniel Juan Gil, Texas Christian University
Miriam Gilbert, University of Iowa
Xochitl Gilkeson, University of Wisconsin
Anne M. Gill, King's College London
Melissa Gill, Lynchburg, Virginia
Katherine Gillen, University of New Hampshire
Jason Gleckman, Chinese University of Hong Kong
Maureen Godman, Washburn University
W. L. Godshalk, University of Cincinnati
Rachel Goldberg, Bedford/St. Martin's
David Goldstein, York University
Jose Manuel Gonzalez, Universidad de Alicante
Anne F. Gossage, Eastern Kentucky University
Suzanne Gossett, Loyola University Chicago
Hugh Grady, Arcadia University
Kenneth J. E. Graham, University of Waterloo
Patrick Gray, Yale University
Douglas E. Green, Augsburg College
Stephen Greenblatt, Harvard University
Bradley Greenburg, Northeastern Illinois University
Peter H. Greenfield, University of Puget Sound
Susan Greenhalgh, Roehampton University, London
Juana Green-Nicoletta, Towson University
Blaine Greteman, University of Iowa
Cory Lowell Grewell, Thiel College
Musa Gurnis-Farrell, Columbia University
Stephen Guy-Bray, University of British Columbia

Judith Haber, Tufts University
Imtiaz Habib, Old Dominion University
Lianne Habinek, Bard College
Heidi Brayman Hackel, University of California, Riverside
R. Carter Hailey, College of William and Mary
Alexandra Halasz, Dartmouth College
Graham Hammill, SUNY, Buffalo
Matthew C. Hansen, Boise State University
Elizabeth Hanson, Queen's University
Susan Harlan, Wake Forest University
James L. Harner, World Shakespeare Bibliography
Brian Harries, Concordia University Wisconsin
Fiona J. Harris-Ramsby, University of Utah
Jonathan Gil Harris, George Washington University
Keith Harrison, Vancouver Island University
David Hartwig, Rhodes State College
Elizabeth Harvey, University of Toronto
Kate Sonya Harvey, Trinity College Dublin
Anselm Haverkamp, New York University
David Hawkes, Arizona State University
Michael L. Hays, Las Cruces, New Mexico
Cyndi Marie Headley, University of Arizona
Abigail Heald, Stanford University

Paul Hecht, Purdue University North Central
Pierre Hecker, Carleton College
Donald Hedrick, Kansas State University
Angela Heetderks, University of Michigan
Megan Heffernan, University of Chicago
Jeffrey Paxton Hehmeyer, University of California, Santa Barbara
Rebeca Helfer, University of California, Irvine
Frances Helphinstine, Morehead State University
Diana E. Henderson, Massachusetts Institute of Technology
Margo Hendricks, University of California, Santa Cruz
Trish Thomas Henley, University of Cincinnati
Karen S. Henry, Bedford/St. Martin's
Catherine A. Henze, University of Wisconsin, Green Bay
Niels Herold, Oakland University
Jennifer Higginbotham, Ohio State University
Mike Hirrel, Arlington, Virginia
Brett D. Hirsch, University of Western Australia
Heather Hirschfeld, University of Tennessee, Knoxville
James Hirsh, Georgia State University
Andrew Hiscock, Bangor University, Wales
Nathaniel Hodes, Brandeis University
Barbara Hodgdon, University of Michigan
Elizabeth Hodgson, University of British Columbia
Andreas Höfele, University of Munich
Ton Hoenselaars, University of Utrecht
Lalita Pandit Hogan, University of Wisconsin, La Crosse
Graham Holderness, University of Hertfordshire
Jennifer R. Holl, The Graduate Center, CUNY
Peter Holland, University of Notre Dame
Scott A. Hollifield, University of Nevada, Las Vegas
Marion Hollings, Middle Tennessee State University
Adam G. Hooks, University of Iowa
Jonathan Hope, Strathclyde University
Robert Hornback, Oglethorpe University
Jean E. Howard, Columbia University
Andrew Hui, Stanford University
Maurice Hunt, Baylor University
Elizabeth Hutcheon, University of Chicago
Christine E. Hutchins, Hostos Community College, CUNY
Lorna Hutson, University of St. Andrews

Nicola M. Imbrascio, University of New Hampshire
Jill Phillips Ingram, Ohio University
Grace Ioppolo, University of Reading
Emily Ruth Isaacson, Chowan University

Russell Bennett Jackson, University of Birmingham
Ken R. Jacobsen, Sir Wilfred Grenfell College, Memorial University
Miriam Emma Jacobson, University of Georgia
Heather James, University of Southern California
Trey Jansen, University of Nevada, Reno
Donald Jellerson, Rhodes College
Joseph Jenkins, University of California, Irvine
Michael P. Jensen, Shakespeare Newsletter
Phebe Jensen, Utah State University
Janelle Jenstad, University of Victoria
Kristine Anne Johanson, University of St. Andrews
Mark Johnston, University of Windsor

Please visit
our booth for a
20% discount!

NEW FROM CAMBRIDGE UNIVERSITY PRESS

Actors and Acting in Shakespeare's Time

The Art of Stage Playing

JOHN H. ASTINGTON

\$75.00: Hb: 978-0-521-19250-7: 260 pp.
\$26.99: Pb: 978-0-521-14077-5

Shakespeare, Computers, and the Mystery of Authorship

Edited by HUGH CRAIG *and* ARTHUR F. KINNEY

\$102.00: Hb: 978-0-521-51623-5: 254 pp.

The Struggle for Shakespeare's Text

Twentieth-Century Editorial Theory and Practice

GABRIEL EGAN

\$90.00: Hb: 978-0-521-88917-9: 332 pp.

Shakespeare Survey

Volume 63: Shakespeare's English Histories and their Afterlives

Edited by PETER HOLLAND

Shakespeare Survey

\$115.00: Hb: 978-0-521-76915-0: 444 pp.

Poetry and Paternity in Renaissance England

Sidney, Spenser, Shakespeare, Donne and Jonson

TOM MACFAUL

\$95.00: Hb: 978-0-521-19110-4: 288 pp.

Shakespeare's Errant Texts

Textual Form and Linguistic Style in Shakespearean 'Bad' Quartos and Co-authored Plays

LENE B. PETERSEN

\$95.00: Hb: 978-0-521-76522-0: 336 pp.

Shakespeare's Memory Theatre

Recollection, Properties, and Character

LINA PERKINS WILDER

\$90.00: Hb: 978-0-521-76455-1: 230 pp.

How to Read a Shakespearean Play Text

Edited by EUGENE GIDDENS

\$75.00: Hb: 978-0-521-88640-6: 200 pp.
\$27.99: Pb: 978-0-521-71397-9

The Cambridge Introduction to Shakespeare's Poetry

MICHAEL SCHOENFELDT

Cambridge Introductions to Literature

\$65.00: Hb: 978-0-521-87941-5: 174 pp.
\$19.99: Pb: 978-0-521-70507-3

The Cambridge Companion to English Renaissance Tragedy

Edited by EMMA SMITH *and* GARRETT A. SULLIVAN, JR.

Cambridge Companions to Literature

\$85.00: Hb: 978-0-521-51937-3: 292 pp.
\$29.99: Pb: 978-0-521-73464-6

The Cambridge Companion to the Sonnet

Edited by A. D. COUSINS *and* PETER HOWARTH

Cambridge Companions to Literature

\$80.00: Hb: 978-0-521-51467-5: 296 pp.
\$29.99: Pb: 978-0-521-73553-7

FORTHCOMING IN 2011:

Romantic Tragedies

The Dark Employments of Wordsworth, Coleridge, and Shelley

REEVE PARKER

Cambridge Studies in Romanticism

\$99.00: Hb: 978-0-521-76711-8: 320 pp.

The Myth of Rome in Shakespeare and his Contemporaries

WARREN CHERNAIK

\$90.00: Hb: 978-0-521-19656-7: 312 pp.

The Places of Wit in Early Modern English Comedy

ADAM ZUCKER

\$90.00: Hb: 978-1-107-00308-8: 272 pp.

Shakespeare, Alchemy and the Creative Imagination

The Sonnets and *A Lover's Complaint*

MARGARET HEALY

\$90.00: Hb: 978-1-107-00404-7: 272 pp.

Supernatural Environments in Shakespeare's England

Spaces of Demonism, Divinity, and Drama

KRISTEN POOLE

\$90.00: Hb: 978-1-107-00835-9: 320 pp.



Prices subject to change.



Nick Jones, Oberlin College
 William R. Jones, Murray State University
 John Jowett, University of Birmingham
 William Junker, University of St. Thomas
 Lea Puljcan Juric, New York University

Jeffrey Kahan, University of La Verne
 Coppélia Kahn, Brown University
 Kathleen Kalpin, University of South Carolina,
 Aiken

Peter Kanelos, Loyola University Chicago
 Satyaki Kanjilal, University of Nevada, Reno
 M. Lindsay Kaplan, Georgetown University
 David Kathman, Chicago, Illinois
 Joe Keener, Indiana University, Kokomo
 Rosemary Kegl, University of Rochester
 Katherine Kellett, Boston University
 Charles Adams Kelly, Howland Research
 Erin E. Kelly, University of Victoria
 Erin Katherine Kelly, Ohio State University
 Gillian Murray Kendall, Smith College
 Lloyd Edward Kermode, California State
 University, Long Beach

Bill Kerwin, University of Missouri
 J. Lucinda Kidder, Seattle, Washington
 Douglas J. King, Gannon University
 Emily King, Tufts University
 Clare R. Kinney, University of Virginia
 Peter Kirwan, University of Warwick
 András Kiséry, City College of New York, CUNY
 Aaron Wells Kitch, Bowdoin College
 Adam H. Kitzes, University of North Dakota
 Elizabeth Klett, University of Houston, Clear Lake
 Robert S. Knapp, Reed College
 Richard Knowles, University of Wisconsin, Madison
 Roslyn L. Knutson, University of Arkansas,
 Little Rock

Yu Jin Ko, Wellesley College
 Justin Kolb, University of Minnesota, Morris
 Alysia Kolentsis, Stanford University
 Elizabeth Zeman Kolkovich, Ohio State University
 Matt Kozusko, Ursinus College
 Matthew J. Kubus, The Shakespeare Institute
 Gary Kuchar, University of Victoria
 Jim Kuhn, Folger Shakespeare Library
 Chikako D. Kumamoto, College of DuPage
 Aaron Kunin, Pomona College
 James Kuzner, Case Western Reserve University

James H. Lake, Louisiana State University,
 Shreveport

Julian Lamb, Chinese University of Hong Kong
 Mary Ellen Lamb, Southern Illinois University
 Kathryn Lamoreaux, Battle Ground High School
 Anne Lancashire, University of Toronto
 Jesse M. Lander, University of Notre Dame
 Jessica Landis, University of Massachusetts
 Sarah Langan, Oregon Shakespeare Festival
 Douglas M. Lanier, University of New Hampshire
 Carol Mejia Laperle, Wright State University
 Rebecca Laroche, University of Colorado,
 Colorado Springs

Katherine R. Larson, University of Toronto
 Caroline Dodge Latta, Columbia College, Chicago
 Kathy M. Lavezzo, University of Iowa

Sean Lawrence, University of British Columbia,
 Okanagan

Jenna Lay, Lehigh University
 Courtney Lehmann, University of the Pacific
 Kent R. Lehnhof, Chapman University
 Jasmine S. Lellock, University of Maryland
 Hannah Lemberg, San Francisco, California
 Rebecca Lemon, University of Southern California
 Allison Kellar Lenhardt, University of Georgia
 Patricia Lennox, New York University
 Kendra Preston Leonard, Westminster Choir
 College of Rider University

Nathaniel C. Leonard, University of Massachusetts
 John Lepage, Vancouver Island University
 Seth Lerer, University of California, San Diego
 Jason Leubner, University of Texas, Austin
 Richard Levin, University of California, Davis
 Laura Levine, New York University
 Jemma Alix Levy, Mary Baldwin College
 Naomi Conn Liebler, Montclair State University
 Erika T. Lin, George Mason University
 Sandra Lindberg, Illinois Wesleyan University
 James Loehlin, University of Texas, Austin
 Sonya Loftis, Morehouse College
 Zachariah C. Long, Ohio Wesleyan University
 Donna J. Long, Fairmont State University
 Catherine Loomis, University of New Orleans
 Jeremy Lopez, University of Toronto
 Rory Loughnane, Trinity College, Dublin
 Genevieve Love, Colorado College
 Jennifer A. Low, Florida Atlantic University
 Eleanor Lowe, Oxford Brookes University
 Christina Luckyj, Dalhousie University
 Julia Reinhard Lupton, University of California,
 Irvine

Sara D. Luttfriing, University of Illinois, Urbana-
 Champaign

Kathleen Lynch, Folger Shakespeare Library
 Tara Lynn Lyons, University of Illinois, Urbana-
 Champaign

Hilda H. Ma, Saint Mary's College of California
 Julia Elizabeth MacDonald, University of North
 Texas

Shawn A. MacDonald, Bob Jones University
 Ian MacInnes, Albion College
 Lairy Magnus, United States Merchant Marine
 Academy

Lynne Magnusson, University of Toronto
 Josh Magsam, University of Oregon
 Laurie Maguire, Oxford University
 John Mahon, Iona College
 Scott Maisano, University of Massachusetts, Boston
 Julia Major, University of Washington
 Jessica Lin Malay, University of Huddersfield
 Cristina Malcolmson, Bates College
 Elizabeth Malson-Huddle, University of Wisconsin,
 Platteville

Lawrence Manley, Yale University
 Jenny Mann, Cornell University
 Howard Marchitello, Rutgers University
 James Mardock, University of Nevada
 Jelena Marelj, Queen's University
 James J. Marino, Cleveland State University
 Zoltán Márkus, Vassar College

New from **OXFORD**

Visit the Oxford booth to save on these and other titles.



Cultural Reformations

Medieval and Renaissance in Literary History

Edited by BRIAN CUMMINGS and JAMES SIMPSON
(Oxford Twenty-First Century Approaches to Literature)

2010 540 pp. 5 illus. Hardback \$160.00

Writing and Reading Royal Entertainments

From George Gascoigne to Ben Jonson

GABRIEL HEATON

2010 272 pp. 10 illus. Hardback \$99.00

The Oxford Handbook of Edmund Spenser

Edited by RICHARD A. MCCABE

(Oxford Handbooks)

2011 648 pp. 23 illus. Hardback \$150.00

Erotic Subjects

The Sexuality of Politics in Early Modern English Literature

MELISSA E. SANCHEZ

2011 304 pp. Hardback \$74.00

Reading Masques

The English Masque and Public Culture in the Seventeenth Century

LAUREN SHOHEIT

2011 240 pp. 9 illus., 7 music ex. Hardback \$99.00

In Defiance of Time

Antiquarian Writing in Early Modern England

ANGUS VINE

2010 264 pp. 12 illus. Hardback \$110.00

:: OXFORD SHAKESPEARE TOPICS ::

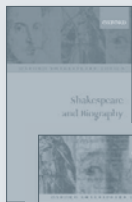

Shakespeare and Biography

DAVID BEVINGTON

2010 192 pp.
Hardback \$45.00 Paperback \$24.95

Shakespeare and Literary Theory

JONATHAN GIL HARRIS

2010 216 pp.
Hardback \$45.00 Paperback \$24.95

:: New in PAPERBACK ::

Writing after Sidney

The Literary Response to Sir Philip Sidney 1586-1640

GAVIN ALEXANDER

2010 424 pp. 3 illus. Paperback \$55.00

Archipelagic English

Literature, History, and Politics 1603-1707

JOHN KERRIGAN

2010 599 pp. 18 illus. Paperback \$29.95

Shakespeare in Parts

SIMON PALFREY and TIFFANY STERN

2011 560 pp. 4 illus. Paperback \$27.95

Thomas Middleton

The Collected Works

Edited by GARY TAYLOR and JOHN LAVAGNINO

2010 2018 pp. 80 illus. Paperback \$45.00

Passion's Triumph over Reason

A History of the Moral Imagination from Spenser to Rochester

CHRISTOPHER TILMOUTH

2011 432 pp. Paperback \$50.00

The English Renaissance Stage

Geometry, Poetics, and the Practical Spatial Arts 1580-1630

HENRY S. TURNER

2011 344 pp. 27 illus. Paperback \$50.00

Shakespeare, Sex, and Love

STANLEY WELLS

2010 228 pp. 25 illus. Hardback \$27.95

Passing Strange

Shakespeare, Race, and Contemporary America

AYANNA THOMPSON

2011 256 pp. 21 illus. Hardback \$55.00

Forthcoming in July!

The Oxford Handbook of Shakespeare

Edited by ARTHUR F. KINNEY

(Oxford Handbooks)

2011 680 pp. 23 illus. Hardback \$150.00

www.oup.com/us

OXFORD
UNIVERSITY PRESS

Karen Sawyer Marsalek, St. Olaf College, Northfield

Gail Marshall, University of Leicester

Darragh Gerard Martin, Columbia University

Randall Martin, University of New Brunswick

Ann Martinez, University of Kansas

Jeffrey Masten, Northwestern University

Maya Mathur, University of Mary Washington

Christopher Matusiak, University of Toronto

Margaret Maurer, Colgate University

Cary M. Mazer, University of Pennsylvania

Kris McAbee, University of Arkansas, Little Rock

Jessica McCall, University of Nevada, Las Vegas

Andrew D. McCarthy, University of Tennessee, Chattanooga

Erin Ann McCarthy, Ohio State University

Jeanne H. McCarthy, Oglethorpe University

Penny McCarthy, University of Glasgow

Janie Caves McCauley, Greenville, South Carolina

Sheri McCord, Saint Louis University

Jennifer Rae McDermott, University of Toronto

Russ McDonald, Goldsmiths College, University of London

Claire McEachern, University of California, Los Angeles

Cory McElaney, Brown University

E. K. McFall, University of Washington

David McInnes, University of Melbourne

Linda McJannet, Bentley University

Roderick McKeown, University of Toronto

Gordon McMullan, King's College London

Cameron Hunt McNabb, University of South Florida

Kate McPherson, Utah Valley University

Nedda Mehdizadeh, George Washington University

Barbara Mello, University of Southern California

Kirk Melnikoff, University of North Carolina, Charlotte

Madhavi Menon, American University

Paul Menzer, Mary Baldwin College

Mary Janell Metzger, Western Washington University

Allison Machlis Meyer, Assumption College

Bernadette Meyler, Cornell University

Irene Middleton, Georgia Institute of Technology

Nichole E. Miller, Temple University

Erin Kathleen Minear, College of William and Mary

Gretchen E. Minton, Montana State University

Robert S. Miola, Loyola University Maryland

Bella Mirabella, New York University

John Mitchell, Oakland Community College

Alfredo Michel Modenessi, Universidad Nacional Autónoma de México

Zsolt Mohi, University of Kansas

Kathryn M. Moncrief, Washington College

Gaywyn Moore, University of Kansas

Martin Moraw, Brandeis University

Ruth Morse, Université Paris Diderot

Nick Moschovakis, Washington, DC

Daniel D. Moss, Southern Methodist University

Ian Frederick Moulton, Arizona State University

Barbara A. Mowat, Folger Shakespeare Library

John M. Mucciolo, Glen Ridge Public Schools

Rolf O. Mueller, Fanny-Leicht-Gymnasium, Stuttgart

Subha Mukherji, University of Cambridge

Steven Mullaney, University of Michigan

Richelle Munkhoff, University of Colorado, Boulder

Ian Munro, University of California, Irvine

Lucy Munro, Keele University

Jennifer A. Munroe, University of North Carolina, Charlotte

Rebecca Munson, University of California, Berkeley

Ineke Murakami, University at Albany, SUNY

Jessica C. Murphy, University of Texas, Dallas

Heather J. Murray, Pennsylvania State University

Anne M. Myers, University of Missouri

Nova Myhill, New College of Florida

Vin Nardizzi, University of British Columbia

Bernice Neal, York University

Carol Neely, University of Illinois, Urbana-Champaign

Kelly M. Neil, University of California, Davis

Alan H. Nelson, University of California, Berkeley

Sarah J. Neville, Indiana University-Purdue University, Indianapolis

Lori Humphrey Newcomb, University of Illinois, Urbana-Champaign

Harry Rex Newman, University of Birmingham

Karen Newman, Brown University

Catherine Nicholson, Yale University

Kim Noling, Hartwick College

Kara Northway, Kansas State University

Michael Noschka, Arizona State University

Marianne Novy, University of Pittsburgh

Marion F. O'Connor, University of Kent

Sharon O'Dair, University of Alabama

Elisa Oh, Howard University

Gloria Olchowy, Grant MacEwan College

Niamh J. O'Leary, Xavier University

Sarah E. Olive, University of York

Julie Ollmann, Green Bay, Wisconsin

Rebecca Olson, Oregon State University

Susan G. O'Malley, City University of New York

Fionnuala Ruth Clara O'Neill, University of Edinburgh

Stephen Orgel, Stanford University

Lena Cowen Orlin, Georgetown University

James N. Ortego, Troy University, Dothan

Joseph M. Ortiz, SUNY, Brockport

David L. Orvis, Appalachian State University

Margaret Owens, Nipissing University

Bethany M. Packard, Vanderbilt University

Simon Palfrey, Brasenose College Oxford

Philip S. Palmer, University of Massachusetts, Amherst

Matteo Pangallo, University of Massachusetts, Amherst

Jennifer M. Park, University of North Carolina

Elinor Parsons, De Montfort University

Vimala C. Pasupathi, Hofstra University

Anthony Guy Patricia, University of Nevada, Las Vegas

J. Gavin Paul, University of British Columbia

Ryan Singh Paul, Allegheny College

Julie Paulson, San Francisco State University

Meg F. Pearson, University of West Georgia

Ed Pechter, University of Victoria

Tara Elizabeth Pedersen, Sonoma State University

Elizabeth Pentland, York University

VISIT PALGRAVE MACMILLAN AT OUR BOOTH!

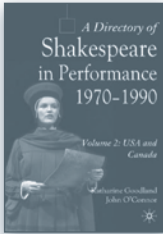

A DIRECTORY OF SHAKESPEARE IN PERFORMANCE, 1970-2005
Volume 1, Great Britain
 John O'Connor
 2007 / 1760 pp.
 ISBN: 978-1-4039-1734-8
 \$275.00 hc. (C\$332.00)

A DIRECTORY OF SHAKESPEARE IN PERFORMANCE 1970-1990
Volume 2, USA and Canada
 Katharine Goodland and John O'Connor
 2011 / 1762 pp.
 ISBN: 978-0-230-54677-6
 \$275.00 hc. (C\$332.00)

A DIRECTORY OF SHAKESPEARE IN PERFORMANCE SINCE 1991
Volume 3, USA and Canada
 Katharine Goodland and John O'Connor
 2011 / 1762 pp.
 ISBN: 978-0-230-22397-4
 \$275.00 hc. (C\$316.00)

IMAGE ETHICS IN SHAKESPEARE AND SPENSER
 James A. Knapp
 2011 / 244 pp.
 ISBN: 978-0-230-10809-7
 \$85.00 hc. (C\$98.00)

SHAKESPEARE STUDIES TODAY
Romanticism Lost
 Edward Pechter
 June 2011 / 240 pp.
 ISBN: 978-0-230-11419-7
 \$85.00 hc. (C\$98.00)

SHAKESPEAREAN NEUROPLAY
Reinvigorating the Study of Dramatic Texts and Performance through Cognitive Science
 Amy Cook
Cognitive Studies in Literature and Performance
 September 2010 / 296 pp.
 ISBN: 978-0-230-10547-8
 \$75.00 hc. (C\$86.00)

THE LAW IN SHAKESPEARE
 Edited by Karen Cunningham and Constance Jordan
Early Modern Literature in History
 August 2010 / 296 pp.
 ISBN: 978-0-230-24772-7
 \$30.00 pb. (C\$36.00)

ECOCRITICISM AND SHAKESPEARE
Reading Ecophobia
 Simon C. Estok
Literatures, Cultures, and the Environment
 April 2011 / 192 pp.
 ISBN: 978-0-230-11256-8
 \$80.00 hc. (C\$92.00)

KNOWING SHAKESPEARE
Senses, Embodiment and Cognition
 Edited by Shankar Raman and Lowell Gallagher
Palgrave Shakespeare Studies
 2010 / 256 pp.
 ISBN: 978-0-230-27561-4
 \$80.00 hc. (C\$92.00)

SHAKESPEARE AND THE INSTITUTION OF THEATRE
The Best in this Kind
 Erica Sheen
Palgrave Shakespeare Studies
 2009 / 256 pp.
 ISBN: 978-0-230-52480-4
 \$80.00 hc. (C\$92.00)

SHAKESPEARE IN TRANSITION
Political Appropriations in the Postcommunist Czech Republic
 Marcela Kostihova
Performance Interventions
 November 2010 / 240 pp.
 ISBN: 978-0-230-20324-2
 \$80.00 hc. (C\$92.00)

SHAKESPEARE: A MIDSUMMER NIGHT'S DREAM
 Nicolas Tredell
Readers' Guides to Essential Criticism
 May 2010 / 192 pp.
 ISBN: 978-0-230-23879-4
 \$23.00 pb. (C\$28.00)

EXTRAMURAL SHAKESPEARE
 Denise Albanese
Reproducing Shakespeare
 2010 / 196 pp.
 ISBN: 978-0-230-10513-3
 \$75.00 hc. (C\$86.00)

SHAKESPEARE AND HIS CONTEMPORARIES
 Jonathan Hart
 2011 / 268 pp.
 ISBN: 978-0-230-10509-6
 \$85.00 hc. (C\$98.00)

THE ARTISTIC LINKS BETWEEN WILLIAM SHAKESPEARE AND SIR THOMAS MORE
Radically Different Richards
 Charles A. Hallett and Elaine S. Hallett
 June 2011 / 304 pp.
 ISBN: 978-0-230-11367-1
 \$85.00 hc. (C\$98.00)

STUDYING SHAKESPEARE IN PERFORMANCE
 John Russell Brown
 June 2011 / 224 pp.
 ISBN: 978-0-230-27374-0
 \$30.00 pb. (C\$34.00)

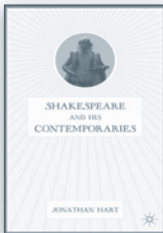
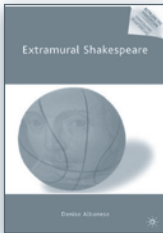

palgrave
macmillan

Distributor of Berg Publishers, I.B.Tauris,
 Manchester University Press, Pluto Press and Zed Books
 (888) 330-8477 • Fax: (800) 672-2054 • www.palgrave.com

Jesús Tronch Pérez, Universitat de València
 Tony Perrello, California State University,
 Stanislaus
 Robert B. Pierce, Oberlin College
 Stephanie Pietros, Fordham University
 Tripti Pillai, Coastal Carolina University
 Kyle A. Pivetti, University of California, Davis
 Peter G. Platt, Barnard College
 Daniel Pollack-Pelzner, Linfield College
 Kristen Kayem Polster, University of North Texas
 Kristen Poole, University of Delaware
 Richard Preiss, University of Utah
 Maria Teresa Prendergast, College of Wooster
 Erin Presley, University of Georgia
 Kendrick Prewitt, University of West Alabama
 Eoin Price, The Shakespeare Institute
 Kathryn Prince, University of Ottawa
 Anna M. Pruitt, University of California, Davis
 Stephen Purcell, Southampton Solent University

Kevin A. Quarmby, Shakespeare's Globe, London
 Kirk Quinsland, Fordham University

Phyllis Rackin, University of Pennsylvania
 Nicholas Radel, Furman University
 Shankar Raman, Massachusetts Institute of
 Technology
 William Reginald Rampone, Jr., South Carolina
 State University
 Sarah D. Rasher, University of Connecticut, Storrs
 Eric Rasmussen, University of Nevada
 Bill Rauch, Oregon Shakespeare Festival
 Terry Reilly, University of Alaska
 Cody Reis, New York University
 Hugh Macrae Richmond, University of California
 Velma Bourgeois Richmond, Holy Names University
 Elizabeth J. Rivlin, Clemson University
 Jennifer Roberts-Smith, University of Waterloo
 Benedict S. Robinson, Stony Brook University
 Marsha S. Robinson, Kean University
 Joanne Rochester, University of Saskatchewan
 Edward L. Rocklin, California State Polytechnic
 University, Pomona
 Amy J. Rodgers, Rhode Island College
 Joel Rodgers, University of Toronto
 Colleen Rosenfeld, Pomona College
 Katherine Rowe, Bryn Mawr College
 Suparna Roychoudhury, Harvard University
 Marjorie Rubright, University of Toronto
 Jennifer R. Rust, Saint Louis University
 Craig M. Rustici, Hofstra University
 Bradley David Ryner, Arizona State University

Carolyn Sale, University of Alberta
 Duncan Salkeld, University of Chichester
 Denis Salter, McGill University
 Melissa Sanchez, University of Pennsylvania
 Julie Sanders, University of Nottingham
 Rhonda Lemke Sanford, Fairmont State University
 Kathryn Vomero Santos, New York University
 Debapriya Sarkar, Rutgers University
 Karen Saupe, Calvin College
 Robert Sawyer, East Tennessee State University
 Joan Saxton, San Francisco, California
 David Schalkwyk, Folger Shakespeare Library

Katherine Scheil, University of Minnesota
 Gregory M. Schnitzspahn, Tufts University
 Richard Schoch, Queen Mary, University of London
 Michael Schoenfeldt, University of Michigan
 J. Dean Schroll, Redmond, Washington
 Melissa Schubert, Claremont Graduate University
 Anne-Marie E. Schuler, Ohio State University
 Sabine Schülting, Freie Universität Berlin
 Dana Schumacher-Schmidt, University of
 Minnesota, Twin Cities
 Kathryn Schwarz, Vanderbilt University
 Charlotte Scott, Goldsmiths College, University
 of London
 William O. Scott, University of Kansas
 Amy Scott-Douglass, Marymount University
 Barbara Sebek, Colorado State University
 Tracey Sedinger, University of Northern Colorado
 Nancy Selleck, University of Massachusetts, Lowell
 Amrita Sen, Michigan State University
 Deneen M. Senasi, Mercer University
 Gitanjali Shahani, San Francisco State University
 Will Sharpe, University of Leeds
 Philippa Sheppard, University of Toronto
 Emily Sherwood, The Graduate Center, CUNY
 Xiaoli Shi, Northern Arizona University
 Heiwon Shin, North Greenville University
 Stephanie Shine, Seattle Shakespeare Company
 Sherry Shuman, Morgantown, West Virginia
 Michael W. Shurgot, South Puget Sound
 Community College
 James Siemon, Boston University
 Marilyn Simon, University of Toronto
 Jerome Singerman, University of Pennsylvania
 Press
 Jonathan Sircy, University of South Carolina
 P. A. Skantze, Roehampton University
 Meredith Skura, Rice University
 Jessica Slight, Acadia University
 William W. E. Slight, University of Saskatchewan
 Emily Sloan-Pace, University of California,
 Santa Cruz
 Joel Elliot Slotkin, Towson University
 Bruce R. Smith, University of Southern California
 Ian Smith, Lafayette College
 Matthew Smith, University of Southern California
 Adam Smyth, Birkbeck College, University of
 London
 Ameer Sohrawardy, Rutgers University
 Geraldo U. de Sousa, University of Kansas
 Eric Spencer, College of Idaho
 Stephen Spiess, University of Michigan
 John D. Staines, John Jay College, CUNY
 Audrey E. Stanley, University of California,
 Santa Cruz
 Kay Stanton, California State University, Fullerton
 Sarah Stanton, Cambridge University Press
 Kristiane R. Stapleton, University of Wisconsin
 Lisa S. Starks-Estes, University of South Florida,
 St. Petersburg
 Janet Wright Starner, Wilkes University
 Jeff Steele, Principia College
 Matthew Steggel, Sheffield Hallam University
 Mary Steible, Southern Illinois University,
 Edwardsville
 Jennifer Steigerwalt, Arizona State University

Annette Stenning, Simon Fraser University
Tiffany Stern, Oxford University
Andrea Stevens, University of Illinois, Urbana-
Champaign
Alan Stewart, Columbia University
William Stockton, Clemson University
Abraham Stoll, University of San Diego
Virginia Lee Strain, Washington University
Marta Straznicky, Queen's University
W. R. Streitberger, University of Washington
Robert E. Stretter, Providence College
Richard Strier, University of Chicago
Elizabeth M. Sturgeon, Mount St. Mary's College
Erin Marie Sullivan, University College London
Garrett Sullivan, Pennsylvania State University
David Summers, Capital University
Andrea Sununu, DePauw University
Alicia Sutliff-Benusis, University of Kansas
Joyce Sutphen, Gustavus Adolphus College
David Swain, Southern New Hampshire University
Holger Syme, University of Toronto
Karoline Szatek-Tudor, Curry College

Ramie Targoff, Brandeis University
Patricia Tatspaugh, London, United Kingdom
Gary Taylor, Florida State University
Verena Theile, North Dakota State University
Jeffrey Theis, Salem State University
Catherine Thomas, College of Charleston
Ann Thompson, King's College, University
of London
Ayanna Thompson, Arizona State University
Sarah E. Thompson, University of Maryland
Leslie Thomson, University of Toronto
Aaron Thurow, University of Texas, Austin
Amy L. Tigner, University of Texas, Arlington
Alicia V. Tomasian, William Rainey Harper College
Jennifer Toms, Michigan State University
Barbara H. Traister, Lehigh University
Jeanette NguyenTran, University of Wisconsin
Valerie Traub, University of Michigan
Linda Tredennick, Gonzaga University
Douglas Trevor, University of Michigan
Evelyn Tribble, University of Otago
Andrea F. Trocha-Van Nort, United States Air
Force Academy
Scott A. Trudell, Rutgers University
Mary Trull, St. Olaf College
Andrew Tumminia, Spring Hill College
Henry S. Turner, Rutgers University
Timothy A. Turner, University of Texas, Austin

Deborah Uman, St. John Fisher College
Steven Urkowitz, City College of New York
Michael Ursell, University of California, Santa Cruz

Martine van Elk, California State University,
Long Beach
Jacqueline Vanhoutte, University of North Texas
Richard van Oort, University of Victoria
Christine Varnado, Columbia University

Denise A. Walen, Vassar College
Wendy Wall, Northwestern University

Sarah Wall-Randell, Wellesley College
Melissa Walter, University of the Fraser Valley
Jane Wanninger, Vanderbilt University
Yolana Wassersug, The Shakespeare Institute
Leila Ruth Watkins, University of Michigan
Robert N. Watson, University of California,
Los Angeles
Geoffrey Way, Arizona State University
Valerie Wayne, University of Hawai'i
Herb Weil, University of Manitoba, Victoria
Judith Weil, University of Manitoba, Victoria
Don Weingust, Center for Shakespeare Studies
Larry Weiss, Statesboro, Georgia
James Wells, Muskingum University
Sarah Werner, Folger Shakespeare Library
Paul Werstine, University of Western Ontario
Tiffany Werth, Simon Fraser University
William N. West, Northwestern University
Helen M. Whall, College of the Holy Cross
D. Jerry White, University of Central Missouri
Charles Whitney, University of Nevada, Las Vegas
H. Austin Whitver, University of Alabama
Lina Perkins Wilder, Connecticut College
Kathryn Will, University of Michigan
Deanne Williams, York University
George W. Williams, Duke University
Katherine Schaap Williams, Rutgers University
Sarah Williams, University of South Carolina
Travis D. Williams, University of Rhode Island
Elizabeth Williamson, Evergreen State College
Rachel Willie, University of York
Brian Willis, Los Angeles, California
Deborah Willis, University of California, Riverside
Luke Wilson, Ohio State University
Amanda Eubanks Winkler, Syracuse University
Michael Witmore, University of Wisconsin
Susanne L. Wofford, New York University
Timothy Michael Wong, University of California,
Irvine
Celest Woo, SUNY, Empire State College
David H. Wood, Northern Michigan University
Jennifer Linhart Wood, George Washington
University
Donna Woodford-Gormley, New Mexico Highlands
University
W. B. Worthen, Barnard College
Ramona Wray, Queen's University, Belfast
George T. Wright, University of Minnesota
Jacqueline Wylde, University of Toronto
Marion Wynne-Davies, University of Surrey

Paul Yachnin, McGill University
Jayme Yeo, Rice University
Mimi Yiu, Georgetown University
James J. Yoch, University of Oklahoma

Timothy Zajac, University of Massachusetts,
Amherst
Rachel Zlatkin, University of Cincinnati
Adam Zucker, University of Massachusetts
Ryan Zurowski, Stanford University
Jay Zysk, Brown University



W UNIVERSITY of WASHINGTON

College of Arts and Sciences

Discovers, preserves, and transmits fundamental knowledge in the arts, humanities, natural, and social sciences

Simpson Center for the Humanities

Fosters creative research and teaching through an array of activities, including fellowship support, cross disciplinary collaborations, conferences, and publicly-engaged projects

Department of English

Offers undergraduate and graduate instruction in the language and literature of Great Britain and the United States and in Anglophone literature from around the world, leading to the BA, MA, MAT, MAT (EOSL), MFA, and PhD

Proud Sponsors of the 2011 Meeting of
The Shakespeare Association of America



THE SHAKESPEARE
ASSOCIATION
OF AMERICA

Department of English
Georgetown University
37th and O Streets, N.W.
Washington, D.C. 20057-1131

PHONE: 202.687.6315

FAX: 202.687.5445

E-MAIL: shakespeare@georgetown.edu

WEB: www.ShakespeareAssociation.org

Shakespeare