

Program of the *26th Annual Meeting*

18-21 MARCH 1998

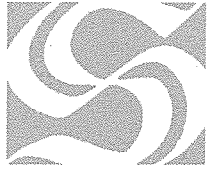

THE SHAKESPEARE
ASSOCIATION
OF AMERICA

University of Maryland,
Baltimore County
1000 Hilltop Circle
Baltimore, Maryland
21250

PHONE: 410-455-6788
FAX: 410-455-1063
E-MAIL: saa@umbc.edu

The
Shakespeare
Association

of
America

Renaissance Cleveland Hotel

Cleveland, Ohio

The Shakespeare Association of America

Executive Director: LENA COWEN ORLIN
University of Maryland, Baltimore County

President

MARY BETH ROSE
University of Illinois at Chicago

Vice-President

JAMES C. BULMAN
Allegheny College

Trustees

A. R. BRAUNMULLER
University of California, Los Angeles

WILLIAM C. CARROLL
Boston University

FRANCES E. DOLAN
Miami University

MARGARET FERGUSON
University of California, Davis

ARTHUR F. KINNEY
University of Massachusetts, Amherst

RUSS McDONALD
University of North Carolina, Greensboro

BARBARA MOWAT
Folger Shakespeare Library

SPONSORS OF THE 26TH ANNUAL MEETING

University of Akron
Allegheny College
Baldwin-Wallace College
Bowling Green State University College of Arts and Sciences
Bowling Green State University Office of the President
Bowling Green State University Office of the Provost
BP America
Case Western Reserve University Baker-Nord Center for the Humanities
Case Western Reserve University College of Arts and Sciences
Case Western Reserve University Department of English
Cleveland State University College of Arts and Sciences
Cleveland State University Department of English
University of Dayton English Department
Duquesne University
Robert Fleissner
Gannon University
Hiram College
John Carroll University
Kent State University Department of Theatre and Dance
Kent State University Office of the Dean of the College of Arts and Sciences
Kent State University Office of the President
Kent State University Office of the Provost
Kent State University Research and Graduate Studies
Kent State University Department of English Richard A. Toerne Endowment
Kent State University Trumbull Campus
Kent State University Vice-Provost for Regional Campuses
Kenyon College
Miami University
Oberlin College
Ohio Northern University
Ohio State University
Ohio University
Plain Dealer Charities
Brownell Salomon
Patricia Salomon
University of Toledo Department of English
University of Toledo Department of Theatre and Film
Wright State University
Youngstown State University College of Arts and Sciences and Department of English
Youngstown State University Provost's Office
and
University of Maryland, Baltimore County

Announcements

Our Cleveland hosts invite us to a buffet dinner in the Cleveland Arcade on the occasion of the Annual Reception, Thursday evening. Various catering stations will offer pasta, Tex-Mex dishes, crudités, and desserts, among other comestibles. There will be a full bar, featuring Great Lakes keg beer, and musical entertainment. The Arcade is a short walk from the Superior Street entrance of the Renaissance Cleveland Hotel, but a shuttle bus will be available for those requiring assistance.

Thanks again to our local hosts, the Friday-evening performance of *Hamlet* is free to conference registrants. The performance will take place on the campus of Cleveland State University in a 375-seat theatre. Attendance is first-come, first-seated. Buses load at the Superior Street entrance of the Renaissance Hotel from 7:00 p.m. Campus geography prevents delivery to the door, but students will be available to direct SAA members to the theatre via various stairs and elevators. Coffee and pastries will be on sale for those who have cut their dinner hours short in honor of the production.

The Saturday-evening concert, *The Food of Love*, is hosted by Case Western Reserve University as part of the early music concert series "Chapel, Court, and Countryside." Those who have not yet secured tickets may check the registration table for additional availability. Buses load at the Superior Street entrance of the Renaissance Hotel from 7:15 p.m. Concert-goers planning to travel by taxi are advised to book ahead with a local cab company, especially for the return at around 10:00 p.m.

On Friday and Saturday between 10:00 a.m. and 4:00 p.m., two Baldwin-Wallace College vans will provide continuous shuttle service to areas of interest to SAA members. The University Circle shuttle, visiting the Cleveland Museum of Art, the Museum of Natural History, the Western Reserve Historical Society, the Omni Hotel, and Glidden House, will depart from the Superior Street entrance of the hotel every hour on the hour. The Lakefront shuttle, serving the Rock and Roll Hall of Fame and the Great Lakes Science Center, will depart from the Superior Street entrance of the hotel every half-hour on the half-hour. Shuttle drivers will have information on scheduled returns.

Visitors to the Cleveland Museum of Art should be advised that the special exhibition of "Vatican Treasures" is viewable by ticket only. To secure tickets, phone 1-888-262-0033 or 216-421-7350.

SAA members will also want to watch for information sheets with dining suggestions, available at the registration tables, and for the Official T-Shirt of the Cleveland meeting, on sale in the Exhibit area in the Whitehall Room of the Renaissance Hotel.

Local Arrangements Committee

TOM BISHOP, Case Western Reserve University
 DAVID EVETT, Cleveland State University
 MEGAN L. ISAAC, Youngstown State University
 SUSAN OLDRIEVE, Baldwin-Wallace College
 ROBERT B. PIERCE, Oberlin College
 CHRISTOPHER ROARK, John Carroll University
 M. RICK SMITH, Kent State University
 ELLEN SUMMERS, Hiram College

Program Committee

Chair: PAUL WERSTINE, King's College, University of Western Ontario
 JOHN COX, Hope College
 CLAIRE MCEACHERN, University of California, Los Angeles
 LOIS POTTER, University of Delaware

Program Guide

Wednesday, 18 March

		Page
9:00 a.m.	Teaching Workshop in the <i>Mather Mansion, Cleveland State University</i> : The Doors are Open: Teaching <i>Macbeth</i> through Performance	6

Thursday, 19 March

11:30 a.m.	Registration and Exhibits Open in the <i>Assembly Area and Whitehall Room</i>	6
12:00 p.m.	Performance and Workshop in the <i>Exhibit Hall</i> : Cleveland Signstage Theatre	6
2:30 p.m.	Paper Session in the <i>Gold Room</i> : Pleasures of the Eye and Ear	7
	Paper Session in the <i>Exhibit Hall</i> : Youth, On Stage and Off	7
4:00 p.m.	Seminar in the <i>Rockefeller Board Room</i> : Shakespeare's Verse	7
	Seminar in the <i>Case Room</i> : Shakespeare and Children's Literature	8
	Seminar in the <i>Stouffer Board Room</i> : Writing about Performance	8
	Seminar in the <i>Garfield Room</i> : Women and Early Modern Theatrical Production	8
	Seminar in the <i>Halle Room</i> : WonderWoman: The Female Tragic Hero in the Plays of Shakespeare and his Contemporaries	9
	Seminar in the <i>Humphrey Room</i> : Speculations in Shakespeare: Appropriation and Audiences, 1623-1800	9
	Seminar in the <i>Carnegie Board Room</i> : Reconsidering <i>Henry IV, Part Two</i>	9
	Seminar in the <i>Blossom Room</i> : The '60s and '70s Revisited	10
	Seminar in the <i>Van Aken Room</i> : Kinship and Renaissance Drama	10
	Seminar in the <i>George Bush Room</i> : Convention and Invention: The Filmed <i>Hamlets</i>	10
	Workshop in the <i>Severance Room</i> : Preparation and Reading of <i>Measure for Measure</i>	11
7:00 p.m.	Opening Reception in <i>The Cleveland Arcade</i>	11

Friday, 20 March

8:00 a.m.	Continental Breakfast for Graduate Students on the <i>Grand Ballroom Balcony</i>	12
9:00 a.m.	Plenary Session in the <i>Grand Ballroom</i> : Memory and the Making of History	12
11:00 a.m.	Paper Session in the <i>Ambassador Ballroom</i> : Shakespeare and the Politics of the Curriculum	13
	Paper Session in the <i>Gold Room</i> : The Text and the Stage	13
1:00 p.m.	Annual Luncheon in the <i>Grand Ballroom</i>	13
3:30 p.m.	Open Rehearsal in the <i>Gold Room</i> : Cincinnati Shakespeare Festival	14
	Seminar in the <i>Humphrey Room</i> : Citing Shakespeare in American Popular Culture	14
	Seminar in the <i>Wade Room</i> : The "Bad Quartos": Text into Performance	14
	Seminar in the <i>Carnegie Board Room</i> : Shakespeare and the Ethics of Historiography	15
	Seminar in the <i>Rockefeller Board Room</i> : Early Modern Print Culture: From "Riffe-raffe" Books to Crown Paper	15
	Seminar in the <i>Holden Room</i> : Narratives and Narrativity in Elizabethan Chronicle History Plays	15

Program Guide, continued for Friday, 20 March

3:30 p.m.	Seminar in the <i>Blossom Room</i> : Addressing the Envelope: More on Shakespeare and Address	16
	Seminar in the <i>Halle Room</i> : Shakespeare and China: From Hakluyt's Cathay to Deng Xiaoping's China	16
	Seminar in the <i>Garfield Room</i> : The Epistemology of Place in Early Modern Culture	16
	Seminar in the <i>Case Room</i> : Domesticities / Sexualities / Work	17
	Seminar in the <i>Van Aken Room</i> : Kinship and Renaissance Drama	17
	Seminar in the <i>Stouffer Board Room</i> : Shakespeare and the Victorians	17
	Workshop in the <i>George Bush Room</i> : Teaching Shakespeare with Technology	18
	Workshop in the <i>Severance Room</i> : Preparation and Reading of <i>Measure for Measure</i>	18
8:00 p.m.	Performance in the <i>Cleveland State University Main Classroom Auditorium</i> : <i>Hamlet</i>	18

Saturday, 21 March

9:00 a.m.	Paper Session in the <i>Ambassador Ballroom</i> : Seeing <i>Hamlet</i> Everywhere: Mapping a Paratext	19
	Paper Session in the <i>Gold Room</i> : The Electronic Text as a Tool in Research and Teaching	19
11:00 a.m.	Paper Session in the <i>Ambassador Ballroom</i> : Beyond Foucault and Laqueur: The Uses of Early Modern Medical Texts	20
	Paper Session in the <i>Gold Room</i> : Cultural Materialism and Performance	20
2:00 p.m.	Paper Session in the <i>Ambassador Ballroom</i> : Biography in the Archives	21
	Paper Session in the <i>Gold Room</i> : Shakespeare and the Culture of Rock and Roll	21
4:00 p.m.	Open Rehearsal in the <i>Gold Room</i> : Cincinnati Shakespeare Festival	21
	Seminar in the <i>George Bush Room</i> : Early Modern Women Writers and Genre	22
	Seminar in the <i>Case Room</i> : Writing for the Private Theatre: Shakespeare's Non-Dramatic Poems	22
	Seminar in the <i>Holden Room</i> : New Perspectives and Contexts for the First Tetralogy and <i>Edward III</i>	22
	Seminar in the <i>Humphrey Room</i> : Shakespeare on Film: Issues of Gender	23
	Seminar in the <i>Carnegie Board Room</i> : Lost Documents	23
	Seminar in the <i>Wade Room</i> : "A world elsewhere?": Canadian Shakespeare	23
	Seminar in the <i>Halle Room</i> : Queer Philologies	24
	Seminar in the <i>Stouffer Board Room</i> : <i>Cymbeline</i> and the State of the Art	24
	Seminar in the <i>Blossom Room</i> : Addressing the Envelope: More on Shakespeare and Address	24
	Seminar in the <i>Van Aken Room</i> : Shakespeare and Skepticism	25
	Seminar in the <i>Rockefeller Board Room</i> : Editing Performance Decisions / Performing Editorial Decisions	25
	Workshop in the <i>Garfield Room</i> : Contexts for Teaching Shakespeare and Contemporaries	25
	Workshop in the <i>Severance Room</i> : Acting and Meaning in Shakespeare Performance	26
8:00 p.m.	Concert in the <i>Harkness Chapel at Case Western Reserve University</i> : <i>The Food of Love</i> : Songs of Shakespeare's England	26
10:00 p.m.	The Shakespeare Association / Malone Society Dance in the <i>Grand Ballroom</i>	26

Conference Administration

TERRY AYLSWORTH, Program Coordinator
 ANNE BARNETT ♦ PATTY HOKE
 JACKIE HOPKINS ♦ JULIE MORRIS

**The Renaissance Cleveland Hotel
 TOWER CITY CENTER**

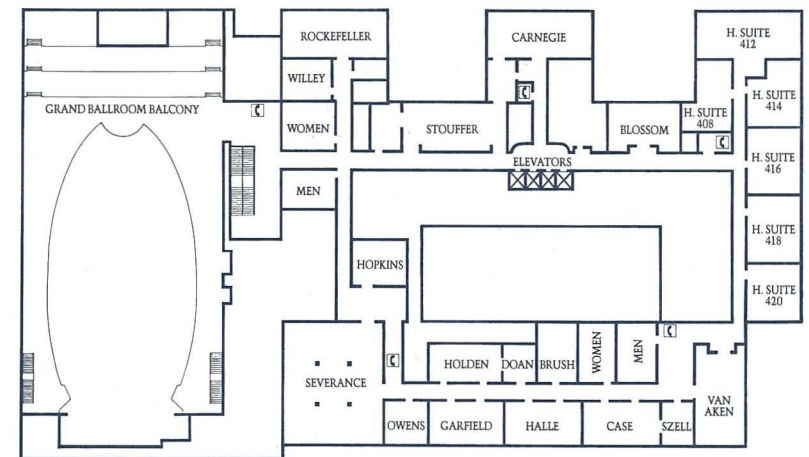
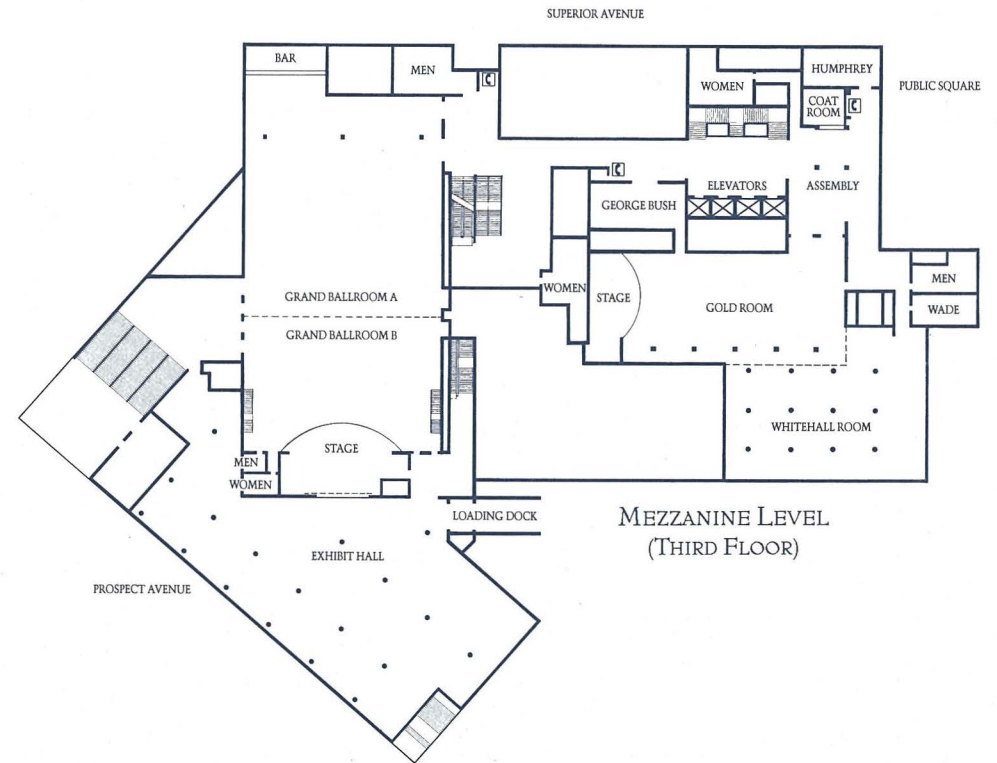

CONFERENCE LEVEL
 (FOURTH FLOOR)

Please note that the **AMBASSADOR BALLROOM** is on the **LOBBY LEVEL (SECOND FLOOR)**

Wednesday, 18 March

9:00 a.m. to 4:00 p.m.

Teaching Workshop:

The Doors Are Open: Teaching *Macbeth* through Performance
Mather Mansion, Cleveland State University

Leaders: BERNICE W. KLIMAN, Nassau Community College, SUNY
ELLEN SUMMERS, Hiram College
KENN MCLAUGHLIN, Great Lakes Theater Festival
TED LARDNER, Cleveland State University
JANET FIELD-PICKERING, Folger Shakespeare Library

Thursday, 19 March

11:30 a.m. to 5:00 p.m.

Registration
Assembly Area

Exhibits
Whitehall Room

12:00 noon to 2:00 p.m.

Performance and Workshop: *The Comedy of Errors*
The Cleveland Signstage Theatre
Exhibit Hall

Chair: TOM BISHOP, Case Western Reserve University
Moderator: MARIANNE EVETT, Theatre Critic, *Cleveland Plain Dealer*

From the Cleveland Signstage Theatre:
NEIL THACKABERRY, General Manager
AARON WEIR, Artistic Director
CATHERINE ALBERS, Vocal and Interpretive Coach
LARRY NEERING, Script Adaptor and Actor
KELLY WUZZARDO, Actor
RACHEL HOLLANDER, Assistant to the Artistic Director

Thursday, 19 March

12:30 to 2:00 p.m.

Luncheon Meeting for the Arden Editors
Carnegie Board Room

2:30 to 3:30 p.m.

Paper Session: Pleasures of the Eye and Ear
Gold Room

Chair: EVELYN GAJOWSKI, University of Nevada, Las Vegas

JEREMY LOPEZ, Cornell University
Tragic Syntax: The Audience and/or *Macbeth*

PAUL YACHNIN, University of British Columbia
Theatrical Pleasure and the Contest of Vision

Paper Session: Youth, On Stage and Off
Exhibit Hall

Chair: JUDITH WEIL, University of Manitoba

SUSAN SNYDER, Swarthmore College
Mamillius and Gender Polarization in *The Winter's Tale*

CHARLES WHITNEY, University of Nevada, Las Vegas
"Usually in the werking daies"? Playgoing Servants in Guild Records, 1582-92

4:00 to 6:00 p.m.

Seminar: Shakespeare's Verse
Rockefeller Board Room

Leader: MAURICE HUNT,
Baylor University

RACHEL HILE BASSETT, University of Kansas
PATRICIA DORVAL, Université Paul-Valéry
COBURN FREER, University of Georgia
CHARLES H. FREY, University of Washington
DAVID GEORGE, Urbana University
MAUREEN GODMAN, University of Kansas
CAMPBELL LATHEY, Albany, New York

RUSS McDONALD, University of North Carolina, Greensboro
KRISTEN L. OLSON, Case Western Reserve University
ALAN W. POWERS, Bristol Community College
ALBERT PRINCE, Marietta Psychological Services
JENNIFER C. VAUGHT, Northern Michigan University
SARAH GREENLEAF WHITTIER, University of California, Santa Cruz
GEORGE T. WRIGHT, University of Minnesota

Thursday, 19 March

Seminar: Shakespeare and
Children's Literature
Case Room

Leader: MEGAN L. ISAAC,
Youngstown State University

JAMES R. ANDREAS, Clemson University
DARLENE CIRAULO, University of Georgia
PATTY S. DERRICK, University of Pittsburgh, Johnstown
JANET FIELD-PICKERING, Folger Shakespeare Library
KATIE HANNAH, University of Alabama
RHODA S. KACHUCK, University of La Verne

LAUREN E. KEHOE, Boston University
DOUGLAS KING, Duquesne University
KELLY NEWMAN, Montgomery Blair High School
CYNTHIA PERANTONI, Youngstown State University
BETHANY S. SINNOTT, Catawba College
WINIFRED YIN, The Shakespeare Institute

Seminar: Writing about
Performance
Stouffer Board Room

Leader: MIRANDA JOHNSON-HADDAD,
Folger Shakespeare Library and the Shakespeare Theatre

ALAN ARMSTRONG, Southern Oregon University
CHRISTOPHER COBB, Bates College
DANIEL L. COLVIN, Western Illinois University
MARY JUDITH DUNBAR, Santa Clara University
PEGGY ENDEL, Florida International University
EDWARD GIESKES, Boston University
ANDREW JAMES HARTLEY, State University of West Georgia
FRANCES L. HELPHINSTINE, Morehead State University
JAMES N. LOEHLIN, Dartmouth College
CYNTHIA MARSHALL, Rhodes College

DAVID McCANDLESS, Carleton College
ALFREDO MICHEL MODENESSI, Universidad
Nacional Autónoma de México
SHARON O'DAIR, University of Alabama
PETER PAROLIN, University of Wyoming
PEGGY A. RUSSO, Pennsylvania State University
NANCY TAYLOR, Tufts University
MARION TROUSDALE, University of Maryland,
College Park
MICHAEL YOGEV, University of Haifa

Seminar: Women and Early Modern
Theatrical Production
Garfield Room

Leader: NATASHA KORDA,
Wesleyan University

KATHRYN MURPHY ANDERSON, Boston University
NANCY ATKINSON, University of Pittsburgh
MARGARET FERGUSON, University of California, Davis
LOREEN L. GIESE, Ohio University
MELINDA GOUGH, Oklahoma State University

SKILES HOWARD, Irvington, New York
WILLIAM INGRAM, University of Michigan
SHANNON MILLER, Temple University
HELEN OSTOVICH, McMaster University

Thursday, 19 March

Seminar: WonderWoman:
The Female Tragic Hero in the
Plays of Shakespeare and his Contemporaries
Halle Room

Leader: NAOMI C. LIEBLER,
Montclair State University

BARBARA BOWEN, Queen's College, CUNY
CAROLYN E. BROWN, University of San Francisco
VICTORINE DAIGRE, Georgia Southern University
MIMI STILL DIXON, Wittenberg University
EDWARD PECHTER, Concordia University
BARBARA RIEBLING, University of Toledo

JEANNE A. ROBERTS, American University
CLIFFORD RONAN, Southwest Texas State University
KAY STANTON, California State University, Fullerton
RACHEL WIFALL, New York University
LINDA WOODBRIDGE, Pennsylvania State University

Seminar: Speculations in Shakespeare:
Appropriations and Audiences, 1623-1800
Humphrey Room

Leader: LORI NEWCOMB,
University of Illinois, Urbana

LEE BLISS, University of California, Santa Barbara
J. DOUGLAS CANFIELD, University of Arizona
MITA CHOUDHURY, Dunwoody, Georgia
FRANK NICHOLAS CLARY, JR., Saint Michael's College
MICHAEL DOBSON, Roehampton Institute
CHRISTINE HUBER, University of North Carolina
KATE D. LEVIN, City College, CUNY

JOYCE GREEN MACDONALD, University of Kentucky
JEAN MARSDEN, University of Connecticut
FRANCES AMBROSIA NAKIWALA, Duquesne University
LOIS POTTER, University of Delaware
LAURA J. ROSENTHAL, Florida State University
KATHERINE WEST SCHEIL, St. Joseph College

Seminar: Reconsidering
Henry IV, Part Two
Carnegie Board Room

Leader: EDMUND M. TAFT,
Marshall University

JUDITH H. ANDERSON, Indiana University
JONATHAN BALDO, Eastman School of Music
STEPHEN BOOTH, University of California, Berkeley
EUGENE ENGLAND, Brigham Young University
JAMES H. FORSE, Bowling Green State University
MINORU FUJITA, Kansai University
W. L. GODSHALK, University of Cincinnati
HUGH GRADY, Beaver College

GLORIA JOHNSON, University of Oregon
SIKANDAR LAL, University of Delhi
WILLIAM T. LISTON, Ball State University
SARAH LYONS, Boston University
NAN MORRISON, College of Charleston
FRANCIS R. OLLEY, St. Joseph's University
SARAH E. SMITH, University of Wisconsin, Madison
GEORGE W. WILLIAMS, Duke University

Thursday, 19 March

Seminar: The '60s and
'70s Revisited
Blossom Room

Leader: HERB WEIL,
University of Manitoba

THOMAS CLAYTON, University of Minnesota
CLINTON CRUMLEY, University of Kansas
INGA-STINA EWBANK, University of Leeds

MARGARET GROOME, University of Manitoba
EDWARD T. WASHINGTON, Mansfield University

Seminar: Kinship and
Renaissance Drama,
Session One
Van Aken Room

Leader: FRANK WHIGHAM,
University of Texas, Austin

ELIZABETH ABELE, Temple University
ELIZABETH BROWN, University of Rio Grande
ALBERTO CACICEDO, Albright College
BIANCA F.-C. CALABRESI, Columbia University
STEPHANIE CHAMBERLAIN, Ball State University
GLENN CLARK, University of Chicago
STEPHEN A. COHEN, University of South Alabama

WILLIAM S. FORESTER, Scholarly Engagement with Anglican Doctrine
MARC GEISLER, Western Washington University
LINDA LIZUT HELSTERN, Southern Illinois University, Carbondale
NANETTE JAYNES, Tamkang University
KATHERINE E. KICKEL, John Carroll University
STUART M. KURLAND, Duquesne University
GAIL KERN PASTER, George Washington University

Seminar: Convention and Invention:
The Filmed *Hamlets*
George Bush Room

Leader: ROBERT F. WILLSON, JR.,
University of Missouri, Kansas City

MICHELLE BUTLER, Duquesne University
SAMUEL CROWL, Ohio University
DAVID G. HALE, SUNY, Brockport
NANCY GLASS HANCOCK, Austin Peay State University
KATHY HOWLETT, Northeastern University
DIANNE M. HUNTER, Trinity College
JAMES H. LAKE, Louisiana State University, Shreveport
GREGORY W. LANIER, University of West Florida

COURTNEY LEHMANN, Indiana University, Bloomington
JAMES P. LUSARDI, Lafayette College
BARBARA D. PALMER, Mary Washington College
KENNETH S. ROTHWELL, University of Vermont
JUNE SCHLUETER, Lafayette College
LISA S. STARKS, Texas A & M University, Commerce
DONALD R. WINEKE, Wichita State University

Thursday, 19 March

Workshop: Preparation and Reading of
Measure for Measure,
Session One
Severance Room

Leader: AUDREY STANLEY,
University of California, Santa Cruz

BRUCE AVERY, San Francisco State University
ERIC A. BINNIE, Hendrix College
JODY D. BROWN, Ferrum College
JOANNA MONTGOMERY BYLES, University of Cyprus
DOUGLAS E. GREEN, Augsburg College
JOAN HUTTON LANDIS, Curtis Institute of Music

STEVEN MARX, California Polytechnic State
University, San Luis Obispo
M. ANN REED, University of Minnesota
MICHAEL W. SHURGOT, South Puget Sound
Community College
JOHN W. VELZ, University of Texas

7:00 to 9:00 p.m.

Opening Reception
The Cleveland Arcade

with

A Flourish of Hautboys

Shawm ensemble performing dances and contrapuntal works
from the late sixteenth and early seventeenth centuries

Director: ROSS W. DUFFIN,
Fynette H. Kulas Professor of Music, Case Western Reserve University

Reception hosted by

University of Akron
Allegheny College
Baldwin-Wallace College
Bowling Green State University
BP America
Case Western Reserve University
Cleveland State University
University of Dayton
Duquesne University
Gannon University
Hiram College
John Carroll University

Kent State University
Kenyon College
Miami University
Oberlin College
Ohio Northern University
Ohio State University
Ohio University
Plain Dealer Charities
University of Toledo
Wright State University
Youngstown State University

Friday, 20 March

8:00 a.m. to 5:00 p.m.

Registration
Assembly Area

Exhibits
Whitehall Room

8:00 to 9:00 a.m.

Continental Breakfast
for Graduate Students
Hosted by the Trustees of the Association
Grand Ballroom Balcony

9:00 to 10:30 a.m.

Plenary Session:
Memory and the Making of History
Grand Ballroom

Chair: PHYLLIS RACKIN, University of Pennsylvania

STEPHEN GREENBLATT, Harvard University
Dreams and Shadows

JYOTSNA SINGH, Southern Methodist University
*Who Speaks for the Nation?:
Trading National Identity in Early Modern England*

MICHAEL NEILL, University of Auckland
*"The Exact Map or Discovery of Human Affairs":
Shakespeare and the Uses of the Past*

Friday, 20 March

10:30 to 11:00 a.m.

Coffee Break
Assembly Areas

11:00 a.m. to 12:30 p.m.

Paper Session: Shakespeare and the
Politics of the Curriculum
Ambassador Ballroom

Chair: DENISE ALBANESE, George Mason University

THOMAS L. BERGER, St. Lawrence University
"Small-Time Shakespeare": The Politics of the Curriculum at a Liberal Arts College

KIM HALL, Georgetown University
*What's a nice girl like me doing in a place like this?
Problems of Curriculum Reform at Georgetown*

MARTHA TUCK ROZETT, SUNY, Albany
Shakespeare the Survivor

KAREN CUNNINGHAM, Florida State University
Shakespeare, the Public, and Public Education

Paper Session: The Text and the Stage
Gold Room

Chair: STANLEY WELLS, Shakespeare Birthplace Trust and University of Birmingham

LINDA GREGERSON, University of Michigan
*Staging the Text: *Sejanus**

STEPHEN ORGEL, Stanford University
*Staging What's Not the Text: *Macbeth**

1:00 to 3:00 p.m.

Annual Luncheon
Grand Ballroom

Presiding: MARY BETH ROSE, University of Illinois at Chicago

Friday, 20 March

3:30 to 5:30 p.m.

Open Rehearsal: *Much Ado about Nothing*
The Cincinnati Shakespeare Festival
Gold Room

Director: JASSON MINADAKIS

CHRISTOPHER LEWIN as Benedick
DAN KENNEY as Dogberry, Balthazar, The Friar
C. CHARLES SCHEEREN as Claudio, Second Watch
TODD DOUGLAS as Leonato
NICOLE FRANKLIN-KERN as Margaret, Conrade

MARNI PENNING as Beatrice
WILLIAM SWEENEY as Don Pedro, First Watch
JILL WESTERBY as Hero, The Sexton, The Boy
R. CHRIS REEDER as Borrachio, Antonio, The Messenger
JAY APKING as Don John, Verges

Seminar: Citing Shakespeare in
American Popular Culture
Humphrey Room

Leaders: RICHARD BURT,
University of Massachusetts, Amherst
LYNDA BOOSE,
Dartmouth College

THOMAS CARTELLI, Muhlenberg College
ANNALISA CASTALDO, Temple University
LESLIE C. DUNN, Vassar College
RICHARD FINKELSTEIN, SUNY, Geneseo
BARBARA FREEDMAN, Tufts University
MICHAEL D. FRIEDMAN, University of Scranton
LEAH GUNTHER, University of Alabama, Tuscaloosa

WILLY MALEY, Glasgow University
LAURIE E. OSBORNE, Colby College
DAVID PASCOE, Glasgow University
FRANCES TEAGUE, University of Georgia
SUZANNE R. WESTFALL, Lafayette College
GARY JAY WILLIAMS, Catholic University of America
LAURA B. WILSON, University of Colorado, Boulder

Seminar: The "Bad" Quartos:
Text into Performance
Wade Room

Leaders: DALE CHURCHWARD,
Upper Canada College
G. B. SHAND,
Glendon College, York University

DOUGLAS A. BROOKS, Texas A & M University
CHRISTY DESMET, University of Georgia
PAUL MATTHEW EDMONDSON, The Shakespeare Institute
BARRY GAINES, University of New Mexico
JAY L. HALIO, University of Delaware

MARGARET MAURER, Colgate University
ANNE TURNER, Folger Shakespeare Library
MICHAEL WARREN, Cowell College, University of
California, Santa Cruz
PAUL WERSTINE, King's College, University of Western Ontario

Friday, 20 March

Seminar: Shakespeare and the
Ethics of Historiography
Carnegie Board Room

Leader: LOWELL GALLAGHER,
University of California, Los Angeles

URSULA APPELT, SUNY, Stony Brook
CYNDIA SUSAN CLEGG, Pepperdine University
SCOTT CRIDER, University of Dallas
STEPHEN MERRIAM FOLEY, Brown University
HIROKO ITO, The Shakespeare Association of Japan
CONSTANCE JORDAN, Claremont Graduate University
JOAN PONG LINTON, Indiana University

HOWARD MARCHITELLO, Texas A & M University
SHANKAR RAMAN, Massachusetts Institute of Technology
WILLIAM O. SCOTT, University of Kansas
DEBORA K. SHUGER, University of California, Los Angeles
ELIZABETH M. STURGEON, Northwestern University
OWEN WILLIAMS, University of Pennsylvania

Seminar: Early Modern Print Culture:
From "Riffe-raffe" Books to
Crown Paper
Rockefeller Board Room

Leader: HEIDI BRAYMAN HACKEL,
Oregon State University

SUSAN CAMPBELL ANDERSON, Longwood College
FRANCES K. BARASCH, Baruch College, CUNY
DOUGLAS BRUSTER, University of Texas, San Antonio
JOHN JOWETT, The Shakespeare Institute
WILLIAM KEMP, Mary Washington College
LINC KESLER, Oregon State University
FREDERICK KIEFER, University of Arizona

RANDY MCLEOD, Erindale College, University of Toronto
STEVE MENTZ, Yale University
ROBERT S. MIOLA, Loyola College in Maryland
BENEDICT SCOTT ROBINSON, Columbia University
GARY TAYLOR, University of Alabama
BARBARA H. TRAISTER, Lehigh University
PAUL J. VOSS, Georgia State University

Seminar: Narratives and Narrativity in
Elizabethan Chronicle History Plays
Holden Room

Leader: DAVID L. MIDDLETON,
Trinity University

ISKA ALTER, Hofstra University
PETER COCKETT, University of Toronto
JENNIFER FORSYTH, University of Nevada, Reno
GEORGE L. GECKLE, University of South Carolina

ATSUHIKO HIROTA, University of Tokyo
JAMES A. LEWIN, Shepherd College
LINDA MCJANNET, Bentley College
WILLIAM W.E. SLIGHTS, University of Saskatchewan

Seminar: Addressing the Envelope:
More on Shakespeare and Address, Session One
Blossom Room

Leaders: PAUL D. NELSEN,
Marlboro College
ELLEN SUMMERS,
Hiram College

HARDIN AASAND, Dickinson State University
RUSSELL J. BODI, Owens Community College
RALPH ALAN COHEN, James Madison University
JILL DIONE, University of Pittsburgh
JAMES HIRSH, Georgia State University
ROBERT IRISH, University of Toronto

ROSALIND KING, Queen Mary and Westfield College
RONALD R. MACDONALD, Smith College
CARY M. MAZER, University of Pennsylvania
JOHN ROE, University of York
SHARON SCHUMAN, Clark Honors College, University of Oregon

Seminar: Shakespeare and China,
From Hakluyt's Cathay to Deng Xiaoping's China
Halle Room

Leaders: DARYL W. PALMER,
University of Akron
YUPEI ZHOU,
University of Akron

PAULA BERGGREN, Baruch College, CUNY
TIMOTHY BILLINGS, Colgate University
AGNES MARIE FLECK, College of St. Scholastica
QIXIN HE, Beijing Foreign Studies University
MURRAY LEVITH, Skidmore College
NICHOLAS RANSON, University of Akron

RACHANA SACHDEV, Susquehanna University
MICHAEL SHAPIRO, University of Illinois, Urbana-Champaign
MASON Y.H. WANG, Saginaw Valley State University
LINGUI YANG, Texas A & M University
LUO ZHIYE, Nanchang University

Seminar: The Epistemology of Place in
Early Modern Culture
Garfield Room

Leaders: LAUREN SHOHEIT,
Villanova University
JULIAN YATES,
University of Delaware

ELLEN M. CALDWELL, Kalamazoo College
MARY CRANE, Boston College
GRAHAM HAMMILL, University of Notre Dame
SARA HANNA, New Mexico Highlands University
WILLIAM KERWIN, University of Missouri, Columbia
DANIEL KULMALA, University of Kansas
JENNIFER LOW, Florida Atlantic University

JAMES MARDOCK, University of Wisconsin, Madison
SIMON MORGAN-RUSSELL, Bowling Green State University
J. DUKE PESTA, University of Tennessee, Martin
CONSTANCE C. RELIHAN, Auburn University
HENRY S. TURNER, Columbia University
JAMES W. WELLS, Ohio University
THOMAS F. WORDEN, Georgetown University

Seminar: Domesticities /
Sexualities / Work
Case Room

Leader: WENDY WALL,
Northwestern University

LINDA ANDERSON, Virginia Polytechnic Institute and State University
MARIO DIGANGI, Indiana University
FRANCES E. DOLAN, Miami University
HEATHER DUBROW, University of Wisconsin, Madison
SUSAN FRYE, University of Wyoming
NANCY A. GUTIERREZ, Arizona State University
ALEXANDRA HALASZ, Dartmouth College
CHRISTINE HUTCHINS, Graduate Center, CUNY
MARK LAWHORN, University of Hawaii, Manoa
NINA LEVINE, University of South Carolina
RICHELLE MUNKHOFF, University of Wisconsin, Madison
LENA COWEN ORLIN, University of Maryland,
Baltimore County
DANA SONNENSCHNEIN, Southern
Connecticut State University
JAN STIRM, Monmouth College

Seminar: Kinship and
Renaissance Drama,
Session Two
Van Aken Room

Leader: FRANK WHIGHAM,
University of Texas, Austin

MARTHA A. KURTZ, Toronto, Ontario
THEODORE B. LEINWAND, University of Maryland, College Park
PAULA MCQUADE, University of Chicago
LALITA PANDIT, University of Wisconsin
JENNIFER RICH, Graduate Center, CUNY
KAREN ROBERTSON, Vassar College
JAMES P. SAEGER, Vassar College

JO ANNE SHEA, Berry College
LOUIS CHARLES STAGG, University of Memphis
JEANIE E. WARNOCK, University of Ottawa
HEIDI S. WEBB, University of Chicago
JUDITH WEIL, University of Manitoba
DEBORAH WILLIS, University of California, Riverside
BRUCE W. YOUNG, Brigham Young University

Seminar: Shakespeare and the Victorians
Stouffer Board Room

Leaders: GEORGIANNA ZIEGLER,
Folger Shakespeare Library
ANN THOMPSON,
Roehampton Institute

RUSSELL JACKSON, The Shakespeare Institute
REBECCA LAROCHE, University of Colorado, Colorado Springs
JUDIANA LAWRENCE, St. John Fisher College
JOHN E. LUEBERING, University of Chicago
JOHN W. MAHON, Iona College
PHYLLIS MCBRIDE, Texas A & M University
MARIANNE NOVY, University of Pittsburgh

MARGARET LOFTUS RANALD, Queens College, CUNY
ROBERT SAWYER, University of Georgia
FRANCES A. SHIRLEY, Wheaton College
JANE WILLIAMSON, University of Missouri, St. Louis
SHARON R. YANG, Eastern Connecticut State University
ALAN R. YOUNG, Acadia University

Friday, 20 March

Workshop: Teaching Shakespeare with
Technology
George Bush Room

Leader: KATHLEEN CAMPBELL,
Austin College

JEAN R. BRINK, Arizona State University
CINDY CARLSON, Metropolitan State College of Denver
SHEILA T. CAVANAGH, Emory University
CRAIG DIONNE, Eastern Michigan University
JENNIFER GOLDFARB, Lehigh University
JOE LENZ, Drake University
KRISTEN MCDERMOTT, Spelman College

IAN FREDERICK MOULTON, Arizona State University West
MICHAEL MULLIN, University of Illinois, Urbana-Champaign
SUSAN OLDRIEVE, Baldwin-Wallace College
RALPH ARTHUR RANALD, Hunter College, CUNY
CHRISTOPHER ROARK, John Carroll University
RANDAL ROBINSON, Michigan State University
ALAN S. WEBER, Pennsylvania State University, Wilkes-Barre

Workshop: Preparation and Reading of
Measure for Measure, Session Two
Severance Room

Leader: AUDREY STANLEY,
University of California, Santa Cruz

For workshop membership, see page 11.

5:00 to 7:00 p.m.

Ohio Shakespeare Conference Holding Committee and
Graduate Student Dinner
Diamondback Brewery, 724 Prospect Avenue
Reservations required in advance; contact David Evelt.

8:00 p.m.

Performance: *Hamlet*
The Cincinnati Shakespeare Festival
Cleveland State University Main Classroom Auditorium

Starring MARNI PENNING as the Princess of Denmark

Seating is limited to 375. Buses load at the Superior Street entrance of the Renaissance Cleveland Hotel from 7:00 p.m. At the Cleveland State University campus, students will direct SAA members to the Auditorium via various stairs and elevators. Those driving should note that underground parking is available to both the right and left off East 22nd Street between Euclid and Chester (where East 22nd Street is one-way northbound). From the parking area, take the clock-tower elevator (on East 22nd Street) or the Main Classroom building elevator to the second floor. In the Auditorium Lobby, coffee and pastries will be available to theatre-goers.

Saturday, 21 March

8:30 a.m. to 12:00 noon

Information
Assembly Area

Exhibits
Whitehall Room

9:00 to 10:30 a.m.

Paper Session: Seeing *Hamlet* Everywhere:
Mapping a Paratext
Ambassador Ballroom

Chair: PETER STALLYBRASS, University of Pennsylvania

CATHERINE BELSEY, University of Wales College of Cardiff
Elegiac Hero in a Country Churchyard

LINDA CHARNES, Indiana University
The Hamlet Formerly Known as Prince

ERIC S. MALLIN, University of Texas, Austin
"You kilt my foddah": Hamlet Meets Hollywood

Paper Session: The Electronic Text as a
Tool in Research and Teaching
Gold Room

Chair: MICHAEL BEST, University of Victoria

MICHAEL BEST, University of Victoria
Dancing Chips: Computers and Shakespeare's Text

HARDY M. COOK, Bowie State University
"Take your choice of those that best can aid your action": Editing and the Electronic Text

IAN LANCASHIRE, University of Toronto
Shakespeare's "Dumb Significants" and Early Modern English Definition

MILLA C. RIGGIO, Trinity College
To screen or not to screen: Film as Text for Electronically Challenged Shakespeare Teachers

Saturday, 21 March

10:30 to 11:00 a.m.

Coffee Break
Assembly Areas

11:00 a.m. to 12:30 p.m.

Paper Session: Beyond Foucault and Laqueur:
The Uses of Early Modern Medical Texts
Ambassador Ballroom

Chair: CAROL THOMAS NEELY, University of Illinois, Urbana-Champaign

MARY FISSELL, Johns Hopkins University
Seeing through Anatomy: The View from Popular Medical Books

CAROL THOMAS NEELY, University of Illinois, Urbana-Champaign
Melancholy Distinctions and Subject Formation: Aristotle, Bright, Freud

VALERIE TRAUB, University of Michigan
Anatomy, Cartography, and the New World Body

Paper Session: Cultural Materialism
and Performance
Gold Room

Chair: WILLIAM INGRAM, University of Michigan

SUSAN BENNETT, University of Calgary
Shakespeare in Performance of the Modern

DOUGLAS LANIER, University of New Hampshire
Shakespeare and the Talkies

WILLIAM B. WORTHEN, University of California, Davis
Shakespearean Performativity

12:30 to 2:00 p.m.

Lunch Break

World Shakespeare Bibliography Business Meeting and Luncheon
Gather outside the Lobby Court Bar.

Saturday, 21 March

2:00 to 3:30 p.m.

Paper Session: Biography in the Archives
Ambassador Ballroom

Chair: SCOTT MCMILLAN, Cornell University

S. P. CERASANO, Colgate University
Philip Henslowe and Edward Alleyn at Court

ALAN H. NELSON, University of California, Berkeley
Shakespeare and the Bibliophiles: The Case of Humphrey Dyson

DAVID RIGGS, Stanford University
The Killing of Christopher Marlowe

Paper Session: Shakespeare and the
Culture of Rock and Roll
Gold Room

Chair: VIRGINIA MASON VAUGHAN, Clark University

PAUL BUDRA, Simon Fraser University
Punk Shakespeare

DAVID LINTON, Marymount Manhattan College
Whole Lotta Shakespeare Goin' On

MARIE PLASSE, Merrimack College
Crossover Dreams: Shakespeareans and Popular Culture

4:00 to 6:00 p.m.

Open Rehearsal: *Much Ado about Nothing*
The Cincinnati Shakespeare Festival
Gold Room

Director: JASSON MINADAKIS

CHRISTOPHER LEWIN as Benedick
DAN KENNEY as Dogberry, Balthazar, The Friar
C. CHARLES SCHEEREN as Claudio, Second Watch
TODD DOUGLAS as Leonato
NICOLE FRANKLIN-KERN as Margaret, Conrade

MARNI PENNING as Beatrice
WILLIAM SWEENEY as Don Pedro, First Watch
JILL WESTERBY as Hero, The Sexton, The Boy
R. CHRIS REEDER as Borrachio, Antonio, The Messenger
JAY APKING as Don John, Verges

Saturday, 21 March

Seminar: Early Modern Women
Writers and Genre
George Bush Room

Leader: ELAINE BEILIN,
Framingham State College

ALEXANDRA G. BENNETT, Concordia University
JULIE D. CAMPBELL, Texas A & M University
LOUIS A. DE CATUR, Ursinus College
VALERIE FORMAN, University of California, Santa Cruz
MARGARET HANNAY, Siena College
GWYNNE KENNEDY, University of Wisconsin, Milwaukee
CLARE KINNEY, University of Virginia
DONNA J. LONG, Florida State University

RANDALL MARTIN, University of New Brunswick
NAOMI J. MILLER, University of Arizona
SUSAN O'MALLEY, CUNY, Kingsborough
PATRICIA PHILLIPPY, Texas A & M University
ANNE RUSSELL, Wilfrid Laurier University
DAVID SCHALKWYK, University of Cape Town
ANDREA SUNUNU, DePauw University
DOMINIQUE TIEMAN, Michigan State University

Seminar: Writing for the Private Theatre:
Shakespeare's Non-Dramatic Poems
Case Room

Leader: KATHERINE DUNCAN-JONES,
Somerville College, Oxford

PETER CUMMINGS, Hobart and William Smith Colleges
ELIZABETH A. DIETZ, University of Iowa
SARA EATON, North Central College
GAYLE GASKILL, College of St. Catherine
THELMA N. GREENFIELD, University of Oregon
DAVID B. HALEY, University of Minnesota
PETER C. HERMAN, San Diego State University
A. KENT HIEATT, University of Western Ontario
PETER HYLAND, Huron College, University of Western Ontario
PENNY MCCARTHY, University of Sussex
DIETER MEHL, University of Bonn
ANTHONY MORTIMER, Misericorde, Fribourg
BARBARA L. PARKER, William Paterson University
INGRID PRUSS, Western Connecticut State University
HELEN VENDLER, Harvard University
EMILY WILSON, Yale University

Seminar: New Perspectives and Contexts for the
First Tetralogy and *Edward III*
Holden Room

Leader: MICHAEL HATTAWAY,
University of Sheffield

EDWARD S. BRUBAKER, Franklin and Marshall College
EDWARD BURNS, University of Liverpool
PATRICIA CAHILL, Columbia University
LINDA L. JACOBS, Francis Marion University
THOMAS A. PENDLETON, Iona College
PHYLLIS RACKIN, University of Pennsylvania
JAMES R. SIEMON, Boston University
M. RICK SMITH, Kent State University
J.J.M. TOBIN, University of Massachusetts, Boston

Saturday, 21 March

Seminar: Shakespeare on Film:
Issues of Gender
Humphrey Room

Leader: DIANA HENDERSON,
Massachusetts Institute of Technology

CURTIS BREIGHT, University of Pittsburgh
STEPHEN M. BUHLER, University of Nebraska, Lincoln
PETER S. DONALDSON, Massachusetts Institute of Technology
SUSAN MICHELE DUNN, University of Kansas
JOHN R. FORD, Delta State University
KATHARINE GOODLAND, Polytechnic University
KIRK HENDERSHOTT-KRAETZER, Michigan State University
BARBARA HODGDON, Drake University
HARRY KEYISHIAN, Fairleigh Dickinson University
RANDALL NAKAYAMA, San Francisco State University
JILL OROFINO, Boston University
JEAN PETERSON, Bucknell University
ANDREA SOLOMON, Columbia University

Seminar: Lost Documents
Carnegie Board Room

Leader: ANNE LANCASHIRE,
University College, Toronto

LEEDS BARROLL, University of Maryland, Baltimore County
HERBERT BERRY, University of Saskatchewan
DONNA B. HAMILTON, University of Maryland, College Park
GRACE IOPPOLO, American University
ROSLYN L. KNUTSON, University of Arkansas, Little Rock
RICHARD LEVIN, SUNY, Stony Brook
WILLIAM B. LONG, Brooklyn, New York
SCOTT McMILLIN, Cornell University
MARION O'CONNOR, University of Kent, Canterbury
BARBARA TODD, University of Toronto
PAUL WHITFIELD WHITE, Purdue University

Seminar: "A World Elsewhere?":
Canadian Shakespeare
Wade Room

Leaders: IRENA MAKARYK,
University of Ottawa
DIANA BRYDON,
University of Guelph

PETER AYERS, Memorial University of Newfoundland
KAREN BAMFORD, Mount Allison University
CAROLINE CAKEBREAD, The Shakespeare Institute
DOUGLAS FREAKE, York University
RIC KNOWLES, University of Guelph
LEANORE LIEBLEIN, McGill University
LAURIE E. MAGUIRE, University of Ottawa
C. EDWARD MCGEE, University of St. Jerome's College
LOIS SHERLOW, Memorial University of Newfoundland
MARTA STRAZNICKY, Queen's University

Seminar: *Queer Philologies*
Halle Room

Leader: JEFFREY MASTEN,
Harvard University

REBECCA ANN BACH, University of Alabama, Birmingham
MARY BLY, Washington University
DAVID GLIMP, University of Miami
MICHAEL MORGAN HOLMES, Georgetown University
THEODORA A. JANKOWSKI, Washington State University
TERESA LYLE, Miami University
FIONA MCNEILL, Columbia University

KAARA L. PETERSON, Boston University
REGINALD RAMPONE, JR., Quinsigamond
Community College
IAN D. SMITH, Lafayette College
SCOTT MANNING STEVENS, Arizona State University
MICHAEL TORREY, La Salle University
ELLIOTT TRICE, Columbia University

Seminar: *Cymbeline and
the State of the Art*
Stouffer Board Room

Leader: JODI MIKALACHKI,
Wellesley College

RICHARD H. ABRAMS, University of Southern Maine
RONALD J. BOLING, Lyon College
CYNTHIA F. BRADY, California State University, Fullerton
JUDITH MATTHEWS CRAIG, Midland, Texas
ELIZABETH FRENCH, University of North Carolina
EVELYN GAJOWSKI, University of Nevada, Las Vegas
ALEXANDER LEGGATT, University of Toronto

MEGAN LLOYD, King's College
LAURIE MCMILLAN, Duquesne University
MARTIN ORKIN, University of the Witwatersrand
AVRAHAM OZ, University of Haifa; Tel Aviv University
TERRY REILLY, University of Alaska, Fairbanks
GORAN V. STANIVUKOVIC, University College of Cape Breton
VALERIE WAYNE, University of Hawaii, Manoa

Seminar: *Addressing the Envelope:
More on Shakespeare and Address, Session Two*
Blossom Room

Leaders: PAUL D. NELSEN,
Marlboro College
ELLEN SUMMERS,
Hiram College

For seminar membership, see page 16.

Seminar: *Shakespeare and Skepticism*
Van Aken Room

Leader: LAWRENCE F. RHU,
University of South Carolina

ROBERT BENNETT, University of Delaware
KENT CARTWRIGHT, University of Maryland, College Park
STANLEY CAVELL, Harvard University
DOLORA G. CUNNINGHAM, San Francisco State University
LARS ENGLE, University of Tulsa
WILLIAM HAMLIN, Idaho State University
MICHAEL HOLAHAN, Southern Methodist University
ROBERT S. KNAPP, Reed College
ANGELA LOCATELLI, Università di Bergamo

ELISE MARKS, Kenyon College
CLAIRE MCEACHERN, University of California, Los Angeles
DAVID MIKICS, University of Houston
ROBERT L. REID, Emory and Henry College
TRACEY SEDINGER, University of Northern Colorado
ERIC V. SPENCER, Albertson College of Idaho
ROBERT N. WATSON, University of California, Los Angeles
RICHARD P. WHEELER, University of Illinois,
Urbana-Champaign

Seminar: *Editing Performance
Decisions / Performing Editorial Decisions*
Rockefeller Board Room

Leader: SARAH H. WERNER,
University of Pennsylvania

ROGER APPELBAUM, Educational Programs Abroad
EDNA ZWICK BORIS, LaGuardia Community College, CUNY
ANTHONY B. DAWSON, University of British Columbia
ALAN C. DESSEN, University of North Carolina
JOHN DRAKAKIS, University of Stirling
PETER D. HOLLAND, The Shakespeare Institute
PAMELA MASON, The Shakespeare Institute

PHILIP C. MCGUIRE, Michigan State University
RICHARD PROUDFOOT, King's College, London
EDWARD L. ROCKLIN, California State
Polytechnic University, Pomona
STEVEN URKOWITZ, City College, CUNY
MICHAEL F. WALKER, Boston University
WILLIAM PROCTOR WILLIAMS, Northern Illinois University

Workshop: *Contexts for Teaching
Shakespeare and Contemporaries*
Garfield Room

Leaders: ANN C. CHRISTENSEN,
University of Houston
BARBARA SEBEK,
Colorado State University

JOHN MICHAEL ARCHER, University of New Hampshire
WENDY M. BEAVER, Florida State University
WILLIAM C. CARROLL, Boston University
EMILY DETMER, Miami University
ANNETTE DREW-BEAR, Washington and Jefferson College
ELIZABETH HANSON, Queen's University
DUNCAN HARRIS, University of Wyoming
NIELS HEROLD, Oakland University

TRICIA A. MCELROY, University of Georgia
MARY JANELL METZGER, Western Washington University
MARYCLAIRE MORONEY, John Carroll University
NINI PAL, Marianopolis College
DAVID E. PHILLIPS, Charleston Southern University
ARNOLD W. PREUSSNER, Truman State University
ALAN ROSEN, Bar-Ilan University
MICHAEL SHEA, Southern Connecticut State University

Saturday, 21 March

Workshop: Acting and Meaning in Shakespeare Performance

Severance Room

Leaders: KURT DAW,
Kennesaw State University
JULIA MATTHEWS,
Kennesaw State University
DAVID SAUER,
Spring Hill College

DEBBIE BARRETT-GRAVES, College of Santa Fe
KRISTIN CROUCH, Waukesha, Wisconsin
WILLIAM W. FRENCH, West Virginia University
THOMAS GANDY, Texas A & M University, Texarkana
VICTORIA HAYNE, University of San Diego
EDWARD ISSER, College of the Holy Cross
KATHLEEN KELLY, Babson College
ROBERT LANE, North Carolina State University
JOHN S. MEBANE, University of Alabama, Huntsville
STEPHANIE MOSS, University of South Florida

LOUISA FOULKE NEWLIN, Folger Shakespeare Library
RICHARD A. PACHOLSKI, Millikin University
MARIA TERESA MICAELA PRENDERGAST,
University of South Alabama
ALISON H. PRINDLE, Otterbein College
DENNIS PRINDLE, Ohio Wesleyan University
BROWNELL SALOMON, Bowling Green State University
PATRICIA P. SALOMON, University of Findlay
CLARE-MARIE WALL, California State University, Fresno

8:00 p.m.

Concert: *The Food of Love: Songs of Shakespeare's England* *Harkness Chapel at Case Western Reserve University*

JULIANNE BAIRD, soprano
RONN MCFARLANE, lutenist

Buses board at the Superior Street entrance of the Renaissance Hotel from 7:15 p.m. Those wishing to attend the pre-concert talk scheduled at Harkness Chapel for 7:15 p.m. should make their own arrangements for transportation. Those taking taxicabs are advised to pre-book them, especially for return trips. The concert is expected to conclude around 10:00 p.m.

10:00 p.m.

The Dance

Sponsored by the Shakespeare Association of America and the Malone Society
Grand Ballroom

Featuring SPECIAL REQUEST and the
HEY NONNIE NONNIES

Participants in the 26th Annual Meeting of the Shakespeare Association of America

Hardin Aasand, Dickinson State University
Elizabeth Abele, Temple University
Richard H. Abrams, University of Southern Maine
Denise Albanese, George Mason University
Isak Alter, Hofstra University
Judith H. Anderson, Indiana University
Kathryn Murphy Anderson, Boston University
Linda Anderson, Virginia Polytechnic Institute and
State University
Susan Campbell Anderson, Longwood College
James R. Andreas, Clemson University
John Andrews, The Shakespeare Guild
Roger Apfelbaum, Educational Programs Abroad
Ursula Appelt, SUNY, Stony Brook
John Michael Archer, University of New Hampshire
Alan Armstrong, Southern Oregon University
Nancy Atkinson, University of Pittsburgh
Bruce Avery, San Francisco State University
Peter Ayers, Memorial University of Newfoundland

Rebecca Ann Bach, University of Alabama, Birmingham
Jonathan Baldo, Eastman School of Music
John C. Bale, Luther College
Karen Bamford, Mount Allison University
Frances K. Barasch, Baruch College, CUNY
Debbie Barrett-Graves, College of Santa Fe
Leeds Barroll, University of Maryland, Baltimore County
Emily Bartels, Rutgers University
Rachel Hile Bassett, University of Kansas
Wendy M. Beaver, Florida State University
Elaine Beilin, Framingham State College
Catherine Belling, SUNY, Stony Brook
Catherine Belsey, University of Wales College of Cardiff
Alexandra G. Bennett, Concordia University
Robert Bennett, University of Delaware
Susan Bennett, University of Calgary
Harry Berger, Jr., University of California, Santa Cruz
Thomas L. Berger, St. Lawrence University
David Bergeron, University of Kansas
Paula Berggren, Baruch College, CUNY
Herbert Berry, University of Saskatchewan
Michael Best, University of Victoria
David Bevington, University of Chicago
Timothy Billings, Colgate University
Eric A. Binnie, Hendrix College
J. W. Binns, University of York
Tom Bishop, Case Western Reserve University
Lee Bliss, University of California, Santa Barbara
Mary Bly, Washington University
Russell J. Bodi, Owens Community College
Ronald J. Boling, Lyon College
Lynda Boose, Dartmouth College
Stephen Booth, University of California, Berkeley
Edna Zwick Boris, LaGuardia Community College, CUNY

Barbara Bowen, Queen's College, CUNY
Norman P. Boyer, Saint Xavier University
Cynthia F. Brady, California State University, Fullerton
A. R. Braummuller, University of California, Los Angeles
Curtis Breight, University of Pittsburgh
Jean R. Brink, Arizona State University
Michael D. Bristol, McGill University
Douglas A. Brooks, Texas A & M University
Carolyn E. Brown, University of San Francisco
Elizabeth Brown, University of Rio Grande
Jody D. Brown, Ferrum College
Edward S. Brubaker, Franklin and Marshall University
Douglas Bruster, University of Texas, San Antonio
Diana Brydon, University of Guelph
Paul Budra, Simon Fraser University
Stephen M. Buhler, University of Nebraska, Lincoln
James C. Bulman, Allegheny College
Edward Burns, University of Liverpool
Richard Burt, University of Massachusetts, Amherst
Michelle Butler, Duquesne University
Joanna Montgomery Byles, University of Cyprus

Alberto Cacicedo, Albright College
Patricia Cahill, Columbia University
Carolyn Cakebread, The Shakespeare Institute
Bianca F.-C. Calabresi, Columbia University
Ellen M. Caldwell, Kalamazoo College
Julia D. Campbell, Texas A & M University
Kathleen Campbell, Austin College
J. Douglas Canfield, University of Arizona
Carol J. Carlisle, University of South Carolina
Cindy Carlson, Metropolitan State College of Denver
William C. Carroll, Boston University
Thomas Cartelli, Muhlenberg College
Kent Cartwright, University of Maryland, College Park
Annalisa Castaldo, Temple University
Sheila T. Cavanagh, Emory University
Stanley Cavell, Harvard University
S. P. Cerasano, Colgate University
Stephanie Chamberlain, Ball State University
Linda Charnes, Indiana University
Mita Choudhury, Dunwoody, Georgia
Ann C. Christensen, University of Houston
Dale Churchward, Upper Canada College
Darlene Ciraulo, University of Georgia
Glenn Clark, University of Chicago
Frank Nicholas Clary, Jr., Saint Michael's College
Thomas Clayton, University of Minnesota
Cyndia Susan Clegg, Pepperdine University
Christopher Cobb, Bates College
Peter Cockett, University of Toronto
Ralph Alan Cohen, James Madison University
Stephen A. Cohen, University of South Alabama
Daniel L. Colvin, Western Illinois University

Ann Jennalie Cook, Vanderbilt University
Hardy M. Cook, Bowie State University
John D. Cox, Hope College
Sandra S. Coyle, College of St. Joseph in Vermont
Judith Matthews Craig, Midland, Texas
Mary Crane, Boston College
Scott Crider, University of Dallas
Kristin Crouch, Waukesha, Wisconsin
Samuel Crowl, Ohio University
Clinton Crumley, University of Kansas
Peter Cummings, Hobart and William Smith Colleges
Dolora G. Cunningham, San Francisco State University
Karen Cunningham, Florida State University

Victorine Daigre, Georgia Southern University
Kurt Daw, Kennesaw State University
Anthony B. Dawson, University of British Columbia
Louis A. DeCatur, Ursinus College
Patty S. Derrick, University of Pittsburgh, Johnstown
Christy Desmet, University of Georgia
Alan C. Dessen, University of North Carolina
Emily Detmer, Miami University
Elizabeth A. Dietz, University of Iowa
Mario DiGangi, Indiana University
Jill Dione, University of Pittsburgh
Craig Dionne, Eastern Michigan University
Mimi Still Dixon, Wittenberg University
Michael Dobson, Roehampton Institute
Frances E. Dolan, Miami University
Peter S. Donaldson, Massachusetts Institute of Technology
Patricia Dorval, Université Paul-Valéry
Gerald E. Downs, Redondo Beach, California
John Drakakis, University of Stirling
Annette Drew-Bear, Washington and Jefferson College
Heather Dubrow, University of Wisconsin, Madison
Mary Judith Dunbar, Santa Clara University
Katherine Duncan-Jones, Somerville College, Oxford
Leslie C. Dunn, Vassar College
Susan Michele Dunn, University of Kansas

Sara Eaton, North Central College
Paul Matthew Edmondson, The Shakespeare Institute
Katherine Egerton, ACTER, University of North Carolina,
Chapel Hill
W. R. Elton, Graduate Center, CUNY
Peggy Endel, Florida International University
Eugene England, Brigham Young University
Lars Engle, University of Tulsa
David Evelt, Cleveland State University
Inga-Stina Ewbank, University of Leeds
Kevin Ewert, The Shakespeare Institute

Margaret Ferguson, University of California, Davis
Janet Field-Pickering, Folger Shakespeare Library
Richard Finkelstein, SUNY, Geneseo
Mary Fissell, Johns Hopkins University
Agnes Marie Fleck, College of St. Scholastica
Robert Fleissner, Central State University
Stephen Merriam Foley, Brown University

John R. Ford, Delta State University
William S. Forester, Scholarly Engagement with
Anglican Doctrine
Charles Foraker, Indiana University
Valerie Forman, University of California, Santa Cruz
James H. Forse, Bowling Green State University
Jennifer Forsyth, University of Nevada, Reno
Douglas Freake, York University
Barbara Freedman, Tufts University
Coburn Freer, University of Georgia
Elizabeth French, University of North Carolina
William W. French, West Virginia University
Charles H. Frey, University of Washington
Michael D. Friedman, University of Scranton
Susan Frye, University of Wyoming
Minoru Fujita, Kansai University

Barry Gaines, University of New Mexico
Evelyn Gajowski, University of Nevada, Las Vegas
Lowell Gallagher, University of California, Los Angeles
Thomas Gandy, Texas A & M University, Texarkana
Gayle Gaskill, College of St. Catherine
Paul Gaudet, University of Western Ontario
George L. Geckle, University of South Carolina
Barbara T. Geisey, Kent State University
Marc Geisler, Western Washington University
David George, Urbana University
Loreen L. Giese, Ohio University
Edward Gieskes, Boston University
David Glimp, University of Miami
Maureen Godman, University of Kansas
W. L. Godshalk, University of Cincinnati
Jennifer Goldfarb, Lehigh University
Katharine Goodland, Polytechnic University
Phyllis Gorfain, Oberlin College
Melinda Gough, Oklahoma State University
Hugh Grady, Beaver College
Douglas E. Green, Augsburg College
William Green, Queens College, CUNY
Stephen Greenblatt, Harvard University
Thelma N. Greenfield, University of Oregon
David J. Greenman, Canisius College
Linda Gregerson, University of Michigan
Margaret Groome, University of Manitoba
Leah Gunther, University of Alabama, Tuscaloosa
Nancy A. Gutierrez, Arizona State University

Heidi Brayman Hackel, Oregon State University
Alexandra Halasz, Dartmouth College
David G. Hale, SUNY, Brockport
David B. Haley, University of Minnesota
Jay L. Halio, University of Delaware
Kim Hall, Georgetown University
Donna B. Hamilton, University of Maryland, College Park
William Hamlin, Idaho State University
Graham Hammill, University of Notre Dame
Nancy Glass Hancock, Austin Peay State University
Sara Hanna, New Mexico Highlands University
Katie Hannah, University of Alabama

Margaret Hannay, Siena College
Elizabeth Hanson, Queen's University
James L. Harner, Texas A & M University
Duncan Harris, University of Wyoming
Andrew James Hartley, State University of West Georgia
Michael Hattaway, University of Sheffield
Victoria Hayne, University of San Diego
Qixin He, Beijing Foreign Studies University
Richard Helgerson, University of California, Santa Barbara
Frances L. Helphinstine, Morehead State University
Linda Lizut Helstern, Southern Illinois University,
Carbondale
Kirk Hendershott-Kraetzer, Michigan State University
Diana Henderson, Massachusetts Institute of Technology
Peter C. Herman, San Diego State University
Niels Herold, Oakland University
A. Kent Hicatt, University of Western Ontario
Atsuhiko Hirota, University of Tokyo
James Hirsh, Georgia State University
Barbara Hodgdon, Drake University
Michael Holahan, Southern Methodist University
Peter D. Holland, The Shakespeare Institute
Michael Morgan Holmes, Georgetown University
Mychelle Hopkins, Kalamazoo Civic Theatre
Jean E. Howard, Columbia University
Skiles Howard, Irvington, New York
Kathy Howlett, Northeastern University
Christine Huber, University of North Carolina
Maurice Hunt, Baylor University
Dianne M. Hunter, Trinity College
Christine Hutchins, Graduate Center, CUNY
Peter Hyland, Huron College, University of Western Ontario

William Ingram, University of Michigan
Grace Ioppolo, American University
Robert Irish, University of Toronto
Megan L. Isaac, Youngstown State University
Edward Isser, College of the Holy Cross
Hiroko Ito, The Shakespeare Association of Japan

Russell Jackson, The Shakespeare Institute
Kathryn Jacobs, Texas A & M University, Commerce
Linda L. Jacobs, Francis Marion University
Theodora A. Jankowski, Washington State University
Nanette Jaynes, Tamkang University
Gloria Johnson, University of Oregon
Miranda Johnson-Haddad, Folger Shakespeare Library
Constance Jordan, Claremont Graduate University
John J. Joughin, University of Central Lancashire
John Jowett, The Shakespeare Institute

Rhoda S. Kachuck, University of La Verne
Coppelia Kahn, Brown University
Lauren E. Kehoe, Boston University
Kathleen Kelly, Babson College
William Kemp, Mary Washington College
Gwynne Kennedy, University of Wisconsin, Milwaukee
William Kerwin, University of Missouri, Columbia
Linc Kesler, Oregon State University

Harry Keyishian, Fairleigh Dickinson University
Marjorie Keyishian, Fairleigh Dickinson University
Katherine Kickel, John Carroll University
Frederick Kiefer, University of Arizona
Douglas King, Duquesne University
Rosalind King, Queen Mary and Westfield College
Arthur F. Kinney, University of Massachusetts, Amherst
Clare Kinney, University of Virginia
Bernice W. Kliman, Nassau Community College, SUNY
Robert S. Knapp, Reed College
Ric Knowles, University of Guelph
Roslyn L. Knutson, University of Arkansas, Little Rock
Yu Jin Ko, Wellesley College
Natasha Korda, Wesleyan University
Daniel Kulmala, University of Kansas
Stuart M. Kurland, Duquesne University
Martha A. Kurtz, Toronto, Ontario

James H. Lake, Louisiana State University, Shreveport
Sikandar Lal, University of Delhi
Anne Lancashire, University College, Toronto
Ian Lancashire, University of Toronto
Joan Hutton Landis, Curtis Institute of Music
Robert Lane, North Carolina State University
Douglas Lanier, University of New Hampshire
Gregory W. Lanier, University of West Florida
Rebecca Laroche, University of Colorado, Colorado Springs
Campbell Lathey, Albany, New York
Mark Lawhorn, University of Hawaii, Manoa
Judiana Lawrence, St. John Fisher College
Alexander Leggatt, University of Toronto
Courtney Lehmann, Indiana University, Bloomington
Theodore B. Leinwand, University of Maryland, College Park
Joe Lenz, Drake University
Kate D. Levin, City College, CUNY
Richard Levin, SUNY, Stony Brook
Richard A. Levin, University of California, Davis
Nina Levine, University of South Carolina
Murray Levith, Skidmore College
James A. Lewin, Shepherd College
Leanore Lieblein, McGill University
Naomi C. Liebler, Montclair State University
David Linton, Marymount Manhattan College
Joan Pong Linton, Indiana University
William T. Liston, Ball State University
Arthur L. Little, Jr., University of California, Los Angeles
Megan Lloyd, King's College
Angela Locatelli, Università de Bergamo
James N. Loehlin, Dartmouth College
Donna J. Long, Florida State University
William B. Long, Brooklyn, New York
Jeremy Lopez, Cornell University
Bryan Loughrey, Roehampton Institute
Genevieve Love, Cornell University
Jennifer Low, Florida Atlantic University
John E. Luebering, University of Chicago
James P. Lusardi, Lafayette College
Teresa Lyle, Miami University
Kathleen Lynch, Folger Shakespeare Library

Margaret Lynch, Great Lakes Theater Festival
 Sarah Lyons, Boston University

Joyce Green MacDonald, University of Kentucky
 Michael MacDonald, University of Michigan
 Ronald R. Macdonald, Smith College
 Laurie E. Maguire, University of Ottawa
 John W. Mahon, Iona College
 Irena Makaryk, University of Ottawa
 Willy Maley, Glasgow University
 Eric S. Mallin, University of Texas, Austin
 Howard Marchitello, Texas A & M University
 James Mardock, University of Wisconsin, Madison
 Elise Marks, Kenyon College
 Jean Marsden, University of Connecticut
 Cynthia Marshall, Rhodes College
 Randall Martin, University of New Brunswick
 Steven Marx, California Polytechnic State University,
 San Luis Obispo

Pamela Mason, The Shakespeare Institute
 Jeffrey Masten, Harvard University
 Julia Matthews, Kennesaw State University
 Margaret Maurer, Colgate University
 Cary M. Mazer, University of Pennsylvania
 Phyllis McBride, Texas A & M University
 David McCandless, Carleton College
 Penny McCarthy, University of Sussex
 Kristen McDermott, Spelman College
 Russ McDonald, University of North Carolina, Greensboro
 Claire McEachern, University of California, Los Angeles
 Tricia A. McElroy, University of Georgia
 Ann M. McEntree, Illinois College
 C. Edward McGee, University of St. Jerome's College
 Philip C. McGuire, Michigan State University
 Linda McJannet, Bentley College
 Randy McLeod, Erindale College, University of Toronto
 Kathleen E. McLuskie, University of Southampton
 Laurie McMillan, Duquesne University
 Scott McMillin, Cornell University
 Fiona McNeill, Columbia University
 Paula McQuade, University of Chicago
 John S. Mebane, University of Alabama, Huntsville
 Dieter Mehl, University of Bonn
 Steve Mentz, Yale University
 Robert P. Merrixx, University of Akron
 Mary Janell Metzger, Western Washington University
 David L. Middleton, Trinity University
 Jodi Mikalachki, Wellesley College
 David Mikics, University of Houston
 Naomi J. Miller, University of Arizona
 Shannon Miller, Temple University
 Robert S. Miola, Loyola College in Maryland
 Alfredo Michel Modenessi, Universidad Nacional Autónoma
 de México

John Moore, Pennsylvania State University
 Simon Morgan-Russell, Bowling Green State University
 Maryclaire Moroney, John Carroll University
 Nan Morrison, College of Charleston
 Anthony Mortimer, Misericorde, Fribourg

Stephanie Moss, University of South Florida
 Ian Frederick Moulton, Arizona State University West
 Barbara Mowat, Folger Shakespeare Library
 Michael Mullin, University of Illinois, Urbana-Champaign
 Richelle Munkhoff, University of Wisconsin, Madison

Randall Nakayama, San Francisco State University
 Frances Ambrosia Nakiwala, Duquesne University
 Carol Thomas Neely, University of Illinois, Urbana-
 Champaign

Michael Neill, University of Auckland
 Paul D. Nelsen, Marlboro College
 Alan H. Nelson, University of California, Berkeley
 Lori Newcomb, University of Illinois, Urbana
 Louisa Foulke Newlin, Folger Shakespeare Library
 Kelly Newman, Montgomery Blair High School
 Kim H. Noling, Hartwick College
 Alan Nordstrom, Rollins College
 Marianne Novy, University of Pittsburgh

Frank Occhiogrosso, Drew University
 Marion O'Connor, University of Kent, Canterbury
 Sharon O'Dair, University of Alabama
 Susan Oldrieve, Baldwin-Wallace College
 Francis R. Olley, St. Joseph's University
 Kristen L. Olson, Case Western Reserve University
 Susan O'Malley, CUNY, Kingsborough
 Stephen Orgel, Stanford University
 Martin Orkin, University of the Witwatersrand
 Lena Cowen Orlin, University of Maryland, Baltimore County
 Jill Orolino, Boston University
 Laurie E. Osborne, Colby College
 Helen Ostovich, McMaster University
 Avraham Oz, University of Haifa

Richard A. Pacholski, Millikin University
 Nini Pal, Marianopolis College
 Barbara D. Palmer, Mary Washington College
 Daryl W. Palmer, University of Akron
 Lalita Pandit, University of Wisconsin
 Barbara L. Parker, William Paterson University
 Peter Parolin, University of Wyoming
 David Pascoe, Glasgow University
 Gail Kern Paster, George Washington University
 Edward Pechter, Concordia University
 Thomas A. Pendleton, Iona College
 Cynthia Perantoni, Youngstown State University
 J. Duke Pesta, University of Tennessee, Martin
 Douglas L. Peterson, Michigan State University
 Jean Peterson, Bucknell University
 Kaara L. Peterson, Boston University
 Patricia Phillippy, Texas A & M University
 David E. Phillips, Charleston Southern University
 Robert B. Pierce, Oberlin College
 Marie Plasse, Merrimack College
 Lois Potter, University of Delaware
 Alan W. Powers, Bristol Community College
 Maria Teresa Micaela Prendergast, University of
 South Alabama

Arnold W. Preussner, Truman State University
 Diana Price, Cleveland, Ohio
 Albert Prince, Marietta Psychological Services
 Alison H. Prindle, Ohio Wesleyan University
 Dennis Prindle, Ohio Wesleyan University
 Richard Proudfoot, King's College, London
 Ingrid Pruss, Western Connecticut State University

Phyllis Raekin, University of Pennsylvania
 Michael Radice, The Union Institute
 Shankar Ramam, Massachusetts Institute of Technology
 Reginald Rampone, Jr., Quinsigamond Community College
 Margaret Loftus Ranald, Queens College, CUNY
 Ralph Arthur Ranald, Hunter College, CUNY
 Nicholas Ranson, University of Akron
 M. Ann Reed, University of Minnesota
 Robert L. Reid, Emory and Henry College
 Terry Reilly, University of Alaska, Fairbanks
 Constance C. Relihan, Auburn University
 Lawrence F. Rhu, University of South Carolina
 Jennifer Rich, Graduate Center, CUNY
 Jeanette Fuller Ridgway, San Diego State University
 Barbara Riebling, University of Toledo
 Milla C. Riggio, Trinity College
 David Riggs, Stanford University
 Christopher Roark, John Carroll University
 Jeanne A. Roberts, American University
 Markley Roberts, American University
 Karen Robertson, Vassar College
 Benedict Scott Robinson, Columbia University
 Randal Robinson, Michigan State University
 Edward L. Rocklin, California State Polytechnic University,
 Pomona

John Roe, University of York
 Clifford Ronan, Southwest Texas State University
 Mary Beth Rose, University of Illinois, Chicago
 Alan Rosen, Bar-Ilan University
 Laura J. Rosenthal, Florida State University
 Kenneth S. Rothwell, University of Vermont
 Martha Tuck Rozett, SUNY, Albany
 Anne Russell, Wilfrid Laurier University
 Peggy A. Russo, Pennsylvania State University

Rachana Sachdev, Susquehanna University
 James P. Saeger, Vassar College
 Brownell Salomon, Bowling Green State University
 Patricia P. Salomon, University of Findlay
 David Sauer, Spring Hill College
 Robert Sawyer, University of Georgia
 David Schalkwyk, University of Cape Town
 Katherine West Scheil, St. Joseph College
 June Schlueter, Lafayette College
 Sharon Schuman, Clark Honors College, University of
 Oregon

William O. Scott, University of Kansas
 Barbara Sebek, Colorado State University
 Tracy Sedinger, University of Northern Colorado
 G. B. Shand, Glendon College, York University
 Michael Shapiro, University of Illinois, Urbana-Champaign

Jo Anne Shea, Berry College
 Michael Shea, Southern Connecticut State University
 Lois Sherlow, Memorial University of Newfoundland
 Frances A. Shirley, Wheaton College
 Lauren Shohet, Villanova University
 Debora K. Shuger, University of California, Los Angeles
 Michael W. Shurgot, South Puget Sound Community College
 James R. Siemon, Boston University
 Jyotsna Singh, Southern Methodist University
 Bethany S. Sinnott, Catawba College
 William W. E. Slight, University of Saskatchewan
 Ian D. Smith, Lafayette College
 M. Rick Smith, Kent State University
 Sarah E. Smith, University of Wisconsin, Madison
 Susan Snyder, Swarthmore College
 Andrea Solomon, Columbia University
 Dana Sonnenschein, Southern Connecticut State University
 Geraldo U. de Sousa, Xavier University
 Susan Spector, Baruch College, CUNY
 Eric V. Spencer, Albertson College of Idaho
 Louis Charles Stagg, University of Memphis
 Peter Stallybrass, University of Pennsylvania
 Goran V. Stanivukovic, University College of Cape Breton
 Audrey Stanley, University of California, Santa Cruz
 Kay Stanton, California State University, Fullerton
 Lisa S. Starks, Texas A & M University, Commerce
 Scott Manning Stevens, Arizona State University
 Michelle Stie, University of Kansas
 Jan Stirm, Monmouth College
 Marta Straznicki, Queen's University
 Elizabeth M. Sturgeon, Northwestern University
 Ellen Summers, Hiram College
 Andrea Sununu, DePauw University

Edmund M. Taft, Marshall University
 Gary Taylor, University of Alabama
 Louise Taylor, Evanston, Illinois
 Nancy Taylor, Tufts University
 Frances Teague, University of Georgia
 Ann Thompson, Roehampton Institute
 Leslie Thomson, University of Toronto
 Dominique Tieman, Michigan State University
 Grace Tiffany, Western Michigan University
 J.J.M. Tobin, University of Massachusetts, Boston
 Barbara Todd, University of Toronto
 Michael Torrey, La Salle University
 Barbara H. Traister, Lehigh University
 Valerie Traub, University of Michigan
 Douglas Trevor, Harvard University
 Elliott Trice, Columbia University
 Marion Trousdale, University of Maryland, College Park
 Anne Turner, Folger Shakespeare Library
 Henry S. Turner, Columbia University

Verne Underwood, Rogue Community College
 Steven Urkowitz, City College, CUNY

Alden Vaughan, Columbia University
 Virginia Mason Vaughan, Clark University

Jennifer C. Vaught, Northern Michigan University
John W. Velz, University of Texas
Helen Vendler, Harvard University
Paul J. Voss, Georgia State University

Michael F. Walker, Boston University
Clare-Marie Wall, California State University, Fresno
Wendy Wall, Northwestern University
Mason Y. H. Wang, Saginaw Valley State University
Jay A. Ward, Thiel College
Kathleen A. Ward, Kent State University
Jeanie E. Warnock, University of Ottawa
Michael Warren, University of California, Santa Cruz
Edward T. Washington, Mansfield University
John M. Wasson, Washington State University
Robert N. Watson, University of California, Los Angeles
Valerie Wayne, University of Hawaii, Manoa
Heidi S. Webb, University of Chicago
Alan S. Weber, Pennsylvania State University, Wilkes-Barre
Herb Weil, University of Manitoba
Judith Weil, University of Manitoba
James W. Wells, Ohio University
Stanley Wells, Shakespeare Birthplace Trust, University of Birmingham
Sarah H. Werner, University of Pennsylvania
Paul Werstine, King's College, University of Western Ontario
Suzanne R. Westfall, Lafayette College
Richard F. Whalen, Truro, Massachusetts
Richard P. Wheeler, University of Illinois, Urbana-Champaign
Frank Whigham, University of Texas, Austin
D. Jerry White, Central Missouri State University
Paul Whitfield White, Purdue University

Charles Whitney, University of Nevada, Las Vegas
Sarah Greenleaf Whittier, University of California, Santa Cruz
Rachel Wifall, New York University
Matthew Wikander, University of Toledo
Gary Jay Williams, Catholic University of America
George W. Williams, Duke University
Owen Williams, University of Pennsylvania
William Proctor Williams, Northern Illinois University
Jane Williamson, University of Missouri, St. Louis
Deborah Willis, University of California, Riverside
Robert F. Willson, Jr., University of Missouri, Kansas City
Emily Wilson, Yale University
Laura B. Wilson, University of Colorado, Boulder
Donald R. Wineke, Wichita State University
Linda Woodbridge, Pennsylvania State University
Thomas F. Worden, Georgetown University
William B. Worthen, University of California, Davis
George T. Wright, University of Minnesota

Paul Yachnin, University of British Columbia
Lingui Yang, Texas A & M University
Sharon R. Yang, Eastern Connecticut State University
Julian Yates, University of Delaware
Winifred Yin, The Shakespeare Institute
Michael Yogev, University of Haifa
Alan R. Young, Acadia University
Bruce W. Young, Brigham Young University
Luo Zhiye, Nanchang University
Yupei Zhou, University of Akron
Georgianna Ziegler, Folger Shakespeare Library

Over 400 adoptions at colleges and universities worldwide

THE NORTON SHAKESPEARE

Based on the Oxford Edition

Stephen Greenblatt, *General Editor*

Walter Cohen, Jean E. Howard, and Katharine Eisaman Maus

"The Norton Shakespeare is the finest teaching edition of Shakespeare that I'm aware of."

—Norman Leer, *Roosevelt University*

THE NORTON SHAKESPEARE WORKSHOP CD-ROM

Edited by Mark Rose

"This is fabulous. The CD-ROM problematizes the text in interesting ways for today's computer-literate student."

—Donna Wolfe, *University of Pittsburgh*

"Excellent. Thoroughly up-to-date. Convenient and well laid-out."

—Roger Prior, *Queen's University at Belfast*

WILLIAM SHAKESPEARE

A Textual Companion

By Stanley Wells and Gary Taylor, with John Jowett and William Montgomery

Visit us on the Web: www.wwnorton.com

Toll-free information: Phone: (800) 233-4830

Fax: (800) 458-6515

mellen

Mellen Press
PO Box 450
Lewiston, NY
14092-0450

invites you to propose your work for publication with us. See our representative at the Mellen book or call our Acquisitions Editor at (716) 754-2266.

Recent Titles

MIRTH AND MORALITY OF SHAKESPEARE'S HOLY FOOLS by Sandra J. Pyle

Table of contents:

Foreword by Albert C.

Labriola

Introduction: Shakespeare's

Medieval Mirth and Morality

The Holy Fool's Prayer

Shakespeare's Holy Fools and

Their Priestly Mission

Feste as Curate Exorcises

Pride in *Twelfth Night*

The Fool Scourges Envy in *King Lear*

Petruchio Combats Anger in *The Taming of the Shrew*

Physician Heal Thyself - Hamlet, the Clown Prince, Purges Sloth

Portia Prosecutes Avarice in *The Merchant of Venice*

Prince Hal Foils Gluttony in *Henry IV, 1 & 2*

Bottom, the Uncourtly Lover, Nullifies Lust in *A Midsummer Night's Dream*

Dancing with the Holy Fool

Appendix: Translation of "Medicines to Cure the Deadly Sins"

284pp. 1997

"The inestimable value and validity of Dr. Pyle's approach emerge from discerning the traces of medieval drama in Shakespeare's oeuvre and explaining their integration and adaptation into a richer and more sophisticated dramaturgy. . . . No commentator has provided a more compelling case for such an assertion than Dr. Pyle."

—Albert C. Labriola

A DICTIONARY OF SHAKESPEARE'S SEMANTIC WORDPLAY by Gilian West



This work demonstrates that Shakespeare uses semantic puns as a device of style, like metre or imagery, for various dramatic purposes and to a far greater extent than has been recognised, in tragedy as in comedy. It persuades the reader to examine the contribution punning makes to the pleasure and emotional effect of the plays. 248pp. 1998

Mellen also publishes the **Shakespeare Yearbook**



W. W. Norton & Company, Inc.
500 Fifth Avenue, New York, NY 10110

Celebrating 75 Years of Independent Publishing