



1 April, 2026

Shakespeare Association of America

54TH ANNUAL MEETING

Hyatt Regency Denver at Colorado Convention Center
Denver, CO



Shakespeare Association of America

Department of English
University of Mississippi
C-128 Bondurant Hall
P.O. Box 1848
University, MS 38677-1848

TELEPHONE

662.915.2477

FACSIMILE

662.915.5787

E-MAIL

shakespeare@olemiss.edu

WEBSITE

www.shakespeareassociation.org

HASHTAG

#shax2026

WI-FI PASSWORD

Shax2026

Dear SAAers,

It's a strange experience to write a farewell letter to the SAA when I'm not actually leaving the organization or anyone in it—but I will be signing off as Executive Director at the end of May and returning to a simpler role as a member and conference attendee. Rather than missing you all, I hope that I'll actually be seeing more of you at our conferences! What I will miss, however, is the extraordinary colleagues who have made my time in office a genuine pleasure, especially the officers and Trustees over the years who have worked together so harmoniously and given me the advantage of their wisdom and support. We have a unique organization: few other such academic groups can command the goodwill of so many over such a long arc of development and evolution. The work of making that happen involves everyone, from new graduate student members to former Presidents and Board members. All of you have been collaborators in the valuable ongoing project that is the SAA. I'm happy that such collaboration can continue under the steady guidance of our capable and experienced incoming Executive Director, Tricia McElroy. Meanwhile, remember to have fun at the 2026 Annual Meeting even while you do serious work—we need more joy always, but especially in present times.



Warm regards,

A handwritten signature in black ink, appearing to read 'Karen Raber'. The signature is fluid and cursive, with a long horizontal stroke at the end.

Karen Raber, *Executive Director*



OFFICERS

EXECUTIVE DIRECTOR

Karen Raber
University of Mississippi

ASSISTANT DIRECTOR

Bi-qi Beatrice Lei

PROGRAM ASSOCIATE

Donna Even-Kesef
Stanford University

PROJECT COORDINATOR

Anne Freeman
University of Mississippi

FINANCIAL ADVISOR

Melody Fetske

SOCIAL MEDIA INTERN

Anna Hegland
Carthage College

With the Assistance of

Jackie Hopkins
Christa Hegland

PROGRAM PLANNING
COMMITTEE

Wendy Beth Hyman
Oberlin College, Chair

Adhaar Noor Desai
Bard College

Allison Deutermann
Baruch College, CUNY

Joseph Gamble
University of Toledo

Bernadette Myers
Washington University in St. Louis

Noémie Ndiaye
University of Chicago

Adam Zucker
University of Massachusetts, Amherst

DIGITAL EXHIBITS
SUBCOMMITTEE

Sarah F. Williams
University of South Carolina, Chair

Jennifer Linhart Wood
George Mason University

BOARD OF TRUSTEES

PRESIDENT

Ruben Espinosa

Arizona State University

VICE PRESIDENT

Lucy Munro

King's College London

TRUSTEES

Katie Brokaw

University of California, Merced

Urvashi Chakravarty

University of Toronto

Simone Chess

Wayne State University

Vanessa I. Corredera

Andrews University

Drew Daniel

Johns Hopkins University

Timothy Francisco

Youngstown State University

Penelope H. Geng

Macalester College

Wendy Beth Hyman

Oberlin College

Kathryn Vomero Santos

Trinity University

LOCAL ARRANGEMENTS COMMITTEE

Roze Hentschell

Colorado State University, Chair

Sharon Harris

Brigham Young University

Julia Schleck

Colorado State University

David Glimp

University of Colorado, Boulder

Jonathan Lamb

University of Kansas

David Preiss

University of Utah

Peter Parolin

University of Wyoming

Kelly Stage

University of Nebraska

SPONSORS

ACMRS, Arizona Center for Medieval
and Renaissance Studies

Brigham Young University

Colorado State University

Digital Theatre+

Drama Online

Folger Shakespeare Library

Guthrie Theater

The Malone Society

Shakespeare Quarterly

University of Colorado Boulder

University of Kansas

University of Nebraska

University of Utah

University of Wyoming

Utah Valley University

And

University of Mississippi



DONORS

The Shakespeare Association of America would like to thank all of you who gave to our Annual Fund Drive in 2025. We are especially grateful to the members below who contributed \$100 or more.

Anonymous
Richard Abel
Elaine Beilin
David Bergeron
Valerie Billing
Gina Bloom
Emily Bryan
James Bulman
Rebecca Bushnell
Kent Cartwright
Stephanie Chamberlain
Vanessa Corredera
Jane Degenhardt
Katherine Eggert
William Engel
Lars Engle
Ruben Espinosa
Margaret Ferguson
Catherine Field
Mary Floyd-Wilson
Lily Freeman-Jones
Penelope Geng
Suzanne Gossett
Miles Grier
Kim Hall
Diana Henderson
Michael Hirrel
Peter Holland
Jean Howard
Wendy Hyman
Farah Karim-Cooper

Harry Keyishian
Douglas Lanier
Naomi Liebler
Arthur Little, Jr.
Julia Lupton
Lynne Magnusson
Adam McKeown
Lucy Munro
Vin Nardizzi
James Newlin
Patricia Parker
Gail K. Paster
Tanya Pollard
Maria Teresa Prendergast
Karen Raber
Eric Schroeder
Courtney Scuro
Emma Smith
Ayanna Thompson
Amy Tigner Art
Evelyn Tribble
Henry Turner
Steven Urkowitz
Virginia Vaughan
Wendy Wall
William N. West
W. B. Worthen

Admission to conference events is by name badge only.

EXHIBITORS

ACMRS Press
The Arden Shakespeare
Cambridge University Press
Digital Theatre+
myShakespeare

The Scholar's Choice
Shakespeare at Notre Dame
University of Chicago Press Journals
University of Pennsylvania Press

AWARD WINNERS

The SAA Innovative Article Award

Amrita Dhar, *University of California, San Diego*

Amrita Sen, *University of Calcutta*
Two Nations, Both Alike:
Shakespeare in Bengal

RUNNERS-UP

Hillary Eklund, *Grinnel College*

Jennifer Park, *University of Glasgow*

Debapriya Sarkar, *University of Connecticut*

Ayanna Thompson, *Arizona State University*
Becoming Undisciplined: On
pathways to Environmental and Racial
Justice in Early Modern Studies

Taylor Hare, *Pennsylvania State University*
Shakespeare by Touch: Tactile
Reading and N. B. Kneass Jr.'s
Merchant of Venice (1870)

Kathryn Vomero Santos, *Trinity University*
"Th'oppressor's wrong," or What's
Hamlet to the Borderlands?

Robert Stagg, *Texas A&M University*
Shakespeare's Arabic Sonnets

Barbara Hodgdon Award

Alexa Alice Joubin, *George Washington University*
"The Greater Globe Itself": An
Introduction to Shakespeare
in Heterotopia

HONORABLE MENTION

Amrita Dhar, *University of California, San Diego*
Shakespeare, Race, and Disability:
Othello and the Wheeling Strangers
of Here and Everywhere

The SAA Publics Award

LARGER PUBLIC

Elyse Sharp, *Sacramento, CA*
Kourtney Smith, *Shakespeare Institute*
Shakespeare Anyone? Podcast

LOCAL OR SMALLER

Ilker Özçelik,
Süleyman Demirel University
International Shakespeare
Festival in Turkey
Peter Kuling, *University of Guelph*
Shakespeare VR Experiences

HONORABLE MENTION

Alexa Alice Joubin,
George Washington University
Screening Shakespeare,
Open-Access Textbook and AI

SAA-Folger Fellowship

Hassana Moosa
University of Cape Town
Rehearsing Bondage:
Performing Racial Slavery on
the English Stage (1550-1670)



2026 PROGRAM AT A GLANCE

All program events are open to all registered members unless otherwise designated: roundtables and panels are larger sessions where speakers address an audience, while seminars and workshops are smaller sessions where seminar participants are in conversation about work circulated and read in advance of the conference. Seminars and workshops are open to auditor attendees who may observe the event and, at the discretion of the session leader(s) may have limited opportunities to participate in discussion at the end of the session. For more information on participation guidelines, see the SAA website.

| WEDNESDAY, 1 APRIL | | | | Pg# |
|--------------------|--------------------------------------|---|------------------|-----------|
| 4:00 p.m. | Registration | Programs, name tags, tickets, information | Centennial Foyer | 14 |
| 5:00 p.m. | Meeting | Opening Welcome and Business Meeting | Centennial F | 14 |
| 6:00 p.m. | Social Gathering and Cash Bar | Open to registrants and registered guests | Centennial Foyer | 14 |

| THURSDAY, 2 APRIL | | | | Pg# |
|-------------------|----------------------------|---|------------------|-----------|
| 7:30 a.m. | Registration | Registration | Centennial Foyer | 14 |
| 8:00 a.m. | Book Exhibits | Book Exhibits | Centennial A | 14 |
| | Professionalization | Publishing in an Academic Journal: A Discussion by Journal Editors | Agate C | 14 |
| 8:30 a.m. | Seminar | The Adaptability of Adaptation | Mineral D | 14 |
| | Seminar | Baz Luhrmann's <i>William Shakespeare's Romeo + Juliet</i> at Thirty (Hybrid Session) | Mineral A | 15 |
| | Workshop | Book Proposal Lab | Mineral E | 15 |
| | Seminar | Child Performance | Granite B | 15 |
| | Seminar | Community and the Scapegoat | Mineral C | 16 |
| | Seminar | Comparative Sexualities: Shakespeare and His Contemporaries (Hybrid Session) | Mineral F | 16 |
| | Seminar | Contemporary Pedagogies of Reading Early Modern Literature | Mineral B | 16 |
| | Seminar | Early Modern Eco-Memory | Granite C | 16 |
| | Seminar | Faculty/Student Collaboration in the Under-graduate Shakespeare Classroom | Quartz B | 17 |
| | Seminar | From Commonplaces to Databases: The So-cial Memory of Proverbs | Virtual | 17 |
| | Seminar | Postcolonial Shakespeares (Hybrid Session) | Mineral G | 17 |
| | Seminar | Race and Anglo-Iberian Literary Exchanges | Granite A | 17 |
| | Seminar | Shakespeare and Belonging | Agate A | 17 |
| | Seminar | Shakespeare and Elite Culture: Performing Whiteness Beyond the Anglophone | Virtual | 18 |

| | | | | |
|------------------------|-------------------------------|---|------------------|------------|
| | Seminar | Shakespeare and the Forms of Religion | Quartz A | 18 |
| | Workshop | Strategic Shakespeares | Agate B | 18 |
| 11:00 a.m. | Panel | Lyric Attachments | Centennial F | 18 |
| | Panel | Book Salon: Seeing Through Shakespeare | Centennial G | 18 |
| 1:00 p.m. | Meeting | Early Modern Community of Care | Mineral A | 19 |
| 2:00 p.m. | Professionalization | CV Review and Career Mentoring | Agate C | 19 |
| 2:00 p.m. | Seminar | <i>Essaying Shakespeare (Hybrid Session)</i> | Mineral G | 20 |
| | Open Workshop | Fencing in Shakespeare's World | Centennial H | 20 |
| | Seminar | The Future of Renaissance (Non-Human) Animal Studies | Quartz A | 20 |
| | Seminar | Generation Shakespeare: YA Adaptations | Granite B | 20 |
| | Seminar | How to Use <i>King Lear</i> | Quartz B | 20 |
| | Seminar | Manuscript Cultures/Theatrical Cultures | Mineral B | 21 |
| | Seminar | New Directions in Shakespeare and the Bible | Agate A | 21 |
| | Seminar | Performing Gender and Sexuality in Shakespeare: Theory and Praxis | Granite C | 21 |
| | Seminar | Performing Repetition | Mineral E | 21 |
| | Seminar | Preternatural Shakespeare | Mineral C | 21 |
| | Seminar | Rethinking Original Practices (Hybrid Session) | Mineral F | 22 |
| | Workshop | Shakespeare and Community-Based Practice | Granite A | 22 |
| | Seminar | Silence on Stage | Agate B | 22 |
| | Seminar | Variorum Shakespeare | Mineral D | 22 |
| 3:00 p.m. | Meeting | SAA Stitchers | Mineral A | 23 |
| 4:30 p.m. | Panel | Beyond New Materialism: Political Ecology and Early Modern Drama | Centennial F | 23 |
| | Panel | Imaginary Shakespeares: Creative and Scholarly | Centennial G | 24 |
| 5:30 p.m. | Graduate Student Event | Graduate Coffee/Tea Social Hour | Mineral A | 24 |
| 6:30 p.m. | Reception | Annual Reception | Centennial E | 24 |
| FRIDAY, 3 APRIL | | | | Pg# |
| 7:30 a.m. | Yoga | Shakespeare Yoga | Agate C | 24 |
| 8:00 a.m. | Breakfast | Graduate Student Breakfast | Centennial E | 24 |
| | Registration | Registration | Centennial Foyer | 24 |
| | Book Exhibits | Book Exhibits | Centennial A | 24 |
| 9:00 a.m. | Panel | Shakespeare Futures Panel: Contingency: The State of Our Field | Centennial G | 24 |



54TH ANNUAL MEETING

Shakespeare Association of America

| | | | | |
|------------|------------------------|--|------------------|-----------|
| | Film Screening | <i>Acting</i> | Centennial H | 25 |
| | Panel | The Early Modern Antiquarian Analytic: Words, Print, Plays | Centennial F | 25 |
| 10:30 a.m. | Break | Coffee Break | Centennial Foyer | 25 |
| | Social | Book Celebration | Centennial Foyer | 25 |
| 11:00 a.m. | Workshop | Air & Breath in Macbeth: A Scholar-Practitioner Convergence | Granite B | 25 |
| | Seminar | Audio Shakespeare Around the World: Ra-dio, Recordings, Internet | Agate A | 25 |
| | Seminar | Creative-Critical Engagements with the Re-naissance | Mineral A | 26 |
| | Seminar | The Many Lives of <i>The Shrew</i> | Quartz A | 26 |
| | Seminar | On Glossing | Mineral E | 26 |
| | Seminar | Play On: Shakespeare and Video Games | Mineral D | 26 |
| | Seminar | The Poetics of the Page | Mineral C | 26 |
| | Seminar | Power Dressing | Granite C | 28 |
| | Seminar | REED at 50: Prospects and Retrospects | Mineral B | 28 |
| | Seminar | Representation, Politics, and Performance | Mineral G | 28 |
| | Workshop | Rescuing Romance | Virtual | 28 |
| | Seminar | Rethinking City Comedy | Granite A | 28 |
| | Seminar | Shakespeare, AI, and Virtuality | Mineral F | 29 |
| | Seminar | Whiteness and the Comic | Quartz B | 29 |
| 1:30 p.m. | Annual Luncheon | Annual Luncheon | Centennial D-E | 29 |
| 3:30 p.m. | Plenary Panel | Plenary Panel: Editing Race, Sex, and <i>Othello</i> | Centennial F-G | 29 |
| 5:15 p.m. | Reception | Scholars of Color Social | Centennial E | 29 |
| 6:30 p.m. | Performance | <i>BIOPhelia</i> | Centennial H | 30 |

| SATURDAY, 4 APRIL | | | | Pg# |
|-------------------|------------------------|--|------------------|-----------|
| 7:30 a.m. | Yoga | Shakespeare Yoga | Agate C | 30 |
| 8:00 a.m. | Information | Information | Centennial Foyer | 30 |
| | Book Exhibits | Book Exhibits | Centennial A | 30 |
| 9:00 a.m. | Panel | Makers, Making and the Made in Early Modern Theatrical Culture and Its Reproductions | Centennial F | 30 |
| | Panel | Mapping Spatial Habits in Early Modernity | Centennial G | 30 |
| 10:00 a.m. | Digital Exhibit | Early Modern England Encyclopedia | Centennial Foyer | 31 |

| | | | | |
|------------|----------------------------|--|------------------|-----------|
| | Digital Exhibit | Open-Access AI & Textbook: <i>Screening Shakespeare</i> | Centennial Foyer | 31 |
| | Digital Exhibit | <i>Points Like A Man: The Shakespearean Breeches Performance Catalogue, 1660-1900</i> | Centennial Foyer | 31 |
| | Digital Exhibit | <i>Shakespeare's Theaterscape</i> | Centennial Foyer | 31 |
| | Digital Exhibit | <i>We'll Hear a Play: Early Modern Performances Online</i> | Centennial Foyer | 31 |
| 10:30 a.m. | Coffee Break | Coffee Break | Centennial Foyer | 31 |
| 11:00 a.m. | Plenary Panel | NextGenPlen | Centennial F-G | 31 |
| 1:00 p.m. | Professionalization | CV Review and Career Mentoring | Agate C | 31 |
| 1:00 p.m. | Meeting | The Guild of Queer Early Modernists Meeting | Mineral E | 31 |
| 2:30 p.m. | Panel | Shakespeare and Neurodiversity | Centennial F | 32 |
| | Panel | Theatre History in Dialogue | Centennial G | 32 |
| 4:30 p.m. | Seminar | Ethical Plurality on the Early Modern Stage | Quartz A | 32 |
| | Seminar | Labor and Early Modern Literature | Granite C | 32 |
| | Seminar | New World Theatricality | Agate B | 33 |
| | Seminar | Overwhelmed | Mineral D | 33 |
| | Seminar | Shakespeare and Nonsense | Granite B | 34 |
| | Seminar | Shakespeare's Sentences | Mineral G | 34 |
| | Seminar | The Sonic Laboratory of the Renaissance Theater | Agate A | 34 |
| | Seminar | Speaking the Speech | Quartz B | 34 |
| | Workshop | Teaching Early Modern Gender, Sexuality, and Care of the Body | Mineral A | 34 |
| | Seminar | Theatrical and Environmental Encounters | Granite A | 34 |
| | Seminar | Unearthing | Mineral C | 35 |
| | Seminar | White Sophistry and Epistemicide in Shakespeare Then and Now | Mineral B | 35 |
| | Seminar | "A Whole Theater of Others": Presenting and Representing the Playgoers in Shakespeare's Playhouses | Mineral F | 35 |
| 6:30 p.m. | Cash Bar | ACMRS Cash Bar | Centennial Foyer | 35 |
| 7:00 p.m. | Film Screening | <i>The Tempest</i> | Centennial F | 36 |
| 10:00 p.m. | Dance | The Malone Society Dance | Centennial E | 36 |

ASYNCHRONOUS SESSION

| | | |
|------------------|-----------------------------|-----------|
| Practicum | Articles in Progress | 36 |
|------------------|-----------------------------|-----------|



HYATT REGENCY DENVER AT COLORADO CONVENTION CENTER

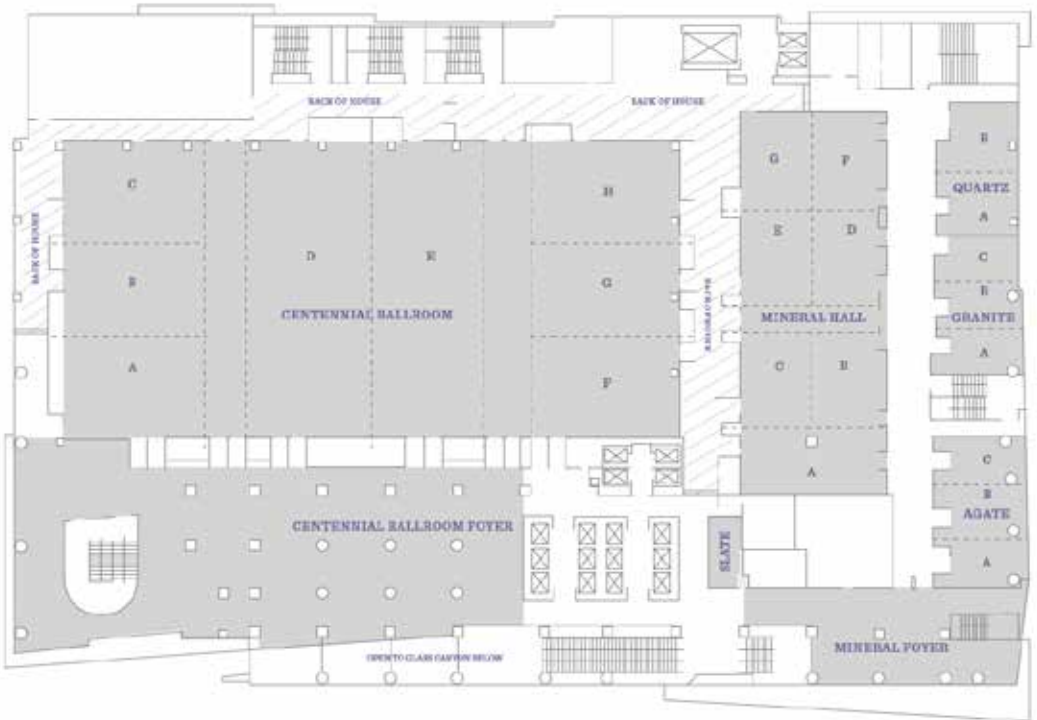

BOOK EXHIBITS

Browse recent publications and meet informally with representatives from several presses.

| Exhibitors | Table(s) |
|---|----------|
| ACMRS Press..... | 1 |
| myShakespeare..... | 2 |
| University of Pennsylvania Press..... | 3 |
| Digital Theatre+..... | 4 |
| Shakespeare at Notre Dame..... | 5 |
| Cambridge University Press..... | 6-7 |
| The Arden Shakespeare..... | 8-9 |
| The Scholar's Choice..... | 10 |
| University of Chicago Press Journals..... | 11 |
| OPEN for Brochures..... | 12 |

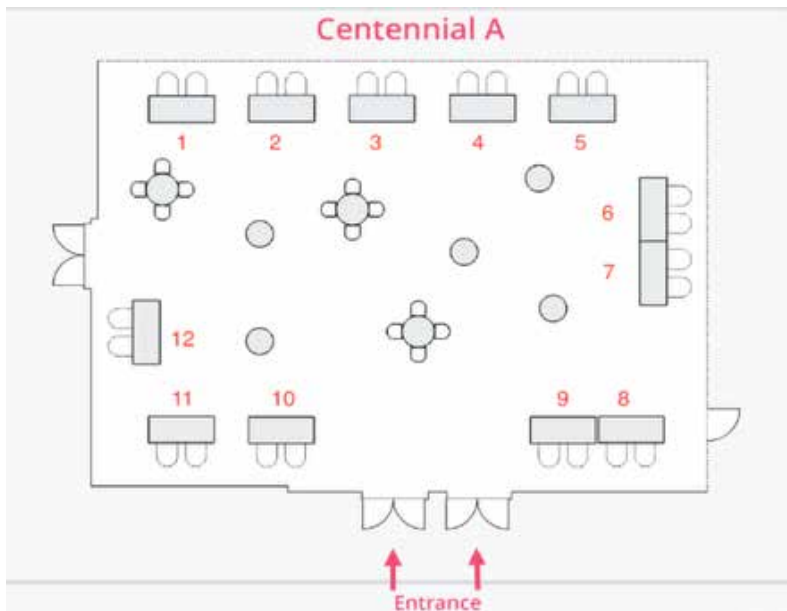



PROGRAM DETAILS

WEDNESDAY, 1 APRIL

4:00 to 7:00 p.m.

Registration

Centennial Foyer

5:00 to 6:00 p.m.

Opening Welcome and Business Meeting

Centennial F

All conference attendees are encouraged to join SAA's leadership for updates about the conference, current initiatives and future plans. There will be brief remarks from officers, trustees, and committees, followed by time for questions and discussion with the membership.

6:00 to 7:00 p.m.

Social Gathering and Cash Bar

Centennial Foyer

Open to all registrants and their registered guests.

THURSDAY, 2 APRIL

7:30 a.m. to 6:00 p.m.

Registration

Centennial Foyer

8:00 a.m. to 6:00 p.m.

Book Exhibits

Centennial A

8:00 to 9:00 a.m.

Professionalization: Publishing in an Academic Journal: A Discussion by Journal Editors

Agate C

ORGANIZERS: Vanessa Corredera,
Arthur Little, and David McInnis
(Shakespeare Quarterly)

Sponsored by Shakespeare Quarterly

Light refreshments served

Join the editors of several peer-reviewed journals for coffee and informal conversation about submitting work for publication: what to submit, where to submit, and what to expect after you've submitted it. All are welcome, and early-career scholars are particularly encouraged to attend.

8:30 to 10:30 a.m.

Seminar: The Adaptability of Adaptation

Mineral D

LEADER: Rebecca Hixon,
St. Bonaventure University

Ved Dutt Arya, *Ashoka University,
Delhi-NCR, India*

Elizabeth Burow-Flak, *Valparaiso University*

Jonathan Burton, *Whittier College*

Walter I. Cohen, *University of Michigan*

Michael D. Friedman, *University of Scranton*

Patrick Aaron Harris, *University
of South Carolina*

Elizabeth Zeman Kolkovich,
Ohio State University

Alfredo Michel Modenessi, *Universidad
Nacional Autónoma de México*

L. Monique Pittman, *Andrews University*

Adam Rzepka, *Montclair State University*
Lucia Scheckner, *New York, NY*
Laryssa Schoeck, *Shakespeare Institute,
University of Birmingham*
Barbara Sebek, *Colorado State University*

Seminar: Baz Luhrmann's *William Shakespeare's Romeo + Juliet* at Thirty (Hybrid Session)

Mineral A

LEADERS: Gemma Kate Allred,
*Université de Neuchâtel, Benjamin
Broadribb, London, UK, and Edel
Semple, University College Cork*

Victoria Bladen, *University of Queensland*
Yoojung Chun, *Harvard University*
Carla Della Gatta, *University of Maryland*
Valerie M. Fazel, *Arizona State University*
Jennifer Flaherty, *Georgia College*
David W. Hartwig, *Weber State University*
Diana E. Henderson, *Massachusetts
Institute of Technology*
Jennifer R. Holl, *Rhode Island College*
Kristine Johanson, *Universiteit
van Amsterdam*
Melissa M. Johnson, *Lyon College*
Mark Beatrice Kaethler,
Medicine Hat College
Courtney Lehmann, *University of the Pacific*
Natalie J. Loper, *University of Alabama*
Jennie M. Votava, *Allegheny College*

Workshop: Book Proposal Lab

Mineral E

**LEADERS: Michelle M. Dowd, University
of Alabama, Karen Raber, University
of Mississippi, and Rebecca Totaro,
Florida Gulf Coast University**

Mathieu D. S. Bouchard, *John
Abbott College*

Nicholas Devlin, *The Gallatin School, NYU*
Kate Doubler, *University of South Florida*
Matthew P. Harrison, *West
Texas A&M University*
Benjamin Hilb, *Francis Marion University*
Lindsay Adams, *Kennedy
Benedictine College*
Katherine I. Knowles, *University of Kansas*
Jennifer Dawson Kraemer,
University of North Texas
Ineke Murakami, *University at Albany, SUNY*
Katie Elizabeth O'Hare, *University
of California, Los Angeles*
James N. Ortego II, *Troy University*
Katey E. Roden, *Gonzaga University*
Rob Wakeman, *Mount St. Mary College*
Eunwoo Yoo, *University of
California, Santa Barbara*
Mary Erica Zimmer, *Massachusetts
Institute of Technology*

Seminar: Child Performance

Granite B

LEADER: Scott A. Trudell,
University of Maryland

Bridget B. Anderson, *University
of Wisconsin, Madison*
Harry R. McCarthy, *University
of Southern California*
Jeanne H. McCarthy, *Georgia
Gwinnett College*
Benjamin Sidney Reed, *University
of Nebraska, Lincoln*
Aidan Selmer, *Sarah Lawrence College*
Nicole Sheriko, *Yale University*
Jordan Windholz, *Shippensburg University*



Seminar: Community and the Scapegoat

Mineral C

LEADERS: Craig Dionne, *Eastern Michigan University* and Sharon O'Dair, *University of Alabama*

Susan L. Anderson, *Mary Baldwin University*
Mark Bayer, *University of Texas, San Antonio*
Lara Bovilsky, *University of Oregon*
Juan F. Cerdá, *Universidad de Murcia*
Emiliano Gutierrez-Popoca, *Georgia Institute of Technology*
Joanna Huh, *University of Cincinnati*
Willnide Lindor, *SUNY Cortland*
Sandra A. Logan, *Michigan State University*
Asia Rowe, *St. Joseph's College of Maine*
Jonathan Shelley, *St. John Fisher University*
Lucas Simpson, *University of Toronto*

Seminar: Comparative Sexualities: Shakespeare and His Contemporaries (Hybrid Session)

Mineral F

LEADER: Goran Stanivukovic,
Saint Mary's University

Douglas H. Arrell, *University of Winnipeg*
Katarzyna Burzyńska, *Adam Mickiewicz University*
Dongqiao Chen, *Beijing, China*
Gina Filo, *Utah State University*
Jemma Louise Forster, *Cambridge, United Kingdom*
José Manuel González, *Universidad de Alicante*
Caitlin Mahaffy, *Mount Holyoke College*
Ian F. Moulton, *Arizona State University*
Alyssa Mulé, *University of Chicago*
Johann Paccou, *Université Sorbonne Nouvelle*
Patrick Soto, *Yale University*
Grace Yancy, *University of Texas, Tyler*

Seminar: Contemporary Pedagogies of Reading Early Modern Literature

Mineral B

LEADERS: Catherine R. Clifford,
Hastings College and Jess Hamlet, *Alvernia University*

Michael Andrew Albright, *Southwest Minnesota State University*
Frederick Bengtsson, *University of Kentucky*
Valerie Billing, *Central College*
Emily D. Bryan, *Sacred Heart University*
Katharine Cleland, *Virginia Tech*
Claire Dawkins, *Stanford University Online High School*
Nic Helms, *Independent Scholar*
Hannah Korell, *University of Wisconsin, Platteville*
Matthew Kozusko, *Ursinus College*
Sara D. Luttfriing, *Pennsylvania State University, Behrend*
Conor O'Sullivan, *Western Reserve Academy*
Danielle A. St. Hilaire, *Duquesne University*
Elizabeth V. Steinway, *Colorado State University*
Lauren Weindling, *Wilfrid Laurier University*
Wenhan Zhang, *Northwestern University*

Seminar: Early Modern Eco-Memory

Granite C

LEADER: Daniel Normandin,
Marshall University

Roya Biggie, *Knox College*
Ciara J. Fulton, *University at Buffalo, SUNY*
Kelley Katherine Glasgow, *Boston College*
Erin K. Kelly, *California State University, Chico*
Christi Spain-Savage, *Siena College*
Kelly J. Stage, *University of Nebraska, Lincoln*

Mariana Trujillo Marquez,
Graduate Center, CUNY
Erin Webster, College of William & Mary

Seminar: Faculty/ Student Collaboration in the Undergraduate Shakespeare Classroom

Quartz B

LEADERS: Lucie Alden, Georgetown
University and Mardy
Philippian, Lewis University

Amanda Di Ponio, Huron University College
Emily Schoenbeck, University of Minnesota

Virtual Seminar: From Commonplaces to Databases: The Social Memory of Proverbs

LEADERS: Laura Estill, St. Francis
Xavier University and Richard
J. Meek, University of Hull

Jonathan Baldo, Eastman School of
Music, University of Rochester

Erin E. Kelly, University of Victoria

Clémence Lescoutre, Université
Sorbonne Nouvelle Paris

Jennifer Lewin, University of Haifa

Elisabeth Lutteman, Visby, Sweden

Anne M. Myers, University of Missouri

Neil Rhodes, University of St. Andrews

Andrea F. Van Nort, United States
Air Force Academy

Seminar: Postcolonial Shakespeares (Hybrid Session)

Mineral G

LEADER: Amrita Dhar, University
of California, San Diego

Ifeoluwa Aboluwade, University
of Würzburg, Germany

Jahidul Alam, Jackson State University

Charmaine Cordero, Claremont
Graduate University

Emily Glider, Bilkent University,
Ankara, Türkiye

E. Rose Grant, University of Toronto

Kathryn Vomero Santos, Trinity University

Abhishek Sarkar, Jadavpur University

Amrita Sen, University of Calcutta

Ira Sen, University of Mississippi

Julie Thompson, Burman University

Chris Thurman, University of
the Witwatersrand

Willow White, University of Alberta

Seminar: Race and Anglo- Iberian Literary Exchanges

Granite A

LEADERS: Zainab Cheema, Florida
Gulf Coast University and Victoria
M. Muñoz, Adelphi University

Erika M. Boeckeler, Northeastern University

Kyle Grady, University of California, Irvine

Eric J. Griffin, Millsaps College

José Juan Villagrana, Santa Clara University

Emily Weissbourd, Lehigh University

Seminar: Shakespeare and Belonging

Agate A

LEADERS: Sara Morrison, William
Jewell College and Deborah
Uman, Weber State University

Jennifer Black, Boise State University

Sarah Brew, Weber State University

Kerry N. Cooke, Mary Baldwin University

Heather C. Easterling, Gonzaga University

Sean K. Lawrence, University of
British Columbia, Okanagan

Rhonda Lemke Sanford, Fairmont
State University

Laura Turchi, Arizona State University

Dawn Monique Williams, Weber
State University



Virtual Seminar: Shakespeare and Elite Culture: Performing Whiteness Beyond the Anglophone

LEADERS: Anandi Rao, *SOAS, University of London* and Francesca Clare Rayner, *Universidade do Minho, Portugal*

Stella Achilleos, *University of Cyprus*
Anna Kowalcze-Pawlik, *University of Lodz*
Jinjian Li, *Peking University*
Kirsten N. Mendoza, *University of Dayton*
Shuo Niu, *University of York*

Seminar: Shakespeare and the Forms of Religion

Quartz A

LEADERS: Trina Hyun, *University at Buffalo, SUNY* and Amanda K. Ruud, *Valparaiso University*

Sean M. Benson, *University of Mary Hardin-Baylor*
James E. Berg, *Middlebury College*
Paul Adrian Fried, *Northfield, MN*
Joseph Navitsky, *Champlain College, Saint-Lambert*

Workshop: Strategic Shakespeares

Agate B

LEADERS: Nedda Mehdizadeh, *University of California, Los Angeles* and Nora J. Williams, *BIMM University*

Ariane M. Balizet, *Texas Christian University*
Ashley Buchanan, *Folger Shakespeare Library*
Sawyer K. Kemp, *Queens College, CUNY*
Tamara Mahadin, *Kirkwood Community College*
Carol Mejia LaPerle, *Wright State University*
Saiham Sharif, *University of California, Irvine*

11:00 a.m. to 12:30 p.m.

Panel: Lyric Attachments

Centennial F

ORGANIZER: Dianne Mitchell, *University of Colorado, Boulder*

CHAIR: Adhaar Noor Desai, *Bard College*

Recipe/Poem

Marissa Nicosia, *Pennsylvania State University, Abington College*

Pastoral Attachment in Marlowe's *The Jew of Malta*

Yunah Kae, *College of Charleston*

Print, Music, Poetry, Patronage

Thomas Ward, *United States Naval Academy*

Letter Surfaces, Queer Attachments

Dianne Mitchell, *University of Colorado, Boulder*

Book Salon: Seeing Through Shakespeare

Centennial G

ORGANIZER: Ambereen Dadabhoy, *Harvey Mudd College*

CHAIR: Ruben Espinosa, *Arizona State University*

Shakespeare through Islamic Worlds

Ambereen Dadabhoy, *Harvey Mudd College*

Shakespeare in the Age of Mass Incarceration

Liz Fox, *University of Massachusetts, Amherst* and Gina Hausknecht, *Coe College*

Shakespeare in Tongues

Kathryn Vomero Santos, *Trinity University*

1:00 to 2:00 p.m.**Meeting: Early Modern
Community of Care***Mineral A*

ORGANIZERS: Bridget Marie Bartlett,
Swansea University, Andrew Bozio,
Skidmore College, and Dalton Edward
Greene, *University of Maryland*

This is a community and a network of care for early modernists with disabilities, committed to the principles of disability justice. Open to all registrants and their registered guests.

2:00 to 3:00 p.m.**Professionalization: CV Review
and Career Mentoring***Agate C*

David Sterling Brown, *Trinity College*, Emily Parise, *University of California, Irvine*, Kathryn Schubert, *University of California, Irvine*, and Eunwoo Yoo, *University of California, Santa Barbara*

Are you a graduate student or early career researcher who is interested in having your CV reviewed? The SAA Graduate Committee and Dr. David Sterling Brown are excited to offer CV Review & Career Mentoring sessions. This will be an opportunity for you to receive feedback on your CV from advanced scholars and professionals (CV

DIGITAL THEATRE+**Shakespeare's plays were written to be performed...**

...so bring performance into your teaching with Digital Theatre+

- Full-length productions
- Leading theatre companies
- Educational resources including interactive playtexts
- Built for Higher Education

- ▶ Visit Andrew Falconer in the Exhibition Area
- ▶ Secure free trial access
- ▶ Exclusive 10% conference discount on new institutional quotes

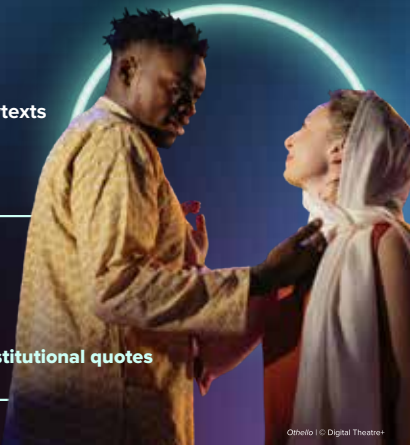

Othello | © Digital Theatre+

digitaltheatreplus.com



reviewers) who will be available in person for individual 15-minute meetings. They will assess your CV and offer guidance catered to your specific career goals.

2:00 to 4:00 p.m.

Seminar: Essaying Shakespeare (Hybrid Session)

Mineral G

LEADERS: *Huw Griffiths, University of Sydney and Jennifer E. Nicholson, University of Sydney*

Jonas Gardsby, University of Wisconsin, Green Bay

Ágnes Matuska, Szegedi Tudományegyetem

Kristen K. Polster, Southern Methodist University

Henry S. Turner, Rutgers University

Megan Vinson, Indiana University

John Yargo, Boston College

Open Workshop: Fencing in Shakespeare's World

Centennial H

LEADERS: *Devon Boorman, Academie Duello Centre for Swordplay and Jade Standing, Queen's University*

Join maestro of historical martial arts, Devon Boorman, and Jade Standing for a practical introduction to the swords and styles of fencing that formed a part of Shakespeare's world. Participants will learn fundamental moves of the rapier, longsword, and sword and buckler and consider the performative range of those weapons commonly used by early modern fencers and scripted into playhouse drama.

Seminar: The Future of Renaissance (Non-Human) Animal Studies

Quartz A

LEADER: *Rebecca Ann Bach, University of Alabama, Birmingham*

Keith Botelho, Kennesaw State University

Erika Lyn Carbonara, Kalamazoo College

Douglas Farquhar Cavers, University of Southern California

Taylor Claire Culbert, SUNY New Paltz

Holly E. Dugan, George Washington University

Perry D. Guevara, Georgia Institute of Technology

Jason C. Hogue, Texas A&M University, Kingsville

Olivia Leonard, Arizona State University

Seminar: Generation Shakespeare: YA Adaptations

Granite B

LEADERS: *Brian Harries, Concordia University, Ann M. Martinez, Kent State University at Stark, and Gaywyn Moore, Santa Clara University*

Madeline Cisneros, University of Miami

Susan M. Dunn-Hensley, Wheaton College

Jess McCall, Delaware Valley University

Donna Woodford-Gormley, New Mexico Highlands University

Seminar: How to Use King Lear

Quartz B

LEADER: *Douglas Lanier, University of New Hampshire*

Effie Botonaki, Aristotle University of Thessaloniki, Greece

Thea Buckley, Belfast, Northern Ireland

Stephen M. Buhler, University of Nebraska, Lincoln

Timothy Francisco, Youngstown State University

Eric S. Mallin, University of Texas, Austin

James T. Newlin, Case Western Reserve University

John-Paul Spiro, Villanova University

Jeanette N. Tran, Drake University

Steven Urkowitz, City College of New York, CUNY

Denise A. Walen, *Vassar College*
 Shay Williams, *University of New Hampshire*

Seminar: Manuscript Cultures/ Theatrical Cultures

Mineral B

LEADER: Alan Stewart,
Columbia University

Bianca F. C. Calabresi, *Columbia University*
 John Colley, *University of Cambridge*
 Alan B. Farmer, *Ohio State University*
 Kara J. Northway, *Kansas State University*
 Vimala C. Pasupathi, *Hofstra University*
 Eilis Smyth, *University of Notre Dame*
 Rachel Leann Spencer, *University
of Texas, Austin*
 Lanier Walker, *University of North Carolina*
 Daniel Yabut, *CNRS/Université de
Montpellier Paul-Valéry*

Seminar: New Directions in Shakespeare and the Bible

Agate A

LEADER: Gabriel Bloomfield,
Bates College

Amy Cooper, *US Air Force Academy*
 Elisha Hamlin, *University of California, Davis*
 Laura Koleva, *Texas Tech University*
 Kelly Lehtonen, *Campbellsville University*
 Amos Rothschild, *St. Thomas
Aquinas College*

Seminar: Performing Gender and Sexuality in Shakespeare: Theory and Praxis

Granite C

LEADER: Chad Allen Thomas,
University of Alabama in Huntsville

Stephen Cohen, *Central
Connecticut State University*
 Liesl Elphie Jensen, *Shakespeare
Institute, University of Birmingham*

Alexandra E. LaGrand, *Texas A&M University*
 Paige Martin Reynolds, *University
of Central Arkansas*
 Kathryn M. Moncrief, *Worcester
Polytechnic Institute*
 William R. Rampone, Jr., *South
Carolina State University*

Seminar: Performing Repetition

Mineral E

LEADERS: Allison K. Deutermann,
*Baruch College, CUNY and Lauren
Robertson, Columbia University*

Charlotte Artese, *Agnes Scott College*
 Hannah Bredar, *Anne Arundel
Community College*
 Piers Brown, *Kenyon College*
 Adhaar Noor Desai, *Bard College*
 Patrick Durdel, *University of Oxford*
 Kent Lehnhof, *Chapman University*
 Emily MacLeod, *Penn State Harrisburg*
 Kate Needham, *University of Mississippi*
 Richard Preiss, *University of Utah*
 Emily Shortslef, *University of Kentucky*
 Arya Sureshbabu, *University
of California, Berkeley*
 Hudson Vincent, *Davidson College*
 Katherine Schaap Williams,
University of Toronto
 Paul J. Zajac, *McDaniel College*
 Corinne Zeman, *Texas A&M
University, Corpus Christi*

Seminar: Preternatural Shakespeare

Mineral C

LEADERS: Mary Floyd-Wilson,
*University of North Carolina, Chapel
Hill, Phebe Jensen, Utah State
University, and Katherine Walker,
University of Nevada, Las Vegas*

Vanessa Rodrigues Barcelos,
University of Miami



Kaitlyn Culliton, *Texas A & M International University*
Jordan Ivie, *Vanderbilt University*
Jesse M. Lander, *University of Notre Dame*
Caroline Lion, *Southern Oregon University*
Jennifer Lillian Lodine-Chaffey,
Montana State University, Billings
Nova Myhill, *New College of Florida*
John L. Parker, *University of Virginia*
Peter C. Remien, *Lewis-Clark State College*
Joel E. Slotkin, *Towson University*
Khristian S. Smith, *University of North Carolina, Chapel Hill*
Mackenzie Margaret Tomlinson,
Oklahoma State University
Christine Varnado, *University at Buffalo, SUNY*

Seminar: Rethinking Original Practices (Hybrid Session)

Mineral F

LEADERS: Benjamin Blyth,
University of Calgary and **Ollie Jones,**
University of York
Melissa D. Aaron, *Cal Poly Pomona*
Kim Howard Carrell, *Worcester State University*
Katharine Goodland, *College of Staten Island, CUNY*
Brent Griffin, *Resurgens Theatre Company / Georgia State University*
Lizzie Conrad Hughes, *Shake-Scene Shakespeare*
Evelyn A. Reidy, *Independent Scholar*
Joseph F. Stephenson, *Abilene Christian University*
Marie Trotter, *McGill University*
Valentina Vinci, *London, UK*

Workshop: Shakespeare and Community-Based Practice

Granite A

LEADERS: Jennifer Feather, *University of North Carolina, Greensboro*
and **Lauren Shook,** *University of North Carolina, Greensboro*

Gregory A. Foran, *Nazareth University*
Marinela Golemi, *Northern Arizona University*
Matthew C. Hansen, *Boise State University*
Sarah Higinbotham, *Emory University, Oxford College*
Neah Lekan, *Johns Hopkins University*
Courtney A. Parker, *Huntingdon College*

Seminar: Silence on Stage

Agate B

LEADER: Maggie Vinter, *Case Western Reserve University*
Olivia Ryan Barry, *University of Massachusetts Amherst*
Heidi Brayman, *University of California, Riverside*
Zeidy Zady Canales, *Universidad Nacional Autónoma de México (UNAM)*
Loreen L. Giese, *Ohio University*
Pierre Hecker, *Carleton College*
Anna Hegland, *Carthage College*
Laura E. Kolb, *Baruch College, CUNY*
Erin K. Minear, *College of William & Mary*

Seminar: Variorum Shakespeare

Mineral D

LEADERS: Robert Stagg, *Texas A&M University* and **Dorothy Todd,** *Texas A&M University*
Heidi Craig, *University of Toronto*
Mark D. Farnsworth, *Brigham Young University, Idaho*
Joshua R. Held, *Southeastern Oklahoma State University*
Erik McCarthy, *Gordon State College*
Alicia J. Meyer, *University of Pennsylvania*

3:00 to 4:00 p.m.

Meeting: SAA Stitchers

Mineral A

Marianne Montgomery, *East Carolina University*

Calling all SAA stitchers! Bring your knitting, crochet, cross-stitch or other project for a Sit and Stitch. All crafts welcome.

4:30 to 6:00 p.m.

Panel: Beyond New Materialism: Political Ecology and Early Modern Drama

Centennial F

ORGANIZER: Daniel J. Vitkus, *University of California, San Diego*

CHAIR: Katherine Steele Brokaw, *University of Texas, Austin*

RESPONDENT: Ashley Sarpong, *California State University, Stanislaus*

Accommodating Humanity: King Lear, Eco-Crisis, and Dialectical Materialism

Daniel J. Vitkus, *University of California, San Diego*

A Little Desire: Gender, Sexuality, and Political Ecology in Rowley's A New Wonder, A Woman Never Vext

Derrick Higginbotham, *University of Hawai'i at Mānoa*

Political Ecology, Primitive Accumulation, and The Witch of Edmonton

Natalie Suzelis, *Antioch College*

**PROUD SPONSOR
SHAKESPEARE
ASSOCIATION OF
AMERICA ANNUAL
MEETING 2026**

BYU College of Humanities

| | | |
|------------------------------|--------------------------|----------------------------|
| 10 | 877 | 84 |
| SHAKESPEARE COURSES PER YEAR | CURRENT ENGLISH STUDENTS | LANGUAGES TAUGHT REGULARLY |



**Panel: Imaginary Shakespeares:
Creative and Scholarly**

Centennial G

ORGANIZER: Scott Maisano, *University
of Massachusetts, Boston*

CHAIR: Wendy Beth Hyman,
Oberlin College

“Let’s Pretend” with Lady Macbeth
Michelle Ephraim, *Worcester
Polytechnic Institute*

**In a Berowne Study, or, Can
Academe Daydream?**
Scott Maisano, *University of
Massachusetts, Boston*

The non sequitur as a Form of Thought
Rachel Eisendrath, *Barnard College,
Columbia University*

5:30 to 6:30 p.m.

Graduate Coffee/Tea Social Hour

Mineral A

Open to all graduate student attendees.

6:30 to 8:00 p.m.

Annual Reception

Centennial E

Hors d’oeuvres and cash bar.

Open to all registrants for the Fifty-Fourth Annual Meeting and their guests. Each guest must have an SAA name tag in order to attend; guest tags may be requested and purchased on the conference registration form.

FRIDAY, 3 APRIL

7:30 to 8:30 a.m.

Shakespeare Yoga

Agate C

Kathryn Moncrief, *RYT-200,
Worcester Polytechnic Institute*

Open to all registrants for the Fifty-Fourth Annual Meeting and registered guests.

8:00 to 9:00 a.m.

Graduate Student Breakfast

Centennial E

Hosted by the Trustees of the Association.

Open to all graduate student attendees.

8:00 a.m. to 6:00 p.m.

Registration

Centennial Foyer

Book Exhibits

Centennial A

9:00 to 10:30 a.m.

**Shakespeare Futures
Panel: Contingency: The
State of Our Field**

Centennial G

ORGANIZER: Benjamin VanWagoner,
Columbia University

CHAIR: Sharon O’Dair,
University of Alabama

**Salvage Poetics: Precarious
Life, Parlous Work**
Benjamin VanWagoner, *New York, NY*

**No Mean Dependence: Reframing
Contingency in Academic Employment**
Loren Cressler, *University of Texas, Austin*

**Activism Within and
Against Contingency**
Jean E. Howard, Columbia University

The Longest Mile: Contingency’s

Human Impacts and What We Can Do about Them

Danielle Rosvally, *University at Buffalo, SUNY*

Panel: The Early Modern Antiquarian Analytic: Words, Print, Plays

Centennial F

ORGANIZER: Miriam E. Jacobson,
University of Georgia

CHAIR: Alan Stewart, *Columbia University*

Feeling History: Early Modern Antiquarianism as Reenactment in *Poly-Olbion* and *Antony and Cleopatra*

Miriam E. Jacobson, *University of Georgia*

“What Mine Authors Say”: Antiquarian Authority in *Troilus and Cressida* and *Pericles*

Megan Cook, *Colby College*

“Presarve within paper walles what the stronge rocke cannot keepe”: Poems and Monuments

András Kiséry, *City College of New York, CUNY*

9:00 to 11:00 a.m.



Film Screening: Acting

Centennial H

Sophie Fiennes' immersive film offers privileged access to the experience

of making theatre with pioneering practitioners, Declan Donnellan and Nick Ormerod of *Cheek By Jowl*.

10:30 to 11:00 a.m.

Coffee Break

Centennial Foyer

SAA Book Celebration

Centennial

Please join us for a Book Celebration, hosted by Kathryn Vomero Santos. This year we are opening our celebration to any books published in the last two years.

11:00 a.m. to 1:00 p.m.

Workshop: Air & Breath in *Macbeth*: A Scholar-Practitioner Convergence

Granite B

LEADERS: Theo Black, *Cornell University*,
Christopher Marino, *University of North Carolina, Wilmington*, and
Stephanie Shirilan, *Syracuse University*

Sharon J. Harris, *Brigham Young University*

David Landreth, *University of California, Berkeley*

Genevieve Love, *Colorado College*

Joseph Penczak, *Troupe of Friends*

Megan Snell, *Boston University*

Kelly Christine Steele, *The Meadows School, Las Vegas*

Seminar: Audio Shakespeare Around the World: Radio, Recordings, Internet

Agate A

LEADER: Michael P. Jensen,
Shakespeare Newsletter

Mark Anthony Houlahan, *University of Waikato, Hamilton, New Zealand*



Blaire A. Krakowitz, *Pennsylvania State University*
Katie Lanning, *Wichita State University*
Marianne Montgomery, *East Carolina University*
Ilker Özçelik, *Süleyman Demirel University*
Charlene V. Smith, *Cleveland, OH*

Seminar: Creative-Critical Engagements with the Renaissance

Mineral A

LEADERS: Kate Bolton Bonnici,
Pepperdine University and **Colleen Ruth Rosenfeld,**
Pomona College

Alice Dailey, *Villanova University*
Jane Hwang Degenhardt, *University of Massachusetts, Amherst*
Doug Eskew, *Colorado State University, Pueblo*
Joseph Hirzer Kidney, *Stanford University*
Arthur L. Little, Jr., *University of California, Los Angeles*
Thomas J. Moretti, *Iona University*
Jennifer Waldron, *University of Pittsburgh*

Seminar: The Many Lives of *The Shrew*

Quartz A

LEADERS: James J. Marino, *Cleveland State University* and **Elizabeth E. Tavares,** *University of Alabama*

Allison Duque, *University of South Florida*
Catherine Loomis, *Rochester, NY*
Arnie Perlstein, *Portland, OR*
Kelsey Ridge, *Alvernia University*
James A. Rizzi, *Canisius University*
Marie H. Roche, *University of Massachusetts, Amherst*
Amy L. Tigner, *University of Texas, Arlington*
Jessica Tooker, *Indiana University, Bloomington*
Sarah Wall-Randell, *Wellesley College*

Seminar: On Glossing

Mineral E

LEADER: Stephen Spiess, *Babson College*

Marlin E. Blaine, *California State University, Fullerton*
Kurt Daw, *San Francisco State University*
Joseph Gamble, *University of Toledo*
Dalton Greene, *University of Maryland*
Eric M. Johnson, *George Mason University*
Peter Kirwan, *Mary Baldwin University*
James D. Mardock, *University of Nevada, Reno*
Jeffrey Masten, *Northwestern University*
Andrew Mattison, *University of Toledo*
Vanessa L. Rapatz, *Ball State University*
Suzanne Tanner, *Avila University*
Evelyn Tribble, *University of Connecticut*

Seminar: Play On: Shakespeare and Video Games

Mineral D

LEADERS: Lowell Duckert, *University of Delaware* and **Christine Hoffmann,** *West Virginia University*

Andrew M. Darr, *Centralia High School, MO*
Remson Jordan DeJoseph, *University of Delaware*
Philip Austin Gilreath, *Tulane University*
Elizabeth B. Hunter, *Washington University in St. Louis*
Jeffrey Scott Squires, *Carnegie Mellon University in Qatar*

Seminar: The Poetics of the Page

Mineral C

LEADER: Jessica C. Beckman, *Dartmouth College*

Amber C. Bird, *University of Alabama*
Beatrice Bradley, *University of Minnesota, Twin Cities*
Francis X. Connor, *Wichita State University*

NOW AVAILABLE ON DRAMA ONLINE

THE ARDEN SHAKESPEARE PLAY COLLECTION: TEXT AND LANGUAGE

Navigate plays and word meanings in one digital space



Now you can read *The Arden Shakespeare Third Series* of plays alongside the landmark five-volume *The Arden Encyclopedia of Shakespeare's Language* in this new integrated resource.

- Navigate between the plays and accessible, dictionary style analysis of Shakespeare's words.
- Seamlessly look up meanings of words in the Encyclopedia whilst reading a world-leading Arden Shakespeare edition, using the new 'look up' tool on the playtext page.
- Each year a small number of new Arden Shakespeare Fourth Series editions will be added to this resource until the entire series has been incorporated.

www.dramaonlinelibrary.com

Find out
more at the
Arden
Shakespeare
booth!

AS

DRAMA
ONLINE

BLOOMSBURY
DIGITAL RESOURCES





Nica Giromini Franklin, *University of California, Berkeley*
Spencer Grayson, *University of Virginia*
Adam G. Hooks, *University of Iowa*
Nicholas Jones, *Oberlin College*
Jonathan P. Lamb, *University of Kansas*
Matthew Ritger, *Dartmouth College*
Bailey Sincox, *Binghamton University*
Ashley Thomas, *Columbia University*

Seminar: Power Dressing

Granite C

LEADER: Katharine E. Landers,
Illinois State University

Hannah N. Chambers, *Emory University*
Hannah Elizabeth Hicks,
University of Notre Dame
Kay Stanton, *California State University, Fullerton*
Valerie Voight, *University of Tennessee*

Seminar: REED at 50: Prospects and Retrospects

Mineral B

LEADERS: Peter Greenfield, University of Puget Sound and Alan H. Nelson,
University of California, Berkeley

Jeeyoung Choi, *Purdue University*
Emily Crider, *Purdue University*
F. Elizabeth Hart, *University of Connecticut, Storrs*
Robert Hornback, *Oglethorpe University*
William Ingram, *University of Michigan*
Alexandra Ferguson Johnston,
University of Toronto
David Kathman, *Chicago, IL*
Siobhan C. Keenan, *De Montfort University*
Sally-Beth MacLean, *University of Toronto*
Gerit Quealy, *New York, NY*

Paul Whitfield White, *Purdue University*
Emily F. Winerock, *Shakespeare and Dance Project / Point Park University*

Seminar: Representation, Politics, and Performance

Mineral G

LEADER: Andrew S. Brown,
Dalhousie University

Rebecca Adusei, *King's College London*
Lisa M. Barksdale-Shaw, *Arizona State University*
Emma R. Cohen, *Northwestern University*
Delanie R. Harrington Dummit,
University of California, Davis
Benjamin C. Gee, *Stanford University*
Joseph Mansky, *University of Oklahoma*
Tracey Miller-Tomlinson, *New Mexico State University*
Emily Parise, *University of California, Irvine*
Emily L. Piersma Sharrett, *University of Northwestern, St. Paul*
Artemis Preeshl, *Adams State University, Alamosa*
Simone Waller, *Reed College*

Virtual Workshop: Rescuing Romance

LEADERS: Katharine A. Craik, Oxford Brookes University and Ewan Fernie, Shakespeare Institute, University of Birmingham

Laura E. Levine, *New York University*
Philippa M. Sheppard, *University of Toronto*

Seminar: Rethinking City Comedy

Granite A

LEADERS: Bernadette Myers,
Washington University in St. Louis and Robert O. Yates, Wagner College

Matthew Charles Carter, *Clayton State University*

Edward Gieskes, *University of South Carolina*

Gina Hausknecht, *Coe College*

Kimberly A. Huth, *California State University, Dominguez Hills*

Bill Kerwin, *University of Missouri*

Linc Kesler, *University of British Columbia*

Jordan Zajac, *O.P., Providence College*

Seminar: Shakespeare, AI, and Virtuality

Mineral F

LEADER: Alexa Alice Joubin,
George Washington University

David J. Baker, *University of North Carolina at Chapel Hill*

Nayoung Seo Bishoff, *George Washington University*

Laurie Ellinghausen, *University of Missouri, Kansas City*

Renuka Gusain, *University of North Carolina, Asheville*

Joseph P. Haughey, *Northwest Missouri State University*

D. J. Hopkins, *San Diego State University*

Emily Rose Nicholls, *King's College London / University of Hong Kong*

Don Rodrigues, *Old Dominion University*

Gregory M. Schnitzspahn, *Boston, MA*

Lauren Shohet, *Villanova University*

W. B. Worthen, *Barnard College, Columbia University*

Seminar: Whiteness and the Comic

Quartz B

LEADER: Sarah Gray Lesley,
University of Chicago

Joseph Bowling, *University of Wisconsin, Madison*

David Sterling Brown, *Trinity College*

Elizabeth Dieterich, *Carnegie Mellon University*

Ian Smith, *University of Southern California*

Lydia Valentine, *Shakespeare's Globe*

1:30 to 3:00 p.m.

Annual Luncheon

Centennial D-E

Open to all registrants for the Fifty-Fourth Annual Meeting. Additional guest tickets may be purchased in advance. Member tickets are included in registration envelopes (but may not be available to onsite registrants).

3:30 to 5:00 p.m.

Plenary Panel: Editing Race, Sex, and Othello

Centennial F-G

ORGANIZER: Dennis A. Britton,
University of British Columbia

CHAIR: Ian Smith, *University of Southern California*

What's a Moor, Again?: Race, Nomenclature, and Othello's Early Commentors

Dennis A. Britton, *University of British Columbia*

Extra-Illustrating Othello

Patricia Akhimie, *Folger Shakespeare Library*

Walking Barefoot from Venice to Palestine: Rerouting Othello

Abdulhamit Arvas, *University of Pennsylvania*

5:15 to 6:15 p.m.

Scholars of Color Social

Centennial E

Co-sponsored by the Folger Shakespeare Library

Cash bar. Open to all registrants and their guests.



6:30 to 8:30 p.m.



Performance: *BIOPhelia*

Centennial H

Theo Black, *Cornell University*, Amanda Vialva, and Adam Washiyama Shulman, *Cornell University*

What if Ophelia's herbs and flowers were given a central place on stage, to share a worldview of regeneration and renewal? What if Ophelia's seeded potential were to be cultivated, enhanced, and empowered in our shared era of ecological crisis? In this performance, actor Amanda Vialva revives Ophelia's journey, to evolve Shakespeare's story beyond the binary of Hamlet's existential question (you know the one) and look at how we may adapt as part of nature, and better learn to inter-be...

SATURDAY, 4 APRIL

7:30 to 8:30 a.m.

Shakespeare Yoga

Agate C

Anna Riehl Bertolet, *RYT-200, Auburn University*

Open to all registrants for the Fifty-Fourth Annual Meeting and registered guests.

8:00 a.m. to 12:00 noon

Information

Centennial Foyer

Book Exhibits

Centennial A

9:00 to 10:30 a.m.

Panel: Makers, Making and the Made in Early Modern Theatrical Culture and Its Reproductions

Centennial F

ORGANIZER: Bridget Mary Escolme, *Queen Mary University of London*

CHAIR: Drew Daniel, *Johns Hopkins University*

Re-making the Made: Craft, Value and Nostalgias in Shakespeare Re-production

Bridget Mary Escolme, *Queen Mary University of London*

“Peculiar Extensions”: Footwork, Footwear, and the Footprint of Early Modern Performance

Natasha Korda, *Wesleyan University*

The Phenomenology of Labour and the Early Modern Stage

James Loxley, *University of Edinburgh*

Panel: Mapping Spatial Habits in Early Modernity

Centennial G

ORGANIZER: Gavin Hollis, *Hunter College, CUNY*

CHAIR: Laura E. Kolb, *Baruch College, CUNY*

Mappery, or The Joy of Maps

Gavin Hollis, *Hunter College, CUNY*

**Mobility, Measurement, and
The English Travel Guide**

Laura Williamson, *St. Mary's
College, Notre Dame*

**Choreography as Chorography:
Dancing Maps on Stage and Street**

Seth Stewart Williams, *Barnard
College, Columbia University*

10:00 a.m. to 12:00 noon**Digital Exhibits**

Centennial Foyer

Early Modern England Encyclopedia

EXHIBITOR: Kate McPherson,
Utah Valley University

**Open-Access AI & Textbook:
Screening Shakespeare**

EXHIBITOR: Alexa Alice Joubin,
George Washington University

**Points Like A Man: The
Shakespearean Breeches
Performance Catalogue, 1660-1900**

EXHIBITOR: Alexandra E. LaGrand,
Texas A&M University

Shakespeare's Theaterscape

EXHIBITORS: Jeeyoung Choi, *Purdue
University*, Emily Crider, *Purdue
University*, and Paul Whitfield
White, *Purdue University*

**We'll Hear a Play: Early Modern
Performances Online**

EXHIBITOR: Miranda Hannasch,
University of Nevada, Las Vegas

10:30 to 11:00 a.m.**Coffee Break**

Centennial Foyer

11:00 a.m. to 12:30 p.m.**Plenary Panel: NextGenPlen**

Centennial F-G

ORGANIZERS: Members of the
NextGenPlen Committee

CHAIR: Wendy Beth Hyman,
Oberlin College

**Effigy Executions, Displaced Violence,
and the Early Modern Stage**

Chelsea Lee, University of California, Irvine

**"No positive proof whatever":
The Authenticity of
"Shakespeare's" Seal Ring**

Anouska Lester, University of York

**Broken Vows and Faithless
Domesticates: Relitigating the
Onstage Cat in William Sampson's
The Vow Breaker (1636)**

*Matthew Walsh, University of
Massachusetts, Amherst*

1:00 to 2:00 p.m.**CV Review and Career Mentoring**

Agate C

David Sterling Brown, *Trinity College*,
Emily Parise, *University of California,
Irvine*, Kathryn Schubert, *University
of California, Irvine*, and Eunwoo Yoo,
University of California, Santa Barbara

**Meeting: The Guild of Queer
Early Modernists Meeting**

Mineral E



2:30 to 4:00 p.m.

Panel: Shakespeare and Neurodiversity

Centennial F

ORGANIZERS: Sheila T. Cavanagh,
Emory University and Bradley J.
Irish, *Arizona State University*

CHAIR: Sheila T. Cavanagh,
Emory University

**Thinking, Feeling, Sensing:
Shakespearean Minds
and Neurodiversity**

Bradley J. Irish, *Arizona State University*

Allistic Shakespeare

Sonya Freeman Loftis, *Morehouse College*

**“Keep me in temper”: Sensory
Capacity, Normative Nationality,
and Racialized Gender**

Deyasini Dasgupta, *Washington
State University*

**Panel: Theatre History
in Dialogue**

Centennial G

ORGANIZERS: Clare McManus,
Northumbria University and Lucy
Munro, *King’s College London*

CHAIR: Lucy Munro, *King’s College London*

**Ink, Paper, Glue, Pins: Manuscript
Playbooks as Theatrical Objects**

Misha Teramura, *University of Toronto*

**Coverture, Sara Allen, and
the Theatre in Shoreditch: A
(Theatre) History of Alienation**

Jonathan Powell, *University of Edinburgh*

**Choreographies of Bad Service:
Resistant Wives and Servants
in The Taming of the Shrew**

Elisa Oh, *Howard University*

**Anatomised Gender: Cis-Centricity
in the King’s Men’s Repertory**

Lucy Holehouse, *Royal Holloway,
University of London*

**Lost Repertorial Contexts: Theatre
History and Textual Editing**

David McInnis, *University of Melbourne*

4:30 to 6:30 p.m.

**Seminar: Ethical Plurality on
the Early Modern Stage**

Quartz A

LEADERS: Christopher Crosbie, *North
Carolina State University* and Anita
Gilman Sherman, *American University*

John C. Higgins, *University of Nevada, Reno*

Jim Kearney, *University of
California, Santa Barbara*

Jonathan Sircy, *Southern
Wesleyan University*

Richard Allen Strier, *University of Chicago*

**Seminar: Labor and Early
Modern Literature**

Granite C

LEADERS: Megan Heffernan, *DePaul
University* and Julia Schleck,
Colorado State University

Emily Coyle, *Rutgers University, Newark*

Joel M. Dodson, *Southern
Connecticut State University*

Anders Greene-Crow, *New York, NY*

Roze F. Hentschell, *Colorado
State University*

Lindsey L. Jones, *Texas A&M University*

Juan Lamata, *California State
University, Los Angeles*

Tanya Pollard, *Brooklyn College, CUNY*

Rebecca M. Quoss-Moore, *University
of Central Oklahoma*

Charlotte Thurston, *Graduate Center, CUNY*

Molly G. Yarn, *Birmingham, AL*

Seminar: New World Theatricality*Agate B*

LEADERS: Andrew Bozio,
Skidmore College and Caro Pirri,
University of Pittsburgh

Robin Alfriend Kello, *Seton Hall University*

Alexander Paulsson Lash, *National
Taiwan University*

Tonhi Lee, *Tufts University*

Vincent Mennella, *Southern
Methodist University*

George N. Perez, *University of Pennsylvania*

Sarah Snee, *Duquesne University*

Jennie G. Youssef, *Graduate Center, CUNY*

Seminar: Overwhelmed*Mineral D*

LEADERS: Gerard Passannante, *University
of Maryland, College Park* and Susanne
L. Wofford, *New York University*

Stephanie Chamberlain, *Southeast
Missouri State University*

Kathryn A. Crim, *University of Chicago*

Drew Daniel, *Johns Hopkins University*

Jean E. Feerick, *John Carroll University*

Cora Virginia Fox, *Arizona State University*

James A. Knapp, *Loyola University Chicago*

Jonathan Koch, *Pepperdine University*

Ross Lerner, *Occidental College*

Naomi C. Liebler, *Montclair State University*

Morgan Taylor Shaw, *Syracuse University*

James Sutton, *Florida International University*

Penelope Meyers Usher, *Barnard College*



GUTHRIE
THEATER

Theater
in Focus

Scan the code to
browse the library
and register



Bring the magic of the Guthrie into your classroom.

Theater in Focus is a free resource for educators that pairs filmed Guthrie Theater productions with a robust curriculum for high school, college and university instruction. *Hamlet* and *Henry V* are currently available with more coming soon.

guthrietheater.org/theaterinfocus

PHOTO: THE CAST OF *HENRY V* (DAN NORMAN)



Seminar: Shakespeare and Nonsense

Granite B

LEADER: Adam Zucker, *University of Massachusetts, Amherst*

Katie Adkison, *Texas A&M University*

RaNelle Kathleen Bradley,
New York University

Lars Engle, *University of Tulsa*

William Germano, *Cooper Union*

Chris Klippenstein, *University of Toronto*

Mary Odbert, *Fort Collins, CO*

Seminar: Shakespeare's Sentences

Mineral G

LEADERS: Shankar Raman, *Massachusetts Institute of Technology* and Travis D. Williams, *University of Rhode Island*

Lara Dodds, *Mississippi State University*

Darlene Farabee, *University of South Dakota*

Lynne Magnusson, *University of Toronto*

Nick Moschovakis, *Bethesda, MD*

Stephanie Pietros, *College of Mount St. Vincent*

Tracey Sedinger, *University of Northern Colorado*

David Vaughan, *Northwestern Oklahoma State University*

Seminar: The Sonic Laboratory of the Renaissance Theater

Agate A

LEADERS: Sarah F. Williams, *University of South Carolina* and Jennifer Linhart Wood, *George Mason University*

Linda Phyllis Austern,
Northwestern University

Mayra Cortes, *University of California, Los Angeles*

Yujin Jang, *University of Pittsburgh*

Joseph Nelson, *College of the Holy Cross*

Joseph M. Ortiz, *University of Texas, El Paso*

Jeremy L. Smith, *University of Colorado, Boulder*

Seminar: Speaking the Speech

Quartz B

LEADER: Matthew Hunter,
Texas Tech University

Cristina León Alfar, *Hunter College, CUNY*

Jennifer Birkett, *Independent Scholar*

James Kuzner, *Brown University*

Scott Oldenburg, *Tulane University*

Workshop: Teaching Early Modern Gender, Sexuality, and Care of the Body

Mineral A

LEADERS: Karen Sawyer Marsalek,
St. Olaf College and Nancy L. Simpson-Younger, *St. Olaf College*

Anna Riehl Bertolet, *Auburn University*

Jennifer Forsyth, *Kutztown University*

James Yukiko Mulder, *Bentley University*

Hillary M. Nunn, *University of Akron*

Katherine W. Scheil, *University of Minnesota*

Kathryn Schubert, *University of California, Irvine*

Anna-Rose Katerina Shack,
University of Freiburg

Seminar: Theatrical and Environmental Encounters

Granite A

LEADERS: Gretchen Minton, *Montana State University* and Chloe K. Preedy, *University of Exeter*

Katherine Steele Brokaw,
University of Texas, Austin

Christina Cawdery, *University of Hawai'i, Mānoa*

Hillary Eklund, *Grinnell College*

Nathan Powell Keckley, *Syracuse University*

Simon Smith, *Shakespeare Institute,
University of Birmingham*

Jeff Theis, *Salem State University*

William Floyd Wolfgang,
Stevenson University

Seminar: **Unearthing**

Mineral C

LEADERS: *Kristen Abbott Bennett,
Framingham State University and Emily
Rowe, Queen Mary University London*

Mira 'Assaf, Butler University

Frederika Bain, Honolulu, Hawai'i

Shannon J. Garner, Salt Lake City, UT

Molly Hand, Florida State University

*Miranda Hannasch, University
of Nevada, Las Vegas*

Inhoo Kim, Texas A&M University

Ian F. MacInnes, Albion College

*Kirsten Schuhmacher, University
of Connecticut*

Naya Tsentourou, University of Exeter, UK

Seminar: **White Sophistry and Epistemicide in Shakespeare Then and Now**

Mineral B

LEADERS: *Nora Galland, University
of Bretagne Occidentale and
Katherine Gillen, Texas A&M
University, San Antonio*

Laurel N. Billings, University of Michigan

*Fen A. Bischoff, University of
California, Los Angeles*

Patricia A. Cahill, Emory University

Ryan Campagna, University of Chicago

*Eric L. De Barros, American
University of Sharjah*

Angelina Del Balzo, Utah Valley University

Laura DeLuca, Carnegie Mellon University

Kyle M. Labe, University of Connecticut

Joyce G. MacDonald, University of Kentucky

*Maya Mathur, University of
Mary Washington*

Jesus A. Montaño, Baylor University

Bradley D. Ryner, Arizona State University

*Anna-Claire Simpson, Bard Microcollege,
Asnuntuck Community College,
Clemente Course in the Humanities*

Seminar: **"A Whole Theater of Others": Presenting and Representing the Playgoers in Shakespeare's Playhouses**

Mineral F

LEADERS: *Amy Rodgers, Mount
Holyoke College and William N.
West, Northwestern University*

Sheila Coursey, Saint Louis University

Claire J. Eager, College of Wooster

Jennifer A. Low, Florida Atlantic University

*Lynsey McCulloch, Royal
Shakespeare Company*

Lucy Munro, King's College London

*Nancy Selleck, University of
Massachusetts, Lowell*

Stephen M. Wisker, Wesleyan College

6:30 to 8:30 p.m.

ACMRS Cash Bar

Centennial Foyer

Sponsored by ACMRS

*Celebrating authors and
contributors to new ACMRS titles.
All members are welcome.*



7:00 to 10:00 p.m.



Film Screening: *The Tempest*

Centennial F

Q&A with director Garrett Replogle led by Melissa Croteau to follow screening.

“Garrett Replogle’s *The Tempest* is in his own words ‘a love letter to Shakespeare himself, the Mojave desert, and Sci-Fi, certainly unlike any Shakespeare adaptation you have seen before.’ *Star Trek* meets Shakespeare and a spaceship captain is marooned on a desert planet with his daughter, with Ariel, a multi-capable android ‘assistant’ and with a resentful snake-skinned spawn of a witch, Caliban.” (Ren Zelen, review for *Horror DNA*, July 2025)

10:00 p.m. to 1:00 a.m.

The Malone Society Dance

Centennial E

The dance is free to all registrants and their guests thanks to the generosity of the Malone Society.

The Malone Society invites all registrants of #Shax2026 to join the dance and join its ranks: malonesociety.com. The Malone Society publishes editions of early printed and manuscript texts of plays, plus collections of documentary material relating to the performance and reception of early drama.



ASYNCHRONOUS SESSION

Practicum: Articles in Progress

LEADERS: Hillary Eklund, *Grinnell College* and Rebecca Totaro, *Florida Gulf Coast University*

PARTICIPANTS | 54TH ANNUAL MEETING

A

Melissa D. Aaron, *Cal Poly Pomona*
Ifeoluwa Aboluwade, *University of Würzburg, Germany*
Stella Achilleos, *University of Cyprus*
Katie Adkison, *Texas A&M University*
Rebecca Adusei, *King's College London*
Patricia Akhimie, *Folger Shakespeare Library*
Jahidul Alam, *Jackson State University*
Michael Andrew Albright, *Southwest Minnesota State University*
Lucie Alden, *Georgetown University*
Cristina León Alfar, *Hunter College, CUNY*
Gemma Kate Allred, *Université de Neuchâtel*
Bridget B. Anderson, *University of Wisconsin, Madison*
Susan L. Anderson, *Mary Baldwin University*
Douglas H. Arrell, *University of Winnipeg*
Charlotte Artese, *Agnes Scott College*
Abdulhamit Arvas, *University of Pennsylvania*
Ved Dutt Arya, *Ashoka University, Delhi-NCR, India*
Mira Assaf, *Butler University*
Linda Phyllis Austern, *Northwestern University*
Rebecca Ann Bach, *University of Alabama, Birmingham*

B

Precious Bailey, *University of Alabama*
Frederika Bain, *Honolulu, Hawai'i*
David J. Baker, *University of North Carolina at Chapel Hill*
Jonathan Baldo, *Eastman School of Music, University of Rochester*
Ariane M. Balizet, *Texas Christian University*
Vanessa Rodrigues Barcelos, *University of Miami*
Lisa M. Barksdale-Shaw, *Arizona State University*

Olivia Ryan Barry, *University of Massachusetts Amherst*
Bridget Marie Bartlett, *Swansea University*
Mark Bayer, *University of Texas, San Antonio*
Jessica C. Beckman, *Dartmouth College*
Frederick Bengtsson, *University of Kentucky*
Kristen Abbott Bennett, *Framingham State University*
Sean M. Benson, *University of Mary Hardin-Baylor*
James E. Berg, *Middlebury College*
Anna Riehl Bertolet, *Auburn University*
Roya Biggie, *Knox College*
Valerie Billing, *Central College*
Laurel N. Billings, *University of Michigan*
Amber C. Bird, *University of Alabama*
Jennifer Birkett, *Independent Scholar*
Fen A. Bischoff, *University of California, Los Angeles*
Nayoung Seo Bishoff, *George Washington University*
Jennifer Black, *Boise State University*
Theo Black, *Cornell University*
Victoria Bladen, *University of Queensland*
Marlin E. Blaine, *California State University, Fullerton*
Gabriel Bloomfield, *Bates College*
Benjamin Blyth, *University of Calgary*
Erika M. Boeckeler, *Northeastern University*
Liesl Claire Bolin, *Baltimore, MD*
Kate Bolton Bonnici, *Pepperdine University*
Devon Boorman, *Academie Duello Centre for Swordplay*
Andrew Falconer Borgars, *Digital Theatre+*
Keith Botelho, *Kennesaw State University*
Effie Botonaki, *Aristotle University of Thessaloniki, Greece*
Mathieu D. S. Bouchard, *John Abbott College*
Lara Bovilsky, *University of Oregon*



Joseph Bowling, *University of Wisconsin, Madison*
Andrew Bozio, *Skidmore College*
Beatrice Bradley, *University of Minnesota, Twin Cities*
RaNelle Kathleen Bradley, *New York University*
Sophie Braker, *Colorado Spring, CO*
Heidi Brayman, *University of California, Riverside*
Hannah Breder, *Anne Arundel Community College*
Sarah Brew, *Weber State University*
Dennis A. Britton, *University of British Columbia*
Benjamin Broadribb, *London, UK*
Katherine Steele Brokaw, *University of Texas, Austin*
Andrew S. Brown, *Dalhousie University*
David Sterling Brown, *Trinity College*
Piers Brown, *Kenyon College*
Emily D. Bryan, *Sacred Heart University*
Ashley Buchanan, *Folger Shakespeare Library*
Thea Buckley, *Belfast, Northern Ireland*
Stephen M. Buhler, *University of Nebraska, Lincoln*
Elizabeth Burow-Flak, *Valparaiso University*
Jonathan Burton, *Whittier College*
Katarzyna Burzyńska, *Adam Mickiewicz University*
Rebecca Bushnell, *University of Pennsylvania*
Rachel Byrd, *Southern Adventist University*

C

Patricia A. Cahill, *Emory University*
Bianca F. C. Calabresi, *Columbia University*
Ryan Campagna, *University of Chicago*
Zeidy Zady Canales, *Universidad Nacional Autónoma de México (UNAM)*
Cate Cappleman, *Shakespeare at Notre Dame*
Erika Lyn Carbonara, *Kalamazoo College*

Kim Howard Carrell, *Worcester State University*
Matthew Charles Carter, *Clayton State University*
Sheila T. Cavanagh, *Emory University*
Douglas Farquhar Cavers, *University of Southern California*
Christina Cawdery, *University of Hawai'i, Mānoa*
Juan F. Cerdá, *Universidad de Murcia*
Darryl Chalk, *University of Southern Queensland*
Stephanie Chamberlain, *Southeast Missouri State University*
Hannah N. Chambers, *Emory University*
Zainab Cheema, *Florida Gulf Coast University*
Dongqiao Chen, *Beijing, China*
Jeeyoung Choi, *Purdue University*
Yoojung Chun, *Harvard University*
Madeline Cisneros, *University of Miami*
Katharine Cleland, *Virginia Tech*
Catherine R. Clifford, *Hastings College*
Emma R. Cohen, *Northwestern University*
Stephen Cohen, *Central Connecticut State University*
Walter I. Cohen, *University of Michigan*
John Colley, *University of Cambridge*
Rob Conkie, *University of North Carolina, Charlotte*
Francis X. Connor, *Wichita State University*
Megan L. Cook, *Colby College*
Kerry N. Cooke, *Mary Baldwin University*
Amy Cooper, *US Air Force Academy*
Kathryn M. Corah, *SUNY Albany*
Charmaine Cordero, *Claremont Graduate University*
Mayra Cortes, *University of California, Los Angeles*
Sheila Coursey, *Saint Louis University*
Emily Coyle, *Rutgers University, Newark*
Heidi Craig, *University of Toronto*
Katharine A. Craik, *Oxford Brookes University*

Loren Cressler, *University of Texas, Austin*
 Emily Crider, *Purdue University*
 Kathryn A. Crim, *University of Chicago*
 Christopher Crosbie, *North Carolina State University*
 Melissa Croteau, *California Baptist University*
 Taylor Claire Culbert, *SUNY New Paltz*
 Kaitlyn Culliton, *Texas A&M International University*

D

Amberleen Dadabhoj, *Harvey Mudd College*
 Alice Dailey, *Villanova University*
 Drew Daniel, *Johns Hopkins University*
 Andrew M. Darr, *Centralia High School, MO*
 Deyasini Dasgupta, *Washington State University*
 Kurt Daw, *San Francisco State University*
 Claire Dawkins, *Stanford University Online High School*
 Eric L. De Barros, *American University of Sharjah*
 Jane Hwang Degenhardt, *University of Massachusetts, Amherst*
 Remson Jordan DeJoseph, *University of Delaware*
 Angelina Del Balzo, *Utah Valley University*
 Carla Della Gatta, *University of Maryland*
 Laura DeLuca, *Carnegie Mellon University*
 Adhaar Noor Desai, *Bard College*
 Allison K. Deutermann, *Baruch College, CUNY*
 Nicholas Devlin, *The Gallatin School, NYU*
 Amrita Dhar, *University of California, San Diego*
 Amanda Di Ponio, *Huron University College*
 Elizabeth Dieterich, *Carnegie Mellon University*
 Craig Dionne, *Eastern Michigan University*
 Lara Dodds, *Mississippi State University*
 Joel M. Dodson, *Southern Connecticut State University*
 Kate Doubler, *University of South Florida*

Michelle M. Dowd, *University of Alabama*
 Lowell Duckert, *University of Delaware*
 Mark Dudgeon, *Arden Shakespeare*
 Holly E. Dugan, *George Washington University*
 Delanie R. Harrington Dummit, *University of California, Davis*
 Susan M. Dunn-Hensley, *Wheaton College*
 Allison Duque, *University of South Florida*
 Patrick Durdell, *University of Oxford*

E

Claire J. Eager, *College of Wooster*
 Heather C. Easterling, *Gonzaga University*
 Rachel Eisendrath, *Barnard College, Columbia University*
 Hillary Eklund, *Grinnell College*
 Laurie Ellinghausen, *University of Missouri, Kansas City*
 Daniel Emerson, *University of Alabama*
 Lars Engle, *University of Tulsa*
 Michelle Ephraim, *Worcester Polytechnic Institute*
 Bridget Mary Escolme, *Queen Mary University of London*
 Doug Eskew, *Colorado State University, Pueblo*
 Ruben Espinosa, *Arizona State University*
 Laura Estill, *St. Francis Xavier University*
 Donna Evan-Kesef, *Stanford University*

F

Darlene Farabee, *University of South Dakota*
 Alan B. Farmer, *Ohio State University*
 Mark D. Farnsworth, *Brigham Young University, Idaho*
 Ryan Derek Farrar, *Collin College*
 Valerie M. Fazel, *Arizona State University*
 Jennifer Feather, *University of North Carolina, Greensboro*
 Jean E. Feerick, *John Carroll University*
 Ewan Fernie, *Shakespeare Institute, University of Birmingham*



Melody Fetske, *Shakespeare Association of America*
Gina Filo, *Utah State University*
Jennifer Flaherty, *Georgia College*
Diego Gregorio Fleitas, *University of Mississippi*
Mary Floyd-Wilson, *University of North Carolina, Chapel Hill*
Gregory A. Foran, *Nazareth University*
Jemma Louise Forster, *Cambridge, UK*
Jennifer Forsyth, *Kutztown University*
Cora Virginia Fox, *Arizona State University*
Liz Fox, *University of Massachusetts, Amherst*
Timothy Francisco, *Youngstown State University*
Nica Giromini Franklin, *University of California, Berkeley*
Anne Freeman, *University of Mississippi*
Paul Adrian Fried, *Northfield, MN*
Michael D. Friedman, *University of Scranton*
Susan C. Frye, *University of Wyoming*
Ciara J. Fulton, *University at Buffalo, SUNY*

G

Evelyn Gajowski, *University of Nevada, Las Vegas*
Nora Galland, *University of Bretagne Occidentale*
Joseph Gamble, *University of Toledo*
Jonas Gardsby, *University of Wisconsin, Green Bay*
Shannon J. Garner, *Salt Lake City, UT*
Benjamin C. Gee, *Stanford University*
William Germano, *Cooper Union*
Loreen L. Giese, *Ohio University*
Edward Gieskes, *University of South Carolina*
Katherine Gillen, *Texas A&M University, San Antonio*
Philip Austin Gilreath, *Tulane University*
Kelley Katherine Glasgow, *Boston College*
Emily Glider, *Bilkent University, Ankara, Türkiye*
Marinela Golemi, *Northern Arizona University*

José Manuel González, *Universidad de Alicante*
Katharine Goodland, *College of Staten Island, CUNY*
Jade Gorgan, *Arden Shakespeare*
Ani Govjian, *University of Pennsylvania*
Kyle Grady, *University of California, Irvine*
E. Rose Grant, *University of Toronto*
Spencer Grayson, *University of Virginia*
Douglas E. Green, *Augsburg University*
Dalton Edward Greene, *University of Maryland*
Anders Greene-Crow, *New York, NY*
Peter Greenfield, *University of Puget Sound*
Brent Griffin, *Resurgens Theatre Company / Georgia State University*
Eric J. Griffin, *Millsaps College*
Huw Griffiths, *University of Sydney*
Perry D. Guevara, *Georgia Institute of Technology*
Renuka Gusain, *University of North Carolina, Asheville*
Emiliano Gutierrez-Popoca, *Georgia Institute of Technology*

H

Jess Hamlet, *Alvernia University*
Elisha Hamlin, *University of California, Davis*
Molly Hand, *Florida State University*
Miranda Hannasch, *University of Nevada, Las Vegas*
Matthew C. Hansen, *Boise State University*
Brian Harries, *Concordia University*
Patrick Aaron Harris, *University of South Carolina*
Sharon J. Harris, *Brigham Young University*
Matthew P. Harrison, *West Texas A&M University*
F. Elizabeth Hart, *University of Connecticut, Storrs*
David W. Hartwig, *Weber State University*
Joseph P. Haughey, *Northwest Missouri State University*

Gina Hausknecht, *Coe College*
 Pierre Hecker, *Carleton College*
 Donald K Hedrick, *Kansas State University*
 Megan Heffernan, *DePaul University*
 Anna Hegland, *Carthage College*
 Christa Hegland
 Joshua R. Held, *Southeastern
 Oklahoma State University*
 Nic Helms, *Independent Scholar*
 Diana E. Henderson, *Massachusetts
 Institute of Technology*
 Roze F. Hentschell, *Colorado
 State University*
 Hannah Elizabeth Hicks,
University of Notre Dame
 Derrick Higginbotham, *University
 of Hawai'i, Mānoa*
 John C. Higgins, *University of Nevada, Reno*
 Sarah Higinbotham, *Emory
 University, Oxford College*
 Benjamin Hilb, *Francis Marion University*
 Michael J. Hirrel, *Arlington, VA*
 Rebecca Hixon, *St. Bonaventure University*
 Christine Hoffmann, *West Virginia University*
 Jason C. Hogue, *Texas A&M
 University, Kingsville*
 Lucy Holehouse, *Royal Holloway,
 University of London*
 Jennifer R. Holl, *Rhode Island College*
 Peter Holland, *University of Notre Dame*
 Gavin Hollis, *Hunter College, CUNY*
 Adam G. Hooks, *University of Iowa*
 Jonathan Hope, *ACMRS Press*
 D. J. Hopkins, *San Diego State University*
 Jackie Hopkins
 Robert Hornback, *Oglethorpe University*
 Mark Anthony Houlahan,
University of Waikato
 Jean E. Howard, *Columbia University*
 Lizzie Conrad Hughes, *Shake-
 Scene Shakespeare*
 Joanna Huh, *University of Cincinnati*
 Elizabeth B. Hunter, *Washington
 University in St. Louis*

Matthew Hunter, *Texas Tech University*
 Lucy Barbara Hurst, *University of Bristol*
 Kimberly A. Huth, *California State
 University, Dominguez Hills*
 Wendy Beth Hyman, *Oberlin College*
 Trina Hyun, *University at Buffalo, SUNY*

William Ingram, *University of Michigan*
 Bradley J. Irish, *Arizona State University*
 Jordan Ivie, *Vanderbilt University*

J

Scott Jackson, *University of Notre Dame*
 Miriam E. Jacobson, *University of Georgia*
 Yujin Jang, *University of Pittsburgh*
 Benjamin Jeffery, *University of Chicago*
 Liesl Elphie Jensen, *Shakespeare
 Institute, University of Birmingham*
 Michael P. Jensen, *Shakespeare Newsletter*
 Phebe Jensen, *Utah State University*
 Kristine Johanson, *Universiteit
 van Amsterdam*
 Eric M. Johnson, *George Mason University*
 Kameron Johnson, *Sorbonne Université*
 Melissa M. Johnson, *Lyon College*
 Alexandra Ferguson Johnston,
University of Toronto
 Keith Jones, *University of
 Northwestern, Saint Paul*
 Lindsey L. Jones, *Texas A&M University*
 Nicholas Jones, *Oberlin College*
 Oliver Jones, *University of York, UK*
 Ollie Jones, *University of York*
 Alexa Alice Joubin, *George
 Washington University*

K

Yunah Kae, *College of Charleston*
 Mark Beatrice Kaethler,
Medicine Hat College
 Cheryle Kapsak, *The Scholar's Choice*



Christine Marie Kasparian,
Bennington College

David Kathman, *Chicago, IL*

Jim Kearney, *University of California, Santa Barbara*

Nathan Powell Keckley, *Syracuse University*

Siobhan C. Keenan, *De Montfort University*

Robin Alfriend Kello, *Seton Hall University*

Erin E. Kelly, *University of Victoria*

Erin K. Kelly, *California State University, Chico*

Sawyer K. Kemp, *Queens College, CUNY*

Lindsay Adams Kennedy, *Benedictine College*

Bill Kerwin, *University of Missouri*

Linc Kesler, *University of British Columbia*

Joseph Hirzer Kidney, *Stanford University*

Inhoo Kim, *Texas A&M University*

Peter Kirwan, *Mary Baldwin University*

Andr as Kis ery, *City College of New York, CUNY*

Chris Klippenstein, *University of Toronto*

James A. Knapp, *Loyola University Chicago*

Katherine I. Knowles, *University of Kansas*

Jonathan Koch, *Pepperdine University*

Laura E. Kolb, *Baruch College, CUNY*

Laura Koleva, *Texas Tech University*

Elizabeth Zeman Kolkovich,
Ohio State University

Natasha Korda, *Wesleyan University*

Hannah Korell, *University of Wisconsin, Platteville*

Anna Kowalcze-Pawlik, *University of Lodz*

Matthew Kozusko, *Ursinus College*

Jennifer Dawson Kraemer,
University of North Texas

Blaire A. Krakowitz, *Pennsylvania State University*

James Kuzner, *Brown University*

L

Kyle M. Labe, *University of Connecticut*

Alexandra E. LaGrand, *Texas A&M University*

Juan Lamata, *California State University, Los Angeles*

Jonathan P. Lamb, *University of Kansas*

Jesse M. Lander, *University of Notre Dame*

Katharine E. Landers, *Illinois State University*

David Landreth, *University of California, Berkeley*

Douglas Lanier, *University of New Hampshire*

Katie Lanning, *Wichita State University*

Alexander Paulsson Lash, *National Taiwan University*

Sean K. Lawrence, *University of British Columbia, Okanagan*

Chelsea Lee, *University of California, Irvine*

Tonhi Lee, *Tufts University*

Courtney Lehmann, *University of the Pacific*

Kent Lehnhof, *Chapman University*

Kelly Lehtonen, *Campbellsville University*

Bi-qi Beatrice Lei, *Shakespeare Association of America*

Neah Lekan, *Johns Hopkins University*

Olivia Leonard, *Arizona State University*

Ross Lerner, *Occidental College*

Cl mence Lescoutre, *Universit  Sorbonne Nouvelle Paris*

Sarah Gray Lesley, *University of Chicago*

Anouska Lester, *University of York*

Laura E. Levine, *New York University*

Marjorie B. Levinson, *University of Michigan*

Jennifer Lewin, *University of Haifa*

Jinjian Li, *Peking University*

Naomi C. Liebler, *Montclair State University*

Erika T. Lin, *Graduate Center, CUNY*

Willnide Lindor, *SUNY Cortland*

Caroline Lion, *Southern Oregon University*

Arthur L. Little, Jr., *University of California, Los Angeles*

Jennifer Lillian Lodine-Chaffey,
Montana State University, Billings

Sonya Freeman Loftis, *Morehouse College*

Sandra A. Logan, *Michigan State University*

Sydney Logan, *Cambridge University Press*

Catherine Loomis, *Rochester, NY*

Natalie J. Loper, *University of Alabama*
 Genevieve Love, *Colorado College*
 Jennifer A. Low, *Florida Atlantic University*
 James Loxley, *University of Edinburgh*
 Elisabeth Lutteman, *Visby, Sweden*
 Sara D. Luttfiring, *Pennsylvania State University, Behrend*

M

Joyce G. MacDonald, *University of Kentucky*
 Ian F. MacInnes, *Albion College*
 Sally-Beth MacLean, *University of Toronto*
 Emily MacLeod, *Penn State Harrisburg*
 Lynne Magnusson, *University of Toronto*
 Tamara Mahadin, *Kirkwood Community College*
 Caitlin Mahaffy, *Mount Holyoke College*
 Grace Maher, *Shakespeare at Notre Dame*
 Scott Maisano, *University of Massachusetts, Boston*
 Eric S. Mallin, *University of Texas, Austin*
 Joseph Mansky, *University of Oklahoma*
 James D. Mardock, *University of Nevada, Reno*
 Christopher Marino, *University of North Carolina, Wilmington*
 James J. Marino, *Cleveland State University*
 Karen Sawyer Marsalek, *St. Olaf College*
 Paige Martin Reynolds, *University of Central Arkansas*
 Ann M. Martinez, *Kent State University, Stark*
 Jeffrey Masten, *Northwestern University*
 Maya Mathur, *University of Mary Washington*
 Andrew Mattison, *University of Toledo*
 Ágnes Matuska, *Szegedi Tudományegyetem*
 Katharine Eisaman Maus, *University of Virginia*
 Kris L. May, *Texas A&M University*
 Jess McCall, *Delaware Valley University*
 Erik McCarthy, *Gordon State College*
 Harry R. McCarthy, *University of Southern California*
 Jeanne H. McCarthy, *Georgia Gwinnett College*

Lynsey McCulloch, *Royal Shakespeare Company*
 Tricia McElroy, *University of Alabama*
 David McInnis, *University of Melbourne*
 Adam N. McKeown, *Tulane University*
 Clare McManus, *Northumbria University*
 Kate McPherson, *Utah Valley University*
 Richard J. Meek, *University of Hull*
 Nedda Mehdizadeh, *University of California, Los Angeles*
 Carol Mejia LaPerle, *Wright State University*
 Kirsten N. Mendoza, *University of Dayton*
 Vincent Mennella, *Southern Methodist University*
 Alicia J. Meyer, *University of Pennsylvania*
 Alfredo Michel Modenessi, *Universidad Nacional Autónoma de México*
 Tracey Miller-Tomlinson, *New Mexico State University*
 Erin K. Minear, *College of William & Mary*
 Gretchen Minton, *Montana State University*
 Dianne Mitchell, *University of Colorado, Boulder*
 Kathryn M. Moncrief, *Worcester Polytechnic Institute*
 Jesus A. Montaña, *Baylor University*
 Marianne Montgomery, *East Carolina University*
 Gaywyn Moore, *Santa Clara University*
 Thomas J. Moretti, *Iona University*
 Sara Morrison, *William Jewell College*
 Nick Moschovakis, *Bethesda, MD*
 Ian F. Moulton, *Arizona State University*
 James Yukiko Mulder, *Bentley University*
 Alyssa Mulé, *University of Chicago*
 Victoria M. Muñoz, *Adelphi University*
 Lucy Munro, *King's College London*
 Ineke Murakami, *University at Albany, SUNY*
 Anne M. Myers, *University of Missouri*
 Bernadette Myers, *Washington University in St. Louis*
 Nova Myhill, *New College of Florida*



N

Joseph Navitsky, *Champlain College, Saint-Lambert*
Kate Needham, *University of Mississippi*
Alan H. Nelson, *University of California, Berkeley*
Joseph Nelson, *College of the Holy Cross*
James T. Newlin, *Case Western Reserve University*
Emily Rose Nicholls, *King's College London / University of Hong Kong*
Jennifer E. Nicholson, *University of Sydney*
Marissa Nicosia, *Pennsylvania State University, Abington College*
Shuo Niu, *University of York*
Daniel Normandin, *Marshall University*
Kara J. Northway, *Kansas State University*
Hillary M. Nunn, *University of Akron*

O

Sharon O'Dair, *University of Alabama*
Katie Elizabeth O'Hare, *University of California, Los Angeles*
Conor O'Sullivan, *Western Reserve Academy*
Mary Odbert, *Fort Collins, CO*
Elisa Oh, *Howard University*
Scott Oldenburg, *Tulane University*
Rebecca Olson, *Oregon State University*
James N. Ortego II, *Troy University*
Joseph M. Ortiz, *University of Texas, El Paso*
İlker Özçelik, *Süleyman Demirel University*

P

Johann Paccou, *Université Sorbonne Nouvelle*
Emily Parise, *University of California, Irvine*
Melissa Parisi, *Cambridge University Press*
Courtney A. Parker, *Huntingdon College*
John L. Parker, *University of Virginia*
Kurtis Glen Parsons, *State Technical College of Missouri*
Gerard Passannante, *University of Maryland, College Park*

Vimala C. Pasupathi, *Hofstra University*
Joseph Penczak, *Troupe of Friends*
George N. Perez, *University of Pennsylvania*
Arnie Perlstein, *Portland, OR*
Mardy Philipian, *Lewis University*
Emily L. Piersma Sharrett, *University of Northwestern, St. Paul*
Stephanie Pietros, *College of Mount St. Vincent*
Tripti Pillai, *Coastal Carolina University*
Caro Pirri, *University of Pittsburgh*
L. Monique Pittman, *Andrews University*
Tanya Pollard, *Brooklyn College, CUNY*
Kristen K. Polster, *Southern Methodist University*
Jonathan Powell, *University of Edinburgh*
Chloe K. Preedy, *University of Exeter*
Artemis Preeshl, *Adams State University, Alamosa*
Richard Preiss, *University of Utah*

Q

Kevin A. Quarmby, *College of St. Scholastica*
Gerit Quealy, *New York, NY*
Rebecca M. Quoss-Moore, *University of Central Oklahoma*

R

Karen Raber, *University of Mississippi*
Shankar Raman, *Massachusetts Institute of Technology*
William R. Rampone, Jr., *South Carolina State University*
Anandi Rao, *SOAS, University of London*
Vanessa L. Rapatz, *Ball State University*
Eric Rasmussen, *University of Nevada*
Francesca Clare Rayner, *Universidade do Minho, Portugal*
Benjamin Sidney Reed, *University of Nebraska, Lincoln*
Evelyn A. Reidy, *Independent Scholar*
Peter C. Remien, *Lewis-Clark State College*
Garrett Replogle

Neil Rhodes, *University of St. Andrews*
 Kelsey Ridge, *Alvernia University*
 Matthew Ritger, *Dartmouth College*
 James A. Rizzi, *Canisius University*
 Lauren Robertson, *Columbia University*
 Marie H. Roche, *University of Massachusetts, Amherst*
 Katey E. Roden, *Gonzaga University*
 Amy Rodgers, *Mount Holyoke College*
 Don Rodrigues, *Old Dominion University*
 Colleen Ruth Rosenfeld, *Pomona College*
 Danielle Rosvally, *University at Buffalo, SUNY*
 Amos Rothschild, *St. Thomas Aquinas College*
 Asia Rowe, *St. Joseph's College of Maine*
 Emily Rowe, *Queen Mary University London*
 Amanda K. Ruud, *Valparaiso University*
 Bradley D. Ryner, *Arizona State University*

S

Adam Rzepka, *Montclair State University*
 Rhonda Lemke Sanford, *Fairmont State University*
 Kathryn Vomero Santos, *Trinity University*
 Abhishek Sarkar, *Jadavpur University*
 Ashley Sarpong, *California State University, Stanislaus*
 Tonissa Saul, *ACMRS Press*
 Dennis C Schebetta, *Skidmore College*
 Lucia Scheckner, *New York, NY*
 Katherine W. Scheil, *University of Minnesota*
 Julia Schleck, *Colorado State University*
 Gregory M. Schnitzspahn, *Boston, MA*
 Laryssa Schoeck, *Shakespeare Institute, University of Birmingham*
 Emily Schoenbeck, *University of Minnesota*
 John Schreiber, *Sparrowbush, NY*
 Kathryn Schubert, *University of California, Irvine*
 Kirsten Schuhmacher, *University of Connecticut*
 Barbara Sebek, *Colorado State University*

Tracey Sedinger, *University of Northern Colorado*
 Nancy Selleck, *University of Massachusetts, Lowell*
 Aidan Selmer, *Sarah Lawrence College*
 Edel Semple, *University College Cork*
 Amrita Sen, *University of Calcutta*
 Ira Sen, *University of Mississippi*
 Anna-Rose Katerina Shack, *University of Freiburg*
 Saiham Sharif, *University of California, Irvine*
 Justin P. Shaw, *Clark University*
 Morgan Taylor Shaw, *Syracuse University*
 Jonathan Shelley, *St. John Fisher University*
 Philippa M. Sheppard, *University of Toronto*
 Nicole Sheriko, *Yale University*
 Anita Gilman Sherman, *American University*
 Stephanie Shirilan, *Syracuse University*
 Lauren Shohet, *Villanova University*
 Lauren Shook, *University of North Carolina, Greensboro*
 Emily Shortslef, *University of Kentucky*
 Adam Washiyama Shulman, *Cornell University*
 Michael W. Shurgot, *South Puget Sound Community College*
 Anna-Claire Simpson, *Bard Microcollege, Asnuntuck Community College, Clemente Course in the Humanities*
 Lucas Simpson, *University of Toronto*
 Nancy L. Simpson-Younger, *St. Olaf College*
 Bailey Sincox, *Binghamton University*
 Jonathan Sircy, *Southern Wesleyan University*
 Joel E. Slotkin, *Towson University*
 Charlene V. Smith, *Cleveland, OH*
 Ian Smith, *University of Southern California*
 Jeremy L. Smith, *University of Colorado, Boulder*
 Khristian S. Smith, *University of North Carolina, Chapel Hill*
 Simon Smith, *Shakespeare Institute, University of Birmingham*
 Eilis Smyth, *University of Notre Dame*



Sarah Snee, *Duquesne University*
Megan Snell, *Boston University*
Patrick Soto, *Yale University*
Christi Spain-Savage, *Siena College*
Rachel Leann Spencer, *University of Texas, Austin*
Stephen Spiess, *Babson College*
John-Paul Spiro, *Villanova University*
Jeffrey Scott Squires, *Carnegie Mellon University in Qatar*
Danielle A. St. Hilaire, *Duquesne University*
Kelly J. Stage, *University of Nebraska, Lincoln*
Robert Stagg, *Texas A&M University*
Jade Standing, *Queen's University*
Goran Stanivukovic, *Saint Mary's University*
Kay Stanton, *California State University, Fullerton*
Kelly Christine Steele, *The Meadows School, Las Vegas*
Mary K. Steible, *Southern Illinois University Edwardsville*
Elizabeth V. Steinway, *Colorado State University*
Joseph F. Stephenson, *Abilene Christian University*
Alan Stewart, *Columbia University*
Shaun Jeremy Stiemsma, *Dordt University*
James W. Stone, *American University*
Richard Allen Strier, *University of Chicago*
Arya Sureshbabu, *University of California, Berkeley*
James Sutton, *Florida International University*
Natalie Suzelis, *Antioch College*
David Swain, *Southern New Hampshire University*
Seth Logan Swanner, *University of Wyoming*

T

Jenny Tan, *University of Pennsylvania Press*
Suzanne Tanner, *Avila University*
Elizabeth E. Tavares, *University of Alabama*

Misha Teramura, *University of Toronto*
Jeff Theis, *Salem State University*
Ashley Thomas, *Columbia University*
Chad Allen Thomas, *University of Alabama, Huntsville*
Julie Thompson, *Burman University*
Chris Thurman, *University of the Witwatersrand*
Charlotte Thurston, *Graduate Center, CUNY*
Amy L. Tigner, *University of Texas, Arlington*
Dorothy Todd, *Texas A&M University*
Mackenzie Margaret Tomlinson, *Oklahoma State University*
Jessica Tooker, *Indiana University, Bloomington*
Katayoun Torabi, *Texas A&M University*
Will Tosh, *Shakespeare's Globe*
Rebecca Totaro, *Florida Gulf Coast University*
Jeanette N. Tran, *Drake University*
Sally Treanor, *myShakespeare*
Evelyn Tribble, *University of Connecticut*
Marie Trotter, *McGill University*
Scott A. Trudell, *University of Maryland*
Mariana Trujillo Marquez, *Graduate Center, CUNY*
Naya Tsentourou, *University of Exeter, UK*
Laura Turchi, *Arizona State University*
Henry S. Turner, *Rutgers University*

U

Deborah Uman, *Weber State University*
Verne Underwood, *Rogue Community College*
Steven Urkowitz, *City College of New York, CUNY*
Penelope Meyers Usher, *Barnard College*

V

Lydia Valentine, *Shakespeare's Globe*
Andrea F. Van Nort, *United States Air Force Academy*

Benjamin VanWagoner, *Columbia University*
 Christine Varnado, *University at Buffalo, SUNY*
 David Vaughan, *Northwestern
 Oklahoma State University*
 Amanda Vialva
 José Juan Villagrana, *Santa Clara University*
 Hudson Vincent, *Davidson College*
 Valentina Vinci, *London, UK*
 Megan Vinson, *Indiana University*
 Maggie Vinter, *Case Western
 Reserve University*
 Daniel J. Vitkus, *University of
 California, San Diego*
 Valerie Voight, *University of Tennessee*
 Jennie M. Votava, *Allegheny College*

W

Rob Wakeman, *Mount St. Mary College*
 Jennifer Waldron, *University of Pittsburgh*
 Denise A. Walen, *Vassar College*
 Katherine Walker, *University
 of Nevada, Las Vegas*
 Lanier Walker, *University of North Carolina*
 Sarah Wall-Randell, *Wellesley College*
 Simone Waller, *Reed College*
 Matthew Walsh, *University of
 Massachusetts, Amherst*
 Thomas Ward, *United States Naval Academy*
 Greg Watkins, *myShakespeare*
 Erin Webster, *College of William & Mary*
 Lauren Weindling, *Wilfrid Laurier University*
 Emily Weissbourd, *Lehigh University*
 Paul Werstine, *King's University College,
 University of Western Ontario*
 William N. West, *Northwestern University*
 Paul Whitfield White, *Purdue University*
 Willow White, *University of Alberta*
 Dawn Monique Williams, *Weber
 State University*
 Katherine Schaap Williams,
University of Toronto
 Nora J. Williams, *BIMM University*

Sarah F. Williams, *University
 of South Carolina*
 Seth Stewart Williams, *Barnard
 College, Columbia University*
 Shay Williams, *University of New Hampshire*
 Travis D. Williams, *University of Rhode Island*
 Laura Williamson, *Saint Mary's
 College, Notre Dame*
 Jordan Windholz, *Shippensburg University*
 Emily F. Winerock, *Shakespeare and
 Dance Project / Point Park University*
 Stephen M. Wisker, *Wesleyan College*
 Susanne L. Wofford, *New York University*
 William Floyd Wolfgang,
Stevenson University
 Jennifer Linhart Wood, *George
 Mason University*
 Donna Woodford-Gormley, *New
 Mexico Highlands University*
 W. B. Worthen, *Barnard College,
 Columbia University*

Y

Daniel Yabut, *CNRS/Université de
 Montpellier Paul-Valéry*
 Grace Yancy, *University of Texas, Tyler*
 John Yargo, *Boston College*
 Molly G. Yarn, *Birmingham, AL*
 Robert Yates, *Wagner College*
 Eunwoo Yoo, *University of
 California, Santa Barbara*
 Jennie G. Youssef, *Graduate Center, CUNY*

Z

Paul J. Zajac, *McDaniel College*
 Jordan Zajac, *O.P., Providence College*
 Matthew Zarnowiecki, *Touro University*
 Corinne Zeman, *Texas A&M
 University, Corpus Christi*
 Wenhan Zhang, *Northwestern University*
 Mary Erica Zimmer, *Massachusetts
 Institute of Technology*
 Adam Zucker, *University of
 Massachusetts, Amherst*



SAA POLICIES

Social Media Guidelines

In recent years, Twitter, Facebook, and other forms of social media have become a rich resource for scholarly discourse, opening up the conversation to those outside of the conference's physical space. That said, many of us are new to social media, and the conventions around its use are still forming. Here are three basic principles for using Twitter and other social media.

Consent

Recording devices and Twitter broadcast work and comments that have traditionally been relatively closely held. Audio and video recordings of sessions should not be made or posted without the permission of all panelists or seminar members, ideally secured through the moderator or seminar leader in advance of the session. Any speaker has the right to request that his or her work and comments not be tweeted. Please ask subjects involved before posting and tagging photos.

Professional Tone

Twitter feeds represent an extension of the conference online. As such, we encourage participants to consider their comments to be public, avoiding remarks that would be inappropriate in other professional spaces.

Fair Quotation

Live-tweeting often represents itself as a transcript of spoken words. Tweeters should be aware of the potential for misrepresentation, appropriation, and removal of context. It is important to attribute tweets with a speaker's handle or full name (for example, @handle:xxx). Retweeting and favoriting remove tweets from temporal sequence, so it is best to attribute individual tweets, rather than just the first in a sequence.

Sexual Harassment Policy

The SAA strives to be an inclusive and welcoming point of contact for our diverse membership of scholars, teachers, and students from around the world. We take instances of disrespectful, dismissive, patronizing, or harassing behavior—whether in speech or act, whether in formal or informal settings, and whether based on gender, sexuality, race, ethnicity, religious affiliation, ability, status, or age—seriously. Those who are the targets of harassment should not feel unheard or unassisted.

Definitions

Sexual harassment is behavior that demeans, humiliates, or threatens an individual on the basis of their sex. It is unwanted attention that a recipient experiences as offensive or disruptive to personal well-being. Sexual harassment can include crude behavior (such as offensive statements, jokes, or gestures); dismissive or insulting modes or address (such as referring to a woman not by her name but as "honey"); unwelcome sexual attention (such as unwanted touching or repeated requests for dates); and coercion.

Sex-based harassment also takes nonsexual forms when an individual is targeted because of gender or gender expression. It singles out some members of the

community as acceptable targets and as unworthy of respect. Harassment never occurs in a vacuum. Frequently, alienating behaviors including race- and religion-based harassments intertwine with sexual harassment. Working to discern, for instance, whether a comment about appearance is aimed primarily at someone's gender, sexuality, religion, or race mistakes how harassment can leave its impact on multiple levels.

The SAA emphasizes the importance of adopting a fully intersectional understanding of sex-based harassment. Harassment not only sabotages the individual; it also damages the Shakespeare Association community by discouraging participation in the Association and compromising the free exchange of ideas that is at the center of our mission as an organization.

Respect

All of the spaces into which our professional meetings extend are professional, and the values of respect, equity, and nondiscrimination should inform conduct in the seminar room and on the dance floor, over coffee, and over drinks. All members should aspire to treat each member as having an equally valuable contribution to make.

What to Do if You Have Been Harassed

The SAA seeks to provide meaningful support to members who have experienced sexual harassment at the annual meeting or related events. If you have experienced any unwelcome behaviors, please contact the executive director or any trustee of the Association. These officially designated contacts can serve as sounding boards, confidantes, and informal advisers; they can also confer with you confidentially about possible next steps. Reporting an incident of sexual harassment does not obligate the reporter to pursue any further action. The SAA's goal above all is to support vulnerable members of the community and to strategize to end the harassment in question. As a voluntary professional organization with a small staff, the SAA is unfortunately limited in its ability to respond formally to charges of sexual harassment. Nonetheless, within these constraints the SAA will follow its professional and ethical responsibility to respond to reports of sexual harassment among its membership.

Academic Integrity

The Shakespeare Association of America thrives on the circulation of new and emerging ideas. The special atmosphere of its annual conference derives in part from its distinctive ways of bringing scholars of all ranks and many kinds of affiliation together for a free exchange of ideas. Unusual openness requires a high degree of academic trust. Given the circulation of work-in-progress that the conference fosters, it is important for all members to follow established citation and copyright guidelines in handling the intellectual property of others, including all abstracts, papers, and talks presented at the SAA.

Always obtain permission before citing unpublished work heard or read at the conference.

Never recirculate another's work in your own scholarship or teaching without the author's permission.

Treat seminar abstracts in the same way as papers read or circulated.

Follow the SAA's Social Media Guidelines for digital distribution, in real time or in retrospect, of the content of panels or seminars.



Shakespeare Association
of America

CONFERENCE APP FOR THE 54TH ANNUAL MEETING



1. **Scan the QR code** to download the MC Member App.
2. **Search for SAA**, or **Use the event code SAA54**.
3. **Sign in** (top right) using your email to get full access.
4. **Edit your Attendee profile** by clicking the face icon on the top right of the home page.
5. **Email a photo to shakespeare@olemiss.edu** to update your Speaker profile





UNIVERSITY
OF WYOMING



The University of Wyoming welcomes the
**Shakespeare Association
of America to Denver**

We invite you to consider our fully funded MA program in English and our trailblazing PhD program in the Public Humanities, blending traditional English scholarship with a deep investment in public advocacy and community engagement.

===== **UWYO.EDU** =====

